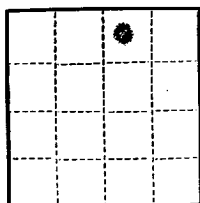

196

COPY TO O. C.

HOBBS

Budget Bureau No. 42-R358.4.  
Approval expires 12-31-60.WANDLEY  
ENGINEER

(SUBMIT IN TRIPLICATE)

UNITED STATES  
DEPARTMENT OF THE INTERIOR  
GEOLOGICAL SURVEY

Land Office

Lease No. **LC-062300**

Unit

## SUNDRY NOTICES AND REPORTS ON WELLS

DEC 14 1960

NOTICE OF INTENTION TO DRILL	<input checked="" type="checkbox"/>	SUBSEQUENT REPORT OF WATER SHUT-OFF	
NOTICE OF INTENTION TO CHANGE PLANS		SUBSEQUENT REPORT OF SHOOTING OR ACIDIZING	
NOTICE OF INTENTION TO TEST WATER SHUT-OFF		SUBSEQUENT REPORT OF ALTERING CASING	
NOTICE OF INTENTION TO RE-DRILL OR REPAIR WELL		SUBSEQUENT REPORT OF RE-DRILLING OR REPAIR	
NOTICE OF INTENTION TO SHOOT OR ACIDIZE		SUBSEQUENT REPORT OF ABANDONMENT	
NOTICE OF INTENTION TO PULL OR ALTER CASING		SUPPLEMENTARY WELL HISTORY	
NOTICE OF INTENTION TO ABANDON WELL			

(INDICATE ABOVE BY CHECK MARK NATURE OF REPORT, NOTICE, OR OTHER DATA)

Lease No. **186466**  
**G. E. Jordan Federal NCT-1****This well is in the Cotton Draw Unit**  
**December 13, 1960**Well No. **8** is located **660** ft. from **N** line and **1980** ft. from **E** line of sec. **15****NW/4 NE/4 Sec. 15** **T-25-S** **R-32-E** **NM**  
(1/4 Sec. and Sec. No.) (Twp.) (Range) (Meridian)**Undesignated Mla. Sd.** **Lee** **New Mexico**  
(Field) (County or Subdivision) (State or Territory)The elevation of the derrick floor above sea level is **Not Avail** ft.

## DETAILS OF WORK

(State names of and expected depths to objective sands; show sizes, weights, and lengths of proposed casings; indicate mudding jobs, cementing points, and all other important proposed work)

FORMATION TOPS EXPECTED:	SIZE CASING			CASING PROGRAM (APPROX.)	
				Set at	Cement
Anhydrite	785'				
Salt	1185'	7-5/8"	24#	350'	300 ex
Delaware Lime	4665'	4-1/2"	9.5#	4790'	150 4% Gel.
Delaware Sand	4690'				
Total Depth	4990'				

I understand that this plan of work must receive approval in writing by the Geological Survey before operations may be commenced.

Company **TEXACO Inc.** **TEXACO Inc.**Address **P. O. Box 3109****Midland, Texas**By **J. J. Velten**  
Title **Division Civil Engineer**

**NEW MEXICO OIL CONSERVATION COMMISSION**  
**WELL LOCATION AND ACREAGE DEDICATION PLAT**

FORM C-128  
Revised 5/1/57

SEE INSTRUCTIONS FOR COMPLETING THIS FORM ON THE REVERSE SIDE

**SECTION A**

Operator <b>TEXACO Inc.</b>			Lease <b>G. E. Jordan Federal NCT-153</b>		Well No. <b>8</b>
Unit Letter <b>B</b>	Section <b>15</b>	Township <b>25 South</b>	Range <b>32 East</b>	County <b>Lea</b>	
Actual Footage Location of Well: <b>660</b> feet from the <b>North</b> line and <b>1980</b> feet from the <b>East</b> line Sec. <b>15</b>					
Ground Level Elev.	Producing Formation <b>Delaware Sand</b>	Pool <b>Undesignated</b>		Dedicated Acreage: <b>40</b> Acres	

1. Is the Operator the only owner in the dedicated acreage outlined on the plat below? YES X NO \_\_\_\_ . ("Owner" means the person who has the right to drill into and to produce from any pool and to appropriate the production either for himself or for himself and another. (65-3-29 (e) NMSA 1935 Comp.)
2. If the answer to question one is "no," have the interests of all the owners been consolidated by communitization agreement or otherwise? YES \_\_\_\_ NO \_\_\_\_ . If answer is "yes," Type of Consolidation \_\_\_\_\_
3. If the answer to question two is "no," list all the owners and their respective interests below:

Owner	Land Description

**RECEIVED**  
**DEC 14 1960**  
 GEOLOGICAL SURVEY  
 ALBUQUERQUE, NEW MEXICO

**SECTION B**

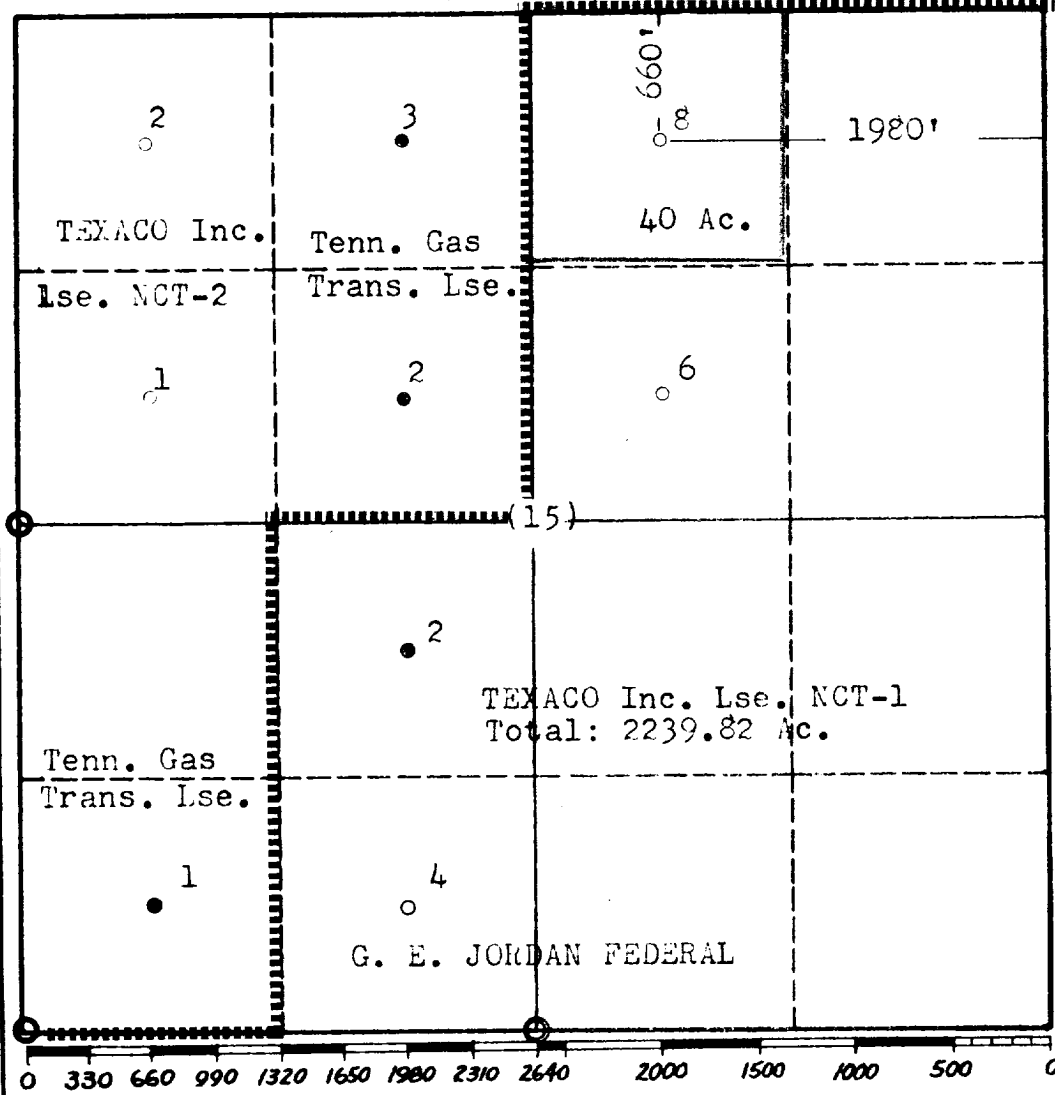

**CERTIFICATION**

I hereby certify that the information in SECTION A above is true and complete to the best of my knowledge and belief.

Name	<b>J. J. Velten</b>
Position	<b>Division Civil Engineer</b>
Company	<b>TEXACO Inc.</b>
Date	<b>12-13-60</b>

⊙ ← Markers

I hereby certify that the well location shown on the plat in SECTION B was plotted from field notes of actual surveys made by me or under my supervision, and that the same is true and correct to the best of my knowledge and belief.

Date Surveyed	<b>12-8-60</b>
Registered Professional Engineer and/or Land Surveyor	<b>J. J. Velten</b>
Certificate No.	<b>8174</b>