

NEW!

OIL CONSERVATION COMM ON  
Santa Fe, New MexicoForm G-101  
Revised (12/1/55)

## NOTICE OF INTENTION TO DRILL

Notice must be given to the District Office of the Oil Conservation Commission and approval obtained before drilling or recompletion begins. If changes in the proposed plan are considered advisable, a copy of this notice showing such changes will be returned to the sender. Submit this notice in QUINTUPLICATE. One copy will be returned following approval. See additional instructions in Rules and Regulations of the Commission. If State Land submit 6 Copies Attach Form G- 128 in triplicate to first 3 copies of form G-101

Hobbs, New Mexico

(Place)

November 28, 1960

(Date)

OIL CONSERVATION COMMISSION  
SANTA FE, NEW MEXICO

Gentlemen:

You are hereby notified that it is our intention to commence the Drilling of a well to be known as  
**Tennessee Gas Transmission Company**

(Company or Operator)

State - Monsanto

(Lease)

Well No. 4, in N The well is

located 660' feet from the south line and 1980' feet from the west line of Section 16, T 25-S, R 32-E, NMPM.

(GIVE LOCATION FROM SECTION LINE) Undesignated Pool, Lea County

If State Land the Oil and Gas Lease is No. E-0789-1

If patented land the owner is.

Address.

We propose to drill well with drilling equipment as follows: Rotary Tools

The status of plugging bond is in effect.

Drilling Contractor Laughlin &amp; Porter Drilling Company

We intend to complete this well in the Delaware Sand formation at an approximate depth of 4800 feet.

## CASING PROGRAM

We propose to use the following strings of Casing and to cement them as indicated:

Size of Hole	Size of Casing	Weight per Foot	New or Second Hand	Depth	Sacks Cement
12 1/4"	8 5/8"	24#	New	370	250
7 7/8"	4 1/2"	9.5#	New	4800	150

If changes in the above plans become advisable we will notify you immediately.

ADDITIONAL INFORMATION (If recompletion give full details of proposed plan of work.)

Approved....., 19.....  
Except as follows:

CIRCULATED BEHIND

CASING.

OIL CONSERVATION COMMISSION

Sincerely yours,

TENNESSEE GAS TRANSMISSION COMPANY

(Company or Operator)

By A. W. Lang

Position District Production Superintendent

Send Communications regarding well to

Name Tennessee Gas Transmission Company

Address P. O. Box 307, Hobbs, New Mexico

# DUPLICATE

## NEW MEXICO CONSERVATION COMMISSION WELL LOCATION AND ACREAGE DEDICATION PLAT

FORM C-128  
Revised 5/1/57

SEE INSTRUCTIONS FOR COMPLETING THIS FORM ON THE REVERSE SIDE

### SECTION A

Operator <b>Tennessee Gas &amp; Trans. Co.</b>		Lease <b>State Monsanto</b>		Well No. <b>4</b>	
Unit Letter <b>N</b>	Section <b>16</b>	Township <b>25 South</b>	Range <b>32 East</b>	County <b>Lea County</b>	
Actual Footage Location of Well: <b>1980</b> feet from the <b>West</b> line and <b>660</b> feet from the <b>South</b> line					
Ground Level Elev. <b>3425.4</b>	Producing Formation <b>Delaware Sand</b>		Pool <b>Undesignated</b>	Dedicated Acreage: <b>40</b> Acres	

1. Is the Operator the only owner in the dedicated acreage outlined on the plat below? YES ☒ NO ☐ ("Owner" means the person who has the right to drill into and to produce from any pool and to appropriate the production either for himself or for himself and another. (55-3-29 (e) NMSA 1935 Comp.)
2. If the answer to question one is "no," have the interests of all the owners been consolidated by communitization agreement or otherwise? YES ☐ NO ☐ If answer is "yes," Type of Consolidation \_\_\_\_\_
3. If the answer to question two is "no," list all the owners and their respective interests below:

Owner	Land Description

### SECTION B

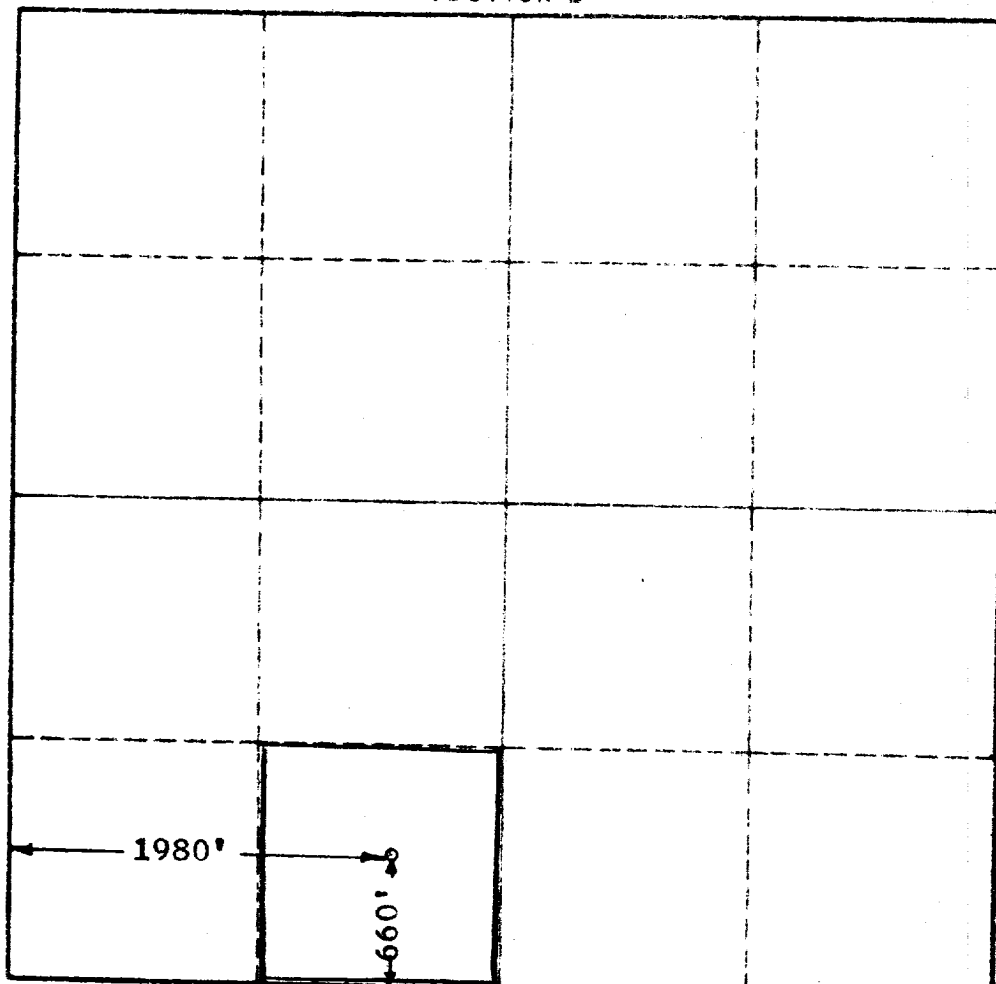

### CERTIFICATION

I hereby certify that the information in SECTION A above is true and complete to the best of my knowledge and belief.

Name: **W. H. Lang**  
 Position: **District Production Supt.**  
 Company: **Tennessee Gas Trans. Co.**  
 Date: **November 28, 1960**

I hereby certify that the well location shown on the plat in SECTION B was plotted from field notes of actual surveys made by me or under my supervision, and that the same is true and correct to the best of my knowledge and belief.

Date Surveyed: 11-28-60  
 Registered Professional Engineer and/or Land Surveyor, **JOHN W. WEST**  
 Certificate No. **676**  
 N. M. - P.E.  
 State of New Mexico

