

APPROVED

MAR 24 1961

COPY TO O. C. 2:

Budget Item 12-12884
Approved

(SUBMIT IN TRIPLICATE)

HOBBS

Land Office New Mexico

Lease No. LC 061869

Unit Cotton Draw

E. W. STANDLEY
DISTRICT ENGINEER

UNITED STATES

DEPARTMENT OF THE INTERIOR

GEOLOGICAL SURVEY

RECEIVED

MAR 24 1961

SUNDRY NOTICES AND REPORTS ON WELLS

U. S. GEOLOGICAL SURVEY
HOBBS, NEW MEXICO

NOTICE OF INTENTION TO DRILL

NOTICE OF INTENTION TO CHANGE PLANS

NOTICE OF INTENTION TO TEST WATER SHUT-OFF

NOTICE OF INTENTION TO REPAIR OR REPAIR WELL

NOTICE OF INTENTION TO SHUT-IN AND

NOTICE OF INTENTION TO PULL OR ALTER CASING

NOTICE OF INTENTION TO ABANDON WELL

☒ SUBSEQUENT REPORT OF WATER SHUT-OFF

SUBSEQUENT REPORT OF SHOOTING OR ACIDIZING

SUBSEQUENT REPORT OF ALTERING CASING

SUBSEQUENT REPORT OF RE-DRILLING OR REPAIR

SUBSEQUENT REPORT OF ABANDONMENT

SUPPLEMENTARY WELL HISTORY

INDICATE ABOVE BY CHECK MARK NATURE OF REPORT, NOTICE, OR OTHER DATA

March 23, 1961

PERRY FEDERAL

Well No. 43 is located 330 ft. from S line and 330 ft. from E line of sec. 20

SE 1/4

T-25-S

R-32-E

N. M. P. M.

Paduca

Lea

New Mexico

*Not yet available. Will be

The elevation of the derrick floor above sea level is * ft. reported when rig is moved in.

DETAILS OF WORK

(State character and extent of proposed work, including size, weights, and lengths of proposed casings; indicate mudding jobs, cementing points, and all other important proposed work)

Propose to drill and complete a well in the upper part of the Delaware Sand at an approximate total depth of 4750'. Approximately 150' of core is to be cut. 8-5/8" OD 24 lb. per ft. grade J-55 casing is to be set in a 12 1/2" hole at 375', and cemented back to the surface with 325 sx. of regular neat cement.

4-1/2" OD new 9.50 #/ft. J-55 casing is to be set in 7-7/8" hole, on bottom, at approximately 4750', and cemented with 165 sx. 50-50 Pozmix 2% gel, followed by 50 sx. of latex cement, to fill approximately 700' between the casing and the drilled hole.

The well will be drilled with rotary tools. Completion will be made by gun-perforating the pay sections, and applying stimulation treatments based on information gained from preliminary natural tests.

Understand that this plan of work must receive approval in writing by the Geological Survey before operations may be commenced

Company PERRY R. BASS

Address Box 1178

Monahans, Texas

Walter D. Powers
Walter D. Powers
Assistant Division Manager

GPO 318507

NEW MEXICO OIL CONSERVATION COMMISSION
WELL LOCATION AND ACREAGE DEDICATION PLAT

FORM C-128
Revised 5/1/57

SEE INSTRUCTIONS FOR COMPLETING THIS FORM ON THE REVERSE SIDE

SECTION A

Operator PERRY R. BASS		Lease PERRY FEDERAL		Well No. 43	
Unit Letter P	Section 20	Township 25 SOUTH	Range 32 EAST	County LEA	
Actual Postage Location of Well: 330 feet from the SOUTH line and 330 feet from the EAST line					
Ground Level Elev. 3369.9	Producing Formation DELEWARE		Pool PADUCCA		Dedicated Acreage: Acres

1. Is the Operator the only owner in the dedicated acreage outlined on the plat below? YES ☒ NO ____ ("Owner" means the person who has the right to drill into and to produce from any pool and to appropriate the production either for himself or for himself and another. (65-3-29 (e) NMSA 1935 Comp.)
2. If the answer to question one is "no," have the interests of all the owners been consolidated by communitization agreement or otherwise? YES ____ NO ____ . If answer is "yes," Type of Consolidation ____
3. If the answer to question two is "no," list all the owners and their respective interests below:

Owner	Land Description

SECTION B

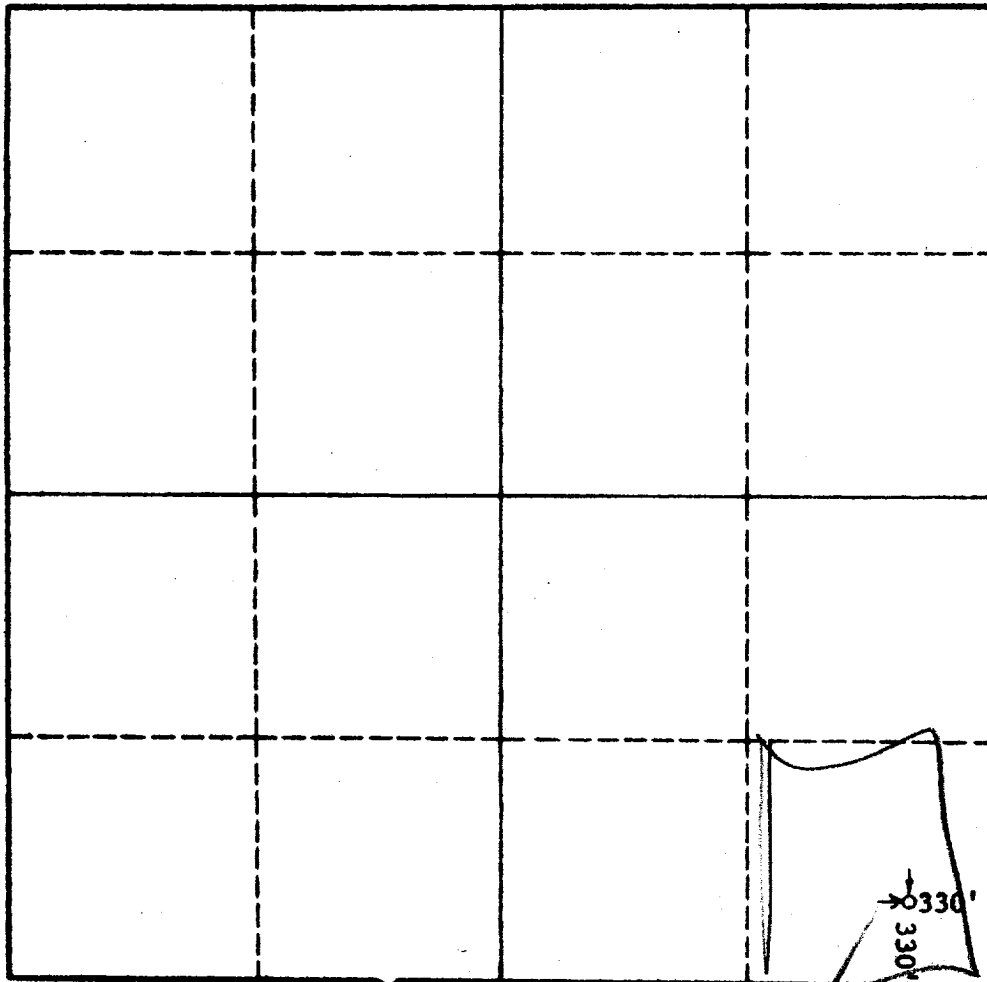

CERTIFICATION

I hereby certify that the information in SECTION A above is true and complete to the best of my knowledge and belief.

Charles H. Sanders
Name

Position
ENGINEER

Company
PERRY R. BASS

Date
3-24-1961

I hereby certify that the well location shown on the plat in SECTION B is plotted from field notes of actual surveys made by me or under my supervision, and that the same is true and correct to the best of my knowledge and belief.

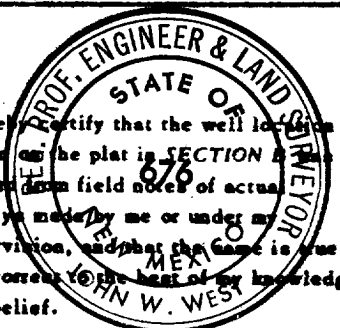

Date Surveyed
3-23-1961

Registered Professional Engineer and/or Land Surveyor, **JOHN W. WEST**

John W. West
Certificate No.
N.M. - P.E. & L.S. NO. 676