

APPROVED

COPY TO  
HOBBS

Approval cap...

Form 9-331a  
(Feb. 1951)

JUN 1 1961

(SUBMIT IN TRIPPLICATE)

E. W. STANDLEY  
DISTRICT ENGINEER

UNITED STATES  
DEPARTMENT OF THE INTERIOR  
GEOLOGICAL SURVEY

1961 JUN 6

Land Office

Lease No. LC-062300

Unit OFFICE 000

MAY 23 1961

SUNDRY NOTICES AND REPORTS ON WELLS

(INDICATE ABOVE BY CHECK MARK NATURE OF REPORT, NOTICE, OR OTHER DATA)	
NOTICE OF INTENTION TO DRILL	XX
NOTICE OF INTENTION TO CHANGE PLANS	
NOTICE OF INTENTION TO TEST WATER SHUT-OFF	
NOTICE OF INTENTION TO RE-DRILL OR REPAIR WELL	
NOTICE OF INTENTION TO SHOOT OR ACIDIZE	
NOTICE OF INTENTION TO PULL OR ALTER CASING	
NOTICE OF INTENTION TO ABANDON WELL	
SUBSEQUENT REPORT OF WATER SHUT-OFF	
SUBSEQUENT REPORT OF SHOOTING OR ACIDIZING	
SUBSEQUENT REPORT OF ALTERING CASING	
SUBSEQUENT REPORT OF RE-DRILLING OR REPAIR	
SUBSEQUENT REPORT OF ABANDONMENT	
SUPPLEMENTARY WELL HISTORY	

Lease No. 186466  
Cotton Draw Unit

THIS WELL IS IN THE COTTON DRAW UNIT  
May 25, 1961

Well No. 50 is located 1980 ft. from <sup>(N)</sup> line and 1980 ft. from <sup>(W)</sup> line of sec. 28

SE/4 NW/4 Sec. 28 T-25-S R-32-E NMPM  
(1/4 Sec. and Sec. No.) (Twp.) (Range) (Meridian)  
Undesignated Lea New Mexico  
(Field) (County or Subdivision) (State or Territory)

The elevation of the derrick floor above sea level is 3383 ft.

DETAILS OF WORK

OBJECTIVE FORMATIONS:  
Top of Anhydrite  
" " Salt  
" " Lamar Lime  
" " Delaware Sand  
Total Depth

SIZE CASING		
790'	24#	New
1190'	7-5/8"	New
4576'	4-1/2"	9.5#
4602'		
4980'		

CASING PROGRAM (APPROX.)	
Set at	Cement
350'	250 sx
4980'	150 sx

(State names of and expected depths to objective sands; show sizes, weights, and lengths of proposed casings; indicate mudding jobs, cementing points, and all other important proposed work)

I understand that this plan of work must receive approval in writing by the Geological Survey before operations may be commenced.

Company TEXACO Inc.  
Address P. O. Box 3109  
Midland, Texas

By J. J. Velten  
Title Division Civil Engineer

GPO 862040

NEW MEXICO OIL CONSERVATION COMMISSION  
WELL LOCATION AND ACREAGE DEDICATION PLAT

FORM C-128  
Revised 5/1/57

SEE INSTRUCTIONS FOR COMPLETING THIS FORM ON THE REVERSE SIDE OF CCC

SECTION A

Operator <b>TEXACO Inc.</b>		Lease <b>COTTON DRAW UNIT G AM 8 24 50</b>		Well No. <b>50</b>
Unit Letter <b>F</b>	Section <b>28</b>	Township <b>25 South</b>	Range <b>32 East</b>	County <b>Lea</b>
Actual Footage Location of Well: <b>1980</b> feet from the <b>North</b> line and <b>1980</b> feet from the <b>West</b> line <b>Sec. 28</b>				
Ground Level Elev. <b>3372</b>	Producing Formation <b>Delaware Sand</b>	Pool <b>Undesignated</b>	Dedicated Acreage: <b>40</b> Acres	

1. Is the Operator the only owner in the dedicated acreage outlined on the plat below? YES \_\_\_\_\_ NO X. ("Owner" means the person who has the right to drill into and to produce from any pool and to appropriate the production either for himself or for himself and another. (65-3-29 (e) NMSA 1935 Comp.)
2. If the answer to question one is "no," have the interests of all the owners been consolidated by communization agreement or otherwise? YES X NO \_\_\_\_\_. If answer is "yes," Type of Consolidation Unitization & Development Agreement
3. If the answer to question two is "no," list all the owners and their respective interests below:

Owner	Land Description

SECTION B

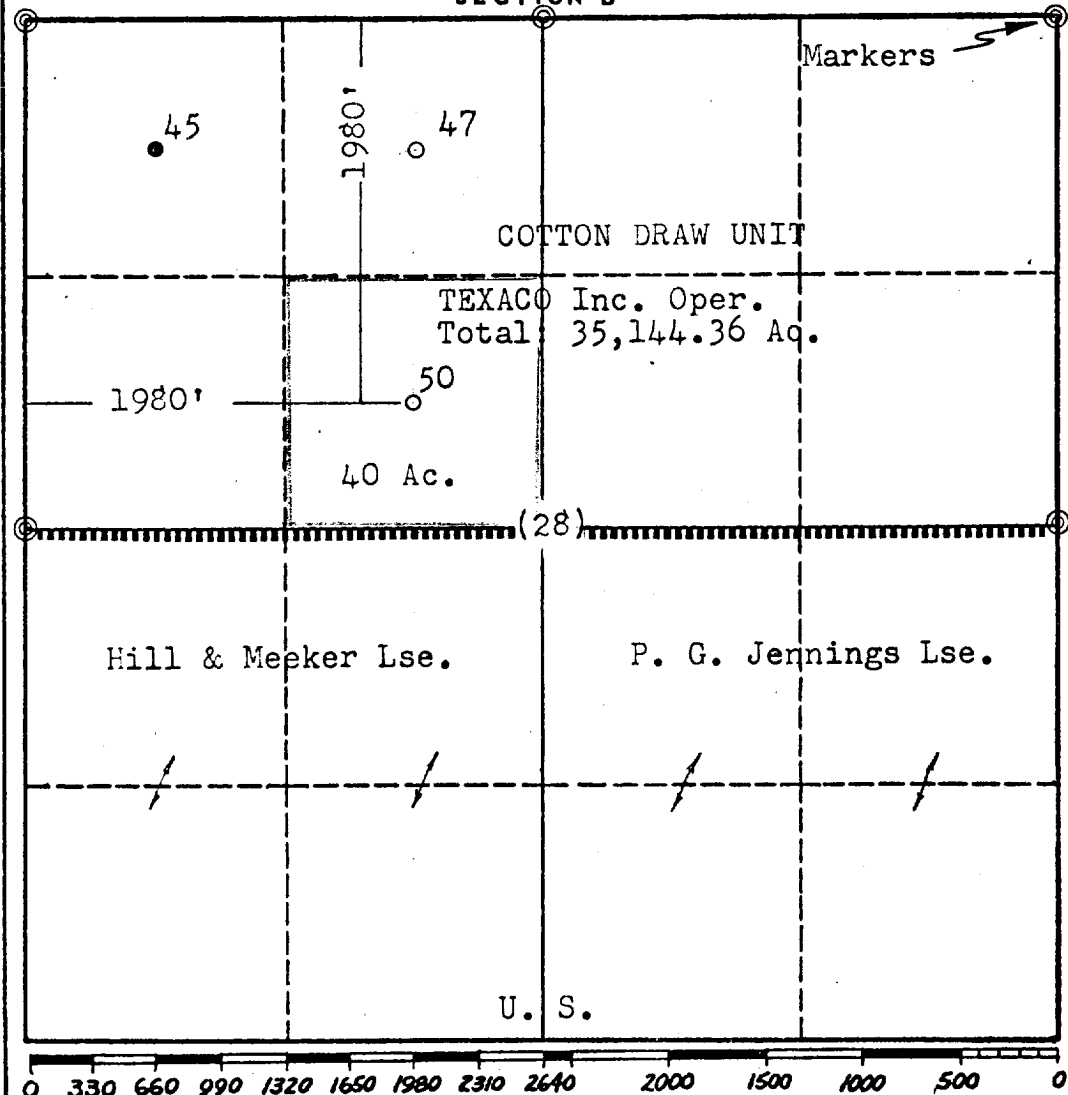

U. S. GEOLOGICAL SURVEY  
HOBBS, NEW MEXICO  
CERTIFICATION

I hereby certify that the information in SECTION A above is true and complete to the best of my knowledge and belief.

Name <b>J. J. Velten</b>
Position <b>Division Civil Engineer</b>
Company <b>TEXACO Inc.</b>
Date <b>5/25/61</b>

I hereby certify that the well location shown on the plat in SECTION B was plotted from field notes of actual surveys made by me or under my supervision, and that the same is true and correct to the best of my knowledge and belief.

Date Surveyed <b>5/19/61</b>
Registered Professional Engineer and/or Land Surveyor <b>J. J. Velten</b>
Certificate No. <b>8174</b>