(SUBMIT IN TRIPLICATE) **HOBBS**

Land Office .....

Lease No. **LC-062300**

Unit .....

UNITED STATES  
DEPARTMENT OF THE INTERIOR  
GEOLOGICAL SURVEY

## SUNDRY NOTICES AND REPORTS ON WELLS

NOTICE OF INTENTION TO DRILL .....	<input checked="" type="checkbox"/> SUBSEQUENT REPORT OF WATER SHUT-OFF .....	
NOTICE OF INTENTION TO CHANGE PLANS .....	SUBSEQUENT REPORT OF SHOOTING OR ACIDIZING .....	
NOTICE OF INTENTION TO TEST WATER SHUT-OFF .....	SUBSEQUENT REPORT OF ALTERING CASING .....	
NOTICE OF INTENTION TO RE-DRILL OR REPAIR WELL .....	SUBSEQUENT REPORT OF RE-DRILLING OR REPAIR .....	
NOTICE OF INTENTION TO SHOOT OR ACIDIZE .....	SUBSEQUENT REPORT OF ABANDONMENT .....	
NOTICE OF INTENTION TO PULL OR ALTER CASING .....	SUPPLEMENTARY WELL HISTORY .....	
NOTICE OF INTENTION TO ABANDON WELL .....		

(INDICATE ABOVE BY CHECK MARK NATURE OF REPORT, NOTICE, OR OTHER DATA)

Lease No. **186466**  
Cotton Draw Unit

April 19, 1961

Well No. **47** is located **660** ft. from **N** line and **1980** ft. from **W** line of sec. **28****NE/4 NW/4 Sec. 28** **T-25-S R-32-E** **NMPM**  
(1/4 Sec. and Sec. No.) (Twp.) (Range) (Meridian)**Undesignated** **Lee** **New Mexico**  
(Field) (County or Subdivision) (State or Territory)The elevation of the derrick floor above sea level is **3392** ft.

## DETAILS OF WORK

(State names of and expected depths to objective sands; show sizes, weights, and lengths of proposed casings; indicate mudlogging jobs, cementing points, and all other important proposed work)

OBJECTIVE FORMATIONS:			SIZE CASING			CASING PROGRAM (APPROX.)	
						Set at	Cement
Top of Anhydrite	755'						
" " Salt	1140'	7-5/8"	24#	New		350'	250 sz
" " Lamar Lime	4550'	4-1/2"	9.5#	New		4960'	150 sz
" " Delaware Sand	4577'						
Total Depth	4960'						

I understand that this plan of work must receive approval in writing by the Geological Survey before operations may be commenced.

Company **TEXACO Inc.** **TEXACO Inc.**Address **P. O. Box 3109****Midland, Texas**By **J. J. Velten**  
Title **Division Civil Engineer**

**NEW MEXICO OIL CONSERVATION COMMISSION**  
**WELL LOCATION AND ACREAGE DEDICATION PLAT**

FORM C-128  
Revised 5/1/57

SEE INSTRUCTIONS FOR COMPLETING THIS FORM ON THE REVERSE SIDE

**SECTION A**

Operator <b>TEXACO Inc.</b>		Lease <b>COTTON DRAW UNIT</b>		Well No. <b>47</b>
Unit Letter <b>C</b>	Section <b>28</b>	Township <b>25 South</b>	Range <b>32 East</b>	County <b>Lea</b>
Actual Footage Location of Well: <b>660</b> feet from the <b>North</b> line and <b>1980</b> feet from the <b>West</b> line Sec. <b>28</b>				
Ground Level Elev. <b>3381</b>	Producing Formation <b>Delaware</b>	Pool <b>Undesignated</b>	Dedicated Acreage: <b>40</b> Acres	

1. Is the Operator the only owner in the dedicated acreage outlined on the plat below? YES \_\_\_\_\_ NO X . ("Owner" means the person who has the right to drill into and to produce from any pool and to appropriate the production either for himself or for himself and another. (65-3-29 (e) NMSA 1935 Comp.)
2. If the answer to question one is "no," have the interests of all the owners been consolidated by communization agreement or otherwise? YES X NO \_\_\_\_\_. If answer is "yes," Type of Consolidation Unitization and Development Agreement
3. If the answer to question two is "no," list all the owners and their respective interests below:

Owner	Land Description

**SECTION B**

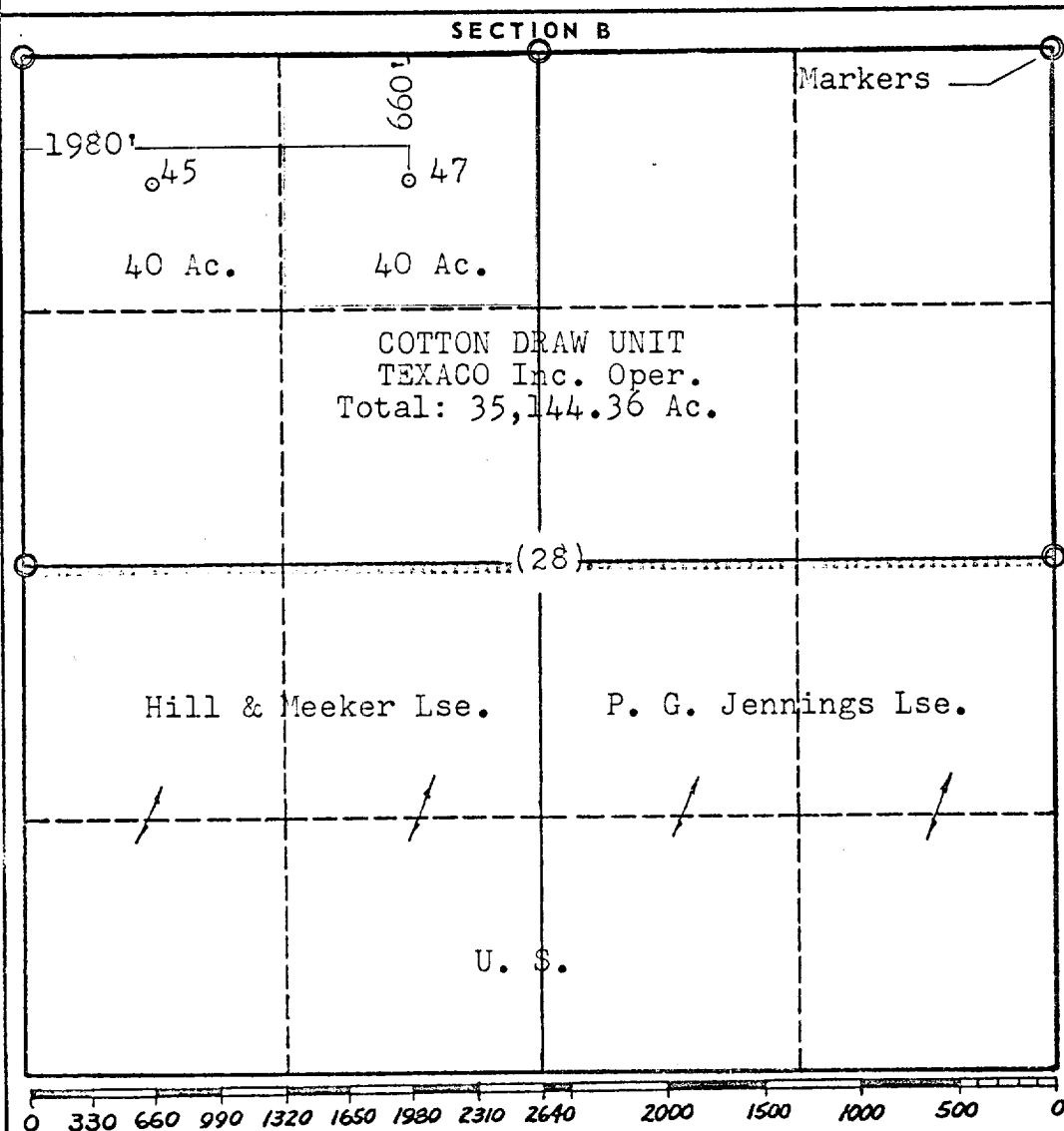

**CERTIFICATION**

I hereby certify that the information in SECTION A above is true and complete to the best of my knowledge and belief.

Name J. J. Velten  
 Position Division Civil Engineer  
 Company TEXACO Inc.  
 Date 4/19/61

I hereby certify that the well location shown on the plat in SECTION B was plotted from field notes of actual surveys made by me or under my supervision, and that the same is true and correct to the best of my knowledge and belief.

Date Surveyed 4/18/61  
 Registered Professional Engineer and/or Land Surveyor J. J. Velten  
 Certificate No. 8174