

APPROVED

Form 9-331a
(Feb. 1951)Budget Bureau No. 42-R358.4.
Approval expires 12-31-60.

AUG 29 1961

(SUBMIT IN TRIPLICATE)

Land Office _____

Lease No. LC-062300

Unit _____

E. W. STANLEY
DISTRICT ENGINEER

UNITED STATES

DEPARTMENT OF THE INTERIOR

GEOLOGICAL SURVEY

1961 SEP 5 AM 9 29

SUNDRY NOTICES AND REPORTS ON WELLS

NOTICE OF INTENTION TO DRILL.....	<input checked="" type="checkbox"/>	SUBSEQUENT REPORT OF WATER SHUT-OFF.....	
NOTICE OF INTENTION TO CHANGE PLANS.....		SUBSEQUENT REPORT OF SHOOTING OR ACIDIZING.....	
NOTICE OF INTENTION TO TEST WATER SHUT-OFF.....		SUBSEQUENT REPORT OF ALTERING CASING.....	
NOTICE OF INTENTION TO RE-DRILL OR REPAIR WELL.....		SUBSEQUENT REPORT OF RE-DRILLING OR REPAIR.....	
NOTICE OF INTENTION TO SHOOT OR ACIDIZE.....		SUBSEQUENT REPORT OF ABANDONMENT.....	
NOTICE OF INTENTION TO PULL OR ALTER CASING.....		SUPPLEMENTARY WELL HISTORY.....	
NOTICE OF INTENTION TO ABANDON WELL.....			

(INDICATE ABOVE BY CHECK MARK NATURE OF REPORT, NOTICE, OR OTHER DATA)

Lease No. 186150
Cotton Draw Unit

August 25, 1961

Well No. 56 is located 660 ft. from [N] line and 950 ft. from [E] line of sec. 28

NE/4 NE/4 Sec. 28 T-25-S 1-NE 10N (Meridian)

Undesignated (Field) New Mexico (State or Territory)

The elevation of the derrick floor above sea level is _____ ft.

DETAILS OF WORK

(State names of and expected depths to objective sands; show sizes, weights, and lengths of proposed casings; indicate mudding jobs, cementing points, and all other important proposed work)

FORMATIONS EXPECTED:		SIZE CASING			CASING PROGRAM (APPROX.)	
					Set at	Cement
Top of Anhydrite	830'					
" " Salt	1205'	7-5/8"	24#	New	350'	250 sx
" " Lamar Line	4587'	4-1/2"	9.5#	New	4980'	150 sx
" " Delaware Sand	4615'					
Total Depth	4980'					

I understand that this plan of work must receive approval in writing by the Geological Survey before operations may be commenced.

Company TEXACO Inc. TEXACO Inc.

Address P. O. Box 3109

Midland, Texas

By J. J. Velten
Title Division Civil Engineer

NEW MEXICO OIL CONSERVATION COMMISSION
WELL LOCATION AND ACREAGE DEDICATION PLAT

FORM C-128
Revised 5/1/57

SEE INSTRUCTIONS FOR COMPLETING THIS FORM ON THE REVERSE SIDE

SECTION A

Operator TEXACO Inc.			Lease COTTON DRAW UNIT		1961 SEP 5	Well No. 28
Unit Letter A	Section 28	Township 25 South	Range 32 East	County Lea		
Actual Footage Location of Well: 660 feet from the North line and 990 feet from the East line Sec. 28						
Ground Level Elev.	Producing Formation Delaware Sand		Pool Undesignated		Dedicated Acreage: 40 Acres	

1. Is the Operator the only owner in the dedicated acreage outlined on the plat below? YES _____ NO X . ("Owner" means the person who has the right to drill into and to produce from any pool and to appropriate the production either for himself or for himself and another. (65-3-29 (e) NMSA 1935 Comp.)
2. If the answer to question one is "no," have the interests of all the owners been consolidated by communitization agreement or otherwise? YES X NO _____. If answer is "yes," Type of Consolidation Unitization & Development Agreement
3. If the answer to question two is "no," list all the owners and their respective interests below:

Owner	Land Description

SECTION B

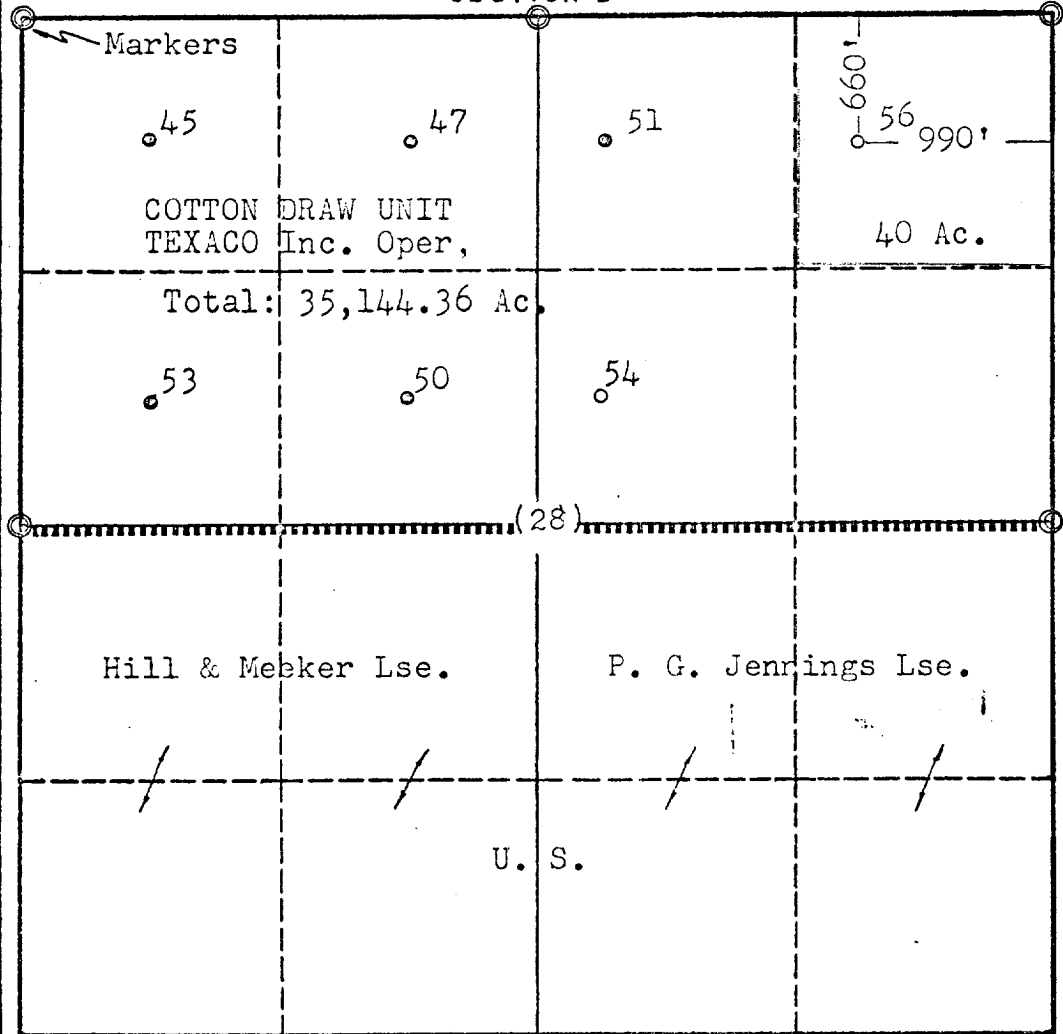

CERTIFICATION

I hereby certify that the information in SECTION A above is true and complete to the best of my knowledge and belief.

Name J. J. Velten
 Position Division Civil Engineer
 Company TEXACO Inc.
 Date 8/25/61

I hereby certify that the well location shown on the plat in SECTION B was plotted from field notes of actual surveys made by me or under my supervision, and that the same is true and correct to the best of my knowledge and belief.

Date Surveyed 8/25/61
 Registered Professional Engineer and/or Land Surveyor J. J. Velten
 Certificate No. 8174

0 330 660 990 1320 1650 1980 2310 2640 2000 1500 1000 500 0