

OCT 18 1961

(SUBMIT IN TRIPLICATE)

D. W. STANLEY
DISTRICT ENGINEERUNITED STATES
DEPARTMENT OF THE INTERIOR
GEOLOGICAL SURVEY

OCT 17 AM 8 45

Land Office

Lease No. LC-062300

Unit

R

OCT 18 1961

SUNDRY NOTICES AND REPORTS ON WELLS

U. S. GEOLOGICAL SURVEY

HOBBS, NEW MEXICO

NOTICE OF INTENTION TO DRILL.....	XXX	SUBSEQUENT REPORT OF WATER SHUT-OFF.....	
NOTICE OF INTENTION TO CHANGE PLANS.....		SUBSEQUENT REPORT OF SHOOTING OR ACIDIZING.....	
NOTICE OF INTENTION TO TEST WATER SHUT-OFF.....		SUBSEQUENT REPORT OF ALTERING CASING.....	
NOTICE OF INTENTION TO RE-DRILL OR REPAIR WELL.....		SUBSEQUENT REPORT OF RE-DRILLING OR REPAIR.....	
NOTICE OF INTENTION TO SHOOT OR ACIDIZE.....		SUBSEQUENT REPORT OF ABANDONMENT.....	
NOTICE OF INTENTION TO PULL OR ALTER CASING.....		SUPPLEMENTARY WELL HISTORY.....	
NOTICE OF INTENTION TO ABANDON WELL.....			

(INDICATE ABOVE BY CHECK MARK NATURE OF REPORT, NOTICE, OR OTHER DATA)

Lease No. 186150
Cotton Draw Unit

October 13, 1961

Well No. 59 is located 1650 ft. from ^[N]~~154~~ line and 990 ft. from ^[E]~~W~~ line of sec. 28SE/4 NE/4 Sec. 28 T-25-S R-32-E NMPM
($\frac{3}{4}$ Sec. and Sec. No.) (Twp.) (Range) (Meridian)Undesignated Lea New Mexico
(Field) (County or Subdivision) (State or Territory)

The elevation of the derrick floor above sea level is 3386 ft.

DETAILS OF WORK

(State names of and expected depths to objective sands; show sizes, weights, and lengths of proposed casings; indicate mudding jobs, cementing points, and all other important proposed work)

FORMATIONS EXPECTED:	SIZE	CASING	CASING PROGRAM (APPROX.)
Top of Anhydrite	775'		Set at Cement
" " Salt	1140'	7-5/8" 24# New	350' 250 sx
" " Lamar Lime	4580'	4-1/2" 9.5# New	4955' 150 sx
" " Delaware Sd.	4604'		
Total Depth	4955'		

I understand that this plan of work must receive approval in writing by the Geological Survey before operations may be commenced.

Company TEXACO Inc. TEXACO Inc.

Address P. O. Box 3109

Midland, Texas

By J. J. Velten

Title Division Civil Engineer

NEW MEXICO OIL CONSERVATION COMMISSION
WELL LOCATION AND ACREAGE DEDICATION PLAT

FORM C-120
 Revised 5/1/57

SEE INSTRUCTIONS FOR COMPLETING THIS FORM ON THE REVERSE SIDE

Operator TEXACO Inc.		Lease COTTON DRAW UNIT		Well No. 59
Unit Letter H	Section 28	Township 25 South	Range 32 East	County Lea
Actual Footage Location of Well: 1650 feet from the North line and 990 feet from the East line Sec. 28				
Ground Level Elev. 3375	Producing Formation Delaware Sand	Pool Undesignated	Dedicated Acreage: 40 Acres	

1. Is the Operator the only owner in the dedicated acreage outlined on the plat below? YES _____ NO X. ("Owner" means the person who has the right to drill into and to produce from any pool and to appropriate the production either for himself or for himself and another. (65-3-29 (e) NMSA 1935 Comp.)
2. If the answer to question one is "no," have the interests of all the owners been consolidated by communitization agreement or otherwise? YES X NO _____. If answer is "yes," Type of Consolidation Unitization & Development Agreement
3. If the answer to question two is "no," list all the owners and their respective interests below:

Owner	Land Description

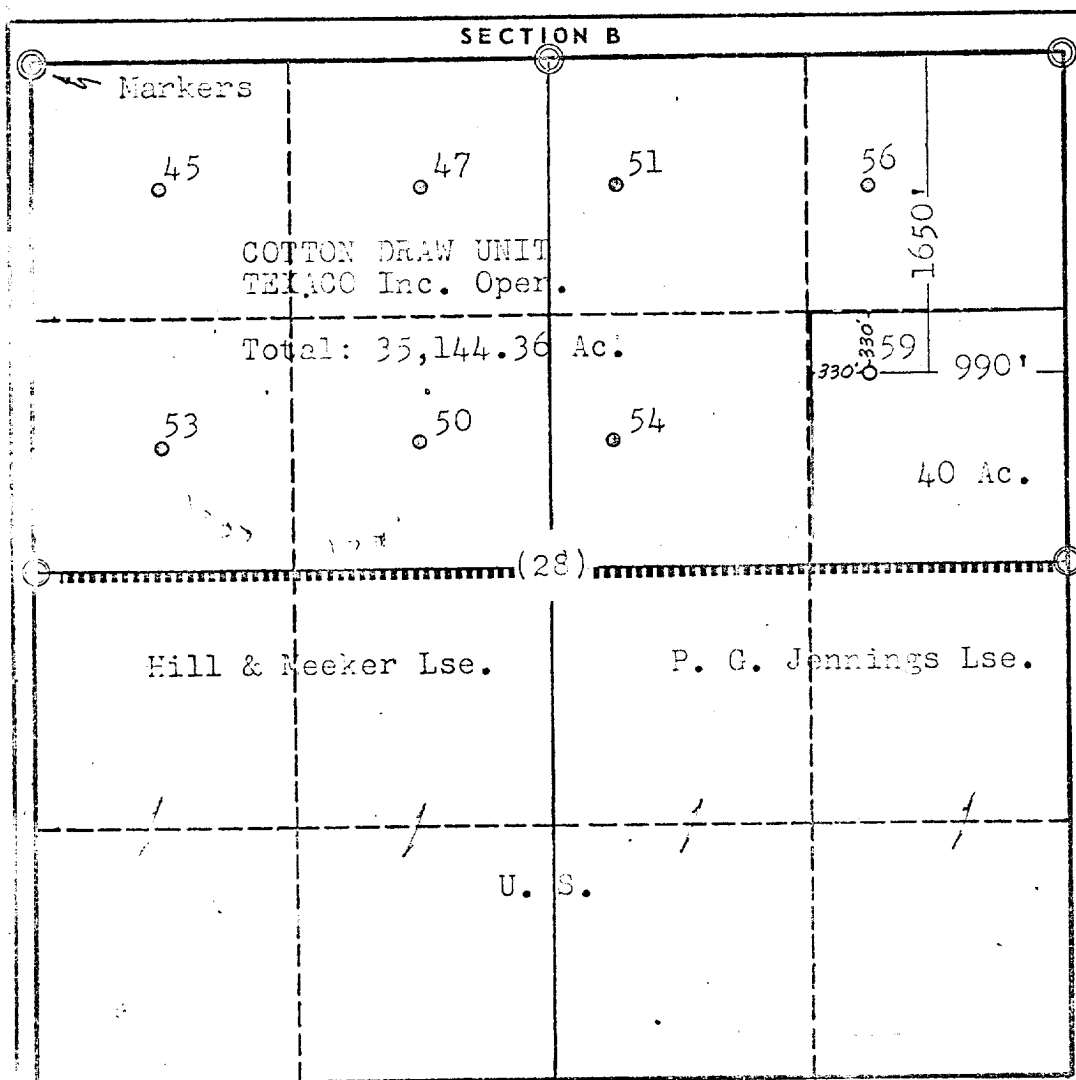

CERTIFICATION

I hereby certify that the information in SECTION A above is true and complete to the best of my knowledge and belief.

Name J. J. Velten
Position Division Civil Engineer
Company TEXACO Inc.
Date 10/13/61

I hereby certify that the well location shown on the plat in SECTION B was plotted from field notes of actual surveys made by me or under my supervision, and that the same is true and correct to the best of my knowledge and belief.

Date Surveyed 10/12/61
Registered Professional Engineer and/or Land Surveyor J. J. Velten
Certificate No. 8174

0 330 660 990 1320 1650 1980 2310 2640 2000 1500 1000 500 0