

APPROVED

COPY TO C. C. C.

Form 9-331a
(Feb. 1951)

AUG 17 1961

HOBBS

Budget Bureau No. 42-R358.4
Approval expires 12-31-60.

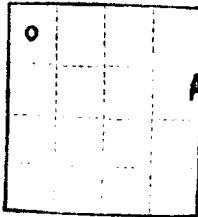

J.L.G.
J.L. GORDON
ACTING DISTRICT ENGINEER
UNITED STATES
DEPARTMENT OF THE INTERIOR
GEOLOGICAL SURVEY

Land Office **New Mexico**

Lease No. **05906**

Unit **Wildcat**

RECEIVED

AUG 16 1961

SUNDRY NOTICES AND REPORTS ON WELLS

NOTICE OF INTENTION TO DRILL	<input checked="" type="checkbox"/>	SUBSEQUENT REPORT OF WATER SHUT-OFF
NOTICE OF INTENTION TO CHANGE PLANS	<input type="checkbox"/>	SUBSEQUENT REPORT OF SHOOTING OR ACIDIZING
NOTICE OF INTENTION TO TEST WATER SHUT-OFF	<input type="checkbox"/>	SUBSEQUENT REPORT OF ALTERING CASING
NOTICE OF INTENTION TO RE-DRILL OR REPAIR WELL	<input type="checkbox"/>	SUBSEQUENT REPORT OF RE-DRILLING OR REPAIR
NOTICE OF INTENTION TO SHOOT OR ACIDIZE	<input type="checkbox"/>	SUBSEQUENT REPORT OF ABANDONMENT
NOTICE OF INTENTION TO PULL OR ALTER CASING	<input type="checkbox"/>	SUPPLEMENTARY WELL HISTORY
NOTICE OF INTENTION TO ABANDON WELL	<input type="checkbox"/>	

(INDICATE ABOVE BY CHECK MARK NATURE OF REPORT, NOTICE, OR OTHER DATA.)

August 16, 1961

FEDERAL MUSE

Well No. **1** is located **660** ft. from **N** line and **660** ft. from **W** line of sec. **1**

NW 1

(1/4 Sec. and Sec. No.)

T-25-S

(Twp.)

R-33-E

(Range)

N.M.P.M.

(Meridian)

WILDCAT

(Field)

Lea

(County or Subdivision)

New Mexico

(State or Territory)

The elevation of the derrick floor above sea level is * **Not yet available. Will be furnished when rig is moved in.**

DETAILS OF WORK

(State names of and expected depths to objective sands; show sizes, weights, and lengths of proposed casings; indicate mudding jobs, cementing points, and all other important proposed work.)

Propose to drill and complete a well in the upper part of the Delaware Sand at an approximate total depth of 5300'.

7-5/8" OD 29 #/ft. N-80 LT&C used casing is to be set in a 12 1/4" hole at 375' with 350 sx. regular neat cement.

4 1/2" OD 9.50 #/ft. J-55 new casing is to be set in 6-3/4" hole, on bottom, at approximately 5300', and cemented with 100 sx. 50-50 Pozmix 2% gel, followed by 50 sx. of regular cement containing 0.9 gal. latex per sack; said cement volumes to be adjusted, if necessary, to bring cement up into the salt section.

The well is to be drilled with rotary tools. Completion will be made by gun-perforating the pay sections and applying stimulation treatments based on information gained from preliminary testing.

I understand that this plan of work must receive approval in writing by the Geological Survey before operations may be commenced.

Company **PERRY R. BASS**

Address **Box 1178**

Monahans, Texas

By

Walter D. Powers
Walter D. Powers

Title **Assistant Division Manager**

NEW MEXICO OIL CONSERVATION COMMISSION
WELL LOCATION AND ACREAGE DEDICATION PLAT

FORM C-128
Revised 5/1/57

MOBBS OFFICE 000

SEE INSTRUCTIONS FOR COMPLETING THIS FORM ON THE REVERSE SIDE

SECTION A

Operator PERRY R. BASS		Lease FED. MUSE		Well No. 1	
Unit Letter D	Section 1	Township 25 SOUTH	Range 33 East	County LEA	
Actual Footage Location of Well: 660 feet from the NORTH line and 660 feet from the WEST line					
Ground Level Elev.	Producing Formation DELEWARE		Pool WILDCAT	Dedicated Acreage: 40 (NWNWN) Acres	

1. Is the Operator the only owner in the dedicated acreage outlined on the plat below? YES ☒ NO ____ . ("Owner" means the person who has the right to drill into and to produce from any pool and to appropriate the production either for himself or for himself and another. (65-3-29 (e) NMSA 1935 Comp.)
2. If the answer to question one is "no," have the interests of all the owners been consolidated by communitization agreement or otherwise? YES ____ NO ____ . If answer is "yes," Type of Consolidation ____
3. If the answer to question two is "no," list all the owners and their respective interests below:

Owner	Land Description

SECTION B

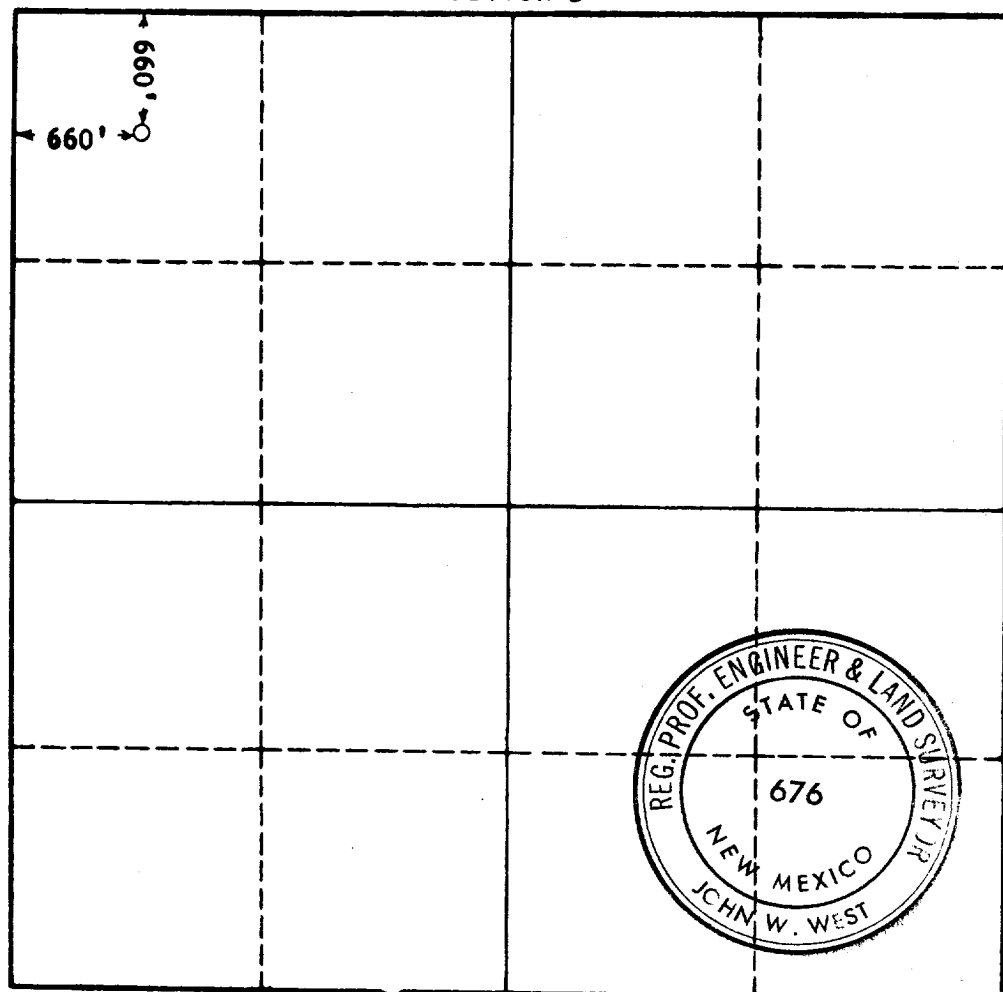

CERTIFICATION

I hereby certify that the information in SECTION A above is true and complete to the best of my knowledge and belief.

Name <i>Charles W. Sander</i>
Position ENGINEER
Company PERRY R. BASS
Date 8-16-1961

I hereby certify that the well location shown on the plat in SECTION B was plotted from field notes of actual surveys made by me or under my supervision, and that the same is true and correct to the best of my knowledge and belief.

Date Surveyed 8-16-1961
Registered Professional Engineer and/or Land Surveyor, JOHN W. WEST
Certificate No. <i>John W. West</i>
N.M. - P.E. & L.S. NO. 676

