

(SUBMIT IN TRIPLICATE)

UNITED STATES
DEPARTMENT OF THE INTERIOR
GEOLOGICAL SURVEY

Land Office Las Cruces
Lease No. LC 061399 A
Unit _____

SUNDRY NOTICES AND REPORTS ON WELLS

NOTICE OF INTENTION TO DRILL.....*	SUBSEQUENT REPORT OF WATER SHUT-OFF.....
NOTICE OF INTENTION TO CHANGE PLANS.....	SUBSEQUENT REPORT OF SHOOTING OR ACIDIZING.....
NOTICE OF INTENTION TO TEST WATER SHUT-OFF.....	SUBSEQUENT REPORT OF ALTERING CASING.....
NOTICE OF INTENTION TO RE-DRILL OR REPAIR WELL.....	SUBSEQUENT REPORT OF RE-DRILLING OR REPAIR.....
NOTICE OF INTENTION TO SHOOT OR ACIDIZE.....	SUBSEQUENT REPORT OF ABANDONMENT.....
NOTICE OF INTENTION TO PULL OR ALTER CASING.....	SUPPLEMENTARY WELL HISTORY.....
NOTICE OF INTENTION TO ABANDON WELL.....	

(INDICATE ABOVE BY CHECK MARK NATURE OF REPORT, NOTICE, OR OTHER DATA)

Ethel Helen Federal _____, 19____

Well No. 1 is located 1980 ft. from N line and 1980 ft. from W line of sec. 21

SW/4 Sec. 21 (1/4 Sec. and Sec. No.) 25S (Twp.) 34E (Range) 10N (Meridian)
Delaware Sand (Field) Lea (County or Subdivision) New Mexico (State or Territory)

The elevation of the derrick floor above sea level is _____ ft.

DETAILS OF WORK

(State names of and expected depths to objective sands; show sizes, weights, and lengths of proposed casings; indicate mudding jobs, cementing points, and all other important proposed work)

It is intended to drill a well with rotary tools at the above location to an approximated TD of 5500'. Casing will be cemented in accordance with GSS standards and other special requirements will be complied with.

The following casing pattern is planned: 10 3/4" OD casing to set at 925' with 1000 sacks cement, cement to be circulated to surface; and 7" OD casing to be set at 5500' with 350 sacks cement. Depths and number of sacks of cement are approximate. Exact amount of cement will be determined by caliper survey.

Approval to produce this well upon completion is also requested.

I understand that this plan of work must receive approval in writing by the Geological Survey before operations may be commenced.

Company Continental Oil Company

Address Box 68

Maricopa, New Mexico

By [Signature]

Title District Superintendent

NEW MEXICO
OIL CONSERVATION COMMISSION

Form C-128

Well Location and/or Gas Proration Plat

Date FEB. 7 1956

Operator CONTINENTAL OIL CO.

Lease ETHEL NOLEN FEDERAL

Well No. 1 Section 21 Township 25S Range 34E NMPM

Located 1980 Feet From SOUTH Line, 1980 Feet From WEST Line,

LEA

County, New Mexico. G. L. Elevation _____

Name of Producing Formation _____ Pool _____ Dedicated Acreage _____

(Note: All distances must be from outer boundaries of Section)

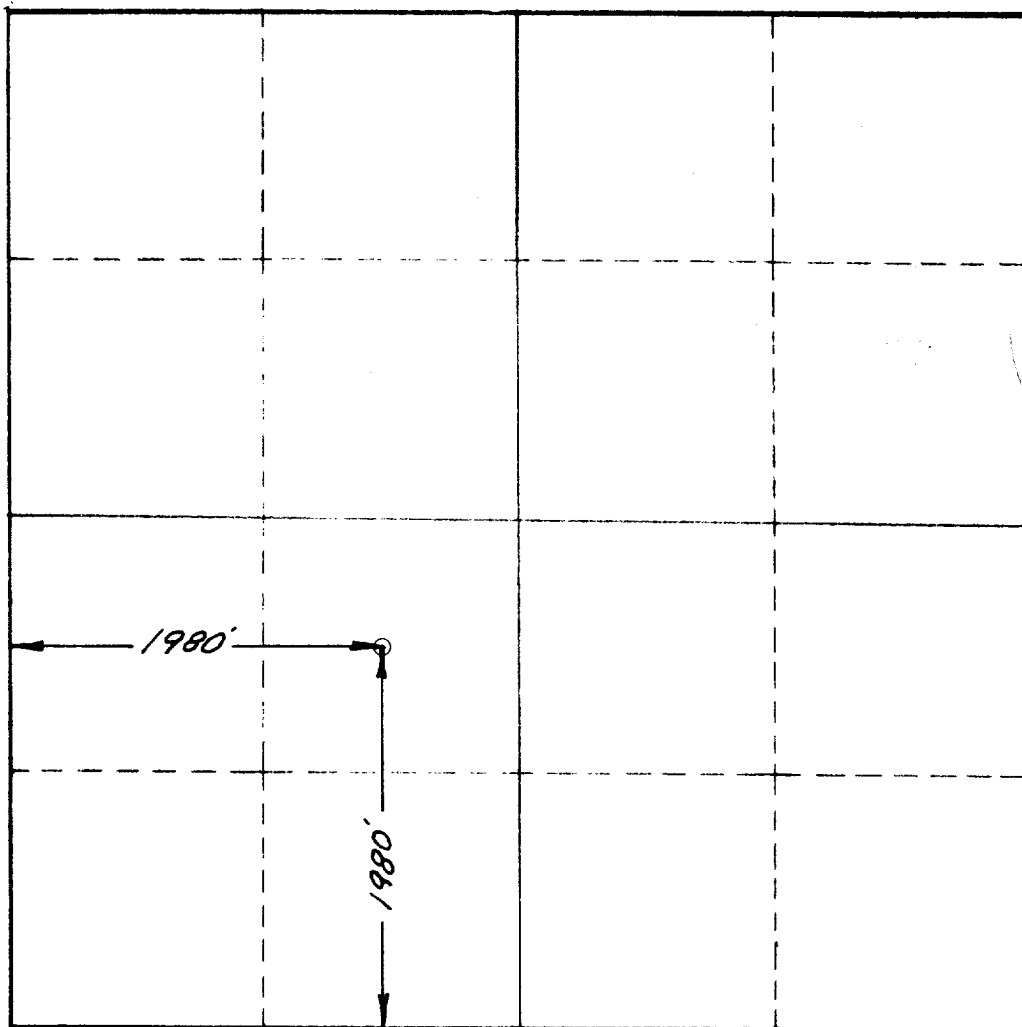

SCALE: 1" = 1000'

1. Is this Well a Dual Comp.? Yes ___ No ___
2. If the answer to Question 1 is yes, are there any other dually completed wells within the dedicated acreage? Yes ___ No ___

This is to certify that the above plat was prepared from field notes of actual surveys made by me or under my supervision and that the same are true and correct to the best of my knowledge and belief.

Name _____
Position _____
Representing _____
Address _____

Date Surveyed FEB. 7, 1956

John W. West
Registered Professional Engineer and/or
Land Surveyor