

UNITED STATES
DEPARTMENT OF THE INTERIOR
BUREAU OF LAND MANAGEMENT

APPLICATION FOR PERMIT TO DRILL, DEEPEN, OR PLUG BACK

1A. TYPE OF WORK

DRILL ☐

DEEPEN ☐

PLUG BACK ☒

B. TYPE OF WELL

OIL
WELL ☒

GAS
WELL ☐

OTHER

SINGLE
ZONE ☒

MULTIPLE
ZONE ☐

2. NAME OF OPERATOR

Amoco Production Company

3. ADDRESS OF OPERATOR

P. O. Box 3092, Houston, TX 77253

4. LOCATION OF WELL (Report location clearly and in accordance with any State requirements.*)

At surface 1980 FNL X 660 Fel

(Unit H, SE/4, NE/4)

At proposed prod. zone

14. DISTANCE IN MILES AND DIRECTION FROM NEAREST TOWN OR POST OFFICE*

5 miles north of Jal, NM

15. DISTANCE FROM PROPOSED*

LOCATION TO NEAREST
PROPERTY OR LEASE LINE, FT.
(Also to nearest drlg. unit line, if any)

660'

16. NO. OF ACRES IN LEASE

19. PROPOSED DEPTH

11,150

17. NO. OF ACRES ASSIGNED
TO THIS WELL

40

20. ROTARY OR CABLE TOOLS

Rotary

21. ELEVATIONS (Show whether DF, RT, GR, etc.)

3247 DF

22. APPROX. DATE WORK WILL START*

1-20-90

23. PROPOSED CASING AND CEMENTING PROGRAM

SIZE OF HOLE	SIZE OF CASING	WEIGHT PER FOOT	SETTING DEPTH	QUANTITY OF CEMENT
17 1/2	13 3/8	36	318	400 SX
12 1/4	9 5/8	36, 32.3	3801	625 SX
8 3/4	7	23, 29	10426	1319 SX

1. Pull out of hole with production tubing and equipment. Inspect and repair as necessary.
2. Run in hole with cast iron bridge plug on wireline above Silurian perforations and set bridge plug at approximately 6900 feet. (Top Silurian perforations at 6960 feet.)
3. Cap bridge plug with 35 feet of cement using dump bailer. Tag cement to check plug back total depth at approximately 6865 feet.
4. Run 4 inch casing gun and perforate 4 shots per foot from 6115'-45', 6216'-46', 6255'-6315'.
5. Run in hole with work string and packer. Acidize pay with 50 gallons/foot 15% NE HCL containing 1 gallon/1000 gallon WA-211; 2 gallon/1000 gallon WA-212.
6. Pull packer to 6000 feet and flush perforations with 60 barrels clean water.
7. Release packer and pull out of hole. Run rods and pump and rig down service unit.
8. Install pumping unit and return to production.

IN ABOVE SPACE DESCRIBE PROPOSED PROGRAM: If proposal is to deepen or plug back, give data on present productive zone and proposed new productive zone. If proposal is to drill or deepen directionally, give pertinent data on subsurface locations and measured and true vertical depths. Give blowout preventer program, if any.

Room 20.164

713-584-7213

24.

SIGNED H. I. Black (H.I. Black)

TITLE Staff Administrative Analyst DATE 1-10-90

(This space for Federal or State office use)

PERMIT NO. _____

APPROVAL DATE _____

APPROVED BY _____

TITLE _____

DATE 1-18-90

CONDITIONS OF APPROVAL, IF ANY: _____

*See Instructions On Reverse Side

RECEIVED

JAN 18 1990

OCD
HOBBS OFFICE

W MEXICO OIL CONSERVATION COMMISSION
WELL LOCATION AND ACREAGE DEDICATION AT

Form C-102
Supersedes C-1
Effective 1-1-65

All distances must be from the outer boundaries of the Section.

Operator Amoco Production Company			Lease South Mattix Unit		Well No. 5
Unit Letter H	Section 22	Township 24-S	Range 37-E	County Lea	
Actual Footage Location of Well:					
1980 feet from the North line and		660 feet from the East line			
Ground Level Elev. 3255	Producing Formation DRINKARD		Pool Fowler	Dedicated Acreage 40 Acres	

1. Outline the acreage dedicated to the subject well by colored pencil or hatchure marks on the plat below.
2. If more than one lease is dedicated to the well, outline each and identify the ownership thereof (both as to working interest and royalty).
3. If more than one lease of different ownership is dedicated to the well, have the interests of all owners been consolidated by communitization, unitization, force-pooling, etc?

☐ Yes ☐ No If answer is "yes," type of consolidation _____

If answer is "no," list the owners and tract descriptions which have actually been consolidated. (Use reverse side of this form if necessary.) _____

No allowable will be assigned to the well until all interests have been consolidated (by communitization, unitization, forced-pooling, or otherwise) or until a non-standard unit, eliminating such interests, has been approved by the Commission.

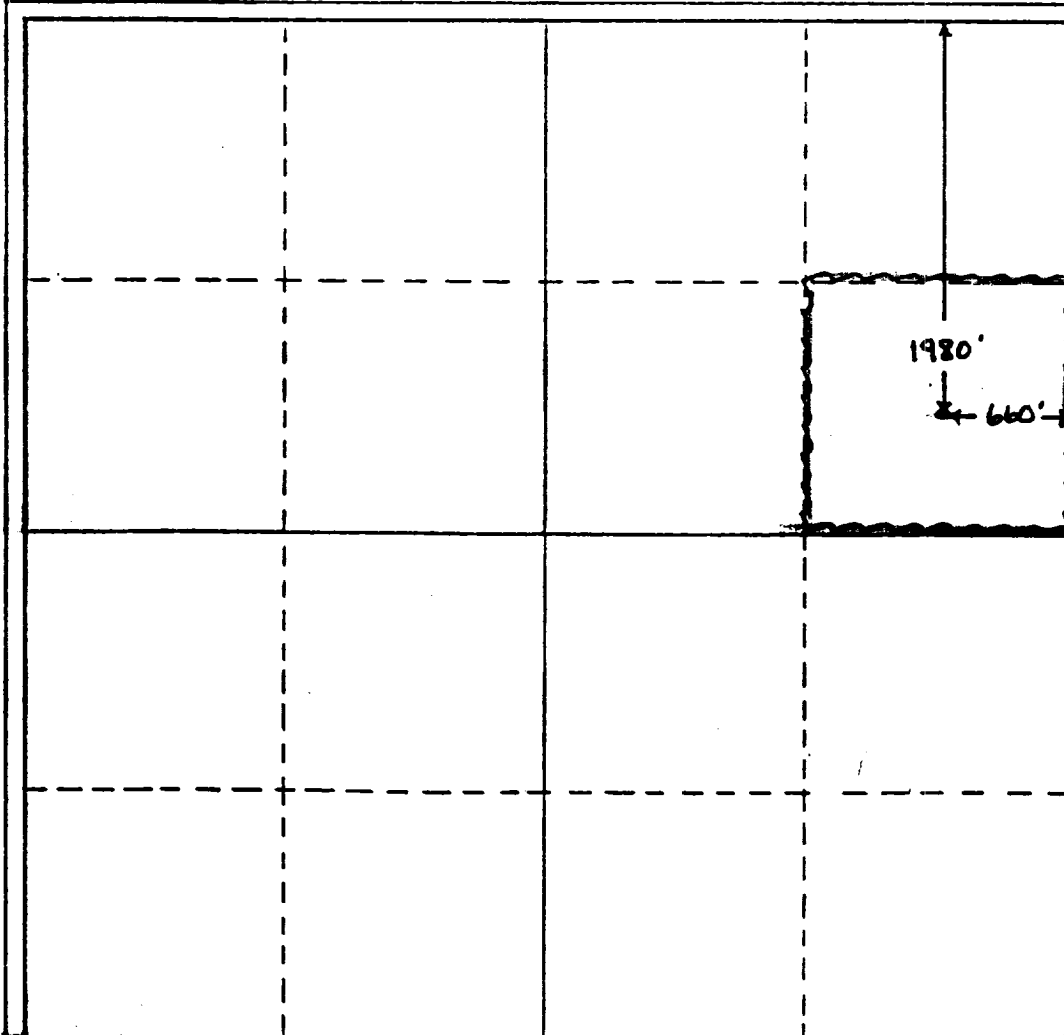

CERTIFICATION

I hereby certify that the information contained herein is true and complete to the best of my knowledge and belief.

Name H. J. Blinn
Position Stf. Admin. Analyst
Company Amoco Production Company

Date January 10, 1990

I hereby certify that the well location shown on this plat was plotted from field notes of actual surveys made by me or under my supervision, and that the same is true and correct to the best of my knowledge and belief.

Date Surveyed _____

Registered Professional Engineer and/or Land Surveyor _____

0 330 660 990 1320 1650 1980 2310 2640 2970 3300 3630 3960 4290 4620 4950 5280 5610 5940 6270 6600

