

4/88

# Memo

*From*

**EVELYN DOWNS**  
*Oil Conservation Staff  
Specialist*

*To* Maurice Mitchell

Re: South Mattix Unit Fed. #5-H & 22-24-37  
South Mattix Unit Fed #15-A 22-24-37

Both the above-referenced wells were recompleted to the Fowler Upper Silurian. This pool is an oil pool but we are recommending it be reclassified as a gas pool.

This will require that your wells have 320 acres dedicated and the location of the #15 well will be non-standard regardless of which portion of the section is dedicated. The #5 well location will be OK if you dedicate the E/2 of the section. You will need to request approval of a NSL for #15 and simultaneous dedication of the acreage to both wells.

This reclassification is set for the May 11th hearing .  
Case #9375.

**Oil Conservation Division**  
**PO Box 1980, Hobbs, New Mexico 88240**

NEW MEXICO OIL CONSERVATION COMMISSION  
WELL LOCATION AND ACREAGE DEDICATION PLAT

Form C-102  
Supersedes C-128  
Effective 1-1-65

All distances must be from the outer boundaries of the Section.

Operator Amoco Production Company			Lease South Mattix Unit <i>212</i>		Well No. 5
Unit Letter H	Section 22	Township 24-S	Range 37-E	County Lea	
Actual Footage Location of Well:					
1980 feet from the North line and		660 feet from the East line			
Ground Level Elev. 3255	Producing Formation Upper Silurian		Pool Fowler	Dedicated Acreage: 40 Acres	

1. Outline the acreage dedicated to the subject well by colored pencil or hachure marks on the plat below.
2. If more than one lease is dedicated to the well, outline each and identify the ownership thereof (both as to working interest and royalty).
3. If more than one lease of different ownership is dedicated to the well, have the interests of all owners been consolidated by communitization, unitization, force-pooling, etc?

☐ Yes ☐ No If answer is "yes," type of consolidation \_\_\_\_\_

If answer is "no," list the owners and tract descriptions which have actually been consolidated. (Use reverse side of this form if necessary.) \_\_\_\_\_

No allowable will be assigned to the well until all interests have been consolidated (by communitization, unitization, forced-pooling, or otherwise) or until a non-standard unit, eliminating such interests, has been approved by the Commission.

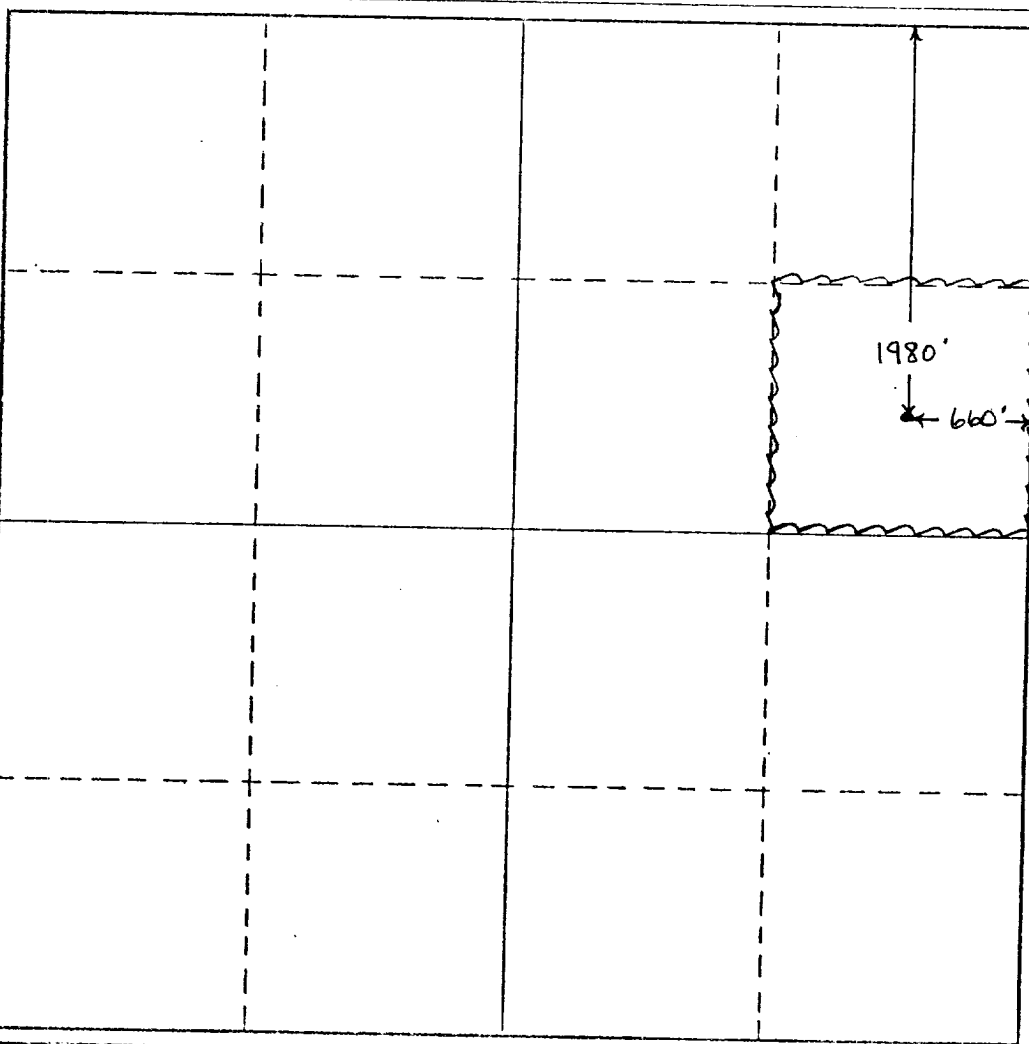

CERTIFICATION

I hereby certify that the information contained herein is true and complete to the best of my knowledge and belief.

Name  
*Maurice S. Nicholls*  
Position  
Sr. Admin. Analyst  
Company  
Amoco Production Company  
Date  
10/7/87

I hereby certify that the well location shown on this plat was plotted from field notes of actual surveys made by me or under my supervision, and that the same is true and correct to the best of my knowledge and belief.

Date Surveyed

Registered Professional Engineer and/or Land Surveyor

Certificate No.

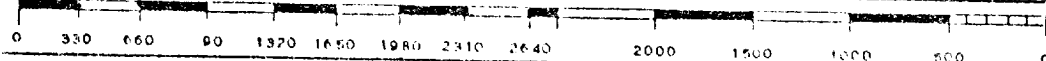

**NEW MEXICO OIL CONSERVATION COMMISSION  
WELL LOCATION AND ACREAGE DEDICATION PLAT**

Form C-102  
Supersedes C-128  
Effective 1-1-65

All distances must be from the outer boundaries of the Section.

Operator <b>Amoco Production Company</b>			Lease <b>South Mattix Unit</b> <i>Lea</i>		Well No. <b>5</b>
Unit Letter <b>H</b>	Section <b>22</b>	Township <b>24-S</b>	Range <b>37-E</b>	County <b>Lea</b>	
Actual Footage Location of Well:					
<b>1980</b>	feet from the	<b>North</b>	line and	<b>660</b>	feet from the <b>East</b> line
Ground Level Elev. <b>3255</b>	Producing Formation <b>Upper Silurian</b>		Pool <b>Fowler</b>	Dedicated Acreage <b>40</b> Acres	

1. Outline the acreage dedicated to the subject well by colored pencil or hachure marks on the plat below.
2. If more than one lease is dedicated to the well, outline each and identify the ownership thereof (both as to working interest and royalty).
3. If more than one lease of different ownership is dedicated to the well, have the interests of all owners been consolidated by communitization, unitization, force-pooling, etc?

☐ Yes    ☐ No    If answer is "yes," type of consolidation \_\_\_\_\_

If answer is "no," list the owners and tract descriptions which have actually been consolidated. (Use reverse side of this form if necessary.) \_\_\_\_\_

No allowable will be assigned to the well until all interests have been consolidated (by communitization, unitization, forced-pooling, or otherwise) or until a non-standard unit, eliminating such interests, has been approved by the Commission.

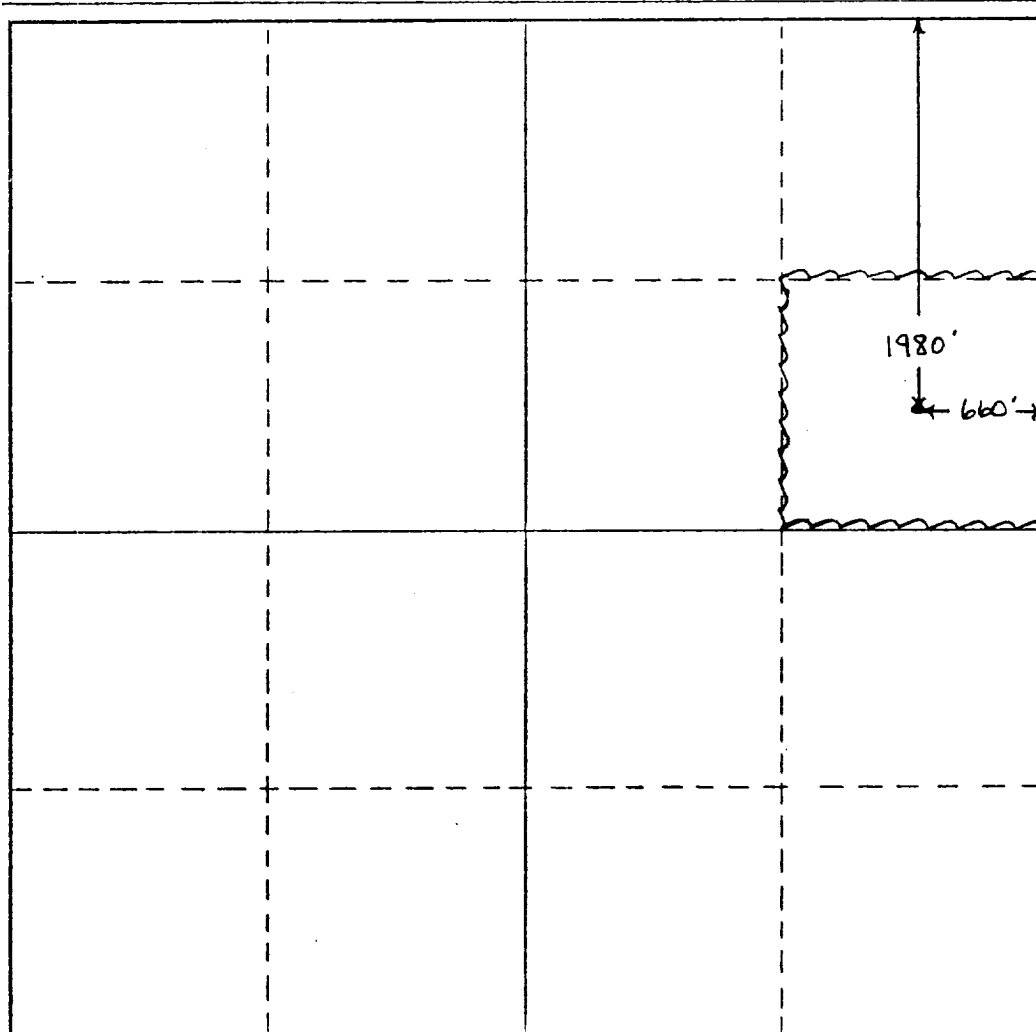

**CERTIFICATION**

*I hereby certify that the information contained herein is true and complete to the best of my knowledge and belief.*

Name \_\_\_\_\_  
*Manning*  
 Position  
**Sr. Admin. Analyst**  
 Company  
**Amoco Production Company**  
 Date  
**10/7/87**

*I hereby certify that the well location shown on this plat was plotted from field notes of actual surveys made by me or under my supervision, and that the same is true and correct to the best of my knowledge and belief.*

Date Surveyed \_\_\_\_\_  
 Registered Professional Engineer and/or Land Surveyor \_\_\_\_\_

Certificate No. \_\_\_\_\_