

NUMBER OF COPIES RECEIVED	
DISTRIBUTION	
SANTA FE	
FILE	
U.S.G.S.	
LAND OFFICE	
TRANSPORTER	OIL GAS
PRORATION OFFICE	
OPERATOR	

NEW MEXICO OIL CONSERVATION COMMISSION  
Santa Fe, New Mexico

Form G-101  
Revised (12/1/55)

# NOTICE OF INTENTION TO DRILL

Notice must be given to the District Office of the Oil Conservation Commission and approval obtained before drilling or recompletion begins. If changes in the proposed plan are considered advisable, a copy of this notice showing such changes will be returned to the sender. Submit this notice in QUINTUPLICATE. One copy will be returned following approval. See additional instructions in Rules and Regulations of the Commission. If State Land submit 6 Copies Attach Form G-128 in triplicate to first 3 copies of form G-101

Midland, Texas  
(Place)

10-27-61  
(Date)

OIL CONSERVATION COMMISSION  
SANTA FE, NEW MEXICO

Gentlemen:

You are hereby notified that it is our intention to commence the Drilling of a well to be known as

Charles B. Gillespie, Jr., ~~et al~~

(Company or Operator)

Gutman, et al

(Lease)

Well No.

1

in

(Unit)

The well is

located 990 feet from the North line and 330 feet from the East line of Section 24, T. 24-S., R. 37-E., NMPM.

(GIVE LOCATION FROM SECTION LINE)

Dollarhide, Queen Pool, Lea County

If State Land the Oil and Gas Lease is No.

If patented land the owner is Clyde N. Cooper

Jadd, New Mexico

We propose to drill well with drilling equipment as follows: Rotary

The status of plugging bond is approved

Drilling Contractor Forster Drilling Company

Bpx 32

Odessa, Texas

We intend to complete this well in the Queen

formation at an approximate depth of 3800' feet.

## CASING PROGRAM

We propose to use the following strings of Casing and to cement them as indicated:

Size of Hole	Size of Casing	Weight per Foot	New or Second Hand	Depth	Sacks Cement
11 3/4"	8 5/8"	26 #	Used	400'	Circulate
7 7/8"	4 1/2"	11.6#	New	3800'	200 Sacks

If changes in the above plans become advisable we will notify you immediately.

ADDITIONAL INFORMATION (If recompletion give full details of proposed plan of work.)

Approved \_\_\_\_\_, 19\_\_\_\_  
Except as follows:

Sincerely yours,

Charles B. Gillespie, Jr. et al

(Company or Operator)

By

Position Operator

Send Communications regarding well to

Name Charles B. Gillespie, Jr.

Address Box 1179, Midland, Texas

OIL CONSERVATION COMMISSION

By

NEW MEXICO OIL CONSERVATION COMMISSION  
Well Location and Acreage Dedication Plat

Section A.

Date October 27, 1961

Operator Charles B. Gillespie, Jr. et al Lease Gutman, et al  
Well No. 1 Unit Letter A Section 24 Township 24-S Range 37-E NMPM  
Located 990 Feet From North Line, 330 Feet From East Line  
County Lee G. L. Elevation 3130 Dedicated Acreage 40 Acres  
Name of Producing Formation Queen Pool Dollarhide

1. Is the Operator the only owner\* in the dedicated acreage outlined on the plat below?  
Yes X No       .
2. If the answer to question one is "no," have the interests of all the owners been consolidated by communitization agreement or otherwise? Yes        No       . If answer is "yes," Type of Consolidation
3. If the answer to question two is "no," list all the owners and their respective interests below:

Owner

Land Description

Section B

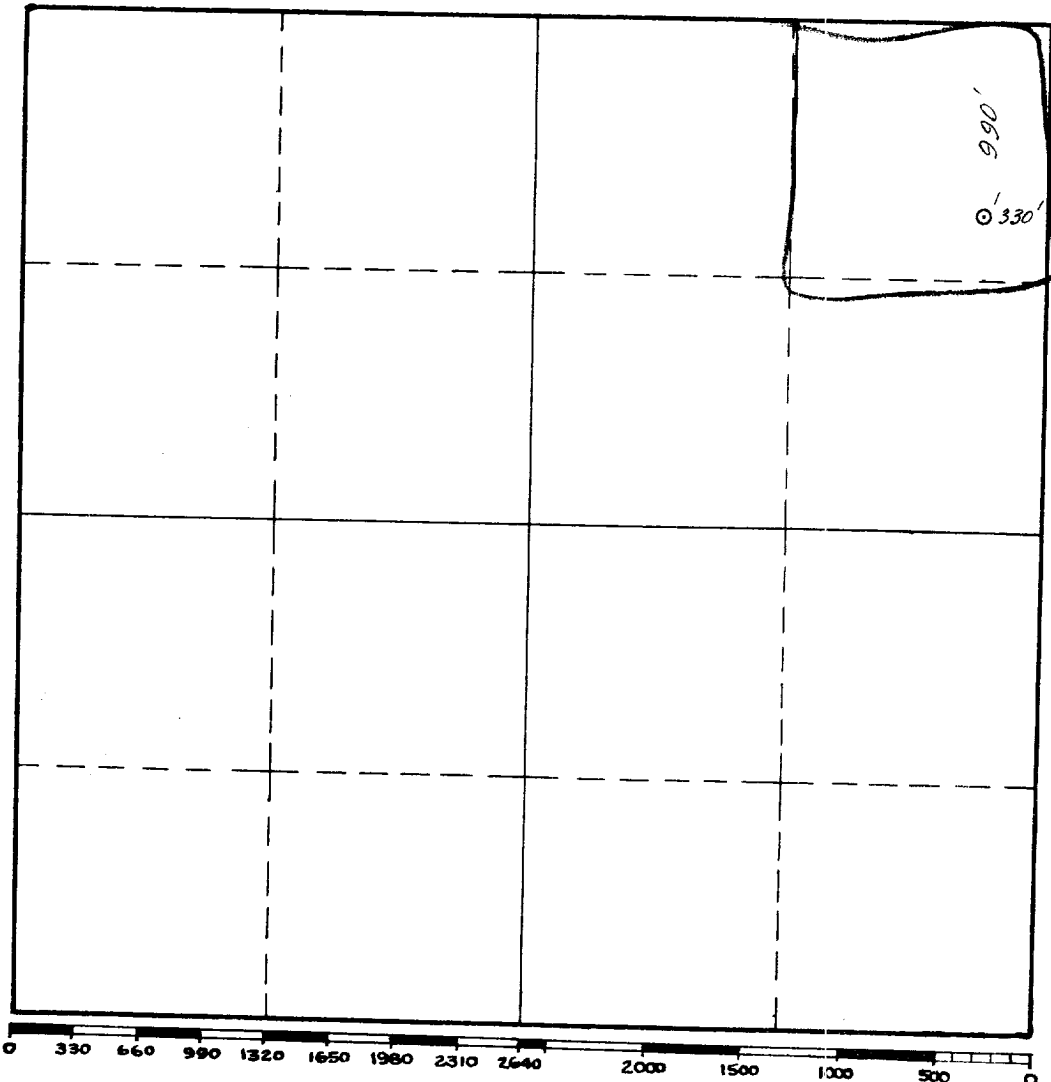

This is to certify that the information in Section A above is true and complete to the best of my knowledge and belief.

Charles B. Gillespie, Jr.  
(Operator)  
Charles B. Gillespie, Jr.  
(Representative)

Box 117, Midland, Texas  
Address

This is to certify that the well location shown on the plat in Section B was plotted from field notes of actual surveys made by me or under my supervision and that the same is true and correct to the best of my knowledge and belief.

Date Surveyed October 27, 1961  
J. F. Johnson  
Registered Professional  
Engineer and/or Land Surveyor.

Certificate No. 1390

INSTRUCTIONS FOR COMPLETION:

1. Operator shall furnish and certify to the information called for in Section A.
2. Operator shall outline the dedicated acreage for both oil and gas wells on the plat in Section B.
3. A registered professional engineer or land surveyor registered in the State of New Mexico or approved by the Commission shall show on the plat the location of the well and certify this information in the space provided.
4. All distances shown on the plat must be from the outer boundaries of Section.
5. If additional space is needed for listing owners and their respective interests as required in question 3, Section A, please use space below

\* "Owner" means the person who has the right to drill into and to produce from any pool and to appropriate the production either for himself or for himself and another. (65-3-29 (e) NMSA 1953 Comp.)