

OWWO
MN 11366

COUNTY **LEA** FIELD **Justis** STATE **NM** SERIAL
OPR **TEXACO INC.** LEASE **Fristoe, C. G. "E" NGI-2** MAP
NO **6** Sec 35, T-24-S, R-37-E CO-ORD
2310' FNL, 660' FEL of Sec ELEV. DF L & S

| SPD CSG & SX | Re- CMP | 10-21-72 | CLASS | | GL | DATUM |
|---------------------------|------------|----------|-----------|-------|-----------|-------|
| | | | FORMATION | DATUM | | |
| 13 3/8" at 265' w/350 SX | | | | | | |
| 9 5/8" at 3500' w/1500 SX | | | | | | |
| 2 7/8" at 7235' | | | | | | |
| 2 7/8" at 7232' w/1600 SX | | | | | | |
| 2 7/8" at 7233' | | | | | | |
| | | | TD 7971' | | PBD 7179' | |

LOGS EL GR RA IND HC A
(Blinebry) Perfs 5053-5539' NO NEW POTENTIAL
(Tubb) Perfs 5887-6061' NO CHANGE
(Fusselman) Perfs 7144-54' NO CHANGE

CONTR OPRS ELEV 3178' DE PD 5539' TYPE WO

11-27-72

E.R.S. 12-2-72 (Blinebry)
(Orig. comp 7-1-62 thru (Tubb) Perfs 6002-61',
(Devonian) Perfs 6940-90', (Fusselman) Perfs
7144-54', OTD 7971', OPE 7179'; OWWO & Re-Gmp
8-18-62 thru (Blinebry) Perfs 5492-5539', (Tubb)
Perfs 6002-61', (Fusselman) Perfs 7144-54',
OTD 7971', OPE 7179'; OWWO & Re-Gmp 8-17-65 thru
(Blinebry) Perfs 5492-5539', (Tubb) Perfs 5887-
6061', (Fusselman) Perfs 7144-54', OTD 7971',
OPE 7179')
TD 7971'; PBD 7179'; COMPLETE
Perf (Blinebry) 5053-59', 5066', 5072', 5074',
5083', 5088-96', 5100', 5104', 5110', 5117-29',
5133-42', 5145', 5152', 5157', 5162', 5169',
5171' w/1 SPE

LEA
TEXACO INC.

11-27-72

12-2-72

Justis
6 Frisbee, G. C. "B" NCT-2 NM Sec 35, T24S, R37E
Page 2

Continued
Frac (5053-5539') 25,000 gals jelled oil +
27,500# sd
Flwd 32 BO + 5 BW in 24 hrs thru 28/64" chk,
TP 175# (5053-5539')
COMPLETION REPORTED

NEW MEXICO OIL CONSERVATION COMMISSION
WELL LOCATION AND ACREAGE DEDICATION PLAT

FORM C-128
Revised 5/1/57

SEE INSTRUCTIONS FOR COMPLETING THIS FORM ON THE REVERSE SIDE

SECTION A

| | | | | |
|---|---|----------------------------------|---|--------------------------------|
| Operator TEXACO Inc. | | Lease C. C. Fristoe (b) NCT-2 | | Well No. 6 |
| Unit Letter H | Section 35 | Township 24 South | Range 37 East | County Lea |
| Actual Footage Location of Well: 2310 feet from the North line and 660 feet from the East line Sec. 35 | | | | |
| Ground Level Elev. 3167 | Producing Formation Permian Devonian | | Pool North Justis (Permian) (Devonian) | Dedicated Acreage: 40 Acres |

1. Is the Operator the only owner in the dedicated acreage outlined on the plat below? YES ☒ NO ____ . ("Owner" means the person who has the right to drill into and to produce from any pool and to appropriate the production either for himself or for himself and another. (65-3-29 (e) NMSA 1935 Comp.)
2. If the answer to question one is "no," have the interests of all the owners been consolidated by communitization agreement or otherwise? YES ____ NO ____ . If answer is "yes," Type of Consolidation ____
3. If the answer to question two is "no," list all the owners and their respective interests below:

| Owner | Land Description |
|-------|------------------|
| | |
| | |

SECTION B

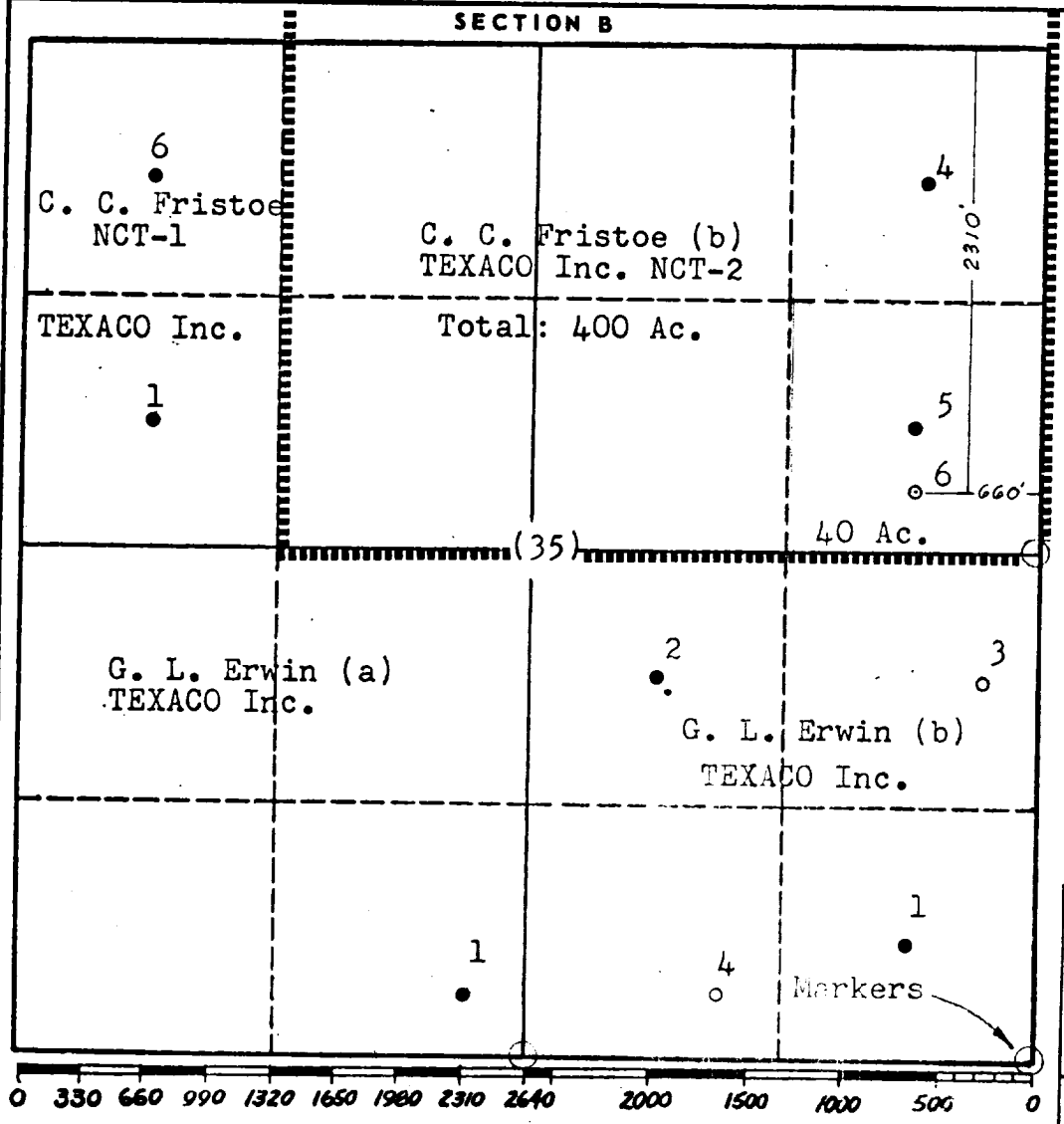

CERTIFICATION

I hereby certify that the information in SECTION A above is true and complete to the best of my knowledge and belief.

Name
J. J. Velten

Position
Division Civil Engineer

Company
TEXACO Inc.

Date
7/24/62

I hereby certify that the well location shown on the plat in SECTION B was plotted from field notes of actual surveys made by me or under my supervision, and that the same is true and correct to the best of my knowledge and belief.

Date Surveyed
4/27/62

Registered Professional Engineer and/or Land Surveyor
J. J. Velten

Certificate No.
8174

NEW MEXICO OIL CONSERVATION COMMISSION
WELL LOCATION AND ACREAGE DEDICATION PLAT

FORM C-128
Revised 5/1/57

SEE INSTRUCTIONS FOR COMPLETING THIS FORM ON THE REVERSE SIDE

SECTION A

| | | | | |
|---|--|---|--------------------------------|---------------|
| Operator TEXACO Inc. | | Lease C. C. Fristoe (b) NCT-2 | | Well No. 6 |
| Unit Letter H | Section 35 | Township 24 South | Range 37 East | County Lea |
| Actual Footage Location of Well: 2310 feet from the North line and 660 feet from the East line Sec. 35 | | | | |
| Ground Level Elev. 3167 | Producing Formation Tubb-Drinkard Permian | Pool North Justis (Tubb-Drinkard) (Permian) | Dedicated Acreage: 40 Acres | |

1. Is the Operator the only owner in the dedicated acreage outlined on the plat below? YES ☒ NO ____ . ("Owner" means the person who has the right to drill into and to produce from any pool and to appropriate the production either for himself or for himself and another. (65-3-29 (e) NMSA 1935 Comp.)
2. If the answer to question one is "no," have the interests of all the owners been consolidated by communitization agreement or otherwise? YES ____ NO ____ . If answer is "yes," Type of Consolidation ____
3. If the answer to question two is "no," list all the owners and their respective interests below:

| Owner | Land Description |
|-------|------------------|
| | |
| | |

SECTION B

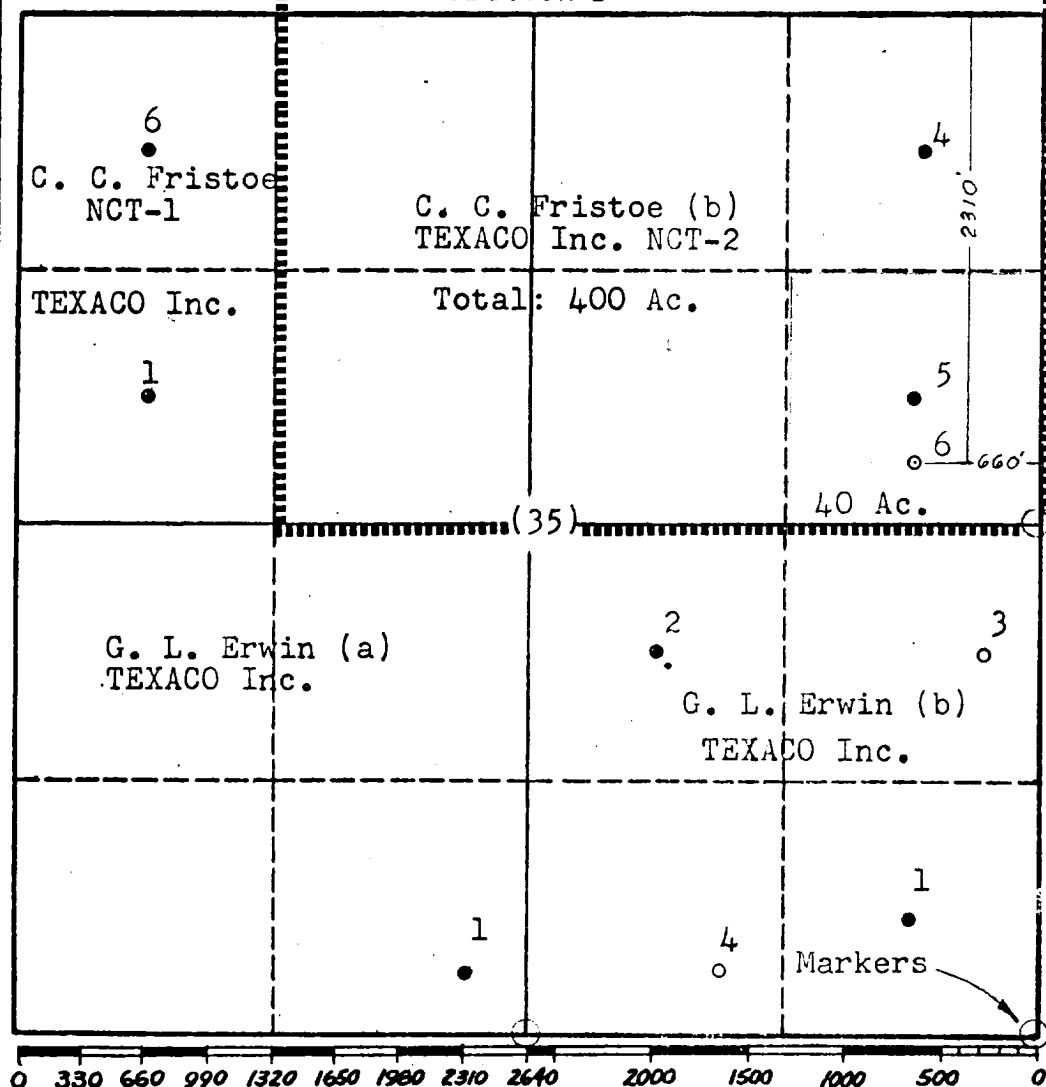

CERTIFICATION

I hereby certify that the information in SECTION A above is true and complete to the best of my knowledge and belief.

Name
J. J. Velten

Position
Division Civil Engineer

Company
TEXACO Inc.

Date
7/24/62

I hereby certify that the well location shown on the plat in SECTION B was plotted from field notes of actual surveys made by me or under my supervision, and that the same is true and correct to the best of my knowledge and belief.

Date Surveyed
4/27/62

Registered Professional Engineer
and/or Land Surveyor
J. J. Velten

Certificate No.
8174