

NEW MEXICO OIL CONSERVATION COMMISSION
Santa Fe, New Mexico

Form O-101
Revised (12/1/55)

NOTICE OF INTENTION TO DRILL

Notice must be given to the District Office of the Oil Conservation Commission and approval obtained before drilling or recompletion begins. If changes in the proposed plan are considered advisable, a copy of this notice showing such changes will be returned to the sender. Submit this notice in **QUINTUPLICATE**. One copy will be returned following approval. See additional instructions in Rules and Regulations of the Commission. If State Land submit 6 Copies Attach Form O- 128 in triplicate to first 3 copies of form O-101

Midland, Texas
(Place)

2-22-62
(Date)

OIL CONSERVATION COMMISSION
SANTA FE, NEW MEXICO

Gentlemen:

You are hereby notified that it is our intention to commence the Drilling of a well to be known as
Humble Oil & Refining Co. Co. Lse. 100914
(Company or Operator)

New Mexico State "B" (Lease)

Well No. 2, in I (Unit) The well is located 2160 feet from the South line and 330 feet from the East line of Section 2, T. 25-S, R. 37-E, NMPM. (GIVE LOCATION FROM SECTION LINE) North Justis Undesignated Pool, Lea County

If State Land the Oil and Gas Lease is No. B-11302

If patented land the owner is

Address

We propose to drill well with drilling equipment as follows: rotary

The status of plugging bond is on file.

Drilling Contractor unknown

We intend to complete this well in the Ellenburger & Drinkard (dual) formation at an approximate depth of 8600 feet.

CASING PROGRAM

We propose to use the following strings of Casing and to cement them as indicated:

Size of Hole	Size of Casing	Weight per Foot	New or Second Hand	Depth	Blocks Cement
17-1/2	13-3/8	48#	New	200	200*sks
12-1/4	9-5/8		New	3400	300*sks
8-3/4	4-1/2		New	8600****	1000***sks
	2-7/8		New	7500****	

If changes in the above plans become advisable we will notify you immediately.

ADDITIONAL INFORMATION (If recompletion give full details of proposed plan of work.)

*Circ1 to surf.

**Circ1 to base of salt, approx. 2100.

***Circ1 to approx 4000 (protect Glorieta)

****We plan to run 2 strings of non-concentric oil strings and to be used. cmt simultaneously, 1 string for each pay zone.

2 cores in McKee 7300-3000

1 core in Waddell 8150-8200

Min. and for samples. HSCCO method of cmtg

Sincerely yours,

HUMBLE OIL & REFINING COMPANY

(Company or Operator)

By: J.E. Pinkerton

Position: Adn. Supervisor

Send Communications regarding well to

Name: R. R. McCarty

Address: Box 1600, Midland, Texas

OIL CONSERVATION COMMISSION

By: [Signature]

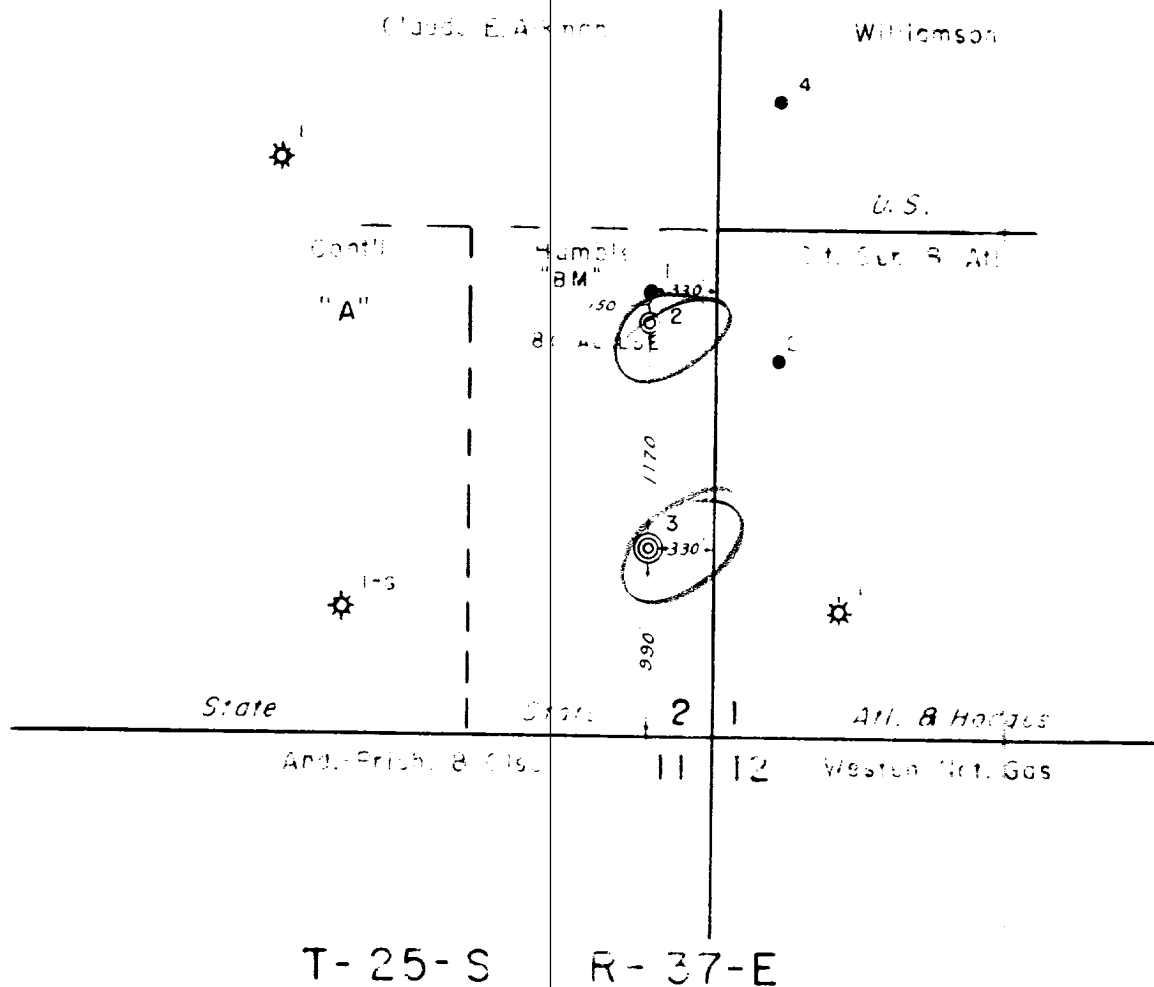

- Fusselman Well
- ⊙ Dual - Ellenburger & Drinkard Well
- ⊙ Dual - Ellenburger & Fusselman

This is to certify that I am a registered professional engineer or registered land surveyor, in the State of New Mexico, that this map was prepared from field notes of actual surveys made by me or under my direction and that the same is true and correct to the best of my knowledge and belief.

1512 E. T. Shannon
 Registration Number Registered Professional Engineer
 or Registered Land Surveyor

ST. NO. B-11302

NEW MEXICO STATE "BM" LSE. 100914 E/2 SE/4 SEC. 2, T-25-S, R-37-E LSA CO., NEW MEXICO		
HUMBLE OIL & REFINING COMPANY CIVIL ENGINEERING DIVISION MIDLAND AREA		
DRAWN BY M. B. CHECKED BY <u>E. T. Shannon</u> APPR. BY <u>E. T. Shannon</u>	SCALE 1" = 1000' DATE 6-30-61 REVISED 2-22-62 M/K	FILE NO. WA 3161

1. The first part of the document is a letter from the President of the United States to the Congress, dated January 1, 1861. It is a very important document, as it sets out the President's policy for the new year. The President states that he is pleased to see the Congress assembled, and that he is confident that the country is in a good position to meet the challenges of the future. He also mentions the recent election of Abraham Lincoln as President, and expresses his confidence in Lincoln's ability to lead the country.

2. The second part of the document is a report from the Secretary of the Treasury, dated January 1, 1861. It provides a detailed account of the financial state of the country at the beginning of the year. The report states that the country is in a sound financial position, with a strong and stable currency. It also mentions the recent election of Abraham Lincoln as President, and expresses confidence in Lincoln's ability to lead the country.

HUMBLE LEASE NO. 100914

NEW MEXICO OIL CONSERVATION COMMISSION

STATE LEASE NO. B-11302

FEDERAL LEASE NO.

Well Location and Acreage Dedication Plat

Form C-128
Revised 5/1/57

Section A.

Date February 22, 1962

Operator Humble Oil & Refining Co Lease New Mexico State "BM"
 Well No. 2 Unit Letter "1" Section 2 Township 25 South Range R-37-E NWPM
 Located 2160 Feet From South Line, 330 Feet From East Line
 County Lea S. L. Elevation Later Dedicated Acreage 40 Acres
 Name of Producing Formation Dual Ellenburger & Sandstone Pool North Justis

1. Is the Operator the only owner* in the dedicated acreage outlined on the plat below?
 Yes ☒ No ☐
2. If the answer to question one is "no", have the interests of all the owners been consolidated by communitization agreement or otherwise? Yes ☐ No ☐ If answer is "yes," Type of Consolidation _____
3. If the answer to question two is "no," list all the owners and thier respective interests below:

Owner

Land Description

Section B

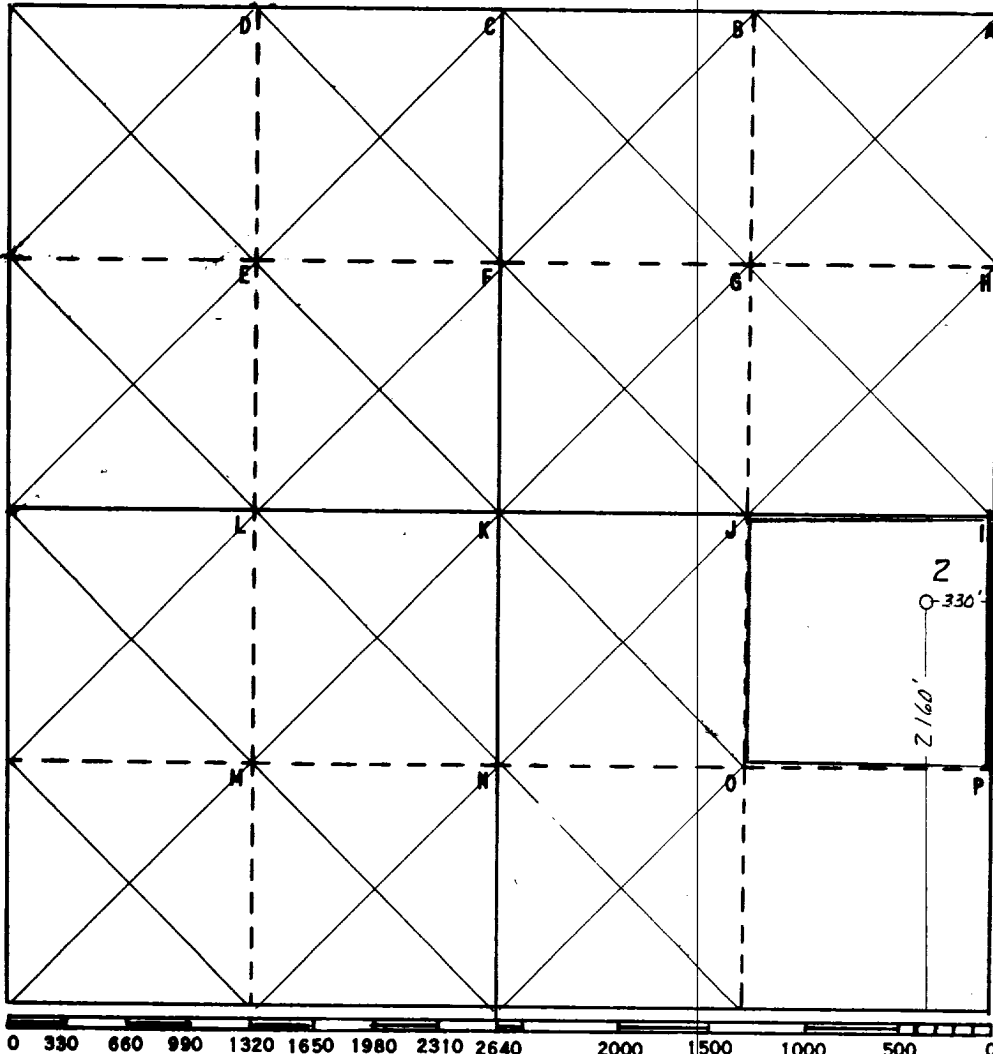

This is to certify that the information in Section A above is true and complete to the best of my knowledge and belief

HUMBLE OIL & REFG. CO.

(Operator)

H. R. Hensley
(Representative)

Box 1600 Midland, Texas
Address

This is to certify that the well location shown on the plat in Section B was plotted from field notes of actual surveys made by me or under my supervision and that the same is true and correct to the best of my knowledge and belief.

Date Surveyed 2-20-62

E. T. Shahan
Registered Professional
Engineer and/or Land Surveyor

Certificate No. 1513

FILE NO. W-A-3161