

NEW MEXICO OIL CONSERVATION COMMISSION
Santa Fe, New Mexico

Form C-101
Revised (12/1/55)

NOTICE OF INTENTION TO DRILL

Notice must be given to the District Office of the Oil Conservation Commission and approval obtained before drilling or recompletion begins. If changes in the proposed plan are considered advisable, a copy of this notice showing such changes will be returned to the sender. Submit this notice in QUINTUPLICATE. One copy will be returned following approval. See additional instructions in Rules and Regulations of the Commission. If State Land submit 6 Copies Attach Form C- 128 in triplicate to first 3 copies of form C-101

Hobbs, New Mexico
(Place)

November 4, 1962
(Date)

OIL CONSERVATION COMMISSION
SANTA FE, NEW MEXICO

Gentlemen:

You are hereby notified that it is our intention to commence the Drilling of a well to be known as

Skelly Oil Company
(Company or Operator)

State "L"
(Lease)

Well No. 4

in Unit

The well is

located 1455.6 feet from the South line and 990 feet from the West

line of Section 2, T 25-S, R 37-E, NMPM. (GIVE LOCATION FROM SECTION LINE) H. Justice Sub Drinkard Pool, Lea County

If State Land the Oil and Gas Lease is No. B-1328

If patented land the owner is

Address

We propose to drill well with drilling equipment as follows: To be drilled with rotary tools from surface to total depth.

The status of plugging bond is Blanket Bond No. 1253688 for \$100,000.00 with Federal Insurance Company.

Drilling Contractor Cactus Drilling Company
P.O. Box 32

Midland, Texas

We intend to complete this well in the Drinkard formation at an approximate depth of 6300 feet.

CASING PROGRAM

We propose to use the following strings of Casing and to cement them as indicated:

Size of Hole	Size of Casing	Weight per Foot	New or Second Hand	Depth	Slacks Cement
15"	13-3/8"	35.6	New	400'	400
11"	8-5/8"	32	New	3400'	1790
7-7/8"	5-1/2"	14 & 15.5	New	6300'	640

If changes in the above plans become advisable we will notify you immediately.

ADDITIONAL INFORMATION (If recompletion give full details of proposed plan of work.)

The pump and plug process will be used in cementing all strings of casing and cement will be circulated to surface behind the 13-3/8" OD casing.

Approved: _____, 19_____
Except as follows:

into _____ casing

OIL CONSERVATION COMMISSION

By _____

Sincerely yours,

Skelly Oil Company
(Company or Operator)

By _____

Dist. Supt.

Position _____

Send Communications regarding well to
Skelly Oil Company

Name _____

Box 32 - Hobbs, New Mexico

Address _____

NEW MEXICO OIL CONSERVATION COMMISSION
WELL LOCATION AND ACREAGE DEDICATION PLAT

FORM C-128
 Revised 5/1/57

SEE INSTRUCTIONS FOR COMPLETING THIS FORM ON THE REVERSE SIDE

SECTION A

Operator SKELLY OIL COMPANY			Lease STATE "L"		Well No. 4
Unit Letter E	Section 2	Township 25 SOUTH	Range 37 EAST	County LEA	
Actual Footage Location of Well: 1655.4 feet from the NORTH line and 990 feet from the WEST line					
Ground Level Elev.	Producing Formation Drinkard		Pool North Justis Tubb Drinkard		Dedicated Acreage: 40 Acres

1. Is the Operator the only owner in the dedicated acreage outlined on the plat below? YES X NO ____ . ("Owner" means the person who has the right to drill into and to produce from any pool and to appropriate the production either for himself or for himself and another. (63-3-29 (e) NMSA 1935 Comp.)
2. If the answer to question one is "no," have the interests of all the owners been consolidated by communitization agreement or otherwise? YES ____ NO ____ . If answer is "yes," Type of Consolidation _____
3. If the answer to question two is "no," list all the owners and their respective interests below:

Owner	Land Description

SECTION B

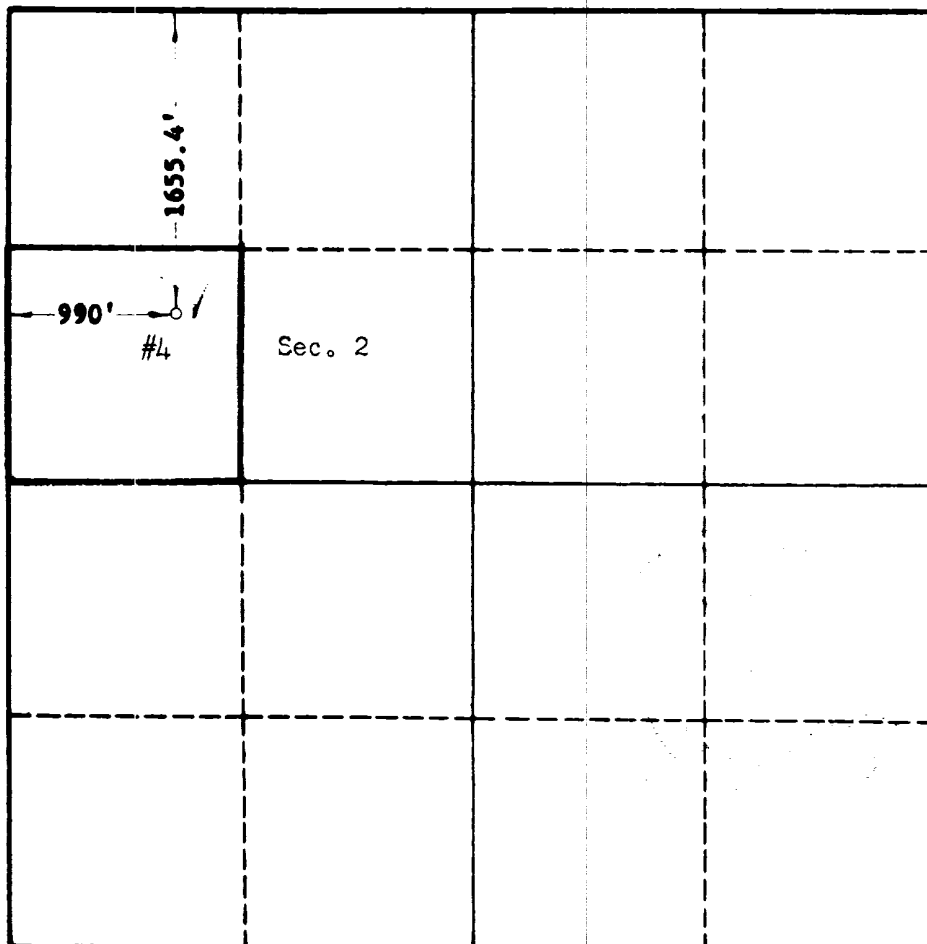

CERTIFICATION

I hereby certify that the information in SECTION A above is true and complete to the best of my knowledge and belief.

Name <i>J. E. Leach</i>
Position Dist. Supt.
Company Skelly Oil Company
Date November 6, 1962

I hereby certify that the well location shown on the plat in SECTION B was plotted from field notes of actual surveys made by me or under my supervision, and that the same is true and correct to the best of my knowledge and belief.

Date Surveyed 11-3-62
Registered Professional Engineer and/or Land Surveyor, JOHN W. WEST <i>John W. West</i>
Certificate No. N. M. - P. E. & L. S. NO. 676

0 330 660 990 1320 1650 1980 2310 2640 2000 1500 1000 500 0