

NEW MEXICO  
OIL CONSERVATION COMMISSION

Well Location and/or Gas Operation Plat

Form C-128

4-12-56

Operator R. Olson Lease Wells 1956 APR 24 10:19 AM  
Well No. 5 Section 5 Township 25 S Range 37 E NMPM  
Located 1930 Feet From North Line, 1980 Feet From East Line,  
Lea County, New Mexico. G. L. Elevation 3274.7  
Name of Producing Formation \_\_\_\_\_ Pool \_\_\_\_\_ Dedicated Acreage \_\_\_\_\_

(Note: All distances must be from outer boundaries of Section)

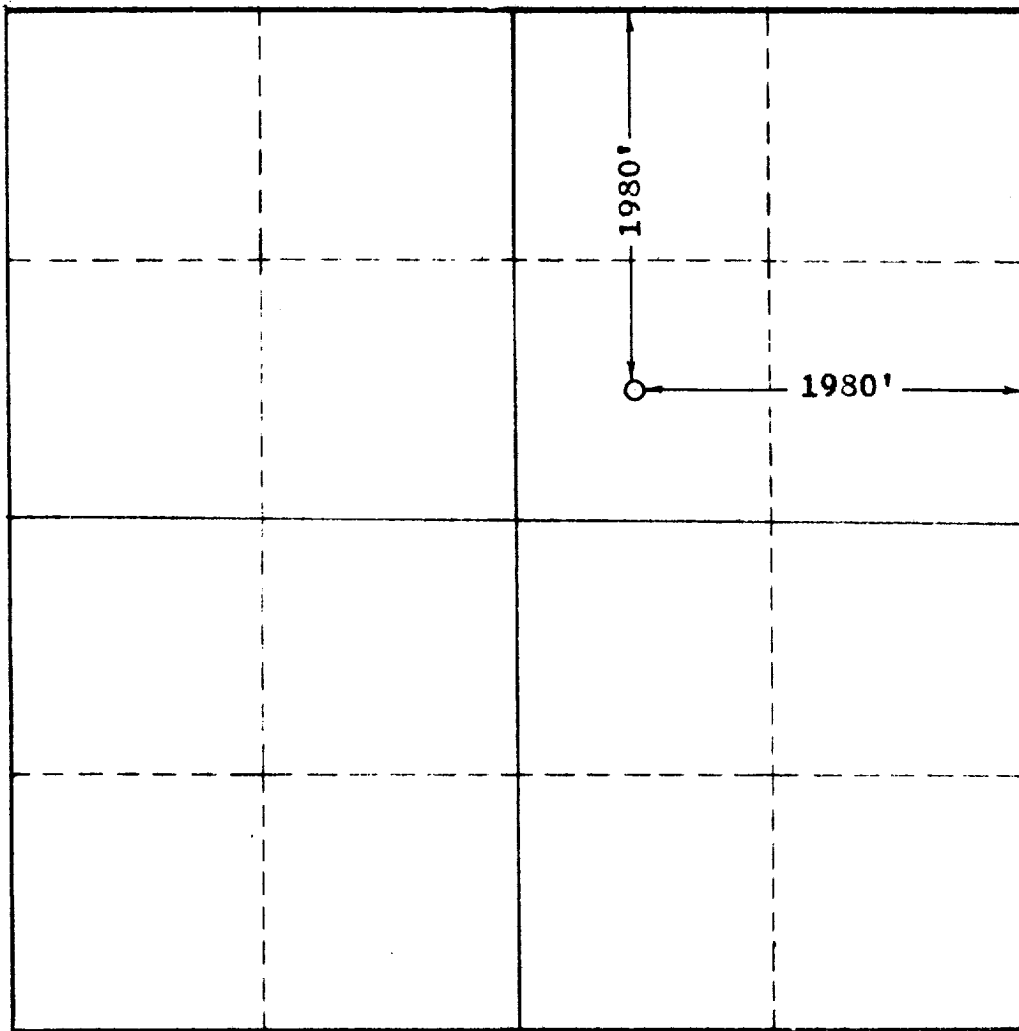

SCALE: 1"=1000'

1. Is this Well a Dual Comp. ? Yes     No    .
2. If the answer to Question 1 is yes, are there any other dually completed wells within the dedicated acreage? Yes     No

This is to certify that the above plat was prepared from field notes of actual surveys made by me or under my supervision and that the same are true and correct to the best of my knowledge and belief.

Name \_\_\_\_\_  
Position \_\_\_\_\_  
Representing \_\_\_\_\_  
Address \_\_\_\_\_

Date Surveyed 4-12-56  
John W. West  
Registered Professional Engineer and/or  
Land Surveyor