

DUPLICATE

NEW MEXICO
OIL CONSERVATION COMMISSION

Form C-128

~~RESERVED~~ Gas Proration Plat

Date June 1, 1936

Operator El Paso Natural Gas Company Lease Wells
Well No. 1 Section 5 Township 25 S Range 37 E NMPM
Located 660 Feet From East Line, 1980 Feet From South Line,
Lea County, New Mexico. G. L. Elevation 3229
Name of Producing Formation Yates Pool Jalmat Dedicated Acreage 160

(Note: All distances must be from outer boundaries of Section)

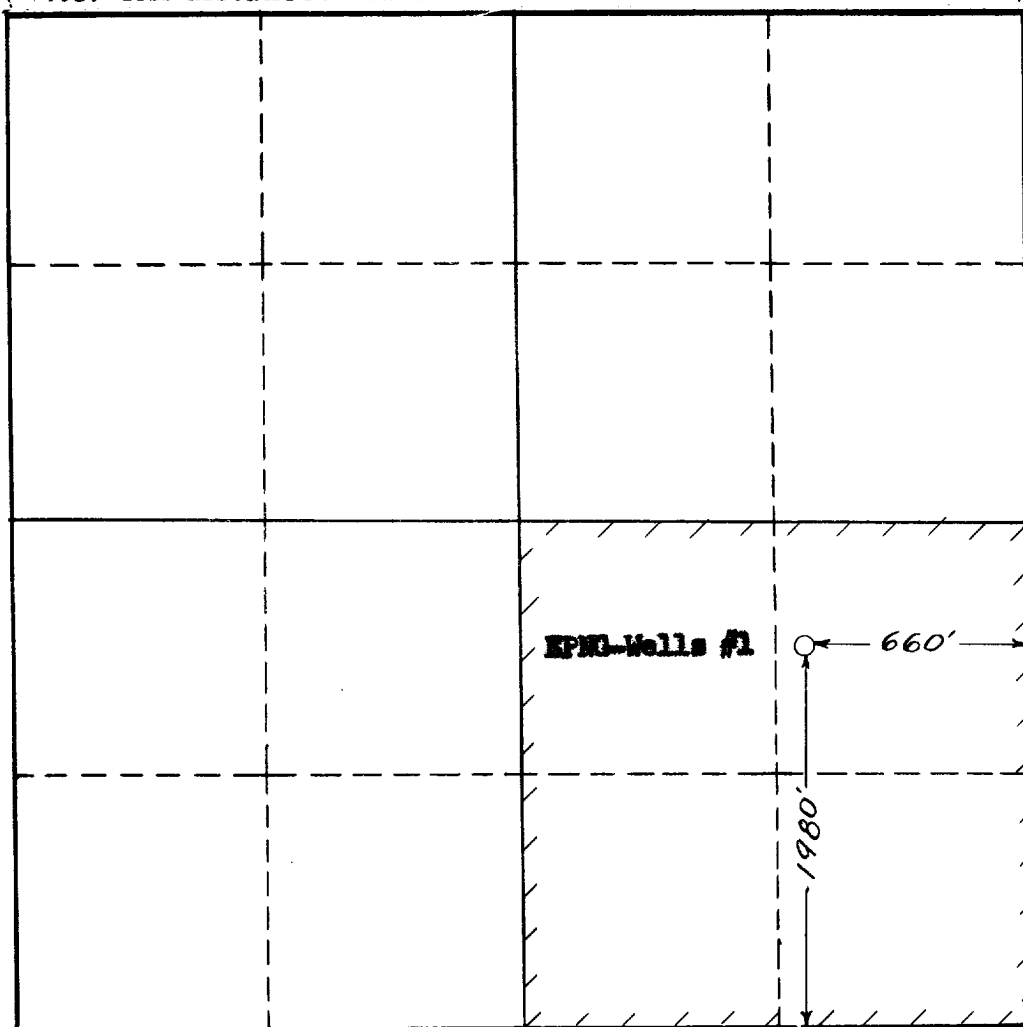

SCALE: 1"=1000'

1. Is this Well a Dual Comp. ? Yes No X .
2. If the answer to Question 1 is yes, are there any other dually completed wells within the dedicated acreage ? Yes No .

Name R. T. Wright
Position Petroleum Engineer
Representing El Paso Natural Gas Company
Address P. O. Box 1384, Jal, New Mexico

This is to certify that the above plat was prepared from field notes of actual surveys made by me or under my supervision and that the same are true and correct to the best of my knowledge and belief.

Date Surveyed

Registered Professional Engineer and/or
Land Surveyor