

NEW

OIL CONSERVATION CO

Santa Fe, New Mexico

RECEIVED

JUN 22 1951

NOTICE OF INTENTION TO DRILL

Notice must be given to the Oil Conservation Commission or its proper agent and approval of the Commission drilling begins. If changes in the proposed plan are considered advisable, a copy of the plan showing such changes will be returned to the sender. Submit this notice in triplicate. One copy will be returned following approval. See additional instructions in Rules and Regulations of the Commission.

Midland, Texas

June 21, 1951

Place

Date

OIL CONSERVATION COMMISSION,
Santa Fe, New Mexico,

Gentlemen:

You are hereby notified that it is our intention to commence the drilling of a well to be known as Lea #108594
Humble Oil & Refining Company Elydia C. Winters Et Al Well No. 2 in NW/4 of SW/4
Company or Operator Lease

of Sec. 7, T. 25-S, R. 37-E, N. M. P. M. Cooper-Jal Field, Lea County.

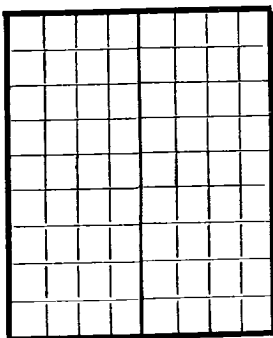

AREA 640 ACRES

LOCATE WELL CORRECTLY

The well is 1980 feet (N.) (S.) of the South line and 660 feet
(E.) (W.) of the West line of NW/4 of SW/4 of Section 7

(Give location from section or other legal subdivision lines. Cross out wrong directions.)

If state land the oil and gas lease is No. _____ Assignment No. _____

If patented land the owner is _____

Address _____

If government land the permittee is _____

Address _____

The lessee is Humble Oil & Refining Company

Address Box 1600, Midland, Texas

We propose to drill well with drilling equipment as follows: _____

Rotary Rig

The status of a bond for this well in conformance with Rule 39 of the General Rules and Regulations of the Commission is as follows: Now on file in Commission Office

We propose to use the following strings of casing and to land or cement them as indicated:

Size of Hole	Size of Casing	Weight Per Foot	New or Second Hand	Depth	Landed or Cemented	Sacks Cement
10-3/4"	8-5/8"	29.40#	New	300'	Cemented	350 sx.
6-3/4"	5-1/2"	17#	"	3100'	"	1300 sx.

If changes in the above plan become advisable we will notify you before cementing or landing casing. We estimate that the first productive oil or gas sand should occur at a depth of about 3200 feet.

Additional information:

Approved JUN 22 1951, 19____
except as follows:

Sincerely yours,

Humble Oil & Refining Company

Company or Operator

By

Position Division Chief Clerk

Send communications regarding well to

Name J. W. HouseAddress Box 1600, Midland, Texas

OIL CONSERVATION COMMISSION,

By

Oil & Gas Inspector

Title

T-25-S, R-37-E

12

7

8

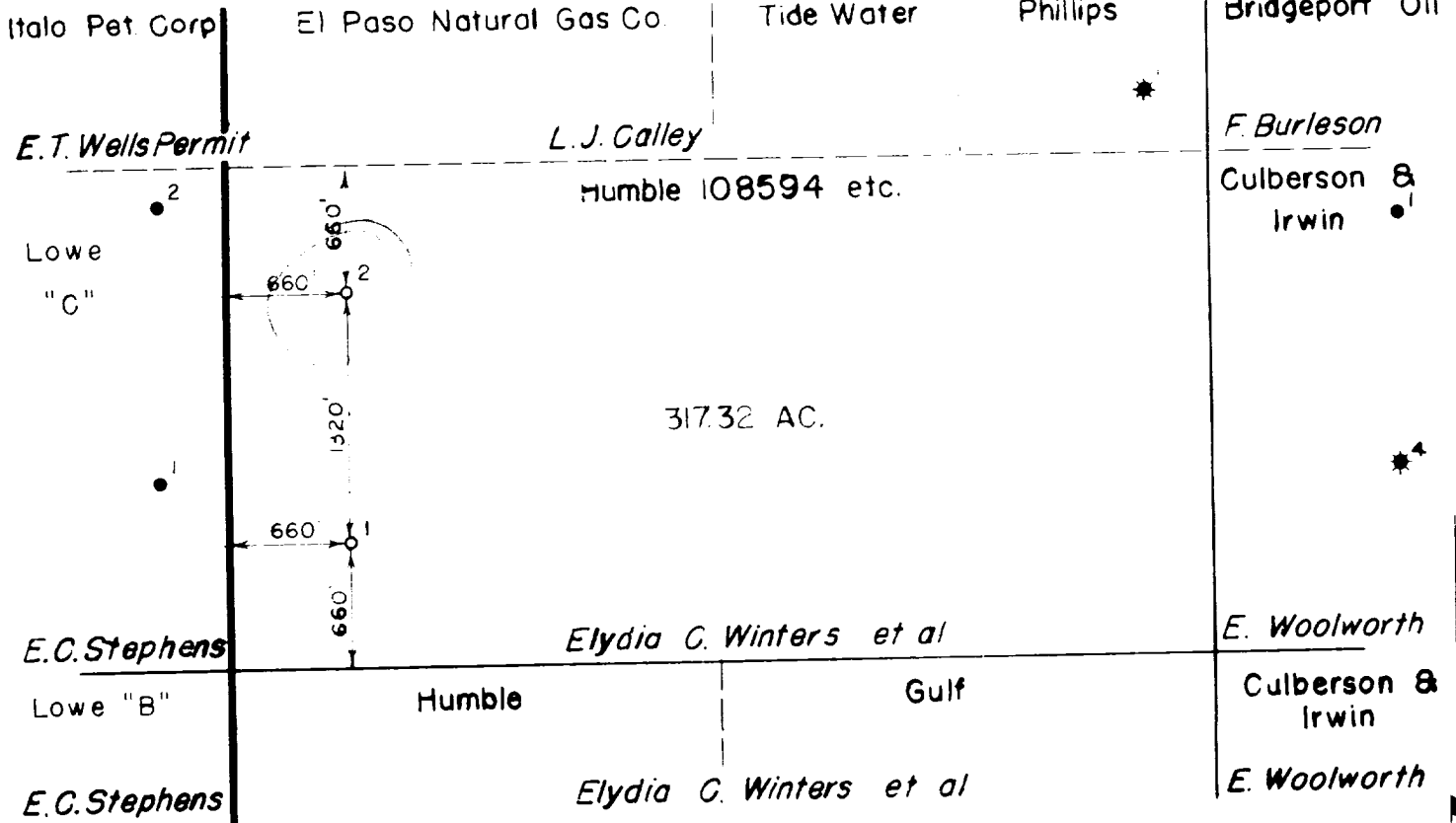

13

18

LSE NOS

108594
108595
108596
108601
109352
108598
109456
111453
139891

THIS APPLICATION FOR WELL NO 2

17

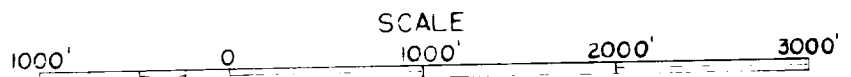

ELYDIA C. WINTERS ET AL LSE. 108594
SEC. 7, T-25-S, R-37-E
LEA COUNTY, NEW MEXICO

HUMBLE OIL & REFINING COMPANY
CIVIL ENGINEERING DIVISION
MIDLAND, TEXAS

DRAWN W.R. SHUCK
CHECKED *E. J. Shahan*
APPR

SCALE 1" = 1000'
DATE 6-20-51
REVISED

FILE NO.

WT-A 1127