

(SUBMIT IN TRIPLICATE)

UNITED STATES
DEPARTMENT OF THE INTERIOR
GEOLOGICAL SURVEY

Land Office **Las Cruces**
Lease No. **057180**
Unit **Prichard "A" Fed.**

SUNDRY NOTICES AND REPORTS ON WELLS

NOTICE OF INTENTION TO DRILL.....	<input checked="" type="checkbox"/>	SUBSEQUENT REPORT OF WATER SHUT-OFF.....	
NOTICE OF INTENTION TO CHANGE PLANS.....		SUBSEQUENT REPORT OF SHOOTING OR ACIDIZING.....	
NOTICE OF INTENTION TO TEST WATER SHUT-OFF.....		SUBSEQUENT REPORT OF ALTERING CASING.....	
NOTICE OF INTENTION TO RE-DRILL OR REPAIR WELL.....		SUBSEQUENT REPORT OF REDRILLING OR REPAIR.....	
NOTICE OF INTENTION TO SHOOT OR ACIDIZE.....		SUBSEQUENT REPORT OF ABANDONMENT.....	
NOTICE OF INTENTION TO PULL OR ALTER CASING.....		SUPPLEMENTARY WELL HISTORY.....	
NOTICE OF INTENTION TO ABANDON WELL.....			

(INDICATE ABOVE BY CHECK MARK NATURE OF REPORT, NOTICE, OR OTHER DATA)

February 6, 19**61**

Well No. **2** is located **1980** ft. from **[N]** line and **660** ft. from **[E]** line of sec. **9**

NE 1/4 of Sec. 9 (1/4 Sec. and Sec. No.) **25-S** (Twp.) **37-E** (Range) (Meridian)
Langlie-Mattix (Field) **Leon** (County or Subdivision) **New Mexico** (State or Territory)

The elevation of the derrick floor above sea level is _____ ft.

DETAILS OF WORK

(State names of and expected depths to objective sands; show sizes, weights, and lengths of proposed casings; indicate mudding jobs, cementing points, and all other important proposed work)

It is proposed to drill with Rotary Tools to the Seven Rivers-Queen formation at about 3500'. Set 5 5/8" csg. at 300' with cement circulated. If productive, set 5 1/2" csg. to Total Depth and cement with about 250 sacks.

I understand that this plan of work must receive approval in writing by the Geological Survey before operations may be commenced.

Company **TEXAS PACIFIC COAL AND OIL COMPANY**
Address **P. O. Box 2110**
Fort Worth 1, Texas
By **R. W. Hines**
Title **Vice President, Production**

NEW MEXICO OIL CONSERVATION COMMISSION

FORM C-128
Revised 5/1/57

WELL LOCATION AND ACREAGE DEDICATION PLAT

SEE INSTRUCTIONS FOR COMPLETING THIS FORM ON THE REVERSE SIDE

SECTION A

Operator TEXAS PACIFIC COAL & OIL		Lease PRICHARD "A"		Well No. 2
Unit Letter H	Section 9	Township 25 SOUTH	Range 37 EAST	County LEA
Actual Footage Location of Well: 1980 feet from the NORTH line and 660 feet from the EAST line				
Ground Level Elev.	Producing Formation	Pool	Dedicated Acreage Acres	

1. Is the Operator the only owner in the dedicated acreage outlined on the plat below? YES ☒ NO ☐ ("Owner" means the person who has the right to drill into and to produce from any pool and to appropriate the production either for himself or for himself and another. (65-3-29 (e) NMSA 1955 (Comp.)
2. If the answer to question one is "no," have the interests of all the owners been consolidated by communitization agreement or otherwise? YES ☐ NO ☐ If answer is "yes," Type of Consolidation _____
3. If the answer to question two is "no," list all the owners and their respective interests below:

Owner	Land Description

SECTION B

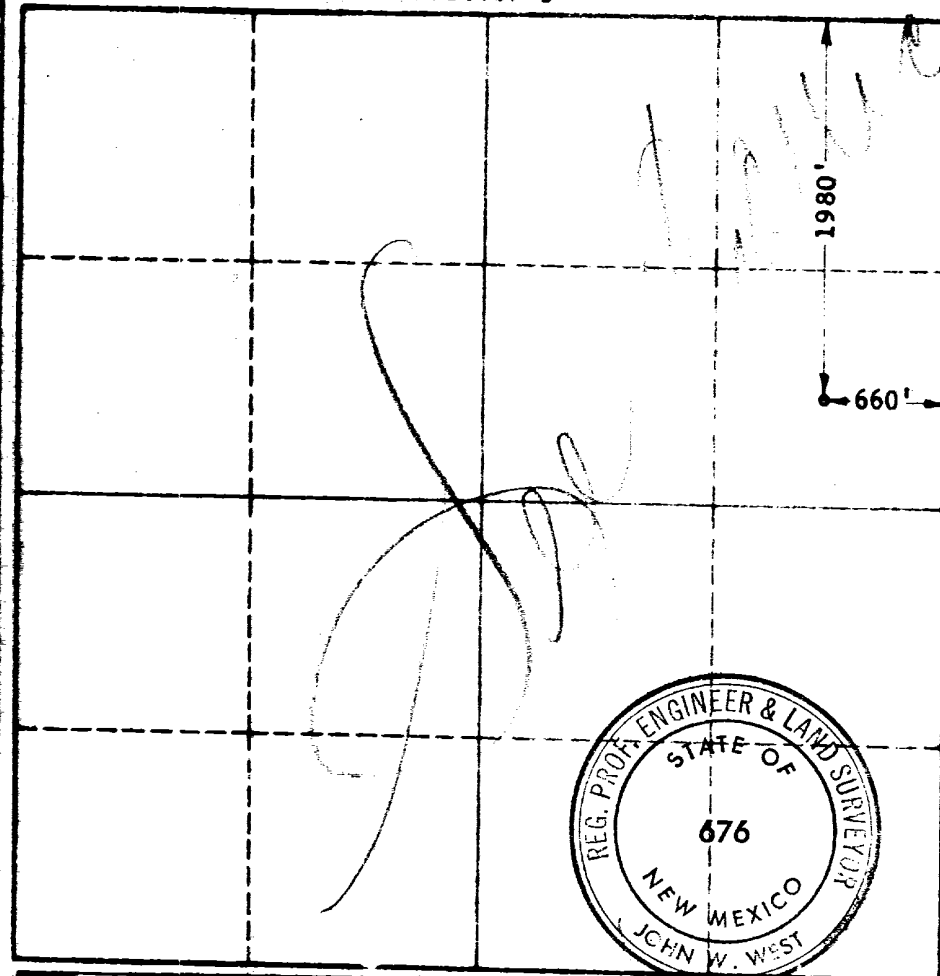

CERTIFICATION

I hereby certify that the information in SECTION A above is true and complete to the best of my knowledge and belief.

Name **R. W. Hine**
Position **Vice President Production**
Company **TEXAS PACIFIC COAL AND OIL CO.**
Date **February 6, 1961**

I hereby certify that the well location shown on the plat in SECTION B was plotted from field notes of actual surveys made by me or under my supervision, and that the same is true and correct to the best of my knowledge and belief.

Date Surveyed **FEBRUARY 6, 1961**
Registered Professional Engineer and/or Land Surveyor, **JOHN W. WEST**
Certificate No. **676**
N.M. - P.E. & L.S. NO. 676

0 330 660 990 1320 1650 1980 2310 2640 2000 1500 1000 500 0