

COPIES RECEIVED
DISTRIBUTION
SANTA FE
FILE
U.S.G.S.
LAND OFFICE
TRANSPORTATION
PRODUCTION
OPERATOR

Revised (12/1/55)

Notice must be given to the District Engineer before drilling or recompletion begins. If changes in the proposed plan are made, the plan must be resubmitted. Submit this notice in **QUINTUPLICATE** to the District Engineer. If State Engineer is required, submit 3 copies of form C-101 to the State Engineer.

Fort Worth, Texas

July 13, 1962

OIL CONSERVATION COMMISSION
SANTA FE, NEW MEXICO

Gentlemen:

You are hereby notified that the proposed plan for the well is as follows:
Texas Pacific Coal and Oil Company

Eaton "B" Ac. 1

located **990** feet from the **North**

East

(GIVE LOCATION FROM SECTION AND

Langlie-Mattix

2 **B** The well is
(Unit)
2,310 feet from the
25-S **R. 37-E**, NMPM.
Lea County

Eaton Heirs

Rotary Rig

D	C	B	A
E	F	G	H
L	K	J	I
M	N	O	P

The status of plugging bond is **Required Bond on File**

F.W.A. Drilling Co., Inc.
First National Bank Building
Wichita Falls, Texas

7-Rivers Queen
3,800 feet.

We propose to use the following strings:

Size of Hole	Size of Casing	Well Number	Status	Depth	Sacks Cement
11 1/4"	8 5/8"	24#	New	300'	200 sacks circ.
7 7/8"	5 1/2"	15.5#	New	3,800'	350 sacks circ.

If changes in the above plans become necessary, the plan must be resubmitted.
ADDITIONAL INFORMATION (If recompletion, give full details of proposed work.)

Approved:
Except as follows:

TEXAS PACIFIC COAL AND OIL COMPANY

Company or Operator

Manager of Production

Communications regarding well to

D.A. Bonney

P.O. Box 2110, Fort Worth 1, Texas

OIL CONSERVATION COMMISSION

By

NEW MEXICO OIL CONSERVATION COMMISSION
WELL LOCATION AND ACREAGE DEDICATION PLAT

FORM C-128
Revised 5/1/57

SEE INSTRUCTIONS FOR COMPLETING THIS FORM ON THE REVERSE SIDE

SECTION A

Operator TEXAS PACIFIC COAL & OIL COMPANY		Lease EATON "B" ACCOUNT 1		Well No. 2
Unit Letter B	Section 12	Township 25 SOUTH	Range 37 EAST	County LEA
Actual Footage Location of Well: 990 feet from the NORTH line and 2310 feet from the EAST line				
Ground Level Elev.	Producing Formation Queen		Pool Langlie-Mattix	Dedicated Acreage: 40 Acres

1. Is the Operator the only owner in the dedicated acreage outlined on the plat below? YES ☒ NO ____ ("Owner" means the person who has the right to drill into and to produce from any pool and to appropriate the production either for himself or for himself and another. (65-3-29 (e) NMSA 1935 Comp.)
2. If the answer to question one is "no," have the interests of all the owners been consolidated by communitization agreement or otherwise? YES ____ NO ____ . If answer is "yes," Type of Consolidation ____
3. If the answer to question two is "no," list all the owners and their respective interests below:

Owner	Land Description

SECTION B

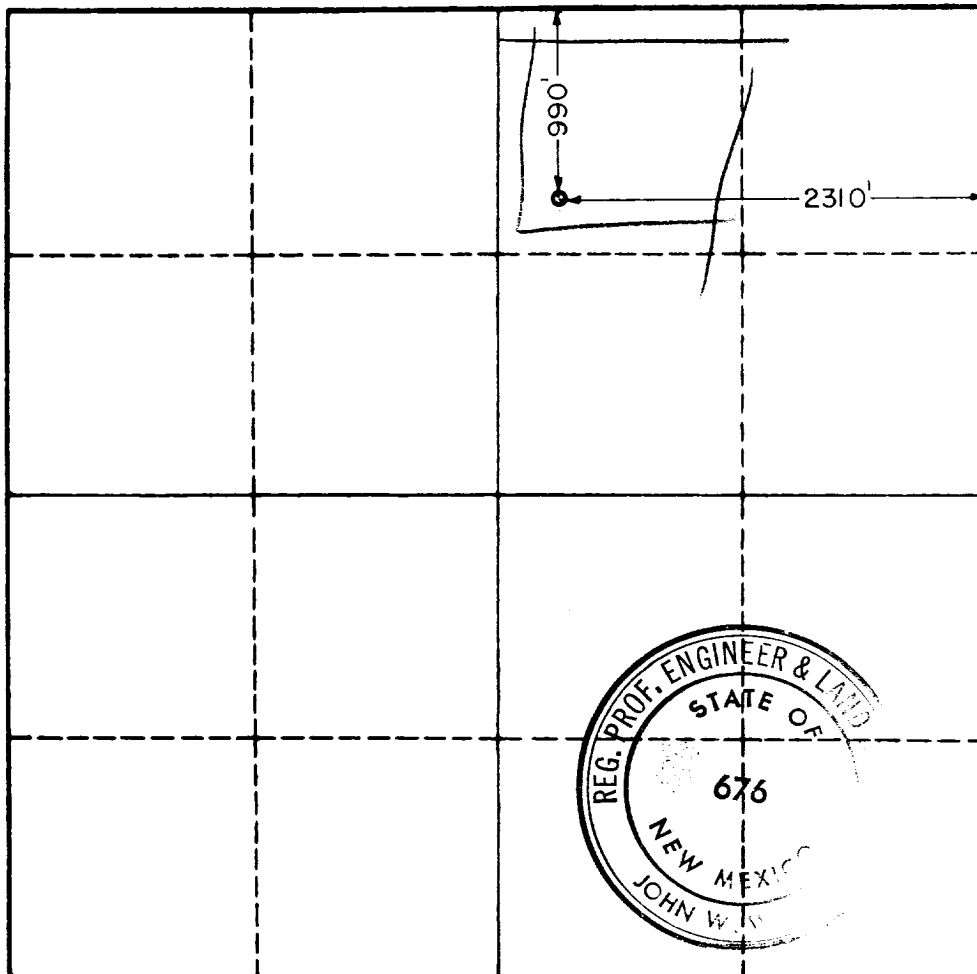

CERTIFICATION

I hereby certify that the information in SECTION A above is true and complete to the best of my knowledge and belief.

Name *John W. West*
Position
Manager of Production
Company
TEXAS PACIFIC COAL AND OIL CO.
Date
July 13, 1962

I hereby certify that the well location shown on the plat in SECTION B was plotted from field notes of actual surveys made by me or under my supervision, and that the same is true and correct to the best of my knowledge and belief.

Date Surveyed
7-12-62
Registered Professional Engineer and/or Land Surveyor, **JOHN W. WEST**
John W. West
Certificate No.
N. M. - P. E. & L. S. NO. 676

0 330 660 990 1320 1650 1980 2310 2640 2000 1500 1000 500 0