

**District IV**  
**2040 South Pacheco, Santa Fe, NM 87505**

OIL CONSERVATION DIVISION  
2040 South Pacheco  
Santa Fe, NM 87505

Form C-102  
Revised March 17, 1999

Submit to Appropriate District Office  
State Lease - 4 Copies  
Fee Lease - 3 Copies

☐ AMENDED REPORT

## WELL LOCATION AND ACREAGE DEDICATION PLAT

<sup>1</sup> API Number 30-025-11675		<sup>2</sup> Pool Code 79240	<sup>3</sup> Pool Name Jalmat (Tnsl- Yts - 7 Rvrs) (Gas)	
<sup>4</sup> Property Code 026178	<sup>5</sup> Property Name Hadfield			<sup>6</sup> Well Number 2
<sup>7</sup> OGRID No. 188294	<sup>8</sup> Operator Name American Inland Resources Company, LLC.			<sup>9</sup> Elevation 3051.5 GR

## <sup>10</sup> Surface Location

UL or lot no.	Section	Township	Range	Lot Idn	Feet from the	North/South line	Feet from the	East/West line	County
P	21	25S	37E		660	South	660	East	Lea

11	Bottom Hole Location If Different From Surface

Bottom Hole Location is Different From Surface									
UL or lot no.	Section	Township	Range	Lot Idn	Feet from the	North/South line	Feet from the	East/West line	County
<sup>13</sup> Dedicated Acres 120		<sup>13</sup> Joint or Infill		<sup>14</sup> Consolidation Code		<sup>15</sup> Order No. NSP-977			

NO ALLOWABLE WILL BE ASSIGNED TO THIS COMPLETION UNTIL ALL INTERESTS HAVE BEEN CONSOLIDATED OR A NON-STANDARD UNIT HAS BEEN APPROVED BY THE DIVISION

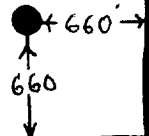
NON-STANDARD UNIT HAS BEEN APPROVED BY THE DIVISION				<b>17 OPERATOR CERTIFICATION</b> I hereby certify that the information contained herein is true and complete to the best of my knowledge and belief  <i>Michael D. Prichard</i> Signature <u>Michael D. Prichard</u> Printed Name <u>Operations Engineer</u> Title _____ Date <u>August 23, 2001</u>	
16				<b>18 SURVEYOR CERTIFICATION</b> I hereby certify that the well location shown on this plat was plotted from field notes of actual surveys made by me or under my supervision, and that the same is true and correct to the best of my belief.  Date of Survey _____ Signature and Seal of Professional Surveyer: _____  Certificate Number _____	
					

**NEW MEXICO OIL CONSERVATION COMMISSION  
WELL LOCATION AND ACREAGE DEDICATION PLAT**

Form C-102  
Supersedes C-128  
Effective 1-1-65

All distances must be from the outer boundaries of the Section.

Operator <b>Lewis B. Burleson, Inc.</b>			Lease <b>Hadfield</b>		Well No. <b>2</b>
Unit Letter <b>P</b>	Section <b>21</b>	Township <b>25-S</b>	Range <b>37-E</b>	County <b>Lea</b>	
Actual Footage Location of Well: <div style="display: flex; justify-content: space-between; align-items: center;"> <span><b>660</b> feet from the <b>South</b> line and <b>660</b> feet from the <b>East</b> line</span> </div>					
Ground Level Elev. <b>3051</b>	Producing Formation <b>Yates</b>		Pool <b>Jalmat (Oil)</b>		Dedicated Acreage; <b>40</b> Acres

1. Outline the acreage dedicated to the subject well by colored pencil or hachure marks on the plat below.
2. If more than one lease is dedicated to the well, outline each and identify the ownership thereof (both as to working interest and royalty).
3. If more than one lease of different ownership is dedicated to the well, have the interests of all owners been consolidated by communitization, unitization, force-pooling, etc?

☐ Yes    ☐ No    If answer is "yes," type of consolidation \_\_\_\_\_

If answer is "no," list the owners and tract descriptions which have actually been consolidated. (Use reverse side of this form if necessary.) \_\_\_\_\_

No allowable will be assigned to the well until all interests have been consolidated (by communitization, unitization, forced-pooling, or otherwise) or until a non-standard unit, eliminating such interests, has been approved by the Commission.

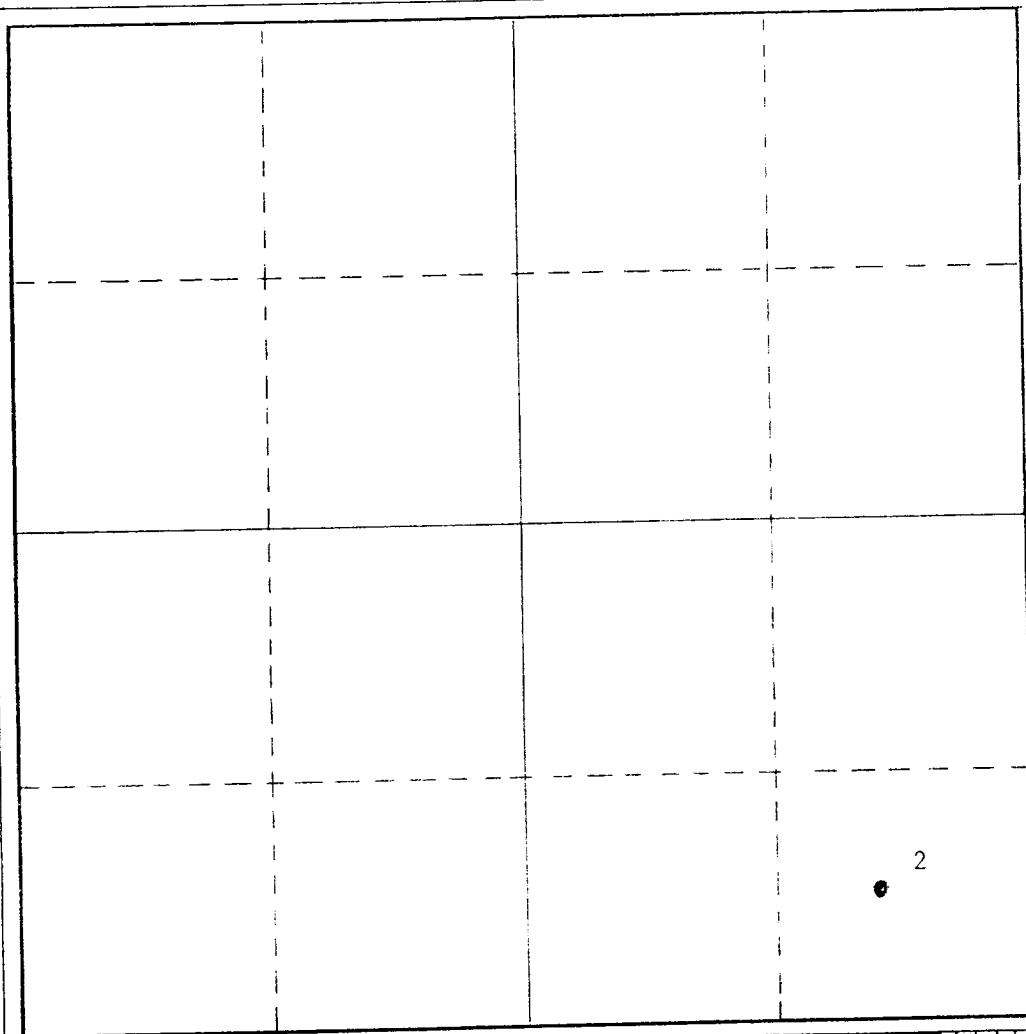

**CERTIFICATION**

*I hereby certify that the information contained herein is true and complete to the best of my knowledge and belief.*

*Steven Burleson*

Name **Steven Burleson**

Position **Vice President**

Company

**Lewis B. Burleson, Inc.**

Date

**Dec. 30, 1986**

*I hereby certify that the well location shown on this plat was plotted from field notes of actual surveys made by me or under my supervision, and that the same is true and correct to the best of my knowledge and belief.*

\_\_\_\_\_  
I am Surveyed

\_\_\_\_\_  
Registered Professional Engineer  
and/or Land Surveyor

Certificate No. \_\_\_\_\_

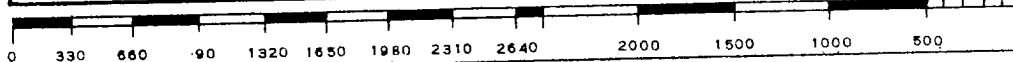

NEW MEXICO OIL CONSERVATION COMMISSION  
WELL LOCATION AND ACREAGE DEDICATION PLAT

Form C-102  
Supersedes C-128  
Effective 1-1-65

All distances must be from the outer boundaries of the Section.

Operator <b>BURLESON and HUFF</b>		Lease <b>Hadfield</b>		Well No. <b>2</b>
Unit Letter <b>P</b>	Section <b>21</b>	Township <b>25</b>	Range <b>37</b>	County <b>Lea</b>
Actual Footage Location of Well: <b>660</b> feet from the <b>South</b> line and <b>660</b> feet from the <b>East</b> line				
Ground Level Elev. <b>3040</b>	Producing Formation <b>Yates</b>	Pool <b>Jalmat</b>	Dedicated Acreage: <b>120</b> Acres	

1. Outline the acreage dedicated to the subject well by colored pencil or hatchure marks on the plat below.
2. If more than one lease is dedicated to the well, outline each and identify the ownership thereof (both as to working interest and royalty).
3. If more than one lease of different ownership is dedicated to the well, have the interests of all owners been consolidated by communitization, unitization, force-pooling, etc?

☐ Yes ☐ No If answer is "yes," type of consolidation \_\_\_\_\_

If answer is "no," list the owners and tract descriptions which have actually been consolidated. (Use reverse side of this form if necessary.) \_\_\_\_\_

No allowable will be assigned to the well until all interests have been consolidated (by communitization, unitization, forced-pooling, or otherwise) or until a non-standard unit, eliminating such interests, has been approved by the Commission.

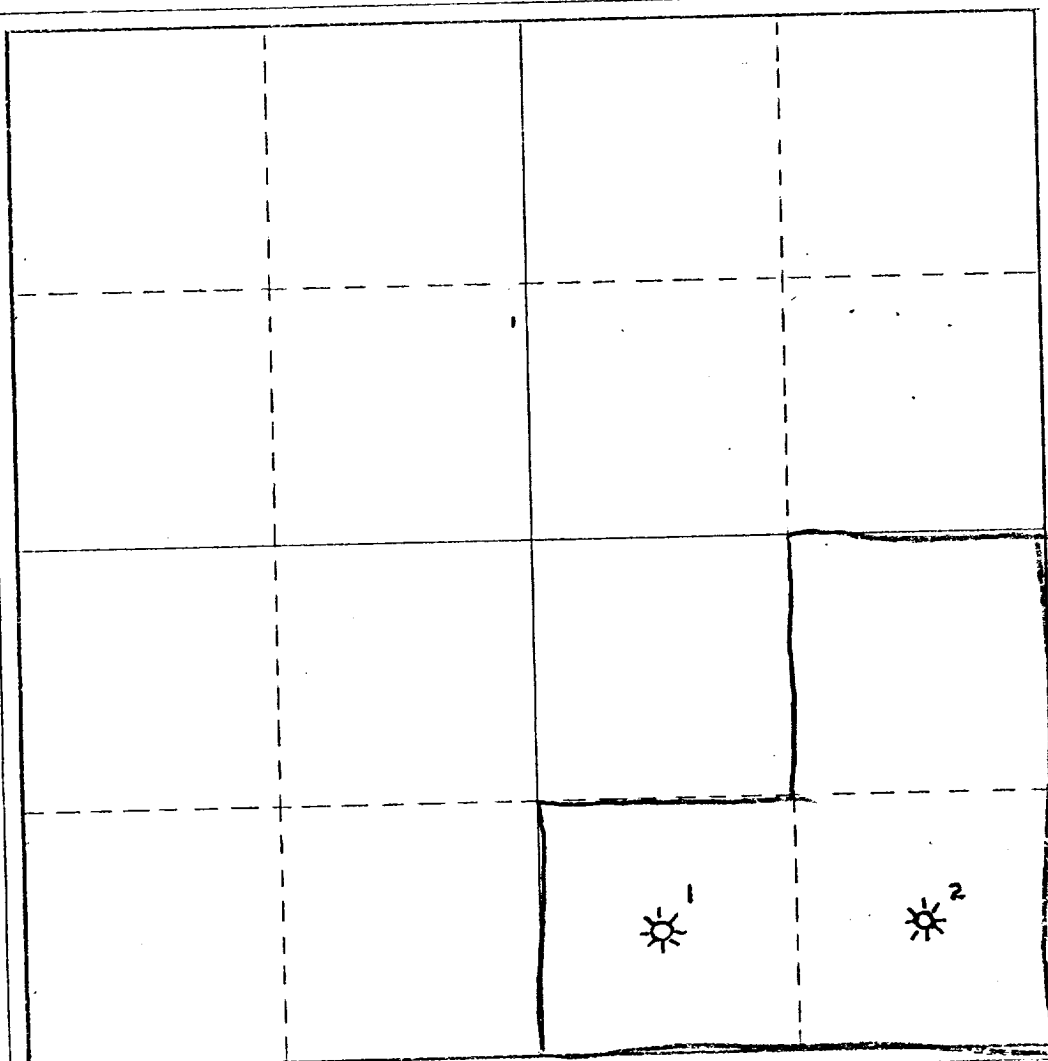

CERTIFICATION

I hereby certify that the information contained herein is true and complete to the best of my knowledge and belief.

*[Signature]*  
Name

Partner

Position

Burleson and Huff

Company

November 14, 1974

Date

I hereby certify that the well location shown on this plat was plotted from field notes of actual surveys made by me or under my supervision, and that the same is true and correct to the best of my knowledge and belief.

Date Surveyed

Registered Professional Engineer  
and/or Land Surveyor

Certificate No.

0 330 660 990 1320 1650 1980 2310 2640 2000 1500 1000 500 0

RECEIVED

NOV 1 1975

CLUB OF THE AMERICAN  
GOLF ASSOCIATION

NEW MEXICO  
OIL CONSERVATION COMMISSION

Form C-128

Well Location and/or Gas Production Plat

Date December 7, 1956

Operator E. G. Rodman

Lease 7-17

Hadfield

Well No. 2 Section 21 Township 25S Range 37E NMPM

Located 660 Feet From East Line, 660 Feet From South Line,

Lea

County, New Mexico. G. L. Elevation \_\_\_\_\_

Name of Producing Formation YATES Pool Jalmat Dedicated Acreage 1/2 of 160  
UNDIVIDED

(Note: All distances must be from outer boundaries of Section)

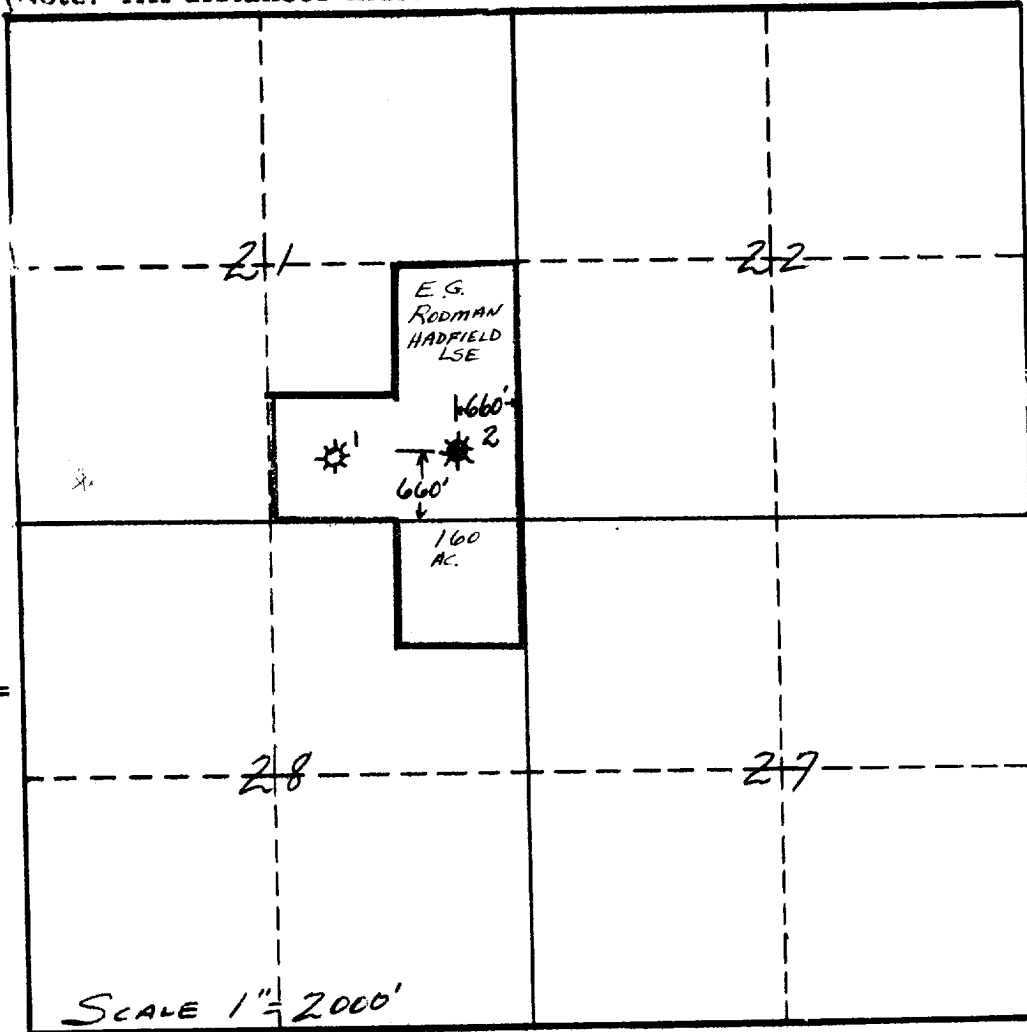

NOTE

This section of  
form is to be  
used for gas  
wells only.



1. Is this Well a Dual Comp.? Yes \_\_\_ No x.
2. If the answer to Question 1 is yes, are there any other dually completed wells within the dedicated acreage? Yes \_\_\_ No \_\_\_.

Name E. G. Rodman  
Position ENGINEER  
Representing E. G. RODMAN  
Address Box 591 ODESSA TEX.

This is to certify that the above plat was prepared from field notes of actual surveys made by me or under my supervision and that the same are true and correct to the best of my knowledge and belief.

Date Surveyed 1946  
E. G. Rodman  
Registered Professional Engineer and/or  
Land Surveyor

NEW MEXICO  
OIL CONSERVATION COMMISSION

Gas Well Plat

Date FEB 8 1954

E. G. Rodman  
Operator

HADFIELD  
Lease

2  
Well No.

Name of Producing Formation YATES Pool LANGMAT GAS

No. Acres Dedicated to the Well 80

SECTION 21 TOWNSHIP 25-S RANGE 37-E

<p><u>NOTE:</u> APPLICATION TO THE OIL CONSERVATION COMMISSION WILL BE MADE FOR A HEARING TO INCLUDE THE NE <math>\frac{1}{4}</math> OF NE <math>\frac{1}{4}</math> OF SEC 28 IN THE ACRES ALLOTTED TO THIS WELL</p>			
SECTION 21			
12-608			
1600 + 1114			
E/2 + 1114 + 1114 21			
1114 1114 1114			
2			

I hereby certify that the information given above is true and complete to the best of my knowledge.

Name Carl Rodman  
Position ENGINEER  
Representing E. G. Rodman  
Address Box 591, ODESSA TEX.

(over)

## INSTRUCTIONS

1. Is this gas well a dual completion? Yes \_\_\_\_ No \_\_\_\_.
2. If the answer to Question 1 is Yes, are there any other dually completed wells within the dedicated acreage? Yes \_\_\_\_\_ No \_\_\_\_\_

A separate plat must be filed for each gas well, outlining the area dedicated to such well and showing the location of all other wells (oil and gas) within the outlined area.

Mail in duplicate to the district office for the district in which the well is located.