

NEW MEXICO OIL CONSERVATION COMMISSION
WELL LOCATION AND ACREAGE DEDICATION PLAT

FORM C-128
Revised 5/1/57

SEE INSTRUCTIONS FOR COMPLETING THIS FORM ON THE REVERSE SIDE

SECTION A

Operator Argo Oil Corporation			Lease B. T. Lanehart		Well No. 41
Unit Letter H	Section 21 & 22	Township 25S	Range 37E	County Lea	
Actual Footage Location of Well: 2310 feet from the North line and 990' feet from the East line of Section 21					
Ground Level Elev. 3071	Producing Formation Yates		Pool Jalmat		Dedicated Acreage: 160 Acres

1. Is the Operator the only owner in the dedicated acreage outlined on the plat below? YES ☒ NO ____ . ("Owner" means the person who has the right to drill into and to produce from any pool and to appropriate the production either for himself or for himself and another. (65-3-29 (e) NMSA 1935 Comp.)
2. If the answer to question one is "no," have the interests of all the owners been consolidated by communitization agreement or otherwise? YES ____ NO ____ . If answer is "yes," Type of Consolidation _____
3. If the answer to question two is "no," list all the owners and their respective interests below:

Owner	Land Description

SECTION B

CERTIFICATION

I hereby certify that the information in SECTION A above is true and complete to the best of my knowledge and belief.

Name	Chas. W. Johnson
Position	Office Manager
Company	Argo Oil Corporation
Date	November 23, 1959

I hereby certify that the well location shown on the plat in SECTION B was plotted from field notes of actual surveys made by me or under my supervision, and that the same is true and correct to the best of my knowledge and belief.

Date Surveyed	
Registered Professional Engineer and/or Land Surveyor	
Certificate No.	

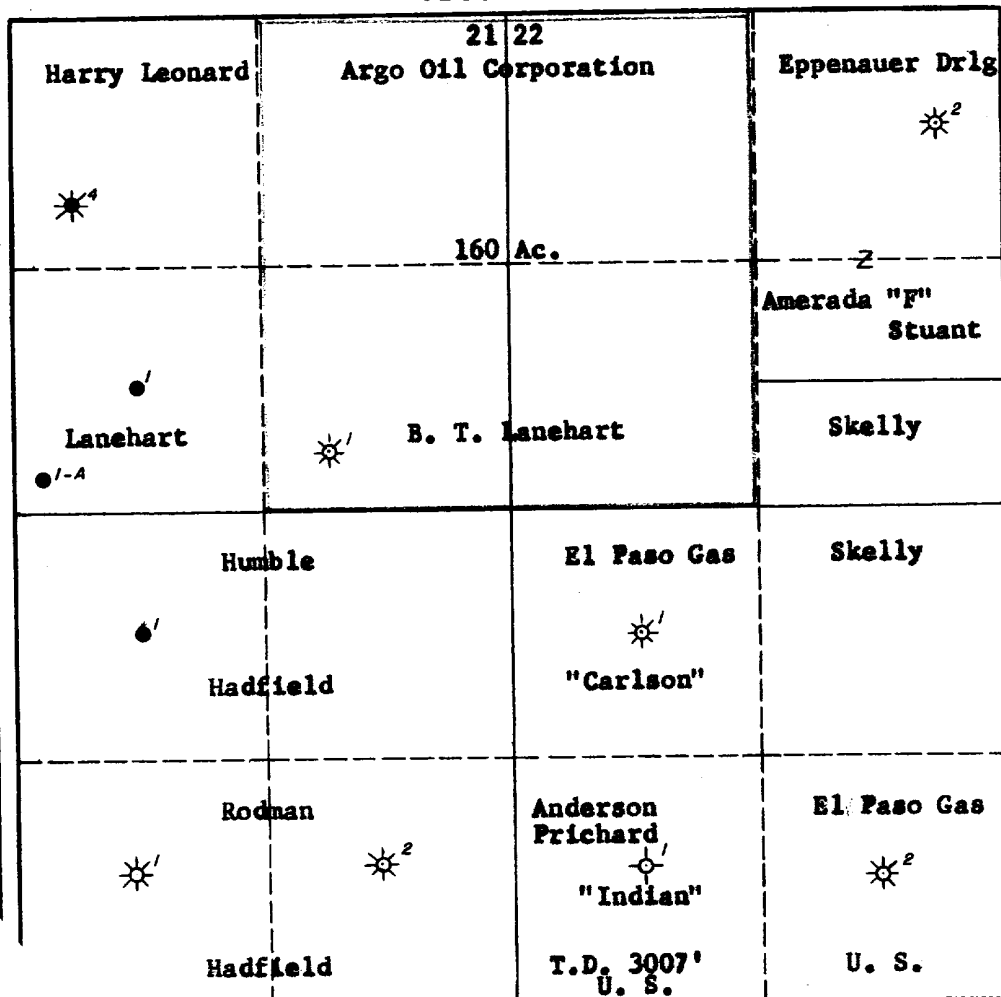

660 990 1320 1650 1980 2310 2640 2000 1500 1000 500 0

INSTRUCTIONS FOR COMPLETION OF FORM C-128

1. Operator shall furnish and certify to the information called for in Section A.
2. Operator shall outline the dedicated acreage for *both* oil and gas wells on the plat in Section B.
3. A registered professional engineer or land surveyor registered in the State of New Mexico or approved by the Commission shall show on the plat the location of the well and certify this information in the space provided.
4. All distances shown on the plat must be from the outer boundaries of the Section.
5. If additional space is needed for listing owners and their respective interests as required in question 3 of Section A, please use space below.

NEW MEXICO
OIL CONSERVATION COMMISSION

Gas Well Plat

Date January 8, 1954

Argo Oil Corporation

B. T. Lanehart

1

Operator

Lease

Well No.

Name of Producing Formation Yates Pool Jalco

No. Acres Dedicated to the Well 80

SECTION 21 TOWNSHIP 25 S RANGE 37 E

			2310' 80 Ac
			☀ 990'

I hereby certify that the information given above is true and complete to the best of my knowledge.

Name Chas. Johnson
Position District Clerical Supervisor
Representing Argo Oil Corporation
Address 1728 Milan Building
San Antonio 5, Texas

(over)

INSTRUCTIONS

1. Is this gas well a dual completion? Yes ____ No **X** ____
2. If the answer to Question 1 is Yes, are there any other dually completed wells within the dedicated acreage? Yes _____ No _____

A separate plat must be filed for each gas well, outlining the area dedicated to such well and showing the location of all other wells (oil and gas) within the outlined area.

Mail in duplicate to the district office for the district in which the well is located.

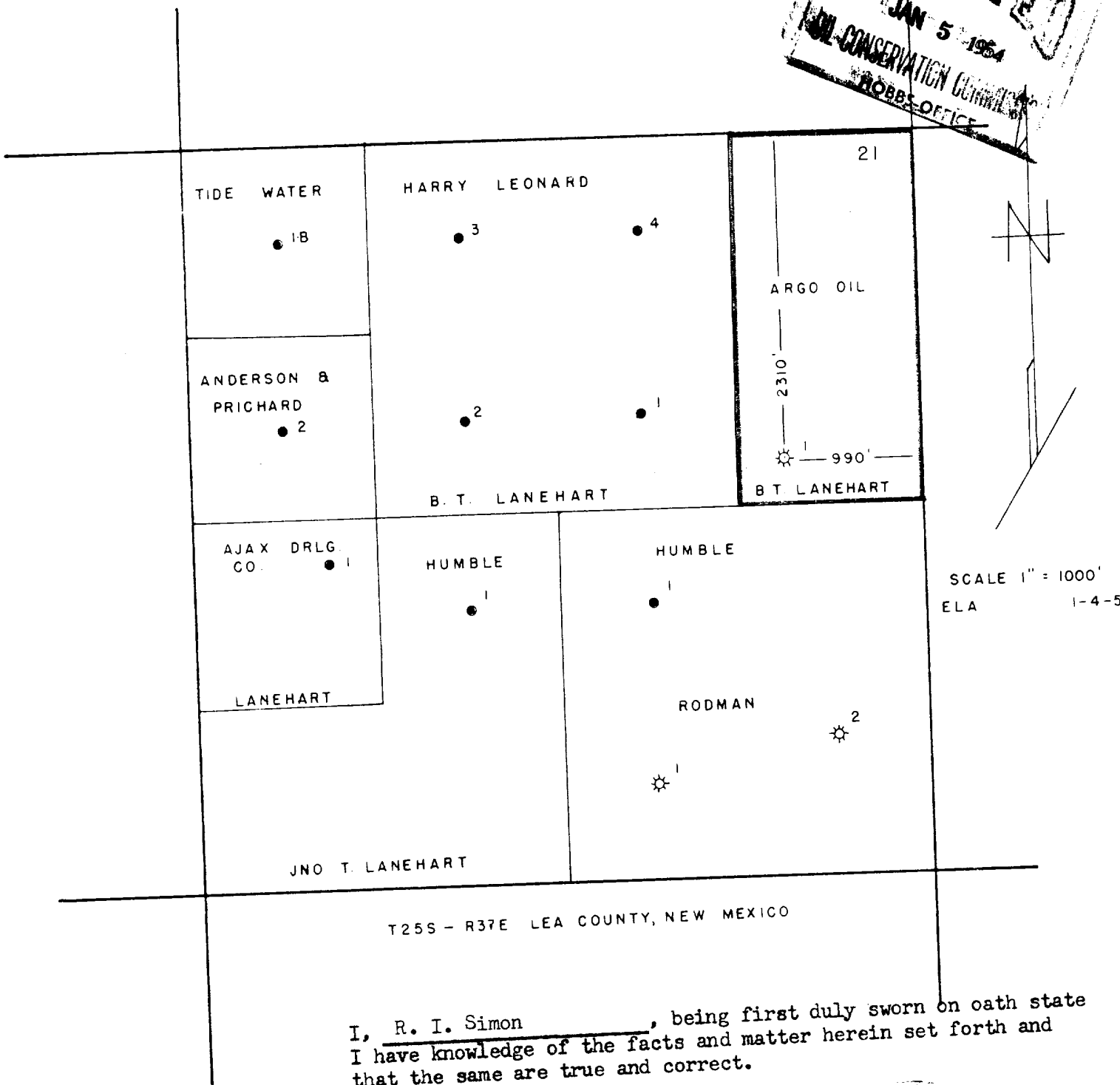
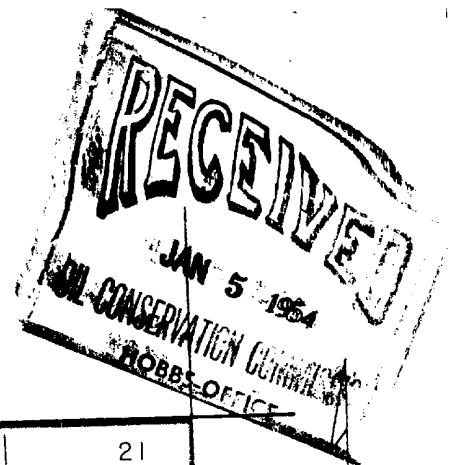

I, R. I. Simon, being first duly sworn on oath state I have knowledge of the facts and matter herein set forth and that the same are true and correct.

Subscribed and sworn to before me this 4th day of January, 1954

Julia Fuller
Notary Public, Bexar County, Texas
JULIA FULLER
Notary Public, Bexar County, Texas