

QWWO)

COUNTY LEA FIELD Langlie Mattix STATE NM MN 11688

OPR MOBIL OIL CORP. MAP

40 Langlie Mattix Queen Unit

Sec 22, T-25-S, R-37-E CO-ORD

1650' FNL, 1650' FEL of Sec

	CLASS		EL	
	FORMATION	DATUM	FORMATION	DATUM
Re-Cmp 10-29-71				
CSG & SX - TUBING				
10 3/4" at 162' w/150 sx				
7 5/8" at 1103' w/250 sx				
5 1/2" at 3285' w/200 sx.				
LOGS EL GR RA IND HC A				
	TD 3345'; PBD 3330'			

IP (Queen) Perfs & OH 3243-3330' P 2 BOPD + 64 BW. Pot based on 24 hr test. GOR TSTM; Grav 37.8.

Distribution limited and publication prohibited by subscribers' agreement.
Reproduction rights reserved by Williams & Lee Scouting Service, Inc.

CONT. PROP DEPTH 3330' TYPE Wt

DATE

F.R.C. 12-2-71; Opr's Elev. 3075' EE
PD 3330' WO (Queen)
(Orig. Amerada Pet. Corp. #1 Stuart, Frances,
comp 5-2-38 from OH 3285-3345', OTD 3345'; QWWO
& dual comp 4-20-59 thru Perfs 2697-3118' &
Perfs 3243-75', OPB 3280')
11-30-71 TD 3345'; PBD 3330'; COMPLETE
Sqzd (2697-3118') w/480 sx
Cleaned Out to 3330'
Perf 3278-85' w/1 SPF
Acid (3243-3330') 2000 gals
12-2-71 COMPLETION REPORTED

NEW MEXICO OIL CONSERVATION COMMISSION

Well Location and Acreage Dedication Plat

HOBBS OFFICE, OCC
August 27, 1959

Section A.

Date

Operator Amerada Petroleum Corporation Lease F. Stuart 1959 AUG 28 AM 10:24
Well No. 1 Unit Letter G Section 22 Township 25-S Range 37-E NMPM
Located 1650' Feet From North Line, 1650' Feet From East Line
County Log G. L. Elevation 3071' D.P. Dedicated Acreage 60 Acres
Name of Producing Formation Lower Yates Pool Jalnet

1. Is the Operator the only owner* in the dedicated acreage outlined on the plat below?
Yes X No .
2. If the answer to question one is "no," have the interests of all the owners been consolidated by communitization agreement or otherwise? Yes No . If answer is "yes," Type of Consolidation
3. If the answer to question two is "no," list all the owners and their respective interests below:

Owner

Land Description

Section B

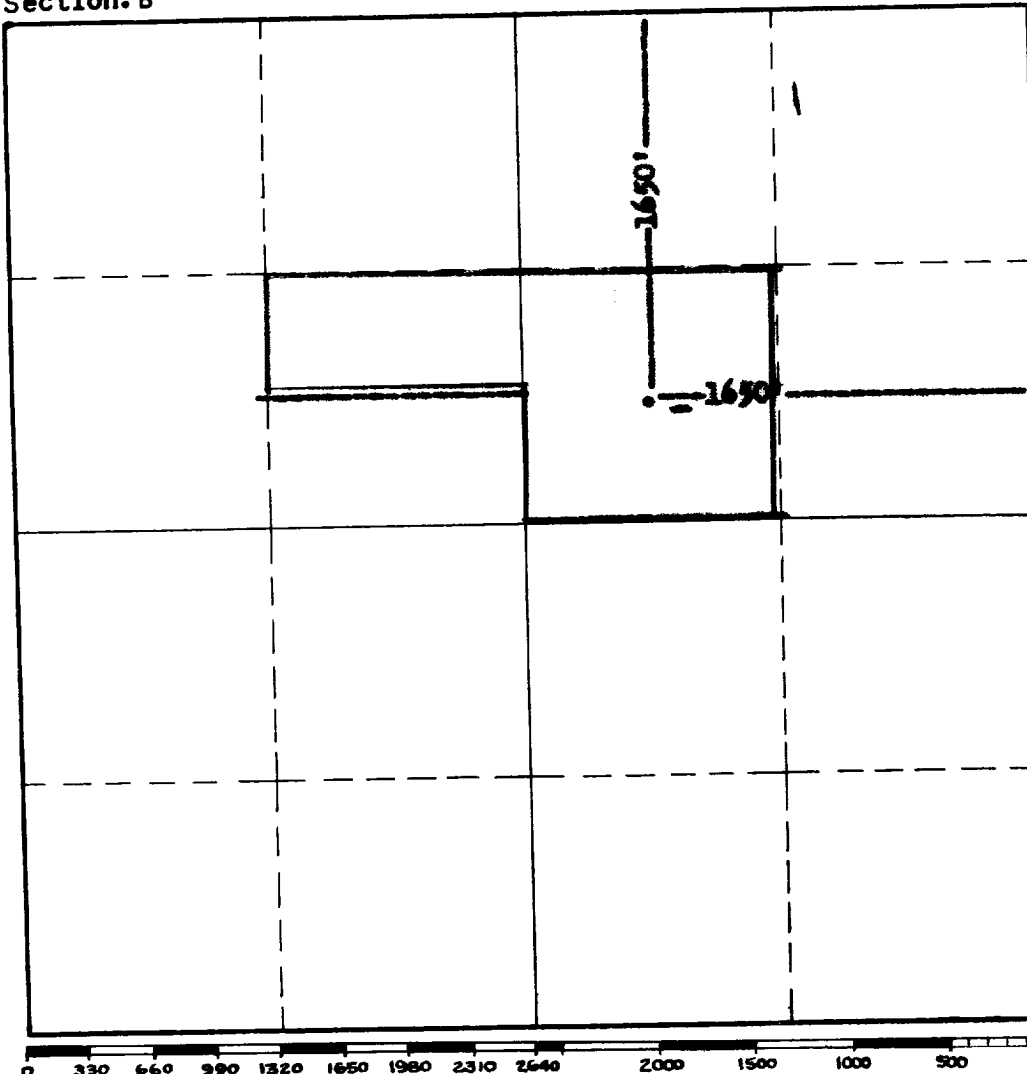

This is to certify that the information in Section A above is true and complete to the best of my knowledge and belief.

Amerada Petroleum Corporation
(Operator)

B. H. Moore
(Representative)

Box 706, Bernalillo, New Mexico
Address

This is to certify that the well location shown on the plat in Section B was plotted from field notes of actual surveys made by me or under my supervision and that the same is true and correct to the best of my knowledge and belief.

Date Surveyed

Registered Professional
Engineer and/or Land Surveyor.

Certificate No.

(See instructions for completing this form on the reverse side)

INSTRUCTIONS FOR COMPLETION:

1. Operator shall furnish and certify to the information called for in Section A.
2. Operator shall outline the dedicated acreage for both oil and gas wells on the plat in Section B.
3. A registered professional engineer or land surveyor registered in the State of New Mexico or approved by the Commission shall show on the plat the location of the well and certify this information in the space provided.
4. All distances shown on the plat must be from the outer boundaries of Section.
5. If additional space is needed for listing owners and their respective interests as required in question 3, Section A, please use space below

* "Owner" means the person who has the right to drill into and to produce from any pool and to appropriate the production either for himself or for himself and another. (65-3-29 (e) NMSA 1953 Comp.)