

District I  
PO Box 1989, Hobbs, NM 88241-1989  
District II  
PO Drawer 60, Aramis, NM 88211-0719  
District III  
1800 Rio Grande Rd., Alamo, NM 87410  
District IV  
PO Box 2088, Santa Fe, NM 87504-2088

State of New Mexico  
Energy, Minerals & Natural Resources Department

OIL CONSERVATION DIVISION  
PO Box 2088  
Santa Fe, NM 87504-2088

Form C-102  
Revised February 10, 1994  
Instructions on back  
Submit to Appropriate District Office  
State Lease - 4 Copies  
Fee Lease - 3 Copies

☐ AMENDED REPORT

WELL LOCATION AND ACREAGE DEDICATION PLAT

APN Number 30-025-11716		Pool Code 79240		Pool Name Jalmar Tan Yates SRO Gas	
Property Code 001542		Property Name Wimberly WN			Well Number 1
OGED No. 000990		Operator Name ARCO Permian			Elevation 3090' GR

10 Surface Location

UL or lot no.	Section	Township	Range	Lot Idn	Feet from the	North/South line	Feet from the	East/West line	County
F	23	25S	37E		1980	N	1980	W	Lea

11 Bottom Hole Location If Different From Surface

UL or lot no.	Section	Township	Range	Lot Idn	Feet from the	North/South line	Feet from the	East/West line	County

Dedication Address 120	John or L&P	Commodities Code	Order No.
---------------------------	-------------	------------------	-----------

NO ALLOWABLE WILL BE ASSIGNED TO THIS COMPLETION UNTIL ALL INTERESTS HAVE BEEN CONSOLIDATED  
OR A NON-STANDARD UNIT HAS BEEN APPROVED BY THE DIVISION

<p>16</p>	<p>17 OPERATOR CERTIFICATION</p> <p>I hereby certify that the information contained herein is true and complete to the best of my knowledge and belief.</p> <p><i>David K. Newell</i></p> <p>Signature</p> <p>David K. Newell</p> <p>Printed Name</p> <p>Senior Engineer</p> <p>Title</p> <p>6-26-95</p> <p>Date</p>
	<p>18 SURVEYOR CERTIFICATION</p> <p>I hereby certify that the well location shown on this plat was placed from field notes of actual surveys made by me or under my supervision, and that the same is true and correct to the best of my belief.</p> <p>Date of Survey</p> <p>Signature and Seal of Professional Surveyor:</p>
	<p>Certification Number</p>

All distances must be from the outer boundaries of the Section.

Operator ARCO Oil and Gas Company Division of Atlantic Richfield Co.			Lease Wimberly WN		Well No. 1
Unit Letter F	Section 23	Township 25S	Range 37E	County Lea	
Actual Footage Location of Well:					
1980 feet from the North line and		1980 feet from the West line			
Ground Level Elev. 3090'	Producing Formation Seven Rivers Qn	Pool Langlie Mattix	Dedicated Acreage: 40 Acres		

1. Outline the acreage dedicated to the subject well by colored pencil or hatchure marks on the plat below.
2. If more than one lease is dedicated to the well, outline each and identify the ownership thereof (both as to working interest and royalty).
3. If more than one lease of different ownership is dedicated to the well, have the interests of all owners been consolidated by communitization, unitization, force-pooling, etc?

☐ Yes ☐ No If answer is "yes," type of consolidation \_\_\_\_\_

If answer is "no," list the owners and tract descriptions which have actually been consolidated. (Use reverse side of this form if necessary.) \_\_\_\_\_

No allowable will be assigned to the well until all interests have been consolidated (by communitization, unitization, forced-pooling, or otherwise) or until a non-standard unit, eliminating such interests, has been approved by the Division.

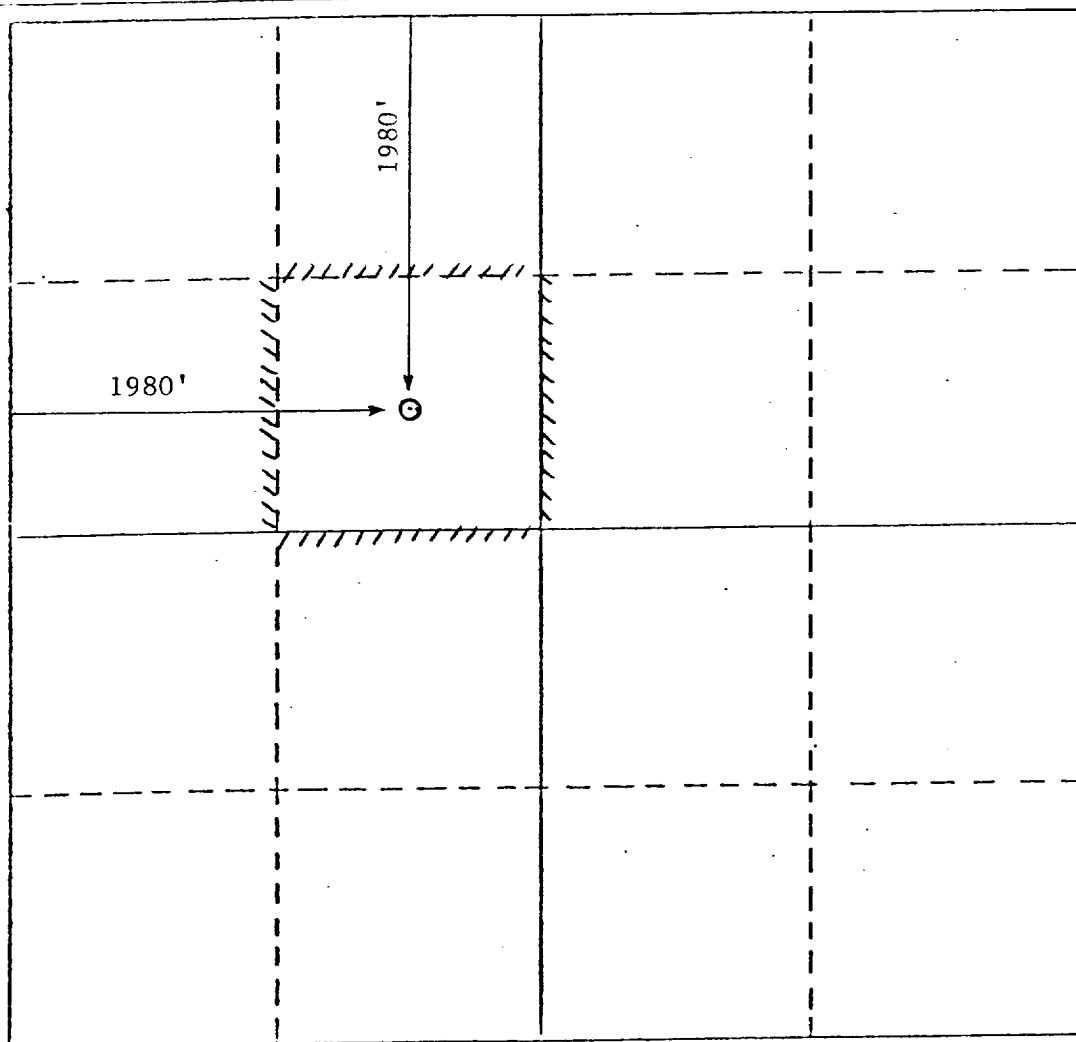

CERTIFICATION

I hereby certify that the information contained herein is true and complete to the best of my knowledge and belief.

Name

*D. L. Shackelford*

Position

Engrg. Tech. Spec.

Company ARCO Oil and Gas Co.

Division of Atlantic Richfield Co.

Date

3-22-82

I hereby certify that the well location shown on this plat was plotted from field notes of actual surveys made by me or under my supervision, and that the same is true and correct to the best of my knowledge and belief.

Date Surveyed

Registered Professional Engineer and/or Land Surveyor

Certificate No.

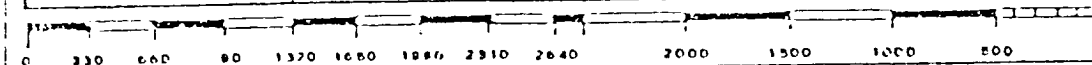

**RECEIVED**

**MAR 26 1982**

**O.C.D.  
ROBBS OFFICE**

NEW MEXICO  
OIL CONSERVATION COMMISSION

Gas Well Plate

Date November 27, 1953

Western Natural Gas Co. Winberly 1  
Operator Lease Well No.

Name of Producing Formation Iatas Pool Justis

No. Acres Dedicated to the Well 120

SECTION 22 TOWNSHIP 25S RANGE 37E

ASP-64

120 acres

E/2 - 120 acres

76126 23

I hereby certify that the information given above is true and complete to the best of my knowledge.

Name B. H. M. Roy  
Position Division Superintendent  
Representing Western Natural Gas Company  
Address 823 Midland Tower, Midland, Texas

(over)

## INSTRUCTIONS

- [illegible]

A separate plat must be filed for each gas well, outlining the area dedicated to such well and showing the location of all other wells (oil and gas) within the outlined area.

Mail in duplicate to the district office for the district in which the well is located.

