

MEXICO OIL CONSERVATION COMMISSION

Well Location and Acreage Dedication Plat

Section A.

Date November 22, 1957

Operator Tidewater Oil Company Lease A. B. Coates "C"  
Well No. 10 Unit Letter F Section 24 Township 25-S Range 37-E NMPM  
Located 1980 Feet From North Line, 2080 Feet From West Line  
County Lea G. L. Elevation \_\_\_\_\_ Dedicated Acreage 40 Acres  
Name of Producing Formation Ellenberger Pool Justis-Ellenberger

1. Is the Operator the only owner\* in the dedicated acreage outlined on the plat below?  
Yes ☒ No ☐.
2. If the answer to question one is "no," have the interests of all the owners been consolidated by communitization agreement or otherwise? Yes ☐ No ☐. If answer is "yes," Type of Consolidation \_\_\_\_\_
3. If the answer to question two is "no," list all the owners and their respective interests below:

Owner

Land Description

RECEIVED

NOV 25 1957

U. S. GEOLOGICAL SURVEY  
HOBBS, NEW MEXICO

Section B

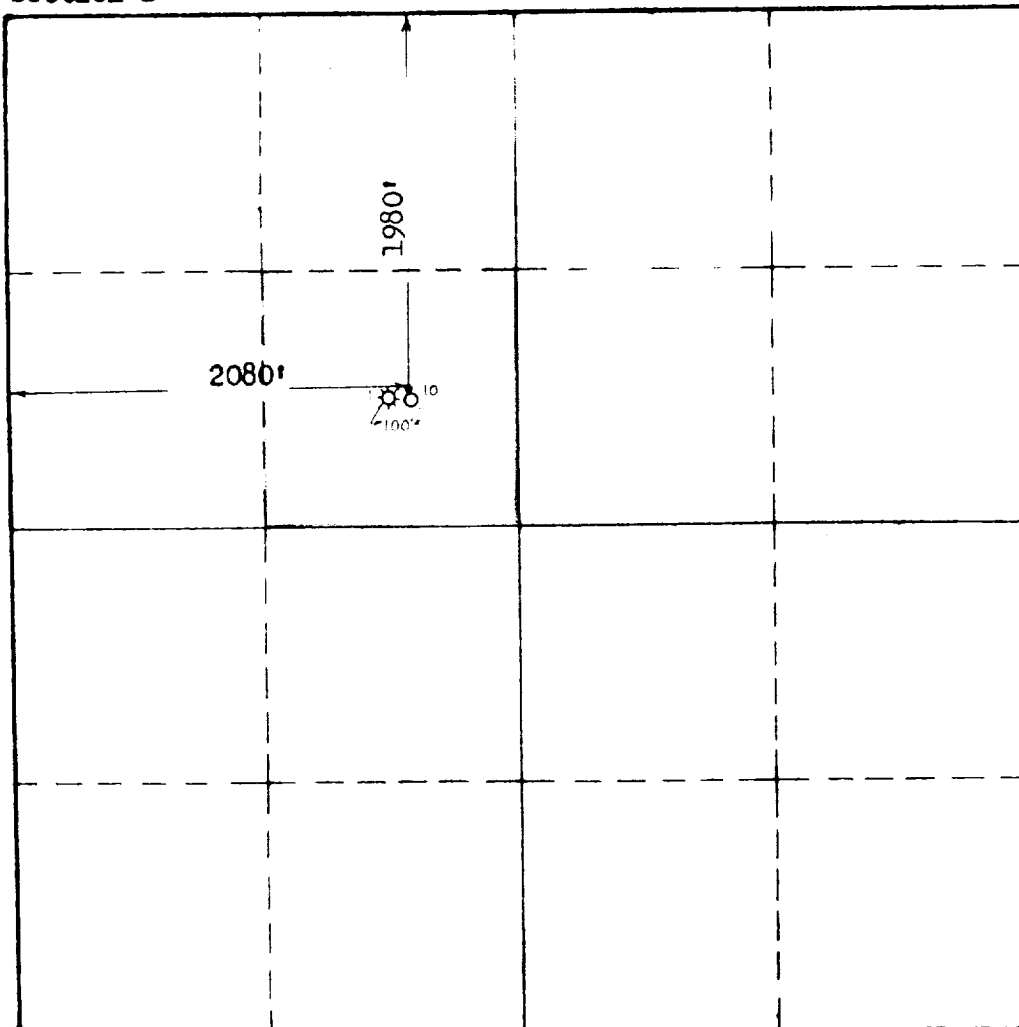

This is to certify that the information in Section A above is true and complete to the best of my knowledge and belief.

Tidewater Oil Company  
(Operator)

J. M. Amis

(Representative)

Box #1231, Midland, Texas  
Address

This is to certify that the well location shown on the plat in Section B was plotted from field notes of actual surveys made by me or under my supervision and that the same is true and correct to the best of my knowledge and belief.

Date Surveyed November 21, 1957

J. M. Amis (Company Employee)  
Registered Professional  
Engineer and/or Land Surveyor.

0 300 600 900 1200 1500 1800 2100 2400 2700 3000 3300 3600 3900 4200 4500 4800 5100 5400 5700 6000

Certificate No. 5129 and 465

(See instructions for completing this form on the reverse side) Texas