

UNITED STATES
DEPARTMENT OF THE INTERIOR
BUREAU OF LAND MANAGEMENT

N.M. Oil Cons. Division
1625 N. French Dr.
Hobbs, NM 88240
ECRM APPROVED
Budget Bureau No. 1004-0135
Expires: March 31, 1993

SUNDRY NOTICES AND REPORTS ON WELLS

Do not use this form for proposals to drill or to deepen or reentry to a different reservoir.

Use "APPLICATION FOR PERMIT --" for such proposals

SUBMIT IN TRIPLICATE

1. Type of Well: OIL WELL ☒ GAS WELL ☒ OTHER ☐
2. Name of Operator: TEXACO EXPLORATION & PRODUCTION INC.
3. Address and Telephone No.: PO BOX 3109, MIDLAND, TX 79702 915-688-475
4. Location of Well (Footage, Sec., T., R., M., or Survey Description):
Unit Letter O 660 Feet From The SOUTH Line and 1980 Feet From The
EAST Line Section 24 Township 25S Range 37E
5. Lease Designation and Serial No.: LC 032650 B
6. If Indian, Allottee or Tribe Name:
7. If Unit or CA, Agreement Designation:
8. Well Name and Number: COATES, A. B. -C- 15
9. API Well No.: 30 025 11728
10. Field and Pool, Exploratory Area: MID JUSTIS ABO
11. County or Parish, State: LEA, NEW MEXICO

12. Check Appropriate Box(s) To Indicate Nature of Notice, Report, or Other Data

TYPE OF SUBMISSION

☒ Notice of Intent
☐ Subsequent Report
☐ Final Abandonment Notice

☐ Abandonment
☐ Recompletion
☐ Plugging Back
☐ Casing Repair
☐ Attaching Casing
☐ OTHER:

TYPE OF ACTION

☒ Change of Plans
☐ New Construction
☐ Non-Routine Fracturing
☐ Water Shut-Off
☐ Conversion to Injection
☐ Dispose Water

(Note: Report results of multiple completion on Well Completion or Recompletion Report and Log Form.)

13. Describe Proposed or Completed Operations (Clearly state all pertinent details, and give pertinent dates, including estimated date of starting any proposed work. If well is directionally drilled, give subsurface locations and measured and true vertical depths for all markers and zones pertinent to this work.)

RECENTLY, TEXACO DIRECTIONALLY DRILLED A SIDETRACK IN THE ABO INTERVAL IN THE A.B. COATES C #9. TEXACO IS AWARE THAT TO PRODUCE THE #9 WELL IN THE ABO, A SIMULTANEOUS DEDICATION WOULD BE NEEDED. A HEARING DATE HAS BEEN SET FOR DECEMBER TO HEAR TEXACO'S REQUEST.

IN THE INTERIM TIME, TEXACO WILL SHUT IN THE A.B. COATES C #15 SO THE A.B. COATES C #9 CAN BE TESTED IN THE ABO FORMATION. THE WELL WILL REMAIN SHUT IN UNTIL TEXACO RECEIVES A RULING ON THE SIMULTANEOUS DEDICATION OF THE TWO WELLS IN THE MID JUSTIS ABO.

IF THERE ARE ANY QUESTIONS, PLEASE CALL ME AT 915-688-4752, OR CALL DENISE WANN AT 915-688-2982.

14. I hereby certify that the foregoing is true and correct

SIGNATURE *J. Denise Leake* TITLE Engineering Assistant

DATE 11/12/01

TYPE OR PRINT NAME J. Denise Leake

(This space for Federal or State office use)

APPROVED

CONDITIONS OF APPROVAL IF ANY: TITLE

DATE 12/27/2001

Title 18 U.S.C. Section 1001, makes it a crime for any person knowingly and willfully to make to any department or agency of the United States any false, fictitious or fraudulent statements or representations as to any matter within its jurisdiction

DISTRICT I

P.O. Box 1980, Hobbs, NM 88241-1980

DISTRICT II

P.O. Box Drawer DD, Artesia, NM 88211-0719

DISTRICT III

1000 Rio Brazos Rd., Aztec, NM 87410

DISTRICT IV

P.O. Box 2088, Santa Fe, NM 87504-2088

State of New Mexico

Energy, Minerals and Natural Resources Department

Form C-102

Revised February 10, 1999

Instructions on back

Submit to Appropriate District Office

State Lease - 4 Copies

Fee Lease - 3 Copies

✓ AMENDED REPORT

OIL CONSERVATION DIVISION

P.O. Box 2088

Santa Fe, New Mexico 87504-2088

WELL LOCATION AND ACREAGE DEDICATION PLAT

1 API Number 30 025 11728	2 Pool Code 96543	3 Pool Name MID JUSTIS ABO
4 Property Code 10913	5 Property Name COATES, A. B. -C-	6 Well No. 15
7 OGRID Number 022351	8 Operator Name TEXACO EXPLORATION & PRODUCTION INC.	9 Elevation 3084' KB

10 Surface Location

UI or lot no	Section	Township	Range	Lot.Idn	Feet From The	North/South Line	Feet From The	East/West Line	County
O	24	25S	37E		660	SOUTH	1980	EAST	LEA

11 Bottom Hole Location If Different From Surface

UI or lot no	Section	Township	Range	Lot.Idn	Feet From The	North/South Line	Feet From The	East/West Line	County
P	24	25S	37E		1260	SOUTH	735	EAST	LEA

12 Dedicated Acre 160	13 Joint or Infill No	14 Consolidation Code	15 Order No.
--------------------------	--------------------------	-----------------------	--------------

NO ALLOWABLE WILL BE ASSIGNED TO THIS COMPLETION UNTIL ALL INTERESTS HAVE BEEN CONSOLIDATED
OR A NON-STANDARD UNIT HAS BEEN APPROVED BY THE DIVISION

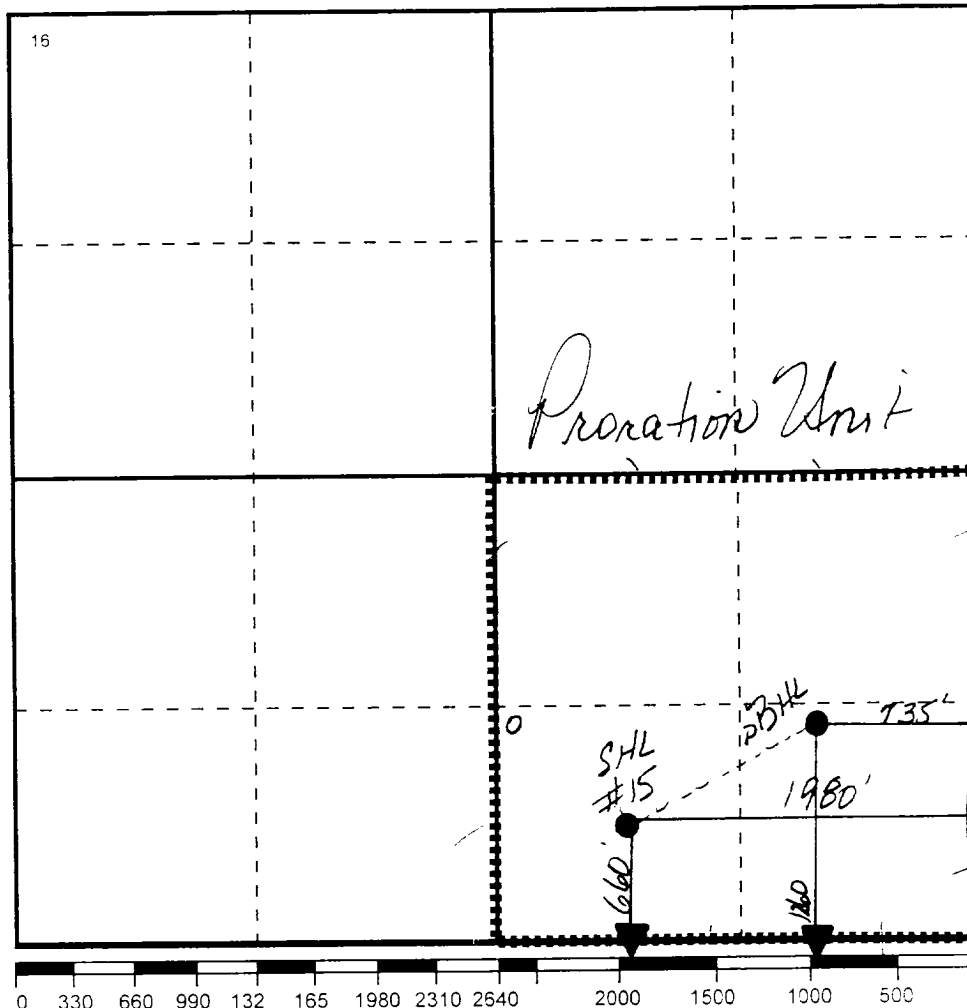

17 OPERATOR CERTIFICATION

I hereby certify that the information contained herein is true and complete to the best of my knowledge and belief

Signature

Printed Name

J. Denise Leake

Position

Engineering Assistant

Date

11/12/01

18 SURVEYOR CERTIFICATION

I hereby certify that the well location shown on this plat was plotted from field notes of actual surveys made by me or under my supervision, and that the same is true and correct to the best of my knowledge and belief.

Date Surveyed

Signature & Seal of
Professional Surveyor

Certificate No.