

INDEXED OFFICE 000
1959 MAY 20 AM 10:56

May 18, 1959

DUAL COMPLETION APPLICATION
Anderson-Prichard Oil Corp.
Carlson A #1
Justis (Fusselman & Drinkard Flds.
Lea County, New Mexico

New Mexico Oil Conservation Commission
Box 871
Santa Fe, New Mexico

Attention: Mr. A. L. Porter, Jr. Secretary-Director

Gentlemen:

In accordance with Order R-1214, Anderson-Prichard Oil Corporation requests administrative approval to dually complete the Subject well in the Justis-Fusselman (Oil) and Justis-Drinkard (Oil) Fields, Lea County, New Mexico.

All offset operators listed on the attached application have been notified by copy of this application through registered mail.

Yours very truly,

ANDERSON-PRICHARD OIL CORP.

R. W. Manry
District Engineer

RWM:ms

cc: 2- New Mexico Oil Conservation Commission, Hobbs, New Mexico
1- Amerada Petroleum Company, Drawer D, Monument, New Mexico
1- Atlantic Refining Company, Box 871, Midland, Texas
1- Pan American Petroleum Corporation, Box 268, Lubbock, Texas
1- Shelly Oil Company, Box 38, Hobbs, New Mexico
1- Western Petroleum Company, Jal, New Mexico
1- R. Olsen Oil Company, Jal, New Mexico

NEW MEXICO OIL CONSERVATION COMMISSION

SANTA FE, NEW MEXICO

7-3-58

APPLICATION FOR DUAL COMPLETION

Field Name Partie		County Lea		Date May 15, 1959
Operator Anderson-Prichard Oil Corp.		Lease Carlson "A"		Well No. 1
Location of Well J	Unit 85	Section 85	Township 85	Range 37E

1. Has the New Mexico Oil Conservation Commission heretofore authorized the dual completion of a well in these same pools or in the same zones within one mile of the subject well? YES ☒ NO ☐
2. If answer is yes, identify one such instance: Order No. **EC-789**; Operator, Lease, and Well No.: **Atlantic Ref. Co., Carlson #1 - Federal**

3. The following facts are submitted:	Upper Zone	Lower Zone
a. Name of reservoir	Brinkard	Pecos
b. Top and Bottom of Pay Section (Perforations)	9850 - 9906	6896 - 6950
c. Type of production (Oil or Gas)	Oil	Oil
d. Method of Production (Flowing or Artificial Lift)	Flow	Flow

4. The following are attached. (Please mark YES or NO)

- ☒ a. Diagrammatic Sketch of the Dual Completion, showing all casing strings, including size and setting, top of cement, perforated intervals, tubing strings, including diameters and setting depth, location and type of packers and side door chokes, and such other information as may be pertinent.
- ☒ b. Plat showing the location of all wells on applicant's lease, all offset wells on offset leases, and the names and addresses of operators of all leases offsetting applicant's lease.
- ☒ c. Waivers consenting to such dual completion from each offset operator, or in lieu thereof, evidence that said offset operators have been furnished copies of the application.*
- ☒ d. Electrical log of the well or other acceptable log with tops and bottoms of producing zones and intervals of perforation indicated thereon. (If such log is not available at the time application is filed, it shall be submitted as provided by Rule 112-A.)

5. List all offset operators to the lease on which this well is located together with their correct mailing address.

Amerasia Petroleum Company, Drawer B, Monument, New Mexico

Atlantic Refining Company, Box 871, Midland, Texas

Pan American Petroleum Corporation, Box 268, Lubbock, Texas

Shelly Oil Company, Box 38, Hobbs, New Mexico

Western Petroleum Company, Jal, New Mexico

R. Olsen Oil Company, Jal, New Mexico

ILLEGIBLE

6. Were all operators listed in Item 5 above notified and furnished a copy of this application? YES ☒ NO ☐ . If answer is yes, give date of such notification **May 18, 1959**

CERTIFICATE: I, the undersigned, state that I am the **District Engineer** of the **Anderson-Prichard Oil Corporation** (company), and that I am authorized by said company to make this report; and that this report was prepared under my supervision and direction and that the facts stated therein are true, correct and complete to the best of my knowledge.

R. W. Mandy
Signature

* Should waivers from all offset operators not accompany an application for administrative approval, the New Mexico Oil Conservation Commission will hold the application for a period of twenty (20) days from date of receipt by the Commission's Santa Fe office. If, after said twenty-day period, no protest nor request for hearing is received by the Santa Fe office, the application will then be processed.

NOTE: If the proposed dual completion will result in an unorthodox well location and/or a non-standard perforation unit in either or both of the producing zones, then separate application for approval of the same should be filed simultaneously with this application.

1.04

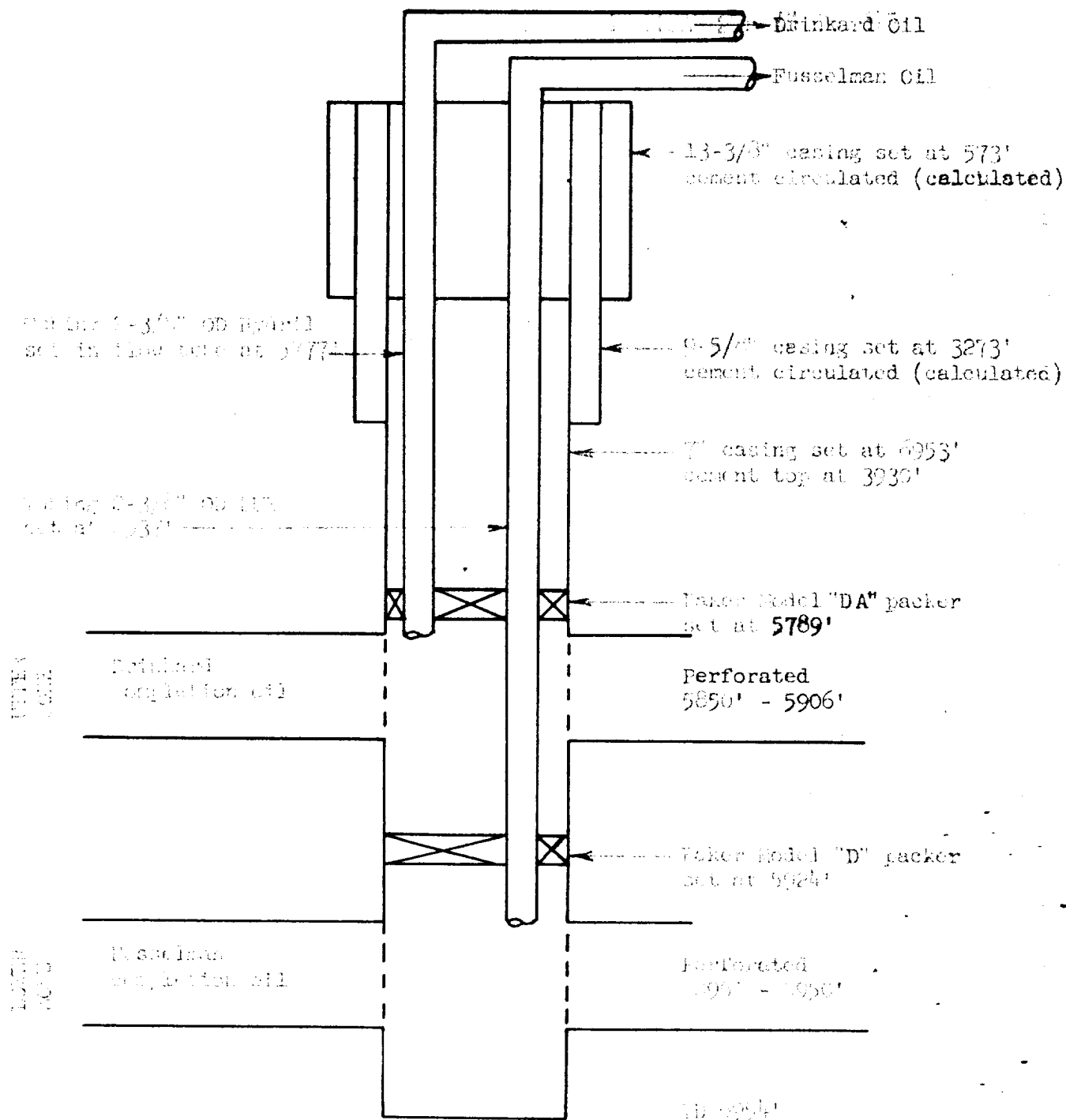

TO: Mr. and Mrs. Richard G. Corporation
 FROM: Mr. and Mrs. A. No. 1
 FOR: Mr. and Mrs. G. No. 1, Section 25,
 Mr. and Mrs. G. No. 1, Los Angeles, New Mexico
 FROM: Mr. and Mrs. G. No. 1
 FOR: Mr. and Mrs. G. No. 1

ILLEGIBLE

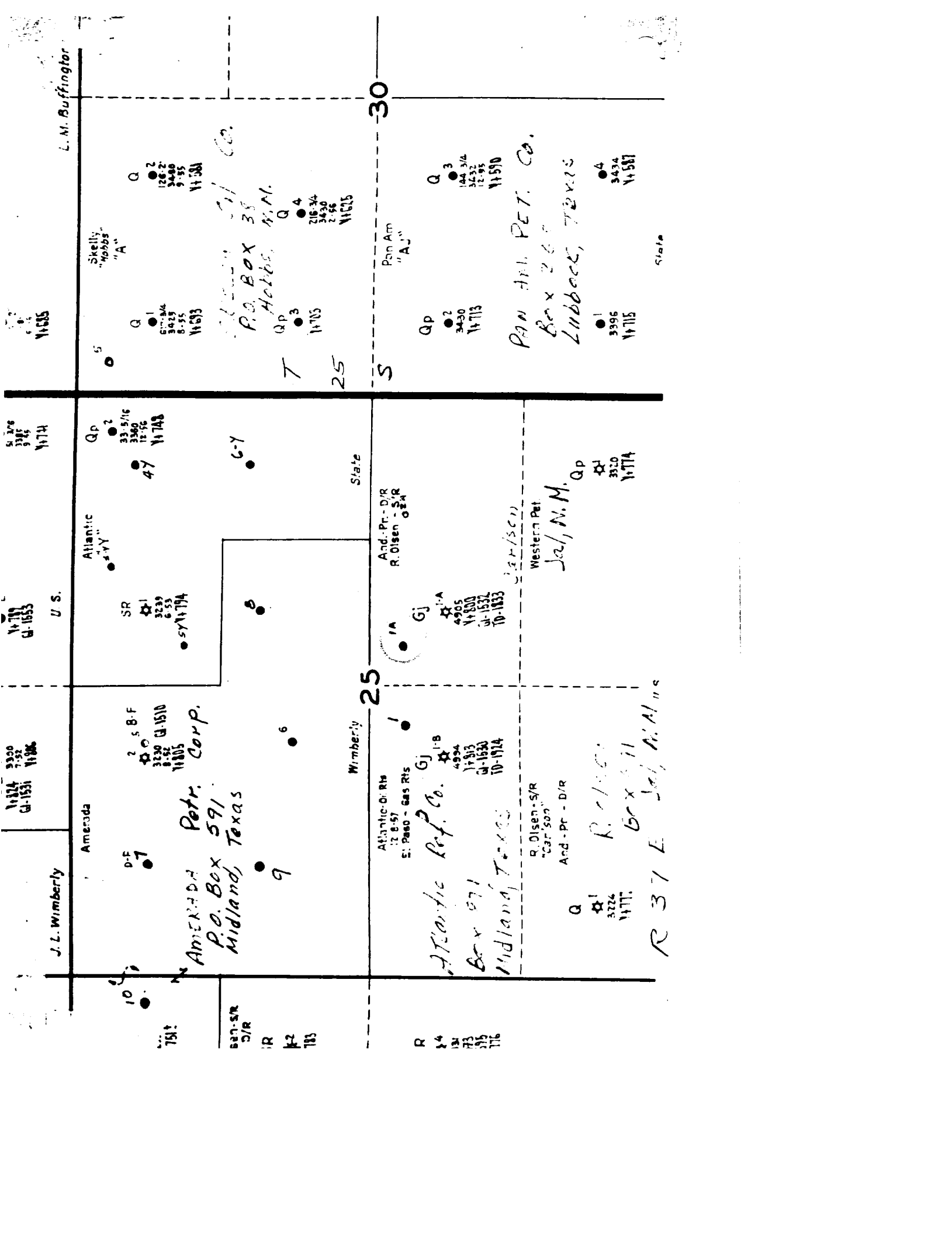

J.L. Wimberly

U.S.

J.L. Wimberly

Amerada

Atlantic

Skelly

AMERADA Petr. Corp.
P.O. Box 591
Midland, Texas

P.O. Box 38
Hobbs, N.M.

PAN AM. PET. Co.
Box 260
Lubbock, Texas

Wimberly

Atlantic Ref. Co.

And. Pr - D/R

R. Olsen - S/R

And - Pr - D/R

Western Pet

Jal, N.M.

R 37 E Jal, N.M.

25

30

25

7

sen-sr
D/R

R

12

783

R

14

131

73

515

716

1

Gj

1-B

4924

11-513

Q-1530

10-1914

Atlantic Ref. Co.

Box 271

Midland, Texas

Q

1

3224

1477

R. Olsen

Box 260

Lubbock, Texas

Q

3

144 3/4

3432

12-95

11590

Q

1

3996

14715

3434

14587

Q

3

144 3/4

3432

12-95

11590

Q

1

3996

14715

3434

14587

Q

3

144 3/4

3432

12-95

11590

Q

1

3996

14715

3434

14587

Q

3

144 3/4

3432

12-95

11590

Q

1

3996

14715

3434

14587

Q

3

144 3/4

3432

12-95

11590

Q

1

3996

14715

3434

14587

Q

3

144 3/4

3432

12-95

11590

Q

1

3996

14715

3434

14587

Q

3

144 3/4

3432

12-95

11590

Q

1

3996

14715

3434

14587

Q

3

144 3/4

3432

12-95

11590

Q

1

3996

14715

3434

14587

Q

3

144 3/4

3432

12-95

11590

Q

1

3996

14715

3434

14587

Q

3

144 3/4

3432

12-95

11590

Q

1

3996

14715

3434

14587

Q

3

144 3/4

3432

12-95

11590

Q

1

3996

14715

3434

14587

Q

3

144 3/4

3432

12-95

11590

Q

1

3996

14715

3434

14587

Q

3

144 3/4

3432

12-95

11590

Q

1

3996

14715

3434

14587

Q

3

144 3/4

3432

12-95

11590

Q

1

3996

14715

3434

14587

Q

3

144 3/4

3432

12-95

11590

Q

1

3996

14715

3434

14587

Q

3

144 3/4

3432

12-95

11590

Q

1

3996

14715

3434

14587

Q

3

144 3/4

3432

12-95

11590

Q

1

3996

14715

3434

14587

Q

3

144 3/4

3432

12-95

11590

Q

1

3996

14715

3434

14587

Q

3

144 3/4

3432

12-95

11590

Q

1

3996

14715

3434

14587

Q

3

144 3/4

3432

12-95

11590

Q

1

3996

14715

3434

14587

Q

3

144 3/4

3432

12-95

11590

Q

1

3996

14715

3434

14587

Q

3