

6 AM 9:05

NEW MEXICO
OIL CONSERVATION COMMISSION

Form C-128

Well Location and/or Gas Proration Plat

Date May 2, 1957

Operator El Paso Natural Gas Company

1957 Lease

Carlson Federal

Well No. 1-3 Section 25 Township 25 S Range 37 E NMPM

Located 1980 Feet From South Line, 1980 Feet From West Line,

Lee

County, New Mexico. G. L. Elevation 3049

Name of Producing Formation Clarietta Pool Justin Dedicated Acreage 160

(Note: All distances must be from outer boundaries of Section)

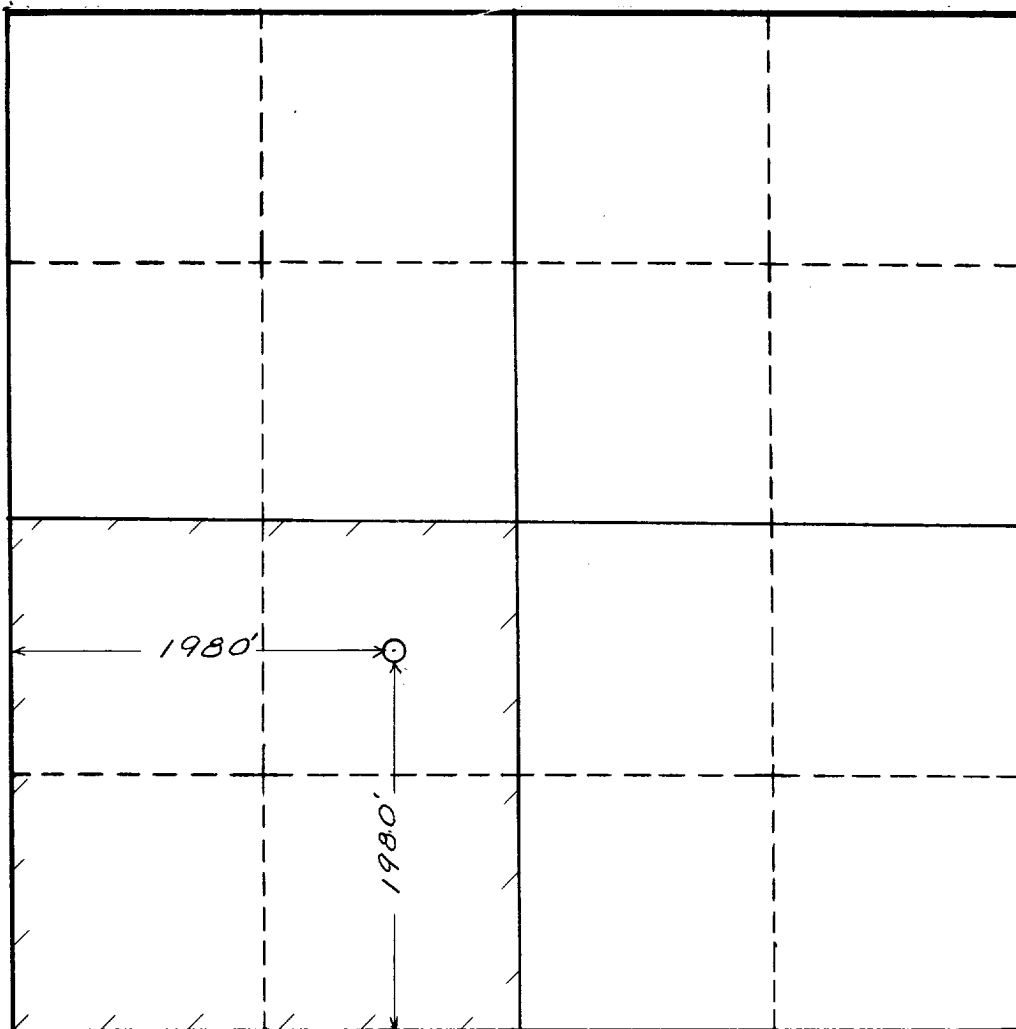

SCALE: 1"=1000'

1. Is this Well a Dual Comp. ? Yes No X
2. If the answer to Question 1 is yes, are there any other dually completed wells within the dedicated acreage? Yes No

Name R. T. Wright R. T. Wright

Position Petroleum Engineer

Representing El Paso Natural Gas Company

Address P. O. Box 1384, San, New Mexico

This is to certify that the above plat was prepared from field notes of actual surveys made by me or under my supervision and that the same are true and correct to the best of my knowledge and belief.

Date Surveyed

Registered Professional Engineer and/or Land Surveyor