

NEW MEXICO
OIL CONSERVATION COMMISSION

Form C-128

Well Location and/or Gas Proration Plat

HOBBS OFFICE OCC

Date 11-23-56

Operator AMERADA PETROLEUM CORP. Lease IMA HAYS

1955 NOV 25 AM 8:49

Well No. 1 Section 29 Township 25 SOUTH Range 37 EAST NMPM

Located 1980 Feet From WEST Line, 660 Feet From SOUTH Line,

LEA

County, New Mexico. G. L. Elevation _____

Name of Producing Formation _____ Pool _____ Dedicated Acreage _____

(Note: All distances must be from outer boundaries of Section)

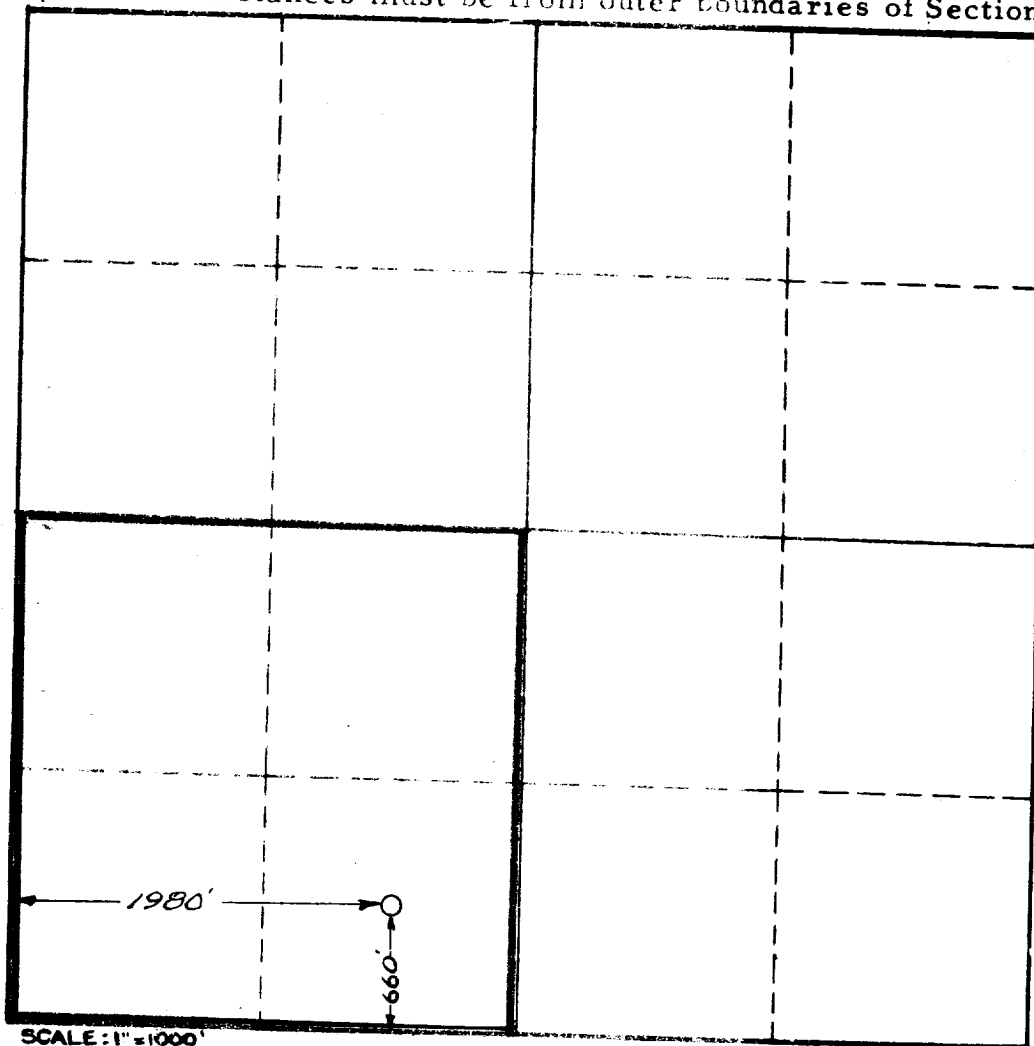

SCALE: 1"=1000'

1. Is this Well a Dual Comp. ? Yes ___ No ___
2. If the answer to Question 1 is yes, are there any other dually completed wells within the dedicated acreage? Yes ___ No ___

This is to certify that the above plat was prepared from field notes of actual surveys made by me or under my supervision and that the same are true and correct to the best of my knowledge and belief.

Name _____
Position _____
Representing _____
Address _____

Date Surveyed 11-21-56
John W. Whit
Registered Professional Engineer and/or
Land Surveyor