

NEW MEXICO
OIL CONSERVATION COMMISSION

Form C-128

Well Location and/or Gas Proration Plat

HOBBS OFFICE

Date **October 22, 1956**

Operator Gulf Oil Corp. Lease Arnett Ramsay "B"

Well No. 3-D Section 32 Township 25-S Range 37-E NMPM

Located 660 Feet From north Line, 660 Feet From east Line,

Lea County, New Mexico. G. L. Elevation _____

Name of Producing Formation _____ Pool _____ Dedicated Acreage _____

(Note: All distances must be from outer boundaries of Section)

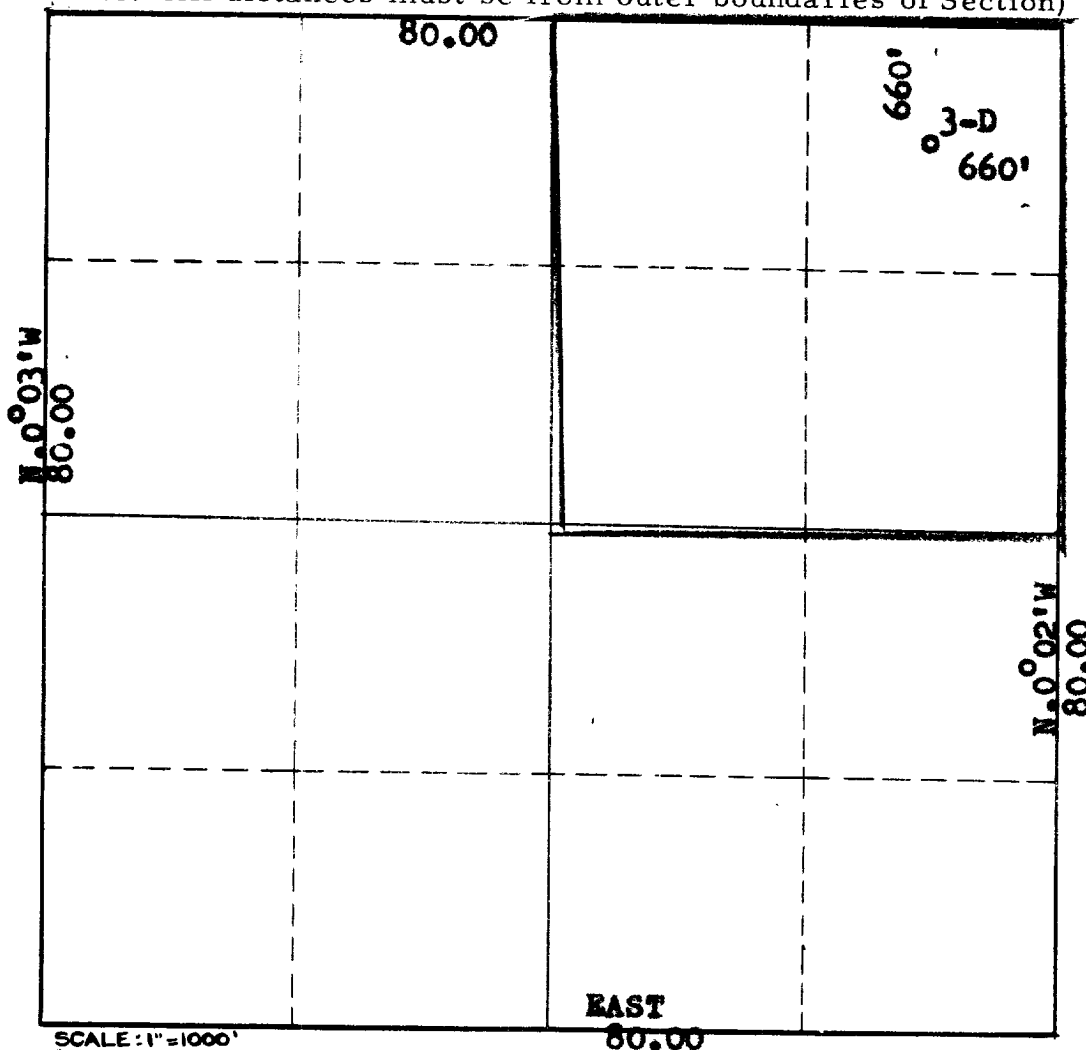

1. Is this Well a Dual Comp. ? Yes ☐ No ☐.
2. If the answer to Question 1 is yes, are there any other dually completed wells within the dedicated acreage? Yes ☐ No ☐.

This is to certify that the above plat was prepared from field notes of actual surveys made by me or under my supervision and that the same are true and correct to the best of my knowledge and belief.

Name _____
Position _____
Representing _____
Address _____

Date Surveyed **October 22, 1956**

Registered Professional Engineer and/or
Land Surveyor *[Signature]*

ELF 3/11/02
ABOVE DATE DOES NOT
INDICATE WHEN
CONFIDENTIAL LOGS
WILL BE RELEASED