

REVISED 7/1/82
(Form # 105)

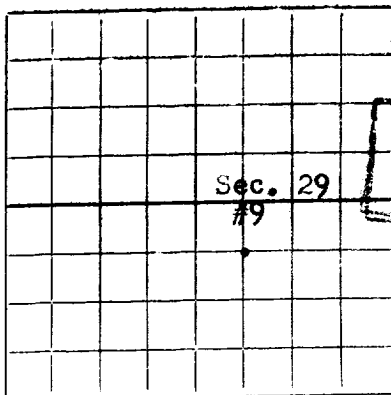

AREA 640 ACRES
LOCATE WELL CORRECTLY

Skelly Oil Company

(Company or Operator)

NEW MEXICO OIL CONSERVATION COMMISSION

Santa Fe, New Mexico

RECEIVED

DEC 10 1953

QIL CONSERVATION COMMISSION

HOBBS-OFFICE

WELL RECORD

Mail to District Office, Oil Conservation Commission, to which Form C-101 was sent not later than twenty days after completion of well. Follow instructions in Rules and Regulations of the Commission. Submit in QUINTUPLICATE.

Skelly Oil Company Mexico "K"
(Company or Operator) (Lease)

Well No. 9, in NW 1/4 of SE 1/4, of Sec. 29, T. 24S, R. 38E, NMPM.
Dollarhide Drinkard Pool, Lea County.

Well is 1980 feet from South line and 1980 feet from East line
of Section 29. If State Land the Oil and Gas Lease No. is ?

Drilling Commenced Nov. 3, 1953, 19..... Drilling was Completed Dec. 6, 1953, 19.....

Name of Drilling Contractor Parker Drilling Company

Address. Tulsa, Oklahoma

Elevation above sea level at Top of Tubing Head 3221' DF The information given is to be kept confidential until
Not confidential, 19.....

OIL SANDS OR ZONES

No. 1, from 6635' to 6935' No. 4, from _____ to _____

No. 2, from _____ to _____ No. 5, from _____ to _____

No. 3, from _____ to _____ No. 6, from _____ to _____

IMPORTANT WATER SANDS

Include data on rate of water inflow and elevation to which water rose in hole.

No. 1, from to feet.

No. 2, from to feet.

No. 3, from to feet.

No. 4, from to feet.

CASING RECORD

SIZE	WEIGHT PER FOOT	NEW OR USED	AMOUNT	KIND OF SHOE	CUT AND PULLED FROM	PERFORATIONS	PURPOSE
8-5/8"	24 & 32#	New	3128'	Float			Surface
5-1/2"	14 & 15.5#	"	6924'	"			Production

MUDDING AND CEMENTING RECORD

SIZE OF HOLE	SIZE OF CASING	WHERE SET	NO. SACKS OF CEMENT	METHOD USED	MUD GRAVITY	AMOUNT OF MUD USED
11"	8-5/8"	3150'	1900	Halliburton		
7-7/8"	5-1/2"	6935'	450	"		

RECORD OF PRODUCTION AND STIMULATION

(Record the Process used, No. of Qts. or Gals. used, interval treated or shot.)

Acidized open hole section 6635-6935' with 4000 Gals. acid in 2 stages.

Result of Production Stimulation After acid treatment well flowed 197 B bls. oil in 24 hours thru
3/4" choke. Corrected Gravity 37.1 Deg. T.P. 70#. Gas tested at rate of 122.2 MCF per Day.

..Depth Cleaned Out.....

If drill-stem or other special tests or deviation surveys were made, submit report on separate sheet and attach hereto

Rotary tools were used from 0 feet to 6935 feet, and from _____ feet to _____ feet.
Cable tools were used from _____ feet to _____ feet, and from _____ feet to _____ feet.

Put to Producing.....Dec. 5,.....1953

OIL WELL: The production during the first 24 hours was.....197.....barrels of liquid of which.....100.....% was oil;% was emulsion;% water; and.....% was sediment. A.P.I. Gravity.....37.1 Deg.....

GAS WELL: The production during the first 24 hours was.....M.C.F. plus.....barrels of liquid Hydrocarbon. Shut in Pressure.....lbs.

Length of Time Shut in.....

PLEASE INDICATE BELOW FORMATION TOPS (IN CONFORMANCE WITH GEOGRAPHICAL SECTION OF STATE):

Northwestern New Mexico

T. Anhy.....	1235'	T. Devonian.....	T. Ojo Alamo.....
T. Salt.....	1336'	T. Silurian.....	T. Kirtland-Fruitland.....
B. Salt.....	2660'	T. Montoya.....	T. Farmington.....
T. Yates.....	2781'	T. Simpson.....	T. Pictured Cliffs.....
T. 7 Rivers.....	3085'	T. McKee.....	T. Menefee.....
T. Queen.....	3800'	T. Ellenburger.....	T. Point Lookout.....
T. Grayburg.....	3994'	T. Gr. Wash.....	T. Mancos.....
T. San Andres.....	4218'	T. Granite.....	T. Dakota.....
T. Glorieta.....	5377'	T.	T. Morrison.....
T. Drinkard.....	6639'	T.	T. Penn.....
T. Tubbs.....	6260'	T.	T.
T. Abo.....		T.	T.
T. Penn.....		T.	T.
T. Miss.....		T.	T.

From	To	Thickness in Feet	Formation	From	To	Thickness in Feet	Formation
0	1235	1235	Red bed				
1235	2660	1425	Anhydrite & salt				
2660	3980	1320	Anhydrite, lime & sand				
3980	6935	2955	Lime				

I hereby swear or affirm that the information given herewith is a complete and correct record of the well and all work done on it so far as can be determined from available records.

December ~~18~~ 9, 1953 (Date)

Company or Operator Skelly Oil Company Address Box 38 - Hobbs, New Mexico

Name [Signature] Position or Title Dist. Supt.