

STATE OF NEW MEXICO
ENERGY AND MINERALS DEPARTMENT

OIL CONSERVATION DIVISION

P. O. BOX 2088

SANTA FE, NEW MEXICO 87501

Form C-101
Revised 10-1-78

NO. OF COPIES RECEIVED	
DISTRIBUTION	
SANTA FE	
FILE	
U.S.G.S.	
LAND OFFICE	
OPERATOR	

5A. Indicate Type of Lease
STATE ☐ FEE ☒

5. State Oil & Gas Lease No.

APPLICATION FOR PERMIT TO DRILL, DEEPEN, OR PLUG BACK

1a. Type of Work

b. Type of Well
OIL WELL ☐ GAS WELL ☐ OTHER WIW ☐ SINGLE ZONE ☒ MULTIPLE ZONE ☐

DRILL ☐ DEEPEN ☒ PLUG BACK ☐

2. Name of Operator

Sirgo-Collier, Inc.

3. Address of Operator

P. O. Box 3531, Midland, Texas 79702

4. Location of Well

UNIT LETTER N LOCATED 467' FEET FROM THE South LINE

AND 2310 FEET FROM THE West LINE OF SEC. 30 TWP. 24-S RGE. 38-E NMPM

7. Unit Agreement Name
West Dollarhide Queen Sand Unit

8. Farm or Lease Name

9. Well No.

20

10. Field and Pool, or Wildcat
Dollarhide Queen

12. County
Lea

11. Elevations (Show whether DF, RT, etc.) GL 3109'	21A. Kind & Status Plug. Bond Cash Statewide	19. Proposed Depth 3770'	19A. Formation Queen	20. Rotary or C.T. Rotary
		21B. Drilling Contractor	22. Approx. Date Work will start November 1, 1987	

23.

PROPOSED CASING AND CEMENT PROGRAM

SIZE OF HOLE	SIZE OF CASING	WEIGHT PER FOOT	SETTING DEPTH	SACKS OF CEMENT	EST. TOP
	* 9-5/8"	36#	305'	200	Surface
	* 7"	17#	3650'	975	Surface
	4-1/2"		3770'	400	Surface

Propose to deepen well from 3710' to 3770', run 4-1/2" casing to TD, selectively perforate Queen zones from 3576-3770' for injection purposes, and run 2-3/8" tubing with a Model R 4-1/2" x 2-3/8" packer, set at approximately 3400'. Propose to then inject a maximum of 400 bbls/day of water at 1100 PSI into the Queen formation.

* Casing already present in wellbore.

ABOVE SPACE DESCRIBE PROPOSED PROGRAM; IF PROPOSAL IS TO DEEPEN OR PLUG BACK, GIVE DATA ON PRESENT PRODUCTIVE ZONE AND PROPOSED NEW PRODUCTION ZONE. GIVE BLOWOUT PREVENTER PROGRAM, IF ANY.

hereby certify that the information above is true and complete to the best of my knowledge and belief.

Signed Amy L. Whitley Title Agent Date 10-9-87

(This space for State Use)

ORIGINAL SIGNED BY JERRY SEXTON

APPROVED BY DISTRICT 1 SUPERVISOR TITLE DATE OCT 14 1987

CONDITIONS OF APPROVAL, IF ANY:

Pending approval of authority to inject

WELL LOCATION SURVEY PLAT.

COMPANY Sinclair Oil & Gas Company
LEASE L. E. Vance
WELL NO. 3

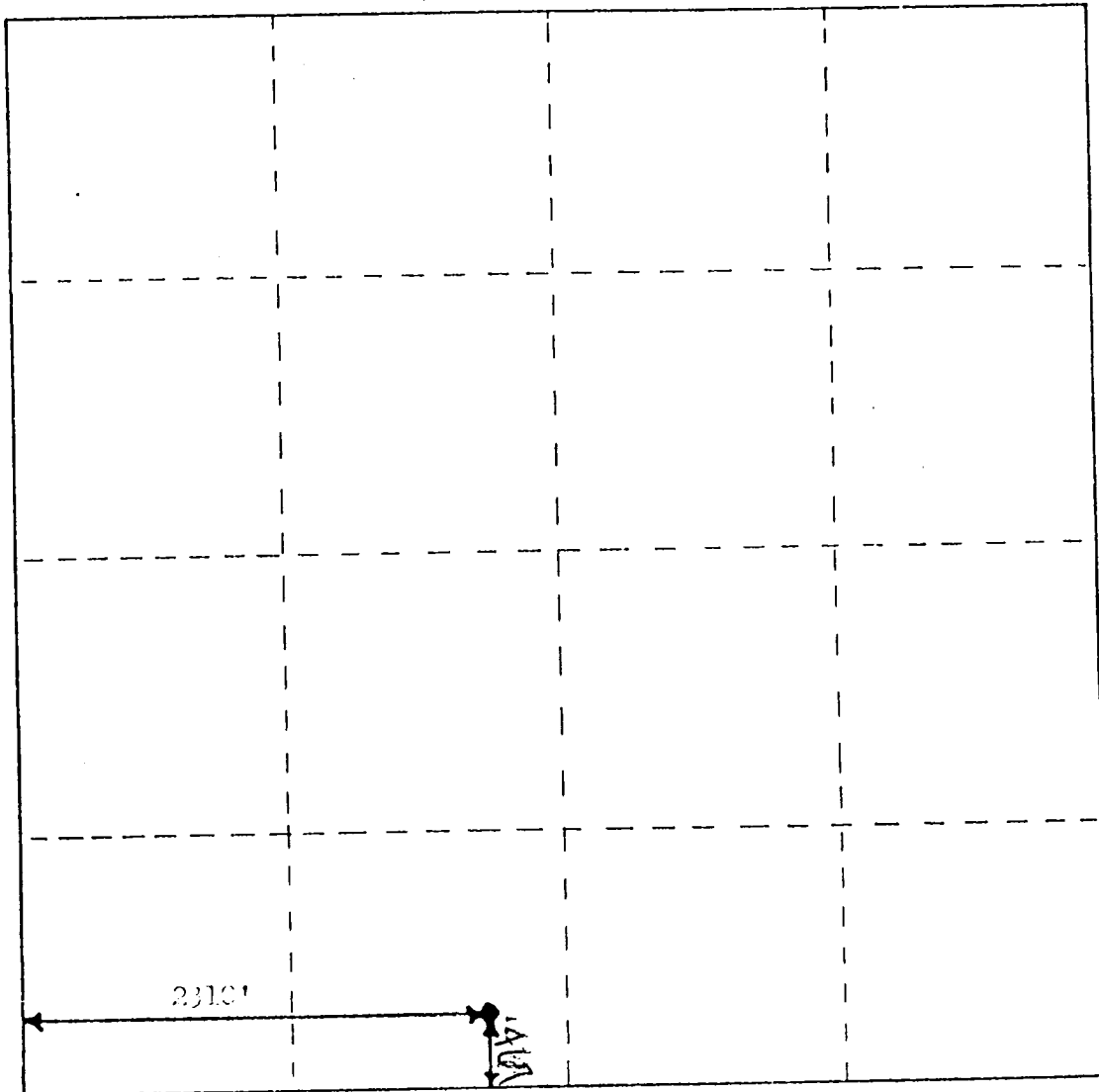

SEC. 30 TWP. 24 S. RGE. 33 E. N.M.P.M.

I CERTIFY THAT THIS SURVEY WAS MADE UNDER
MY DIRECTION, AND THAT THE PLAT IS CORRECT
TO THE BEST OF MY KNOWLEDGE.

Glen Haley

NEW MEXICO LICENSE NO. 273