

NO. OF COPIES RECEIVED	
DISTRIBUTION	
SANTA FE	
FILE	
U.S.G.S.	
LAND OFFICE	
OPERATOR	

NEW MEXICO OIL CONSERVATION COMMISSION

Form 7-101
Revised 11-65

5A. Indicate Type of Lease	
STATE <input checked="" type="checkbox"/>	FEE <input type="checkbox"/>
5. State Oil & Gas Lease No. B-9311	

APPLICATION FOR PERMIT TO DRILL, DEEPEN, OR PLUG BACK

1a. Type of Work		7. Unit Agreement Name	
b. Type of Well OIL WELL <input checked="" type="checkbox"/> GAS WELL <input type="checkbox"/> OTHER <input type="checkbox"/>		8. Farm or Lease Name Mexico "J"	
2. Name of Operator Skelly Oil Company		9. Well No. 4	
3. Address of Operator P. O. Box 1351, Midland, Texas 79701		10. Field and Pool, or Wildcat Dollarhide Fusselman	
4. Location of Well UNIT LETTER N LOCATED 660 FEET FROM THE South LINE 1980 FEET FROM THE West LINE OF SEC. 32 TWP. 24S RGE. 38E NMPM		11. County Lea	
18. Proposed Depth 8750'		19A. Formation Fusselman	
21. Elevations (Show whether DF, RT, etc.) 3162' DF		20. Rotary or C.T. ---	
21A. Kind & Status Plug. Bond Blanket Bond #1253688		21. Approx. Date Work will start Immediately	
21B. Drilling Contractor \$100,000 w/Fed. Ins. Co.			

PROPOSED CASING AND CEMENT PROGRAM

SIZE OF HOLE	SIZE OF CASING	WEIGHT PER FOOT	SETTING DEPTH	SACKS OF CEMENT	EST. TOP

As authorized by Order No. R-4602, exception to Rule 104 Commission Rules and Regulations, to produce two wells from the same proration unit, with production limited to one top unit allowable from each proration unit, we propose to plug back Well No. 4 from the Ellenburger to the Fusselman by performing the following work:

- 1) Move in pulling unit. Pull rods and tubing.
- 2) Set 5-1/2" bridge plug at 8770' and cap with two sacks of cement.
- 3) Perforate 5-1/2" casing with two shots per foot at the following intervals: 8454-8458', 8465-8468', 8482-8488', 8495-8502', 8539-8544', 8553-8457', 8694-8698' and 8704-8708'.
- 4) Set RTTS tool at approximately 8400'.
- 5) Treat Fusselman perforations 8454-8708' with 6000 gallons of 15% NE acid, with blocking agents and ball sealers, in six stages.
- 6) Pull RTTS tool.
- 7) Swab test well.
- 8) Re-treat if necessary.
- 9) Run tubing and rods.
- 10) Connect to flow line and produce well.

APPROVAL VALID
FOR 90 DAYS UNLESS
DRILLING COMM. CTD,

EXPIRES 1-12-74

IN ABOVE SPACE DESCRIBE PROPOSED PROGRAM: IF PROPOSAL IS TO DEEPEN OR PLUG BACK, GIVE DATA ON PRESENT PRODUCTIVE ZONE AND PROPOSED NEW PRODUCTIVE ZONE. GIVE BLOWOUT PREVENTER PROGRAM, IF ANY.

I hereby certify that the information above is true and complete to the best of my knowledge and belief.

B. A. Strickling, Jr. Dist. Operations Supt.

10-8-73

(SIGNED) **B. A. STRICKLING, JR.** Title _____ Date _____
(This space for State Use)

APPROVED BY _____ TITLE _____ DATE _____
CONDITIONS OF APPROVAL, IF ANY: _____

**NEW MEXICO OIL CONSERVATION COMMISSION
WELL LOCATION AND ACREAGE DEDICATION PLAT**

Form C-102
Supersedes C-128
Effective 1-1-65

All distances must be from the outer boundaries of the Section.

Operator Skelly Oil Company			Lease Mexico "J"		Well No. 4
Unit Letter N	Section 32	Township 24S	Range 38E	County Lea	
Actual Footage Location of Well: 660 feet from the South line and 1980 feet from the West line					
Ground Level Elev. 3150'	Producing Formation Fusselman		Pool Dollarhide Fusselman		Dedicated Acreage: 40 Acres

1. Outline the acreage dedicated to the subject well by colored pencil or hachure marks on the plat below.
2. If more than one lease is dedicated to the well, outline each and identify the ownership thereof (both as to working interest and royalty).
3. If more than one lease of different ownership is dedicated to the well, have the interests of all owners been consolidated by communitization, unitization, force-pooling, etc?

☐ Yes ☐ No If answer is "yes," type of consolidation _____

If answer is "no," list the owners and tract descriptions which have actually been consolidated. (Use reverse side of this form if necessary.) _____

No allowable will be assigned to the well until all interests have been consolidated (by communitization, unitization, forced-pooling, or otherwise) or until a non-standard unit, eliminating such interests, has been approved by the Commission.

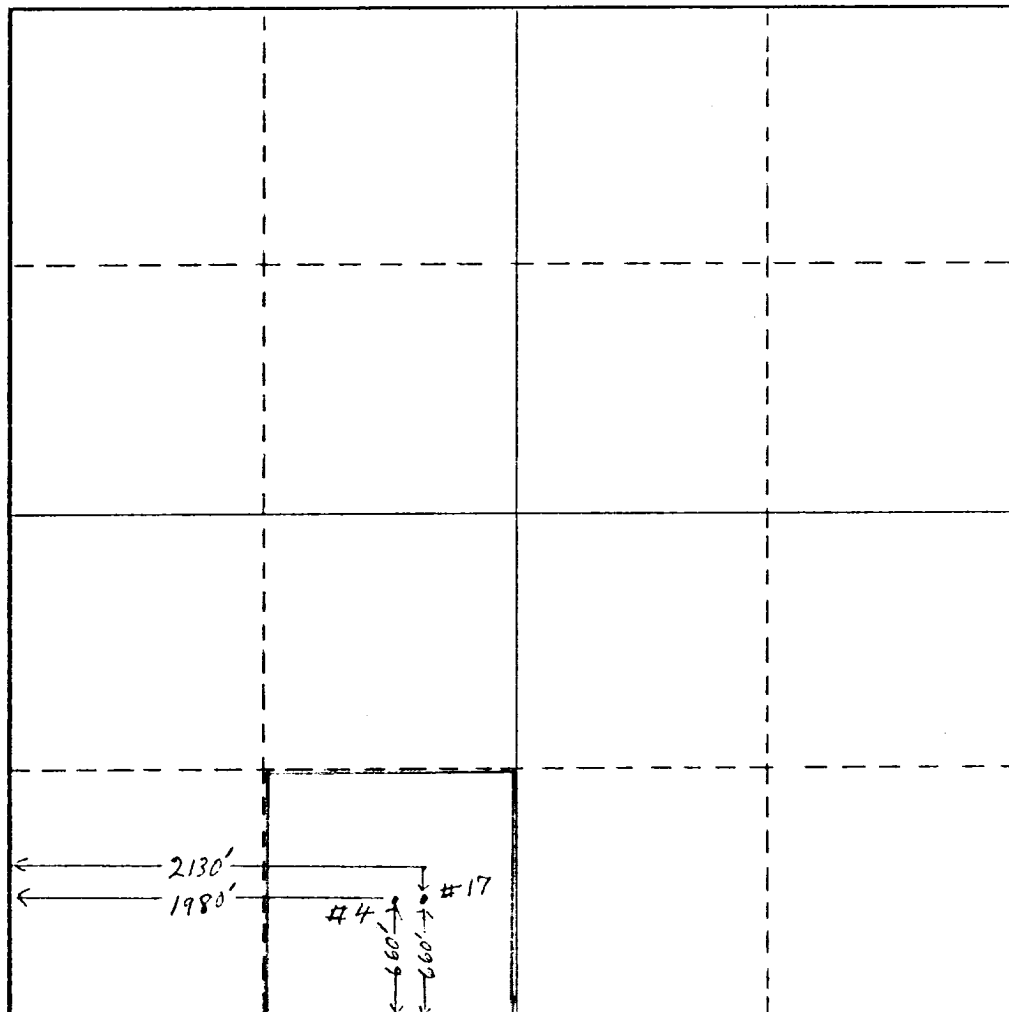

CERTIFICATION

I hereby certify that the information contained herein is true and complete to the best of my knowledge and belief.

Name
D. R. Crow (signed) D. R. Crow

Position
Lead Clerk

Company
Skelly Oil Company

Date
October 8, 1973

I hereby certify that the well location shown on this plat was plotted from field notes of actual surveys made by me or under my supervision, and that the same is true and correct to the best of my knowledge and belief.

Date Surveyed

Registered Professional Engineer
and/or Land Surveyor

Certificate No.

0 330 660 990 1320 1650 1980 2310 2400 2000 1500 1000 500 0