

DISTRICT I

P.O. Box 1980, Hobbs, NM 88241-1980

DISTRICT II

P.O. Box Drawer DD, Artesia, NM 88211-0719

DISTRICT III

1000 Rio Brazos Rd., Aztec, NM 87410

DISTRICT IV

P.O. Box 2088, Santa Fe, NM 87504-2088

State of New Mexico

Energy, Minerals and Natural Resources Department

Form C-101

Revised February 10, 1994

Instructions on back

Submit to Appropriate District Office

State Lease - 6 Copies

Fee Lease - 5 Copies

OIL CONSERVATION DIVISION

P.O. Box 2088

Santa Fe, New Mexico 87504-2088

☐ AMENDED REPORT

APPLICATION FOR PERMIT TO DRILL, RE-ENTER, DEEPEN, PLUGBACK, OR ADD A ZONE

| | | |
|---|--|---|
| ¹ Operator Name and Address TEXACO EXPLORATION & PRODUCTION INC. P.O. BOX 730, HOBBS, NM 88240 | | ² OGRID Number 022351 |
| | | ³ API Number 30 025 12299 |
| ⁴ Property Code 10996 | ⁵ Property Name MEXICO -J- | ⁶ Well No. 5 |

⁷ Surface Location

| Ul or lot no. | Section | Township | Range | Lot.Idn | Feet From The | North/South Line | Feet From The | East/West Line | County |
|---------------|---------|----------|-------|---------|---------------|------------------|---------------|----------------|--------|
| L | 32 | 24S | 38E | | 1980 | SOUTH | 660 | WEST | LEA |

⁸ Proposed Bottom Hole Location If Different From Surface

| Ul or lot no. | Section | Township | Range | Lot.Idn | Feet From The | North/South Line | Feet From The | East/West Line | County |
|---|---------|----------|-------|---------|-------------------------------|------------------|---------------|----------------|--------|
| ⁹ Proposed Pool 1 <i>Wildcat</i> BLINEBRY | | | | | ¹⁰ Proposed Pool 2 | | | | |

| | | | | |
|-----------------------------------|---------------------------------------|--|------------------------------------|---|
| ¹¹ Work Type Code P | ¹² WellType Code O | ¹³ Rotary or C.T. ROTARY | ¹⁴ Lease Type Code S | ¹⁵ Ground Level Elevation 3157' |
| ¹⁶ Multiple No | ¹⁷ Proposed Depth 5950' | ¹⁸ Formation BLINEBRY | ¹⁹ Contractor PRIDE | ²⁰ Spud Date 3/14/96 |

²¹ Proposed Casing and Cement Program

| SIZE OF HOLE | SIZE OF CASING | WEIGHT PER FOOT | SETTING DEPTH | SACKS OF CEMENT | EST. TOP |
|--------------|----------------|-----------------|---------------|-----------------|------------|
| 18" | 13-3/8" | 36# | 250' | 250sx | Cmt Circ. |
| 12-1/4" | 9-5/8" | 36# | 3150' | 1800sx | Cmt. Circ. |
| 7-7/8" | 5-1/2" | 17 & 15.5# | 8745' | 1294sx | Cmt. Circ. |
| | | | | | |
| | | | | | |

²² Describe the proposed program. If this application is to DEEPEN or PLUG BACK give the data on the present productive zone and proposed new productive zone. Describe the blowout prevention program, if any. Use additional sheets if necessary.

1. MIRU pulling unit. TOH w/rods and pump. Install BOP. TOH w/tbg.
2. TIH w/5 1/2" CIBP and set CIBP above above Devonian perms @ +/- 7650' (top Devonian perf @ 7700'). Cap w/ 35' cmt. Set CIBP at 5950'. Cap w/ 35' cmt. Spot 250 gals 15% HCL NEFE.
3. Perf 5 1/2" csg w/2 JSPF from 5413' - 5610'.
4. TIH w/pkr to +/- 5375'. Set pkr at +/- 5375. Load backside.
5. Acidize Blinebry perms 5413-5610' w/9000 gals 15% HCL NEFE w/ 225 ball sealers.
6. TOH w/ tbg and pkr.
7. TIH w/production tbg, pump and rods. Put well on production.

²³ I hereby certify that the rules and regulations of the Oil Conservation Division have been complied with and that the information given above is true and complete to the best of my knowledge and belief.

Signature

Paul R. Wilcox

Printed Name

Paul R. Wilcox

Title

Field Technician

Date

2/29/96

Telephone

397-0442

OIL CONSERVATION DIVISION

ORIGINAL SIGNED BY JERRY SEXTON
Approved By: DISTRICT I SUPERVISOR

Title:

Approval Date: MAR 07 1996

Expiration Date:

Conditions of Approval:

Attached ☐

2025 11 13

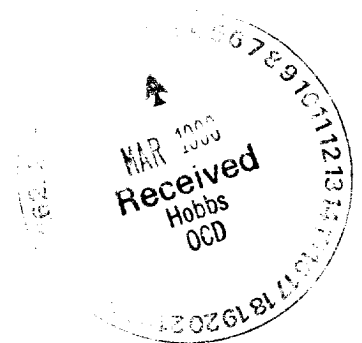

DISTRICT I

P.O. Box 1980, Hobbs, NM 88241-1980

DISTRICT II

P.O. Box Drawer DD, Artesia, NM 88211-0719

DISTRICT III

1000 Rio Brazos Rd., Aztec, NM 87410

DISTRICT IV

P.O. Box 2088, Santa Fe, NM 87504-2088

State of New Mexico

Energy, Minerals and Natural Resources Department

OIL CONSERVATION DIVISION

P.O. Box 2088

Santa Fe, New Mexico 87504-2088

Form C-10

Revised February 10, 1999

Instructions on back

Submit to Appropriate District Office

State Lease - 4 Copies

Fee Lease - 3 Copies

☐ AMENDED REPORT

WELL LOCATION AND ACREAGE DEDICATION PLAT

| | | | | | |
|------------------------------|--|---|--|---|----------------------|
| 1 API Number 30 025 12299 | | 2 Pool Code 6660 | | 3 Pool Name Wildcat BLINEBRY OIL AND GAS | |
| 4 Property Code 10996 | | 5 Property Name MEXICO -J- | | | 6 Well No. 5 |
| 7 OGRID Number 022351 | | 8 Operator Name TEXACO EXPLORATION & PRODUCTION INC. | | | 9 Elevation 3157' |

10 Surface Location

| | | | | | | | | | |
|--------------------|---------------|-----------------|--------------|---------|-----------------------|---------------------------|----------------------|------------------------|---------------|
| UI or lot no. L | Section 32 | Township 24S | Range 38E | Lot.Idn | Feet From The 1980 | North/South Line SOUTH | Feet From The 660 | East/West Line WEST | County LEA |
|--------------------|---------------|-----------------|--------------|---------|-----------------------|---------------------------|----------------------|------------------------|---------------|

11 Bottom Hole Location If Different From Surface

| | | | | | | | | | |
|--------------------------|--------------------------|----------|-----------------------|---------|---------------|------------------|---------------|----------------|--------|
| UI or lot no. | Section | Township | Range | Lot.Idn | Feet From The | North/South Line | Feet From The | East/West Line | County |
| 12 Dedicated Acres 40 | 13 Joint or Infill No | | 14 Consolidation Code | | 15 Order No. | | | | |

NO ALLOWABLE WILL BE ASSIGNED TO THIS COMPLETION UNTIL ALL INTERESTS HAVE BEEN CONSOLIDATED
OR A NON-STANDARD UNIT HAS BEEN APPROVED BY THE DIVISION

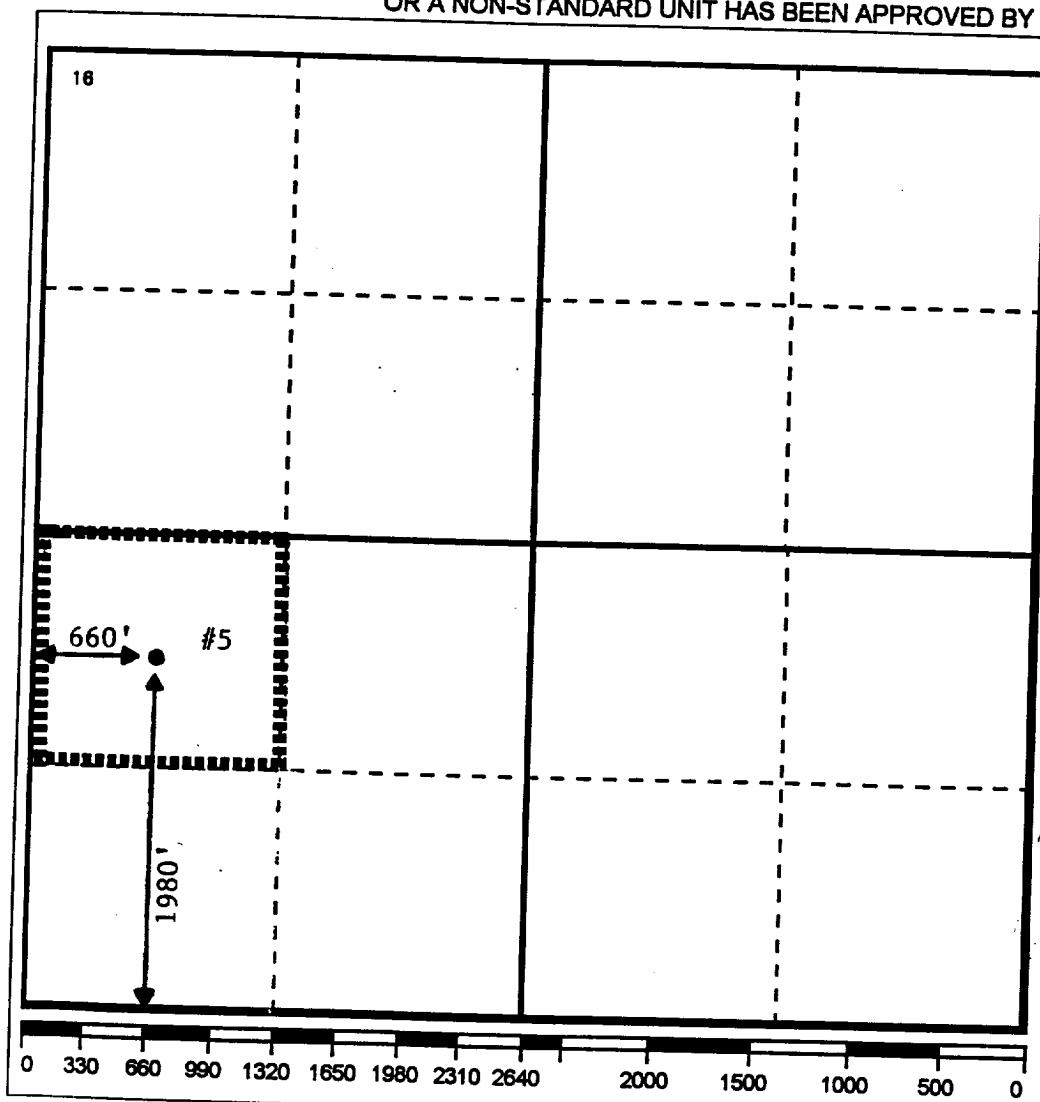

17 OPERATOR CERTIFICATION

I hereby certify that the information contained herein is true and complete to the best of my knowledge and belief

Signature

Printed Name

Paul R. Wilcox

Position

Field Technician

Date

3/4/96

18 SURVEYOR CERTIFICATION

I hereby certify that the well location shown on this plat was plotted from field notes of actual surveys made by me or under my supervision, and that the same is true and correct to the best of my knowledge and belief.

Date Surveyed

Signature & Seal of
Professional Surveyor

Certificate No.