

COPIES RECEIVED	
CONTRIBUTION	
SANITARY FEE	
STATE FEE	
LAND OFFICE	
OPERATOR	

NEW MEXICO OIL CONSERVATION COMMISSION

Form C-101
Revised 1-1-65

5A. Indicate Type of Lease	
STATE <input checked="" type="checkbox"/>	FEE <input type="checkbox"/>
5. State Oil & Gas Lease No.	
B-9311	
7. Unit Agreement Name	

8. Farm or Lease Name	
Mexico "J"	
9. Well No.	
5	
10. Field and Pool, or Wildcat	
Dollarhide Fusselman	
12. County	
Lea	
13. Proposed Depth	19A. Formation
7830' Plug back	Devonian
20. Rotary or C.T.	
21. Elevation (Show whether DF, RT, etc.)	
3157' DF	
21A. Kind & Status Plug. Bond	21B. Drilling Contractor
Blanket Bond #1253688	\$100,000 w/Fed. Ins. Co.
22. Approx. Date Work will start	

APPLICATION FOR PERMIT TO DRILL, DEEPEN, OR PLUG BACK					
1. Type of Work					
DRILL <input type="checkbox"/> DEEPEN <input type="checkbox"/> PLUG BACK <input checked="" type="checkbox"/>					
2. Location of Well					
GAS WELL <input checked="" type="checkbox"/> OTHER <input type="checkbox"/> SINGLE ZONE <input checked="" type="checkbox"/> MULTIPLE ZONE <input type="checkbox"/>					
3. Name of Operator					
Skelly Oil Company					
4. Address of Operator					
P. O. Box 1351, Midland, Texas 79701					
5. Location of Well					
UNIT LETTER	0	LOCATED	1980	FEET FROM THE	South LINE
AND	660	FEET FROM THE	West	LINE OF SEC.	32
		TWP.	24S	RGE.	38E
		NMPM			
23. PROPOSED CASING AND CEMENT PROGRAM					

SIZE OF HOLE	SIZE OF CASING	WEIGHT PER FOOT	SETTING DEPTH	SACKS OF CEMENT	EST. TOP
No Change					

- 1) Move in workover rig. Pull tubing.
- 2) Set Cast Iron Bridge Plug 7870' with cement to plug back to 7830' PBTD.
- 3) Perforate 5-1/2" OD casing 7700-7704', 7706-7710', 7714-7717', 7719-7723', 7725-7731', 7736-7740', 7773-7777', 7788-7807' with one shot per foot.
- 4) Treat perfs. 7700-7807' with 7000 gallons 15% NE acid in 4 stages using diverting material.
- 5) Swab test. If zone proves commercial, set tubing and return to production.
- If unsuccessful:
- 6) Perforate 5-1/2" OD casing 7585-7600', 7604-7607', 7613-7622', 7626-7732', 7642-7646' with one shot per foot.
- 7) Isolate perfs. 7585-7646' and treat with 8,000 gallons 15% NE acid in 5 stages with diverting material.
- 8) Return well to producing status pumping Devonian perfs. 7585-7807'.

IN ABOVE SPACE DESCRIBE PROPOSED PROGRAM: IF PROPOSAL IS TO DEEPEN OR PLUG BACK, GIVE DATA ON PRESENT PRODUCTIVE ZONE AND PROPOSED NEW PRODUCTIVE ZONE. GIVE BLOWOUT PREVENTER PROGRAM, IF ANY.

I hereby certify that the information above is true and complete to the best of my knowledge and belief.

(Signed) **D. R. Crow** Title **Lead Clerk** Date **1-5-76**

(This space for State Use)

APPROVED BY **John Sexton** TITLE **Asst. Supv.** DATE **JAN 9 1976**

CONDITIONS OF APPROVAL, IF ANY:

**NEW MEXICO OIL CONSERVATION COMMISSION
WELL LOCATION AND ACREAGE DEDICATION PLAT**

Form C-102
Supersedes C-128
Effective 1-1-65

All distances must be from the outer boundaries of the Section.

Operator Skelly Oil Company			Lease Mexico "J"		Well No. 5
Unit Letter 0	Section 32	Township 24S	Range 38E	County Lea	
Actual Footage Location of Well: 1980 feet from the South line and 660 feet from the West line					
Ground Level Elev. 3157' DF	Producing Formation Devonian		Pool Dollarhide Devonian	Dedicated Acreage: 40 Acres	

1. Outline the acreage dedicated to the subject well by colored pencil or hachure marks on the plat below.
2. If more than one lease is dedicated to the well, outline each and identify the ownership thereof (both as to working interest and royalty).
3. If more than one lease of different ownership is dedicated to the well, have the interests of all owners been consolidated by communitization, unitization, force-pooling, etc?

☐ Yes ☐ No If answer is "yes," type of consolidation _____

If answer is "no," list the owners and tract descriptions which have actually been consolidated. (Use reverse side of this form if necessary.) _____

No allowable will be assigned to the well until all interests have been consolidated (by communitization, unitization, forced-pooling, or otherwise) or until a non-standard unit, eliminating such interests, has been approved by the Commission.

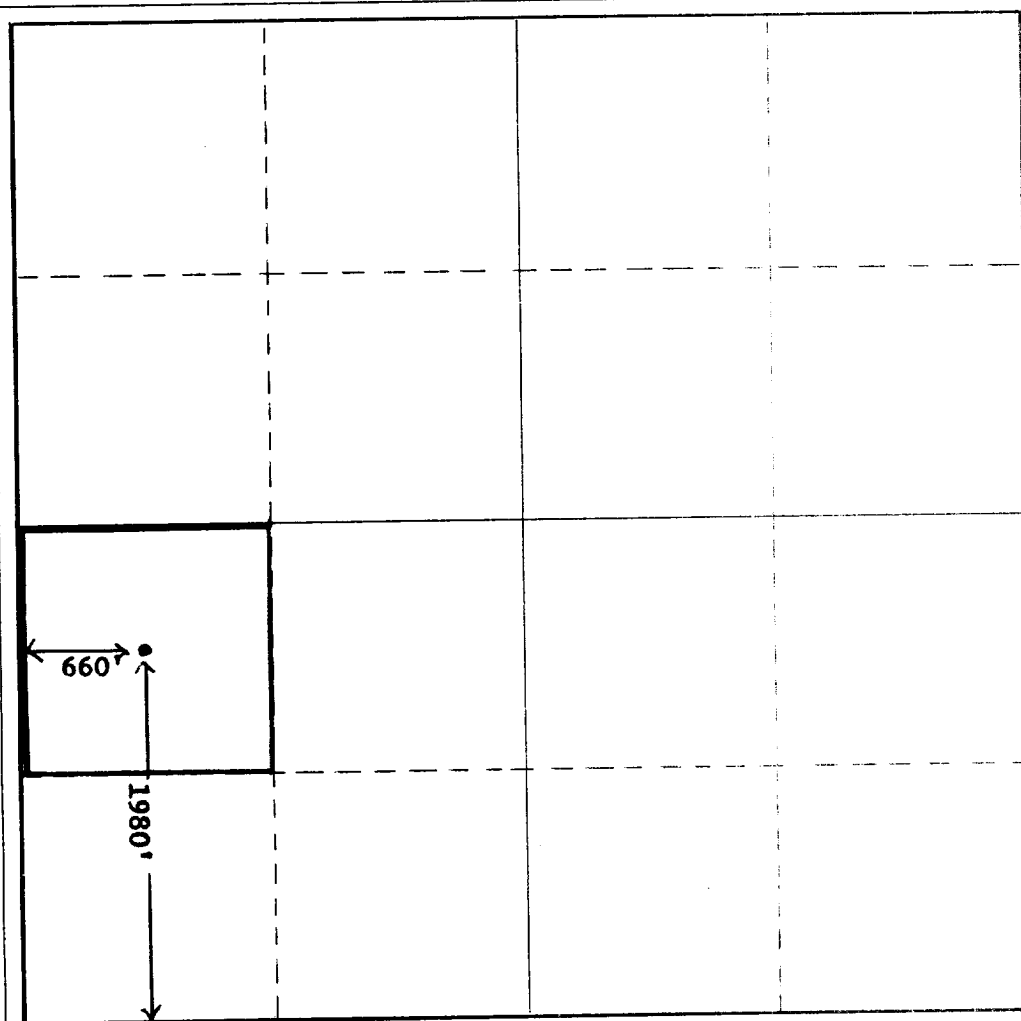

CERTIFICATION

I hereby certify that the information contained herein is true and complete to the best of my knowledge and belief.

(Signed) **D. R. Crow**
D. R. Crow

Position
Lead Clerk

Company
Skelly Oil Company

Date
January 5, 1976

I hereby certify that the well location shown on this plat was plotted from field notes of actual surveys made by me or under my supervision, and that the same is true and correct to the best of my knowledge and belief.

Date Surveyed

Registered Professional Engineer and/or Land Surveyor

Certificate No.