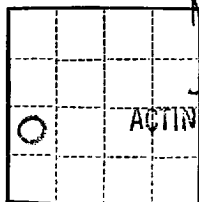

APPROVED

COPY TO O. C. C.

HOFBS

Budget Bureau No. 42-R358.4.  
Approval expires 12-31-60.

MAR 27 1963

(SUBMIT IN TRIPLICATE)

J. L. GORDON  
ACTING DISTRICT ENGINEERUNITED STATES  
DEPARTMENT OF THE INTERIOR  
GEOLOGICAL SURVEY

Land Office

Lease No. **LC-032874-a**

Unit

## SUNDRY NOTICES AND REPORTS ON WELLS

NOTICE OF INTENTION TO DRILL	<input checked="" type="checkbox"/>	SUBSEQUENT REPORT OF WATER SHUT-OFF	
NOTICE OF INTENTION TO CHANGE PLANS		SUBSEQUENT REPORT OF SHOOTING OR ACIDIZING	
NOTICE OF INTENTION TO TEST WATER SHUT-OFF		SUBSEQUENT REPORT OF ALTERING CASING	
NOTICE OF INTENTION TO RE-DRILL OR REPAIR WELL		SUBSEQUENT REPORT OF RE-DRILLING OR REPAIR	
NOTICE OF INTENTION TO SHOOT OR ACIDIZE		SUBSEQUENT REPORT OF ABANDONMENT	
NOTICE OF INTENTION TO PULL OR ALTER CASING		SUPPLEMENTARY WELL HISTORY	
NOTICE OF INTENTION TO ABANDON WELL			

(INDICATE ABOVE BY CHECK MARK NATURE OF REPORT, NOTICE, OR OTHER DATA)

Lease No. **41696**  
**O. L. Erwin (a)**

March 26, 1963

Well No. **4** is located **1980** ft. from **N** line and **990** ft. from **W** line of sec. **35**

**NW 1/4 SW 1/4 Sec. 35** **T-24-S** **R-37-E** **NMPM**  
(1/4 Sec. and Sec. No.) (Twp.) (Range) (Meridian)  
**Justis, N. (Blindery)** **Lee** **New Mexico**  
(Field) (County or Subdivision) (State or Territory)  
**Justis, N. (Tubb-Drinkard)**

The elevation of the derrick floor above sea level is \* ft. **\*Not yet available**

## DETAILS OF WORK

(State names of and expected depths to objective sands; show sizes, weights, and lengths of proposed casings; indicate mudding jobs, cementing points, and all other important proposed work)

SEE ATTACHED SHEET FOR FORMATIONS EXPECTED &amp; CASING PROGRAM

- \* Sufficient cement on the 2 7/8" strings to tie back into the 8 5/8" intermediate casing.

I understand that this plan of work must receive approval in writing by the Geological Survey before operations may be commenced.

Company **TEXACO INC.** **TEXACO INC.**Address **P.O. Box 3109****Midland, Texas**

By

  
**J. J. Volten**Title **Division Civil Engineer**

TEXACO INC. #4 G. L. Erwin (a), Lea County, New Mexico

# CASING PROGRAM

Size Hole	Size Casing	Wt. per Foot	New or 2nd Hand	Depth	Sacks Cement
19"	11 3/4"	23.72	New	250'	250
11"	8 5/8"	32 & 24	New	3545'	1800 *
7 7/8"	2 7/8"	6.4	New	6200' (Blind)	600 **
7 7/8"	2 7/8"	6.4	New	6200' (Drill)	

\* 1st stage 400 sks. Inner nest  
2nd stage 1300 sks. TLM + 100 sks. Inner nest.

\*\* 600 sks. Inner 4% gel containing friction reducing agent to attain turbulent flow.

# FORMATION TOPS EXPECTED

Top of Anhydrite	920'	Top of Glorieta	4800'
Top of Salt	1120'	Top of Blinberry	5185'
Top of Yates	2415'	Top of Tubb	5850'
Top of Queen	3155'	Top of Drinkard	6075'
Top of San Andres	3685'		

NEW TEXACO OIL CONSERVATION COMMISSION  
WELL LOCATION AND ACREAGE DEDICATION PLAT

FORM C-128  
Revised 5/1/57

SEE INSTRUCTIONS FOR COMPLETING THIS FORM ON THE REVERSE SIDE

SECTION A

Operator <b>TEXACO Inc.</b>			Lease <b>G. L. Erwin (a)</b>			Well No. <b>4</b>		
Unit Letter <b>L</b>	Section <b>35</b>	Township <b>24 South</b>	Range <b>37 East</b>	County <b>Lea</b>				
Actual Footage Location of Well: <b>1980</b> feet from the <b>South</b> line and <b>990</b> feet from the <b>West</b> line Sec. <b>35</b>								
Ground Level Elev. <b>Later</b>	Producing Formation <b>Blinberry &amp; Drinkard</b>			Pool <b>Justis, North (Blinberry) Justis, North (Tubb-Drinkard)</b>		Dedicated Acreage: <b>40</b> Acres		

1. Is the Operator the only owner in the dedicated acreage outlined on the plat below? YES ☒ NO \_\_\_\_ . ("Owner" means the person who has the right to drill into and to produce from any pool and to appropriate the production either for himself or for himself and another. (65-3-29 (e) NMSA 1935 Comp.)
2. If the answer to question one is "no," have the interests of all the owners been consolidated by communitization agreement or otherwise? YES \_\_\_\_ NO \_\_\_\_ . If answer is "yes," Type of Consolidation \_\_\_\_
3. If the answer to question two is "no," list all the owners and their respective interests below:

Owner	Land Description

SECTION B

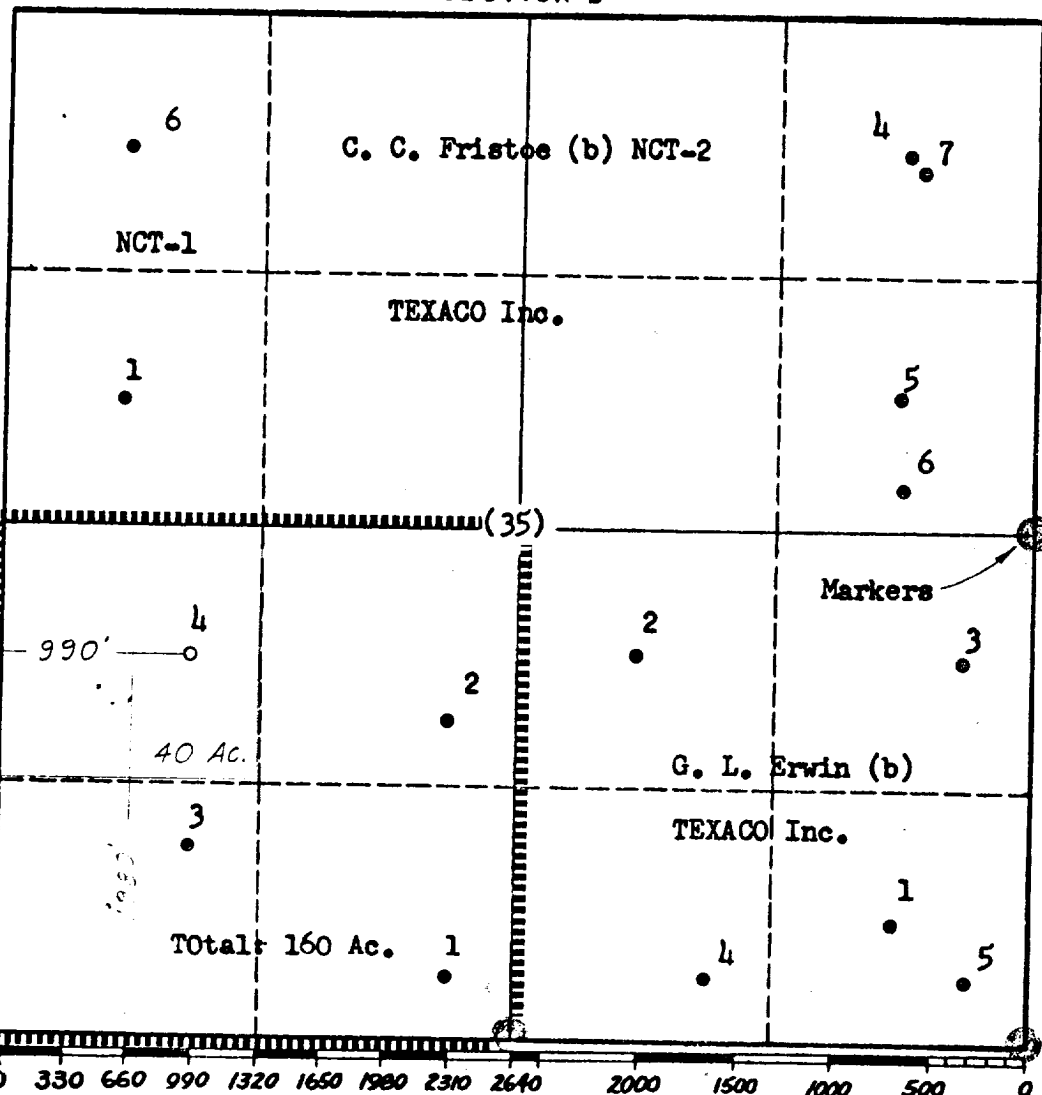

CERTIFICATION

I hereby certify that the information in SECTION A above is true and complete to the best of my knowledge and belief.

Name **J. J. Velten**  
Position **Division Civil Engineer**  
Company **TEXACO Inc.**  
Date **3-26-63**

I hereby certify that the well location shown on the plat in SECTION B was plotted from field notes of actual surveys made by me or under my supervision, and that the same is true and correct to the best of my knowledge and belief.

Date Surveyed **3-26-63**  
Registered Professional Engineer and/or Land Surveyor **J. J. Velten**  
Certificate No. **8174**