

APPROVED

Budget Bureau No. 42-R358.4.
Approval expires 12-31-60.

Form 9-331a
(Feb. 1961)

JAN 30 1963

(SUBMIT IN TRIPLICATE)

Land Office **New Mexico**

Lease No. **LC 067081**

E. W. STANDLEY
DISTRICT ENGINEER

UNITED STATES
DEPARTMENT OF THE INTERIOR
GEOLOGICAL SURVEY

Unit **D-55**

X			

SUNDRY NOTICES AND REPORTS ON WELLS

NOTICE OF INTENTION TO DRILL	X	SUBSEQUENT REPORT OF WATER SHUT-OFF	
NOTICE OF INTENTION TO CHANGE PLANS		SUBSEQUENT REPORT OF SHOOTING OR ACIDIZING	
NOTICE OF INTENTION TO TEST WATER SHUT-OFF		SUBSEQUENT REPORT OF ALTERING CASING	
NOTICE OF INTENTION TO RE-DRILL OR REPAIR WELL		SUBSEQUENT REPORT OF RE-DRILLING OR REPAIR	
NOTICE OF INTENTION TO SHOOT OR ACIDIZE		SUBSEQUENT REPORT OF ABANDONMENT	
NOTICE OF INTENTION TO PULL OR ALTER CASING		SUPPLEMENTARY WELL HISTORY	
NOTICE OF INTENTION TO ABANDON WELL			

(INDICATE ABOVE BY CHECK MARK NATURE OF REPORT, NOTICE, OR OTHER DATA)

Midland, Texas, January 29, 19**63**

Well No. **1** is located **660** ft. from **N** line and **1980** from **W** line of sec. **22**

SE/4SW/4 22 **25a** **25b** **25c** **25d**

Wildcat **Lee** **New Mexico**

The elevation of the derrick floor above sea level is _____ ft.

DETAILS OF WORK

(State names of and expected depths to objective sands; show sizes, weights, and lengths of proposed casings; indicate mudding jobs, cementing points, and all other important proposed work)

Lease designated **Elliott Federal, Well #1.**

This well is proposed to be drilled to a depth of 5300' approximately to test the Delaware Sand. Surface hole is to be drilled to a depth of 350' with cable tools drilling an 8" hole and setting 7" casing with 200 sack circulated. A 6-1/4" hole will be drilled with rotary tools to total depth and 4-1/2" oil string set at T.D. and cementing program to be worked out and approved by U.S.G.S. prior to running the oil string.

I understand that this plan of work must receive approval in writing by the Geological Survey before operations may be commenced.

Company **CACTUS DRILLING CORPORATION**

Address **P. O. Box 32**

Midland, Texas

By *Jim L. Map*

Title **Geologist**

NEW MEXICO OIL CONSERVATION COMMISSION
WELL LOCATION AND ACREAGE DEDICATION PLAT

FORM C-120
Revised 5/1/57

SEE INSTRUCTIONS FOR COMPLETING THIS FORM ON THE REVERSE SIDE

SECTION A

Operator CACTUS DRILLING CORPORATION		Lease ELLIOTT FEDERAL		FEB 5 AM	Well No. 7-56
Unit Letter N	Section 22	Township 25 SOUTH	Range 35 EAST	County LEA	
Actual Footage Location of Well: 660 feet from the SOUTH line and 1980 feet from the WEST line					
Ground Level Elev. 3205.4	Producing Formation		Pool	Dedicated Acreage: Acres	

1. Is the Operator the only owner in the dedicated acreage outlined on the plat below? YES _____ NO _____. ("Owner" means the person who has the right to drill into and to produce from any pool and to appropriate the production either for himself or for himself and another. (65-3-29 (e) NMSA 1935 Comp.)
2. If the answer to question one is "no," have the interests of all the owners been consolidated by communitization agreement or otherwise? YES _____ NO _____. If answer is "yes," Type of Consolidation _____
3. If the answer to question two is "no," list all the owners and their respective interests below:

Owner	Land Description

SECTION B

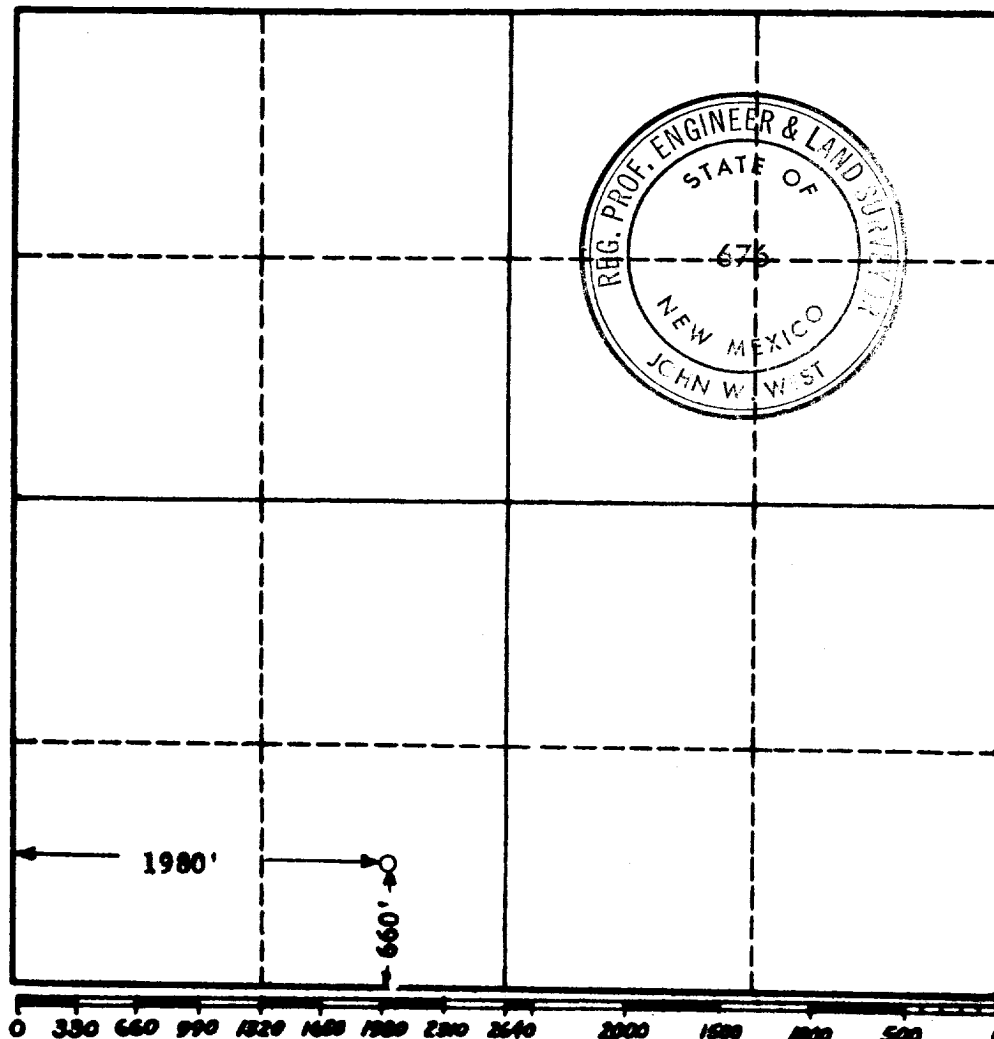

CERTIFICATION

I hereby certify that the information in SECTION A above is true and complete to the best of my knowledge and belief.

Name
Position
Company
Date

I hereby certify that the well location shown on the plat in SECTION B was plotted from field notes of actual surveys made by me or under my supervision, and that the same is true and correct to the best of my knowledge and belief.

Date Surveyed JAN 24, 1963
Registered Professional Engineer and/or Land Surveyor, JOHN W. WEST
<i>John W. West</i>
Certificate No. N.M. - P.E. & L.S. NO. 676