

NEW MEXICO OIL CONSERVATION COMMISSION

Santa Fe, New Mexico

RECEIVED DISTRICT O. C. C.

NOTICE OF INTENTION TO DRILL OR RECOMPLETE '63

Notice must be given to the District Office of the Oil Conservation Commission and approval obtained before drilling or recompletion begins. If changes in the proposed plan are considered advisable, a copy of this notice showing such changes will be returned to the sender. Submit this notice in QUINTUPPLICATE. One copy will be returned following approval. See additional instructions in Rules and Regulations of the Commission.

Midland, Texas

(Place)

December 20, 1963

(Date)

OIL CONSERVATION COMMISSION
SANTA FE, NEW MEXICO

Gentlemen:

You are hereby notified that it is our intention to commence the (Drilling) ~~Recompletion~~ of a well to be known as

Union Texas Petroleum Corporation

(Company or Operator)

Two States - Stuart

(Lease)

Well No. 1, in L

(Unit)

located 990' feet from the West line and 2310 feet from the

South line of Section 11, T. 25-S, R. 37-E, NMPM.

(GIVE LOCATION FROM SECTION LINE) North Justis Pool, Lea County

If State Land the Oil and Gas Lease is No.

If patented land the owner is F. J. Dangle

Address Lovington, New Mexico

We propose to drill well with drilling equipment as follows: To be drilled with rotary tools from surface to total depth

The status of plugging bond is

Drilling Contractor Camay - Phillips, Inc. 1108
Continental National Bank Bldg, Fort Worth, Texas

We intend to complete this well in the Blinbry & Tubb-Drinkard formation at an approximate depth of 6200 feet.

CASING PROGRAM

We propose to use the following strings of Casing and to cement them as indicated:

Size of Hole	Size of Casing	Weight per Foot	New or Second Hand	Depth	Sacks Cement
12-1/4"	9-5/8"	36#	New	1100'	345 sks.
8-3/4"	7"	20# & 23#	New	6200'	520 sks.

If changes in the above plans become advisable we will notify you immediately.

ADDITIONAL INFORMATION (If recompletion give full details of proposed plan of work.)

Approved, 19
Except as follows:

Sincerely yours,

Union Texas Petroleum Corporation

By

Position District Superintendent
Send Communications regarding well to

Name Union Texas Petroleum Corporation

Address Box 1859

Midland, Texas

OIL CONSERVATION COMMISSION

By

Title

NEW MEXICO OIL CONSERVATION COMMISSION
WELL LOCATION AND ACREAGE DEDICATION PLAT

FORM C-128
 Hobbs Office O.C.C.
 Revised 5/1/57

SEE INSTRUCTIONS FOR COMPLETING THIS FORM ON THE REVERSE SIDE

Dec 23 9 25 AM '63

SECTION A

Operator UNION TEXAS PETROLEUM CORP.		Lease TWO STATES-STUART		Well No. 1
Unit Letter L	Section 11	Township 25 SOUTH	Range 37 EAST	County LEA
Actual Footage Location of Well: 990 feet from the WEST line and 2310 feet from the SOUTH line				
Ground Level Elev. 3119'	Producing Formation Blinberry & Tubb Drinkard		Pool North Justis	Dedicated Acreage: 40 Acres

1. Is the Operator the only owner in the dedicated acreage outlined on the plat below? YES ☒ NO ____ . ("Owner" means the person who has the right to drill into and to produce from any pool and to appropriate the production either for himself or for himself and another. (65-3-29 (e) NMSA 1935 Comp.)
2. If the answer to question one is "no," have the interests of all the owners been consolidated by communitization agreement or otherwise? YES ____ NO ____ . If answer is "yes," Type of Consolidation _____
3. If the answer to question two is "no," list all the owners and their respective interests below:

Owner	Land Description

SECTION B

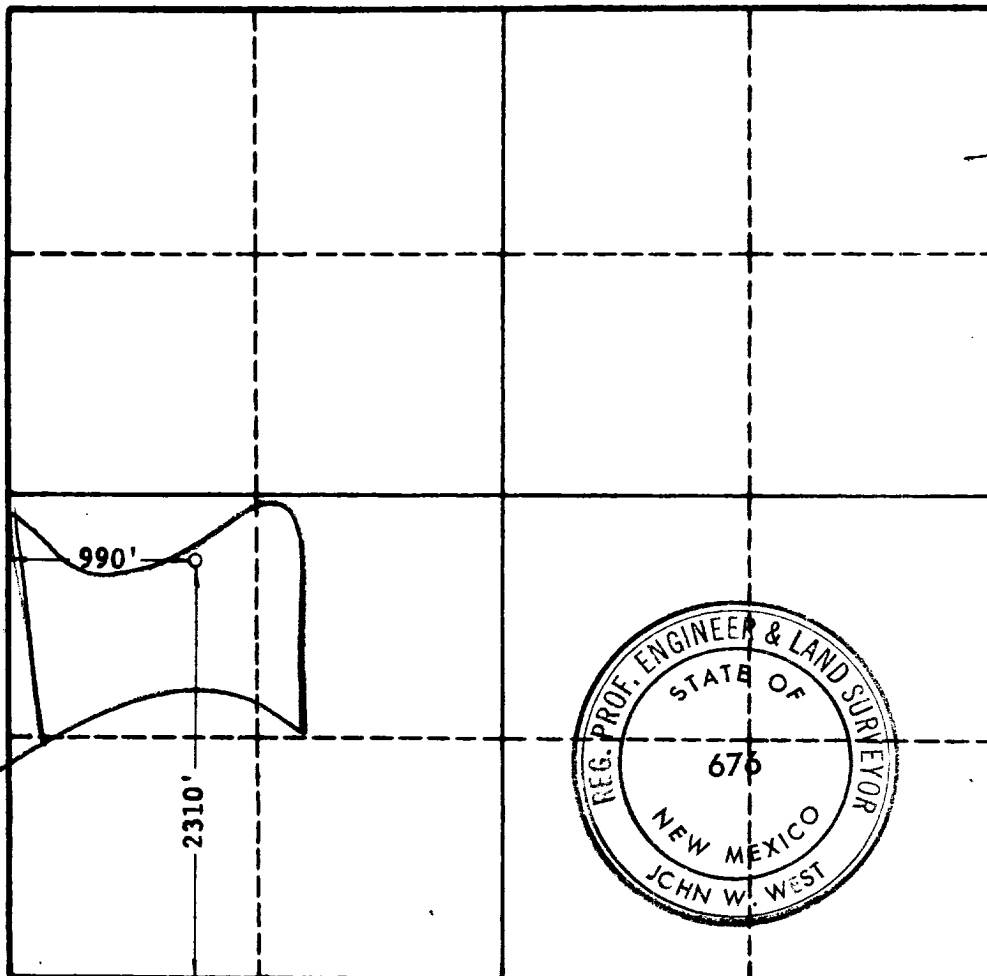

CERTIFICATION

I hereby certify that the information in SECTION A above is true and complete to the best of my knowledge and belief.

Name
L. H. Foster
 Position
District Superintendent
 Company
Union Texas Petroleum Corp.
 Date
December 20, 1963

I hereby certify that the well location shown on the plat in SECTION B was plotted from field notes of actual surveys made by me or under my supervision, and that the same is true and correct to the best of my knowledge and belief.

Date Surveyed
12-18-1963
 Registered Professional Engineer and/or Land Surveyor, **JOHN W. WEST**
 Certificate No.
N.M. - P.E. & L.S. NO. 676

0 330 660 990 1320 1650 1980 2310 2640 2000 1650 1300 950 600 250 0