

Form 9-331a  
(Feb. 1937)

(SUBMIT IN TRIPLICATE)

UNITED STATES  
DEPARTMENT OF THE INTERIOR  
GEOLOGICAL SURVEY

Register Bureau No. 42-R358.4.  
Form Approved,

Land Office Hobbs

Lease No. 44-0339287

Unit P

SUNDRY NOTICES AND REPORTS ON WELLS

NOTICE OF INTENTION TO DRILL		SUBSEQUENT REPORT OF WATER SHUT-OFF	
NOTICE OF INTENTION TO CHANGE PLANS		SUBSEQUENT REPORT OF SHOOTING OR ACIDIZING	
NOTICE OF INTENTION TO TEST WATER SHUT-OFF		SUBSEQUENT REPORT OF ALTERING CASING	
NOTICE OF INTENTION TO RE-DRILL OR REPAIR WELL		SUBSEQUENT REPORT OF RE-DRILLING OR REPAIR	
NOTICE OF INTENTION TO SHOOT OR ACIDIZE		SUBSEQUENT REPORT OF ABANDONMENT	
NOTICE OF INTENTION TO PULL OR ALTER CASING		SUPPLEMENTARY WELL HISTORY	
NOTICE OF INTENTION TO ABANDON WELL			

(INDICATE ABOVE BY CHECK MARK NATURE OF REPORT, NOTICE, OR OTHER DATA)

Continental-Federal 20 November 3, 1944

Well No. 1 is located 950 ft. from N line and 350 ft. from E line of sec. 29

SE/4 SE/4 Sec. 29 25-S 32-S N

(1/4 Sec. and Sec. No.) (Twp.) (Range) (Meridian)

Paducah 140 New Mexico

(Field) (County or Subdivision) (State or Territory)

The elevation of the derrick floor above sea level is 3353 ft.

DETAILS OF WORK

(State names of and expected depths to objective sands; show sizes, weights, and lengths of proposed casings; indicate mudding jobs, cementing points, and all other important proposed work)

Drill 8 3/4" hole to approximately 330'. Set 7" OD Casing.  
Drill 6 1/4" hole to approximately 4800'. Set 4 1/2" Casing if production is indicated.  
Circulate cement to surface on 7". Tie cement back to base of the salt on oil string.

I understand that this plan of work must receive approval in writing by the Geological Survey before operations may be commenced.

Company I. W. Lovelady  
Address P. O. Box 3448  
Odessa, Texas 79760

By R. L. Hamph  
Title Production Superintendent

**NEW MEXICO OIL CONSERVATION COMMISSION**  
**WELL LOCATION AND ACREAGE DEDICATION PLAT**

FORM C-128  
 Revised 5/1/57

**SEE INSTRUCTIONS FOR COMPLETING THIS FORM ON THE REVERSE SIDE**

Operator <b>I. W. LOVELADY</b>				Lease <b>CONTINENTAL FED. 29</b>		Vell No. <b>1</b>
Unit Letter <b>O</b>	Section <b>29</b>	Township <b>25 SOUTH</b>	Range <b>32 EAST</b>	County <b>LEA</b>		
Actual Footage Location of Well: <b>990</b> feet from the <b>SOUTH</b> line and <b>330</b> feet from the <b>EAST</b> line						
Ground Level Elev. <b>3354.6</b>	Producing Formation <b>Delaware</b>		Pool <b>Paducah</b>	Dedicated Acreage: <b>40</b> Acres		

1. Is the Operator the only owner in the dedicated acreage outlined on the plat below? YES ☒ NO ☐ ("Owner" means the person who has the right to drill into and to produce from any pool and to appropriate the production either for himself or for himself and another. (65-3-29 (e) NMSA 1955 Comp.)
2. If the answer to question one is "no," have the interests of all the owners been consolidated by communication agreement or otherwise? YES ☐ NO ☐ . If answer is "yes," Type of Consolidation \_\_\_\_\_
3. If the answer to question two is "no," list all the owners and their respective interests below:

Owner	Land Description

**SECTION B**

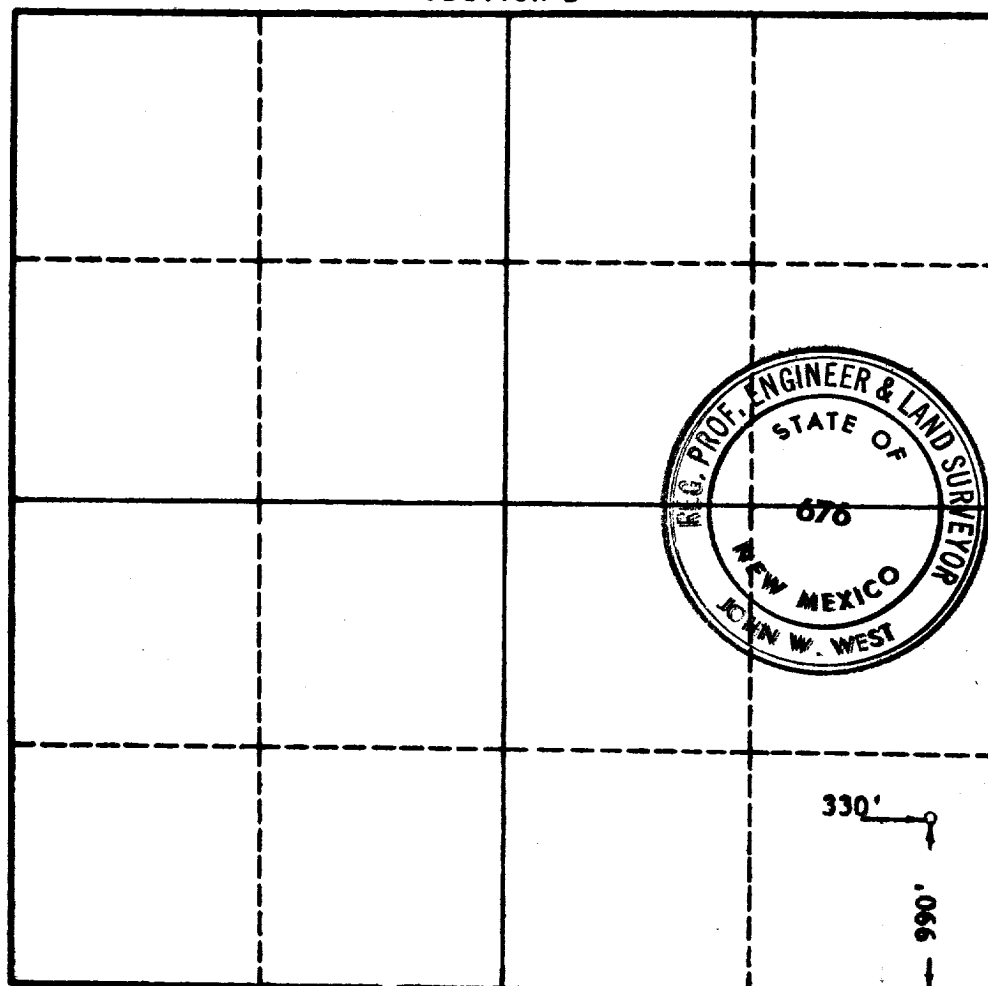

**CERTIFICATION**

I hereby certify that the information in SECTION A above is true and complete to the best of my knowledge and belief.

**I. W. LOVELADY**  
 Name \_\_\_\_\_  
 Position \_\_\_\_\_  
 Company **Production Dept.**  
 Date **I. W. LOVELADY**  
**November 1, 1964**

I hereby certify that the well location shown on the plat in SECTION B was plotted from field notes of actual surveys made by me or under my supervision, and that the same is true and correct to the best of my knowledge and belief.

Date Surveyed  
**10-29-1964**  
 Registered Professional Engineer  
 and/or Land Surveyor, **JOHN W. WEST**  
  
 Certificate No. \_\_\_\_\_  
**N. M. - P. E. & L. S. NO. 676**

**0 330 660 990 1320 1650 1980 2310 2640 2970 3300 3630 3960 4290 4620 4950 5280 5610 5940 6270 6600 6930 7260 7590 7920 8250 8580 8910 9240 9570 9900**