

NUMBER OF COPIES RECEIVED	
DISTRIBUTION	
SANTA FE	
FILE	
U.S.G.S	
LAND OFFICE	
TRANSPORTER	OIL GAS
PRODUCTION OFFICE	
OPERATOR	

NEW MICO OIL CONSERVATION COMMISSION
Santa Fe, New Mexico

Form C-101
Revised (12/1/55)

NOTICE OF INTENTION TO DRILL

Notice must be given to the District Office of the Oil Conservation Commission ^{1963 JUL 17 PM 3 32} approval obtained before drilling or recompletion begins. If changes in the proposed plan are considered advisable, a copy of this notice showing such changes will be returned to the sender. Submit this notice in QUINTUPPLICATE. One copy will be returned following approval. See additional instructions in Rules and Regulations of the Commission. If State Land submit 6 Copies Attach Form C-128 in triplicate to first 3 copies of form C-101

Reswell, New Mexico
(Place)

July 17, 1963
(Date)

OIL CONSERVATION COMMISSION
SANTA FE, NEW MEXICO

Gentlemen:

You are hereby notified that it is our intention to commence the Drilling of a well to be known as

JOHN H. TRIGG COMPANY

(Company, or Operator)

WEST JAL

(Lease)

Well No. 1-18

J

(Unit)

located 1650 feet from the SOUTH line and 1650 feet from the

EAST

line of Section 18

T 25 SOUTH

R 36 EAST

NMPM.

(GIVE LOCATION FROM SECTION LINE)

WILDCAT

Pool,

LEA

County

If State Land the Oil and Gas Lease is No.

If patented land the owner is Estate of C. H. E. Kammerer

Address Jal, New Mexico

We propose to drill well with drilling equipment as follows: Rotary Equipment

The status of plugging bond is Blanket bond on file with Commission.

Drilling Contractor Parker Drilling Company, probably.

We intend to complete this well in the Strawn Section of Pennsylvanian.

formation at an approximate depth of 12,600 feet.

CASING PROGRAM

We propose to use the following strings of Casing and to cement them as indicated:

Size of Hole	Size of Casing	Weight per Foot	New or Second Hand	Depth	Sacks Cement
	<u>13 3/8"</u>	<u>48#</u>	<u>New</u>	<u>350'</u>	<u>400</u>
	<u>9 5/8"</u>	<u>36# to 40#</u>	<u>New</u>	<u>5,200'</u>	<u>2,000</u>
	<u>7"</u>	<u>23# to 29#</u>	<u>New</u>	<u>11,300'</u>	<u>400</u>
	<u>5"</u>	<u>20#</u>	<u>New</u>	<u>11,100 to TD</u>	<u>100*</u>

If changes in the above plans become advisable we will notify you immediately.

ADDITIONAL INFORMATION (If recompletion give full details of proposed plan of work.)

SEE ATTACHED SHEET FOR ADDITIONAL INFORMATION.

Approved....., 19.....
Except as follows:

* Circulate liner

OIL CONSERVATION COMMISSION

By Joe R. Ramey

Sincerely yours,

JOHN H. TRIGG COMPANY

(Company or Operator)

By John H. Trigg

Position OPERATOR

Send Communications regarding well to

Name.....

Address.....

ADDITIONAL INFORMATION

We propose to drill a 12,600 foot well to test the Strawn Section of the Pennsylvanian. This test will be drilled with rotary tools.

This test is to be drilled under Communitization Agreement covering the entire Section 18, Township 25 South, Range 36 East, N.M.P.M., Lea County, New Mexico. Authority for this Communitization Agreement is found in New Mexico Oil Conservation Commission Order Number R-2439 of February 28, 1963 and concerning the West Jal Strawn.

Surface casing, 13 3/8", will be run to an approximate depth of 350 feet and cemented with 400 sacks.

An intermediate string, 9 5/8", will be run to about 5,200 feet and cemented with 2,000 sacks.

At an approximate depth of 11,300 feet, or within 200 feet above the top of the Strawn, a string of 7" casing will be run and cemented with 400 sacks.

If the gas distillate pay found in the Skelly well in Section 20 is productive, a 5" liner will be run to total depth -- the top of the liner will come back into the 7" casing at approximately 11,100 feet. The 5" liner will be cemented with 100 sacks.

All casing run and cemented will be under methods prescribed by the New Mexico Oil Conservation Commission.

THEORY OF THE EARTH

The theory of the earth is a branch of geology which deals with the origin and development of the earth and its various parts.

The theory of the earth is a branch of geology which deals with the origin and development of the earth and its various parts. It is a branch of geology which deals with the origin and development of the earth and its various parts.

The theory of the earth is a branch of geology which deals with the origin and development of the earth and its various parts. It is a branch of geology which deals with the origin and development of the earth and its various parts.

The theory of the earth is a branch of geology which deals with the origin and development of the earth and its various parts. It is a branch of geology which deals with the origin and development of the earth and its various parts.

The theory of the earth is a branch of geology which deals with the origin and development of the earth and its various parts. It is a branch of geology which deals with the origin and development of the earth and its various parts.

The theory of the earth is a branch of geology which deals with the origin and development of the earth and its various parts. It is a branch of geology which deals with the origin and development of the earth and its various parts.

The theory of the earth is a branch of geology which deals with the origin and development of the earth and its various parts. It is a branch of geology which deals with the origin and development of the earth and its various parts.

NEW MEXICO OIL CONSERVATION COMMISSION
WELL LOCATION AND ACREAGE DEDICATION PLAT

FORM C-128
Revised 5/1/57

SEE INSTRUCTIONS FOR COMPLETING THIS FORM ON THE REVERSE SIDE

SECTION A

Operator John H. Trigg		Lease West Jal		Well No. 1-18
Unit Letter I	Section 18	Township 25 South	Range 36 East	County Lea
Actual Footage Location of Well: 1650 feet from the South line and 1650 feet from the East line				
Ground Level Elev. 3139.50'	Producing Formation Wildcat		Dedicated Acreage: 639.44 Acres	

1. Is the Operator the only owner in the dedicated acreage outlined on the plat below? YES _____ NO X . ("Owner" means the person who has the right to drill into and to produce from any pool and to appropriate the production either for himself or for himself and another. (65-3-29 (a) NMSA 1935 Comp.)
2. If the answer to question one is "no," have the interests of all the owners been consolidated by communitization agreement or otherwise? YES X NO ____ . If answer is "yes," Type of Consolidation Communitization
3. If the answer to question two is "no," list all the owners and their respective interests below:

Owner	Land Description

SECTION B

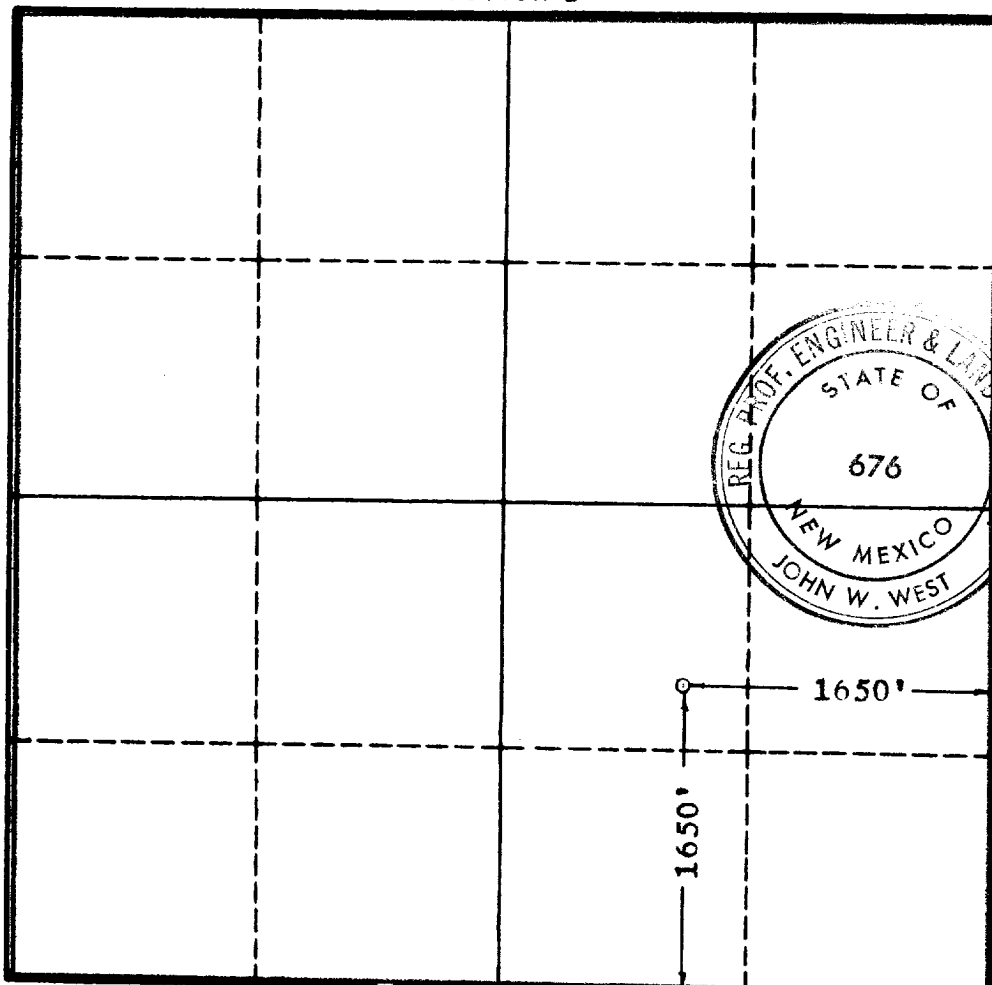

CERTIFICATION

I hereby certify that the information in SECTION A above is true and complete to the best of my knowledge and belief.

Name <u>John H. Trigg</u>
Position <u>Operator</u>
Company <u>John H. Trigg</u>
Date <u>July 17, 1963</u>

I hereby certify that the well location shown on the plat in SECTION B was plotted from field notes of actual surveys made by me or under my supervision, and that the same is true and correct to the best of my knowledge and belief.

Date Surveyed <u>July 7, 1963</u>
Registered Professional Engineer and/or Land Surveyor, <u>JOHN W. WEST</u>
Certificate No. <u>N.M. - P.E. & L.S. NO. 676</u>

0 350 650 950 1250 1550 1850 2150 2450 2000 1500 1000 500 0