

STATE OF NEW MEXICO
ENERGY AND MINERALS DEPARTMENT

OIL CONSERVATION DIVISION
P. O. BOX 2088
SANTA FE, NEW MEXICO 87501

Form C-101
Revised 10-1-78

NO. OF COPIES RECEIVED	
DISTRIBUTION	
SANTA FE	
FILE	
U.S.G.S.	
LAND OFFICE	
OPERATOR	

5A. Indicate Type of Lease
STATE ☒ FEE ☐

5. State Oil & Gas Lease No.
B-2657

APPLICATION FOR PERMIT TO DRILL, DEEPEN, OR PLUG BACK

1a. Type of Work DRILL <input type="checkbox"/> DEEPEN <input type="checkbox"/> PLUG BACK <input checked="" type="checkbox"/>		7. Unit Agreement Name
b. Type of Well OIL WELL <input type="checkbox"/> GAS WELL <input checked="" type="checkbox"/> OTHER <input type="checkbox"/> SINGLE ZONE <input checked="" type="checkbox"/> MULTIPLE ZONE <input type="checkbox"/>		8. Farm or Lease Name <u>State A</u>
2. Name of Operator <u>CONOCO INC.</u>		9. Well No. <u>2</u>
3. Address of Operator <u>P. O. Box 460, Hobbs, N.M. 88240</u>		10. Field and Pool, or Wildcat <u>Stateline Ellenburger</u>
4. Location of Well UNIT LETTER <u>C</u> LOCATED <u>752</u> FEET FROM THE <u>North</u> LINE AND <u>2092</u> FEET FROM THE <u>West</u> LINE OF SEC. <u>5</u> TWP. <u>24S</u> RGE. <u>38E</u> NMPN		11. County <u>Lea</u>
19. Proposed Depth		19A. Formation
20. Policy or C.T.		
21. Elevations (show whether DT, KT, etc.)	21A. Kind & Status Plug. Bond	21B. Drilling Contractor
22. Approx. Date Work will start		

23. PROPOSED CASING AND CEMENT PROGRAM

SIZE OF HOLE	SIZE OF CASING	WEIGHT PER FOOT	SETTING DEPTH	SACKS OF CEMENT	EST. TOP
	<u>No Change</u>				

MIRU. CD to 12,000'. Set CIBP at 11,900'. Spot 35' Class H cmt on top. Pressure test csq. Set RBP at 5,700'. Perforate at 5528', 32', 42', 51', 56', 62', 71', 87' w/ 2 JSPF. Set pkr. at 5430'. Acidize w/ 2500 gals 15% NE-FE-HCL. Flush w/ 45 bbls. 2% KCL TFW. Swab. Run production equipment if oil appears. If not, set RBP at 5520'. Perforate at 5478', 86', 94', 5501', 11' w/ 2 JSPF. Set pkr at 5380'. Acidize w/ 2300 gals. 15% NE-FE-HCL. Flush w/ 44 bbls. 2% KCL TFW. Swab. Run production equipment if oil appears. If not, set RBP at 5475'. Perforate at 5428', 33', 37', 40', 45', 48', 53', 59' w/ 2 JSPF. Set pkr at 5330'. Acidize w/ 2500 gals 15% NE-FE-HCL. Flush w/ 44 bbls 2% KCL TFW. Swab. Run production equipment. Test.

IN ABOVE SPACE DESCRIBE PROPOSED PROGRAM; IF PROPOSAL IS TO DEEPEN OR PLUG BACK, GIVE DATA ON PRESENT PRODUCTIVE ZONE AND PROPOSED NEW PRODUCTIVE ZONE. GIVE BLOWOUT PREVENTER PROGRAM, IF ANY.

I hereby certify that the information above is true and complete to the best of my knowledge and belief.

Signed David J. Smythe for Administrative Supervisor Date September 22, 1983

(This space for State Use)

APPROVED BY ORIGINAL SIGNED BY JERRY SEXTON
DISTRICT 1 SUPERVISOR

TITLE

DATE

SEP 26 1983

CONDITIONS OF APPROVAL, IF ANY:

RECEIVED
SEP 23 1983
S. D.
HUBBS OFFICE

**NEW MEXICO OIL CONSERVATION COMMISSION
WELL LOCATION AND ACREAGE DEDICATION PLAT**

Form C-102
Supersedes C-128
Effective 1-1-65

All distances must be from the outer boundaries of the Section.

Operator Conoco Inc.			Lease State A		Well No. 2
Unit Letter C	Section 5	Township 24 South	Range 38 East	County Lea	
Actual Footage Location of Well: 752 feet from the North line and 2092 feet from the West line					
Ground Level Elev.	Producing Formation San Andres		Pool Wildcat	Dedicated Acreage: 40 Acres	

1. Outline the acreage dedicated to the subject well by colored pencil or hatchure marks on the plat below.
2. If more than one lease is dedicated to the well, outline each and identify the ownership thereof (both as to working interest and royalty).
3. If more than one lease of different ownership is dedicated to the well, have the interests of all owners been consolidated by communitization, unitization, force-pooling, etc?

☐ Yes ☐ No If answer is "yes," type of consolidation _____

If answer is "no," list the owners and tract descriptions which have actually been consolidated. (Use reverse side of this form if necessary.) _____

No allowable will be assigned to the well until all interests have been consolidated (by communitization, unitization, forced-pooling, or otherwise) or until a non-standard unit, eliminating such interests, has been approved by the Commission.

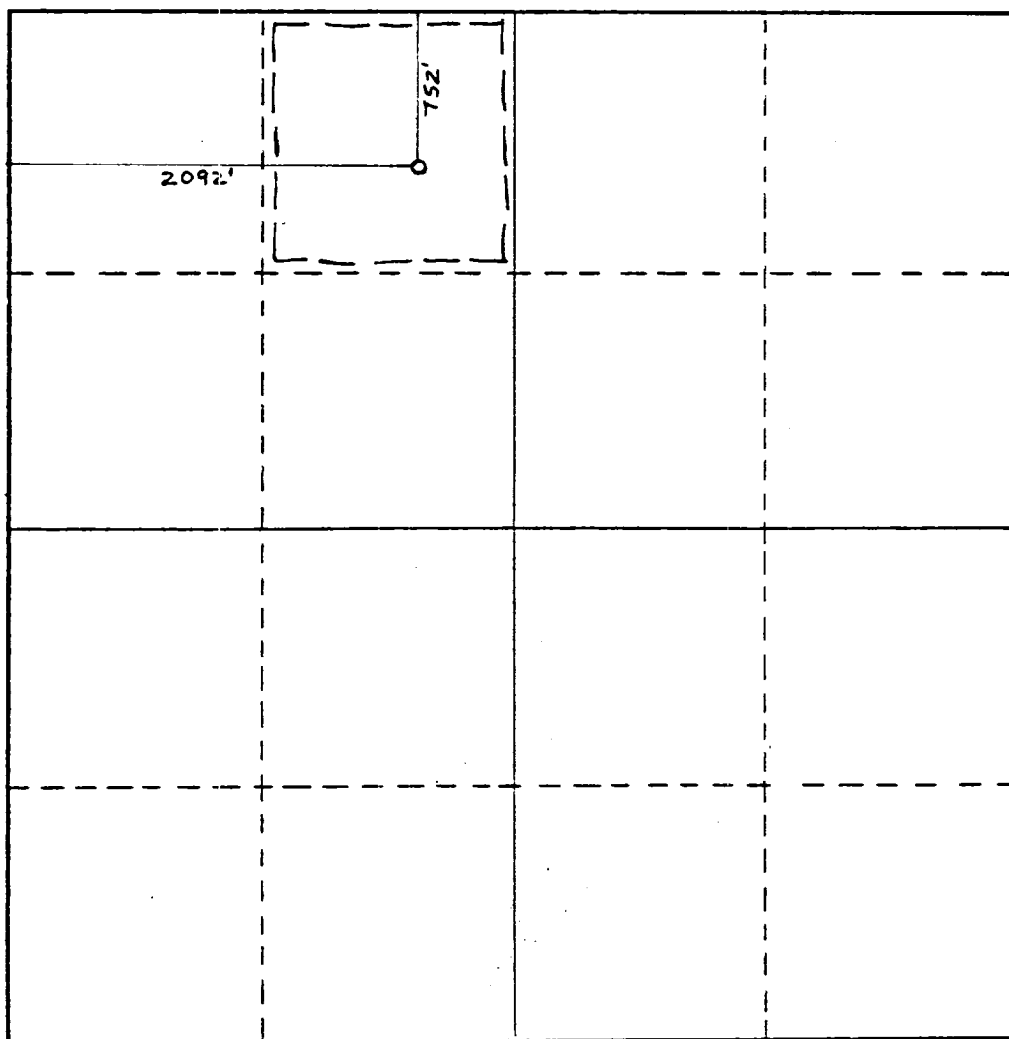

CERTIFICATION

I hereby certify that the information contained herein is true and complete to the best of my knowledge and belief.

Name **David A. Smyler**
 Position **Administrative Supervisor**
 Company **Conoco Inc.**

Date **September 22, 1983**

I hereby certify that the well location shown on this plat was plotted from field notes of actual surveys made by me or under my supervision, and that the same is true and correct to the best of my knowledge and belief.

Date Surveyed _____

Registered Professional Engineer
and/or Land Surveyor

Certificate No. _____

RECEIVED
SEP 23 1983
S-L-D
HUBBS OFFICE