

UNITED STATES
DEPARTMENT OF THE INTERIOR
GEOLOGICAL SURVEY

APPLICATION FOR PERMIT TO DRILL, DEEPEN, OR PLUG BACK

1a. TYPE OF WORK DRILL <input checked="" type="checkbox"/> DEEPEN <input type="checkbox"/> PLUG BACK <input type="checkbox"/>			5. LEASE DESIGNATION AND SERIAL NO. LC 032450 (a)
b. TYPE OF WELL OIL WELL <input checked="" type="checkbox"/> GAS WELL <input type="checkbox"/> OTHER <input type="checkbox"/> SINGLE ZONE <input type="checkbox"/> MULTIPLE ZONE <input type="checkbox"/>			6. IF INDIAN, ALLOTTEE OR TRIBE NAME
2. NAME OF OPERATOR Pan American Petroleum Corporation			7. UNIT AGREEMENT NAME South Mattix Unit
3. ADDRESS OF OPERATOR Box 68, Hobbs, New Mexico 88240			8. FARM OR LEASE NAME
4. LOCATION OF WELL (Report location clearly and in accordance with any State requirements.)* At surface 1980' FNL X 1830' FEL, Sec. 22 (Unit G, SW/4 NE/4) At proposed prod. zone			9. WELL NO. 18
14. DISTANCE IN MILES AND DIRECTION FROM NEAREST TOWN OR POST OFFICE*			10. FIELD AND POOL, OR WILDCAT Fowler Blinbry
15. DISTANCE FROM PROPOSED* LOCATION TO NEAREST PROPERTY OF LEASE LINE, FT. (Also to nearest drig. line, if any)			11. SEC., T., R., M., OR BLK. AND SURVEY OR AREA 22-24-37 NMPM
16. NO. OF ACRES IN LEASE 960			12. COUNTY OR PARISH Lea
17. NO. OF ACRES ASSIGNED TO THIS WELL 80			13. STATE New Mexico
18. DISTANCE FROM PROPOSED LOCATION* TO NEAREST WELL, DRILLING, COMPLETED, OR APPLIED FOR, ON THIS LEASE, FT.			20. ROTARY OR CABLE TOOLS Rotary
19. PROPOSED DEPTH 5750'			22. APPROX. DATE WORK WILL START* 5-20-65
21. ELEVATIONS (Show whether DF, RT, GR, etc.)			
23. PROPOSED CASING AND CEMENTING PROGRAM			

SIZE OF HOLE	SIZE OF CASING	WEIGHT PER FOOT	SETTING DEPTH	QUANTITY OF CEMENT
12 1/4"	9 5/8"	32.3#	1000'	Circulate
8 3/4"	7"	32#	5750'	Sufficient to bring T/cmt to base of salt.

It is proposed to drill a 5750' Fowler Blinbry development well.

After drilling well, logs will be run and evaluations made, perforating and stimulating as necessary to attempt commercial production.

IN ABOVE SPACE DESCRIBE PROPOSED PROGRAM: If proposal is to deepen or plug back, give data on present productive zone and proposed new productive zone. If proposal is to drill or deepen directionally, give pertinent data on subsurface locations and measured and true vertical depths. Give blowout preventer program, if any.

24. ORIGINAL SIGNED BY
SIGNED V. E. STALEY TITLE Area Superintendent DATE 5-19-65
(This space for Federal or State office use)

PERMIT NO. _____ APPROVAL DATE _____

APPROVED BY _____ TITLE _____ DATE _____
CONDITIONS OF APPROVAL, IF ANY:

*See Instructions On Reverse Side

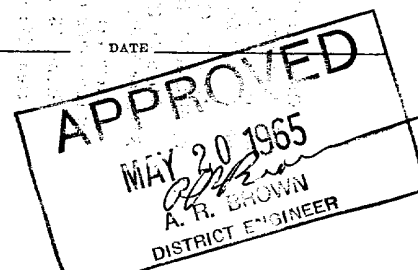

NEW MEXICO OIL CONSERVATION COMMISSION
WELL LOCATION AND ACREAGE DEDICATION PLAT

FORM C-128
Revised 5/1/57

SEE INSTRUCTIONS FOR COMPLETING THIS FORM ON THE REVERSE SIDE

SECTION A

Operator PAN AMERICAN PETROLEUM CORP.		Lease SOUTH MATTIX UNIT		Well No. 18
Unit Letter G	Section 22	Township 24 SOUTH	Range 37 EAST	County LEA
Actual Postage Location of Well: 1980 feet from the NORTH line and 1830 feet from the EAST line				
Ground Level Elev.	Producing Formation Elinebry	Pool Fowler Elinebry	Dedicated Acreage: 80 Acres	

1. Is the Operator the only owner in the dedicated acreage outlined on the plat below? YES ☒ NO ____ . ("Owner" means the person who has the right to drill into and to produce from any pool and to appropriate the production either for himself or for himself and another. (65-3-29 (e) NMSA 1935 Comp.)
2. If the answer to question one is "no," have the interests of all the owners been consolidated by communitization agreement or otherwise? YES ____ NO ____ . If answer is "yes," Type of Consolidation ____
3. If the answer to question two is "no," list all the owners and their respective interests below:

Owner	Land Description

SECTION B

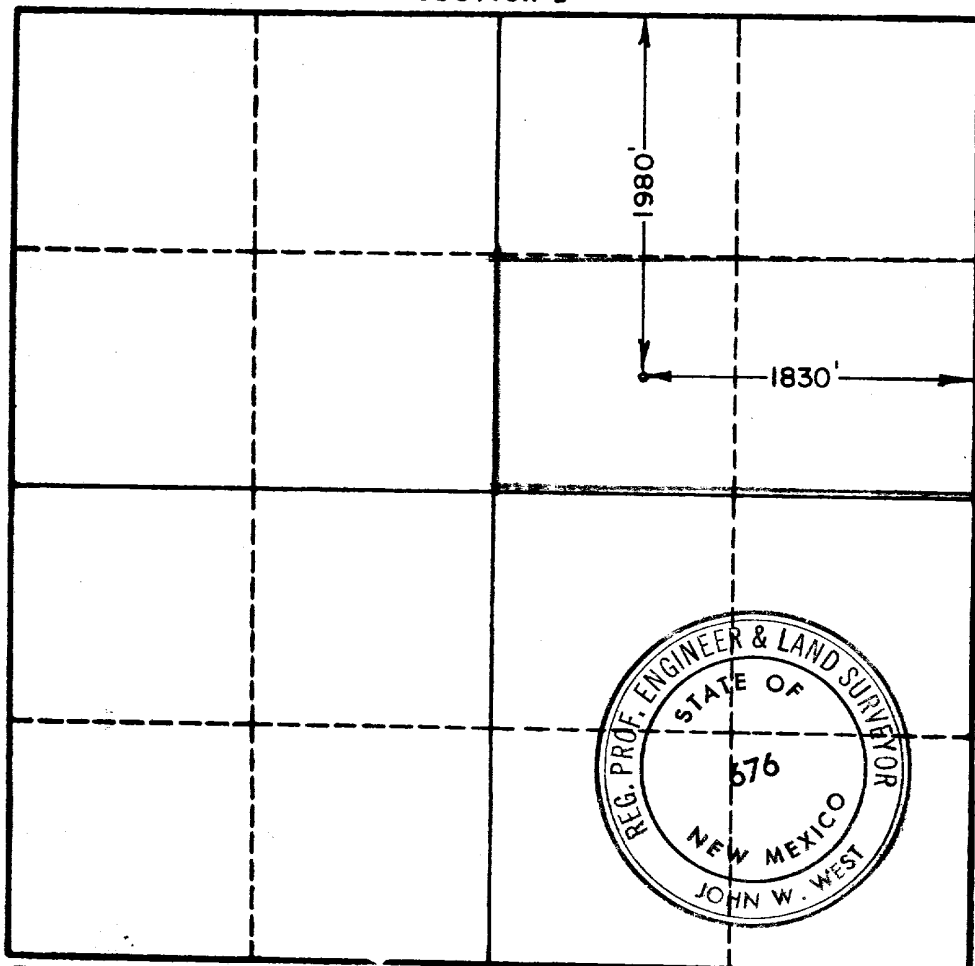

CERTIFICATION

I hereby certify that the information in SECTION A above is true and complete to the best of my knowledge and belief.

Name EDWARD SIGNED BY V. E. STALEY
Position Area Superintendent
Company Pan American Petrol. Corp.
Date 5-19-65

I hereby certify that the well location shown on the plat in SECTION B was plotted from field notes of actual surveys made by me or under my supervision, and that the same is true and correct to the best of my knowledge and belief.

Date Surveyed 3-11-65
Registered Professional Engineer and/or Land Surveyor, JOHN W. WEST
Certificate No. N. M. - P. E. & L. S. NO. 676