

District I
PO Box 1980, Hobbs, NM 88241-1980
District II
811 S. 1st Street, Artesia, NM 88210-2834
District III
1000 Rio Brazos Rd., Aztec, NM 87410
District IV
2040 South Pacheco, Santa Fe, NM 87505

State of New Mexico
Energy, Minerals & Natural Resources Department

OIL CONSERVATION DIVISION
2040 South Pacheco
Santa Fe, NM 87505

Form C-102
Revised October 18, 1994
Instructions on back
Submit to Appropriate District Office
State Lease - 4 Copies
Fee Lease - 3 Copies

COPY

☐ AMENDED REPORT

WELL LOCATION AND ACREAGE DEDICATION PLAT

¹ API Number 30-025-21308		² Pool Code 37240		³ Pool Name Langlie Mattix; 7 Rivers-Queen-Grayburg	
⁴ Property Code 25418		⁵ Property Name Cortland Myers 'C'			⁶ Well Number 2
⁷ OGRID No. 157984		⁸ Operator Name Altura Energy LTD			⁹ Elevation 3277' RDB

¹⁰ Surface Location									
UL or lot no. C	Section 22	Township 24-S	Range 37-E	Lot. Idn	Feet from the 660	North/South Line North	Feet from the 1980	East/West line West	County Lea

¹¹ Bottom Hole Location If Different From Surface									
UL or lot no.	Section	Township	Range	Lot. Idn	Feet from the	North/South Line	Feet from the	East/West line	County
¹² Dedicated Acres 40		¹³ Joint or Infill		¹⁴ Consolidation Code		¹⁵ Order No.			

NO ALLOWABLE WILL BE ASSIGNED TO THIS COMPLETION UNTIL ALL INTERESTS HAVE BEEN CONSOLIDATED
OR A NON--STANDARD UNIT HAS BEEN APPROVED BY THE DIVISION

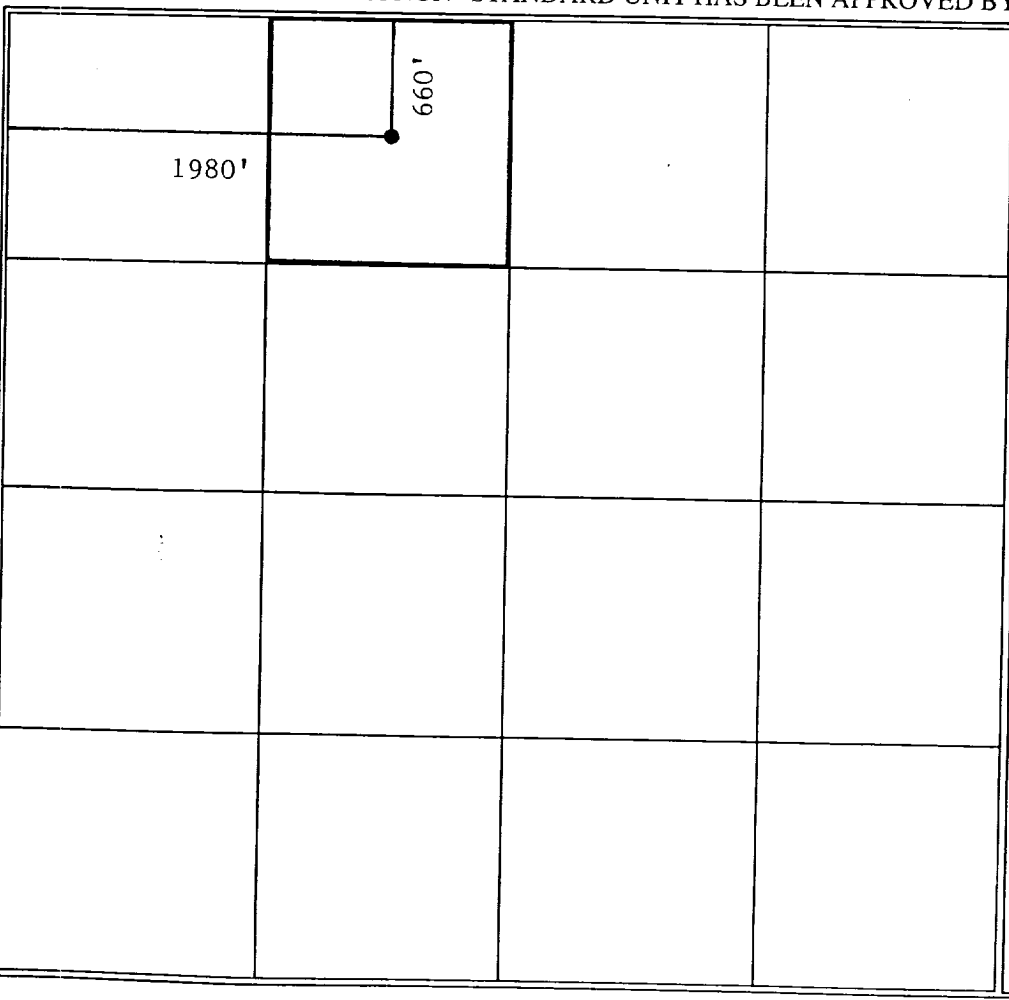
				¹⁷ OPERATOR CERTIFICATION I hereby certify that the information contained herein is true and complete to the best of my knowledge and belief. <u>Mark Stephens</u> Signature Mark Stephens Printed Name Business Analyst (SG) Title 02/21/2000 Date	
				¹⁸ SURVEYOR CERTIFICATION I hereby certify that the well location shown on this plat was plotted from field notes of actual surveys made by me or under my supervision, and that the same is true and correct to the best of my belief. Date of Survey Signature and Seal of Professional Surveyer:	
				Certificate Number	



NEW MEXICO OIL CONSERVATION COMMISSION
WELL LOCATION AND ACREAGE DEDICATION PLAT

Form C-102
Supersedes C-128
Effective 1-1-65

All distances must be from the outer boundaries of the Section.

Operator Amoco Production Co.			Lease SOUTH MATTIX UNIT		Well No. 19
Unit Letter C	Section 22	Township 24-S	Range 37-E	County LEA	
Actual Footage Location of Well: 660 feet from the NORTH line and 1980 feet from the WEST line					
Ground Level Elev. 3277 RDB	Producing Formation UPPER YESO		Pool FOWLER UPPER YESO		Dedicated Acreage: 80 Acres

1. Outline the acreage dedicated to the subject well by colored pencil or hachure marks on the plat below.
2. If more than one lease is dedicated to the well, outline each and identify the ownership thereof (both as to working interest and royalty).
3. If more than one lease of different ownership is dedicated to the well, have the interests of all owners been consolidated by communitization, unitization, force-pooling, etc?

☒ Yes ☐ No If answer is "yes," type of consolidation **UNITIZATION**

If answer is "no," list the owners and tract descriptions which have actually been consolidated. (Use reverse side of this form if necessary.)

No allowable will be assigned to the well until all interests have been consolidated (by communitization, unitization, forced-pooling, or otherwise) or until a non-standard unit, eliminating such interests, has been approved by the Commission.

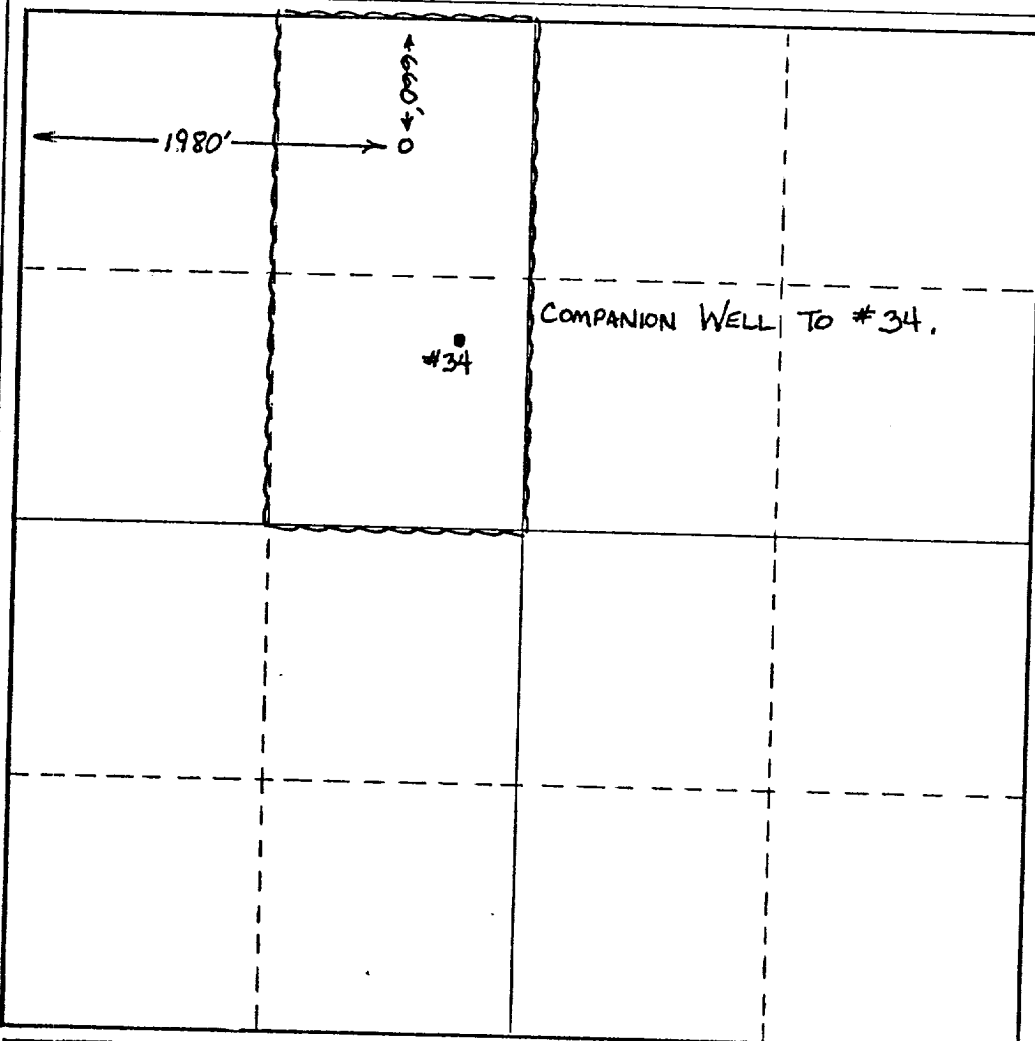

CERTIFICATION

I hereby certify that the information contained herein is true and complete to the best of my knowledge and belief.

Name
Randy Atkins
Position
ADMINISTRATIVE ANALYST
Company
AMOCO PRODUCTION Co.
Date
APRIL 3, 1979

I hereby certify that the well location shown on this plat was plotted from field notes of actual surveys made by me or under my supervision, and that the same is true and correct to the best of my knowledge and belief.

Date Surveyed

Registered Professional Engineer and/or Land Surveyor

Certificate No.

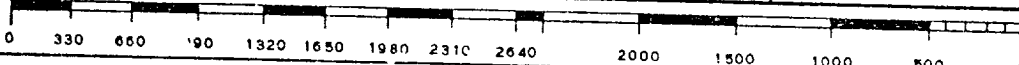

NEW MEXICO OIL CONSERVATION COMMISSION
WELL LOCATION AND ACREAGE DEDICATION PLAT

Form C-102
Supersedes C-128
Effective 1-1-65

All distances must be from the outer boundaries of the Section.

Operator PAN AMERICAN PETROLEUM CORPORATION			Lease <i>South Matter Unit</i>		Well No. <i>19</i>
Unit Letter <i>C</i>	Section <i>22</i>	Township <i>24-S</i>	Range <i>37-E</i>	County <i>Lea</i>	
Actual Footage Location of Well: <i>660</i> feet from the <i>NORTH</i> line and <i>1980</i> feet from the <i>WEST</i> line					
Ground Level Elev. <i>3277 RDB</i>	Producing Formation <i>LOWER PADDOCK</i>	Pool <i>FOWLER LOWER PADDOCK-OIL</i>	Dedicated Acreage: <i>80</i> Acres		

1. Outline the acreage dedicated to the subject well by colored pencil or hachure marks on the plat below.
2. If more than one lease is dedicated to the well, outline each and identify the ownership thereof (both as to working interest and royalty).
3. If more than one lease of different ownership is dedicated to the well, have the interests of all owners been consolidated by communitization, unitization, force-pooling, etc?

☐ Yes ☐ No If answer is "yes," type of consolidation _____

If answer is "no," list the owners and tract descriptions which have actually been consolidated. (Use reverse side of this form if necessary.) _____

No allowable will be assigned to the well until all interests have been consolidated (by communitization, unitization, forced-pooling, or otherwise) or until a non-standard unit, eliminating such interests, has been approved by the Commission.

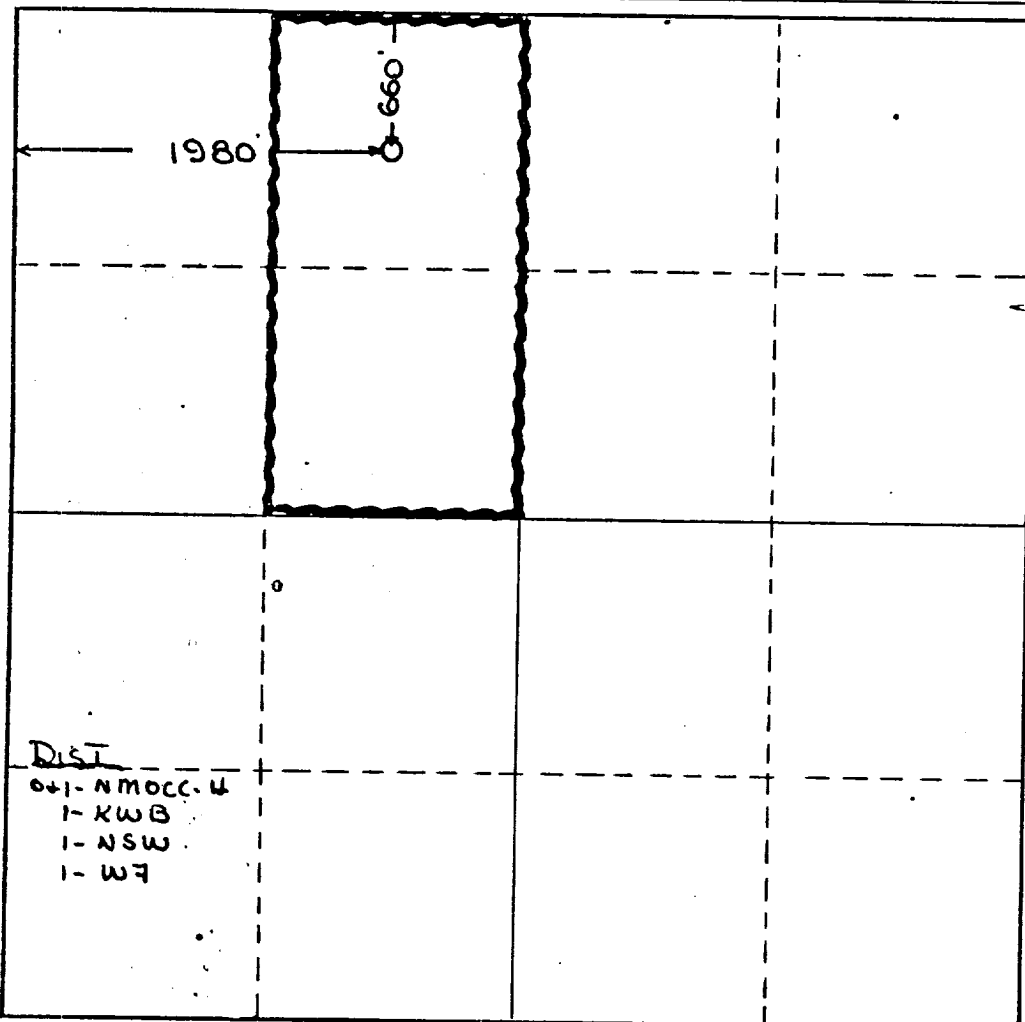

CERTIFICATION

I hereby certify that the information contained herein is true and complete to the best of my knowledge and belief.

Name _____

Position _____

Company _____

Date _____

I hereby certify that the well location shown on this plat was plotted from field notes of actual surveys made by me or under my supervision, and that the same is true and correct to the best of my knowledge and belief.

Date Surveyed _____

Registered Professional Engineer and/or Land Surveyor

Certificate No. _____



OWWO

COUNTY LEA FIELD Fowler STATE MN 21308
 OPR AMOCO PRODUCTION CO. MAP
19 South Mattix Unit - Federal
Sec 22, T-24-S, R-37-E CO-ORD
660' FNL, 1980' FWL of Sec

Re-Cmp 1-14-72	CLASS		EL	
	FORMATION	DATUM	FORMATION	DATUM
CSG & SX - TUBING				
9 5/8" at 1053' w/530 sx				
7" at 5767' w/550 sx				
LOGS EL GR RA IND HC A				
	TD 5767'; PBD 5730'			

(Upper Yeso) Perfs 5214-5729' NO NEW POTENTIAL

Distribution limited and publication prohibited by subscribers' agreement.
 Reproduction rights reserved by Williams & Lee Scouting Service, Inc.

CONT. PROP DEPTH 5729' TYPE WO
 DATE

F.R.C. 3-2-72; Opr's Elev. 3277' KB
 PD 5729' WO (Upper Yeso)
 (Orig. Pan American Pet. Corp., comp 12-11-65
 thru (Lower Paddock) Perfs 5280-5308' & (Blindbry)
 Perfs 5444-5729', OTD 5767', OPB 5730')
 2-29-72 TD 5767'; PBD 5730'; COMPLETE
 Perf @ 5214', 5220', 5225-29', 5244', 5257', 5261-
 63', 5267', 5271', 5315', 5319', 5324', 5327-29',
 5337', 5342', 5346', 5360', 5367', 5378', 5406',
 5411', 5416-20' w/2 SPF
 Acid (5214-5729') 1500 gals
 Frac (5214-5729') 36,000 gals wtr + 54,000# sd
 Ppd 41 BO + 136 BW in 24 hrs, GOR 930 (5214-5729')
 3-2-72 COMPLETION REPORTED

COUNTY	LEA	FIELD	Fowler	STATE	NM
OPR	PAN AMERICAN PETROLEUM CORP.				MAP
	19 South Mattix Unit-Federal				
	Sec. 22, T-24-S, R-37-E				CO-ORD
	660' FNL & 1980' FWL of Sec.				
	Spd 10-5-65; Cmp 12-11-65 (L/Pad)				CLASS
	Cmp 11-11-65 (Bli)				EL
CSG & SX - TUBING	FORMATION	DATUM	FORMATION	DATUM	
9 5/8" 1053' 530					
7" 5767' 550					
LOGS EL GR RA IND HC A					
	TD 5767', PBD 5730'				
IP Lower Paddock Perfs 5280-5308' Pmpd 25 BOPD + 6 BW. Pot. Based on 24 hr test, gravity 38.					
IP Blinebry Perfs 5444-5729' Flwd 122 BOPD + 30 BW. Pot. Based on 24 hr test thru 12/64" chk., TP 650#, gravity 38., GOR 893.					
Distribution limited and publication prohibited by subscribers' agreement. Reproduction rights reserved by Williams & Lee Scouting Service, Inc.					
CONT.	PROP DEPTH				5750'
DATE					TYPE

F.R. 8-12-65; Opr's Elev. 3277' KB
 PD 5750' - Blinebry
 10-11-65 Drlg. 3033'.
 9 5/8" casing @ 1053' W/530 sx.
 10-18-65 TD 4498', fshg.
 10-25-65 Drlg. 5631'.
 11-1-65 TD 5767', PBD 5730', flwg load.
 7" casing @ 5767' W/550 sx.
 Perf (Blinebry) 5444-49', 5459-67', 5485-90', 5527-30', 5554-57', 5605-11', 5632-35', 5714-16', 5726-29' W/2 SPF
 Ac. (5444-5729') 2000 gals.,
 Frac (5444-5729') 30,000 gals oil + 30,000# sd.

11-8-65 TD 5767', PBD 5730', flwg load.
Flwd 425 BLO, 17 BLW + 22 BNW/72 hrs
thru 12/64" chk. (5444-5729')

11-15-65 TD 5767', PBD 5730', prep to swab.
Blinebry complete.
Perf (Lower Paddock) 5280-5308' W/2 SPF
Ac. (5280-5308') 3000 gals.

11-22-65 TD 5767', PBD 5730', RU Pump.
Swbd & Flwd 8 BLO + 4 BNO in 2 hrs &
swbd down (5280-5308')
Re-Ac. (5280-5308') 5000 gals.
Swbd 97 BLO + 40 BLW/4½ hrs.

11-29-65 TD 5767', PBD 5730', prep to RU Pump.

12-6-65 TD 5767', PBD 5730', tstg Lower Paddock,
no gauge.

12-13-65 TD 5767', PBD 5730', COMPLETED.
(Holding for tops)

12-20-65 TD 5767', PBD 5730', Completion Reported.
LOG TOPS: Anhydrite 1050', Yates 2530',
Queen 3263', San Andres 3992', Glorieta
4907', Blinebry 5400'.