

NO. OF COPIES RECEIVED		
DISTRIBUTION		
SANTA FE		
FILE		
U.S.G.S.		
LAND OFFICE		
OPERATOR		

# NEW MEXICO OIL CONSERVATION COMMISSION

Form C-101  
Revised 1-1-65

5A. Indicate Type of Lease	
STATE <input type="checkbox"/>	FEE <input checked="" type="checkbox"/>
5. State Oil & Gas Lease No.	

## APPLICATION FOR PERMIT TO DRILL, DEEPEN, OR PLUG BACK

1a. Type of Work				7. Unit Agreement Name	
b. Type of Well DRILL <input checked="" type="checkbox"/> DEEPEN <input type="checkbox"/> PLUG BACK <input type="checkbox"/> OIL WELL <input checked="" type="checkbox"/> GAS WELL <input type="checkbox"/> OTHER <input type="checkbox"/> SINGLE ZONE <input type="checkbox"/> MULTIPLE ZONE <input checked="" type="checkbox"/>				8. Farm or Lease Name <b>J. A. Stuart</b>	
2. Name of Operator <b>J. Cecil Rhodes</b>				9. Well No. <b>1</b>	
3. Address of Operator <b>201 West Wall Bldg., Midland, Texas</b>				10. Field and Pool, or Wildcat <b>Justis Blinbry</b> <b>N. Justis Tube Drinkard</b>	
4. Location of Well UNIT LETTER <b>N</b> LOCATED <b>990</b> FEET FROM THE <b>South</b> LINE AND <b>2310</b> FEET FROM THE <b>West</b> LINE OF SEC. <b>11</b> TWP. <b>25 S</b> RGE. <b>37 E</b> NMPM				12. County <b>Lea</b>	
19. Proposed Depth <b>6250'</b>		19A. Formation <b>Drinkard</b>		20. Rotary or C.T. <b>Rotary</b>	
21. Elevations (Show whether DF, RT, etc.) <b>3121 (ground)</b>		21A. Kind & Status Plug. Bond <b>1 well, in force</b>		21B. Drilling Contractor <b>Forster Drilling Co.</b>	
				22. Approx. Date Work will start <b>March 6, 1965</b>	

## PROPOSED CASING AND CEMENT PROGRAM

SIZE OF HOLE	SIZE OF CASING	WEIGHT PER FOOT	SETTING DEPTH	SACKS OF CEMENT	EST. TOP
<b>12-1/4"</b>	<b>8-5/8" OD</b>	<b>28#</b>	<b>1000'</b>	<b>450</b>	<b>Surface</b>
<b>7-7/8"</b>	<b>5-1/2" OD</b>	<b>15.5#</b>	<b>6250'</b>	<b>1200</b>	<b>1700'</b>

**Blow out preventer; series 900, 6000# test, Shaffer Model 39.**

IN ABOVE SPACE DESCRIBE PROPOSED PROGRAM: IF PROPOSAL IS TO DEEPEN OR PLUG BACK, GIVE DATA ON PRESENT PRODUCTIVE ZONE AND PROPOSED NEW PRODUCTIVE ZONE. GIVE BLOWOUT PREVENTER PROGRAM, IF ANY.

I hereby certify that the information above is true and complete to the best of my knowledge and belief.

Signed J. Cecil Rhodes Title Owner Date March 4, 1965  
(This space for State Use)

APPROVED BY \_\_\_\_\_ TITLE \_\_\_\_\_ DATE \_\_\_\_\_

CONDITIONS OF APPROVAL, IF ANY:

NEW MEXICO OIL CONSERVATION COMMISSION  
WELL LOCATION AND ACREAGE DEDICATION PLAT

FORM C-128  
Revised 3/1/57

SEE INSTRUCTIONS FOR COMPLETING THIS FORM ON THE REVERSE SIDE

SECTION A

Operator <b>J. CECIL RHODES</b>		Lease <b>J.A. STUART</b>		Well No. <b>1</b>
Unit Letter <b>N</b>	Section <b>11</b>	Township <b>25 SOUTH</b>	Range <b>37 EAST</b>	County <b>LBA</b>
Actual Footage Location of Well: <b>990</b> feet from the <b>SOUTH</b> line and <b>2310</b> feet from the <b>WEST</b> line				
Ground Level Elev. <b>3121.3</b>	Producing Formation <b>Blinebry &amp; Tubb Drinkard</b>		Pool <b>Justis</b>	Dedicated Acreage: <b>40</b> Acres

1. Is the Operator the only owner in the dedicated acreage outlined on the plat below? YES ☒ NO \_\_\_\_ ("Owner" means the person who has the right to drill into and to produce from any pool and to appropriate the production either for himself or for himself and another. (65-3-29 (e) NMSA 1935 Comp.)
2. If the answer to question one is "no," have the interests of all the owners been consolidated by communitization agreement or otherwise? YES \_\_\_\_ NO \_\_\_\_ If answer is "yes," Type of Consolidation \_\_\_\_
3. If the answer to question two is "no," list all the owners and their respective interests below:

Owner	Land Description

SECTION B

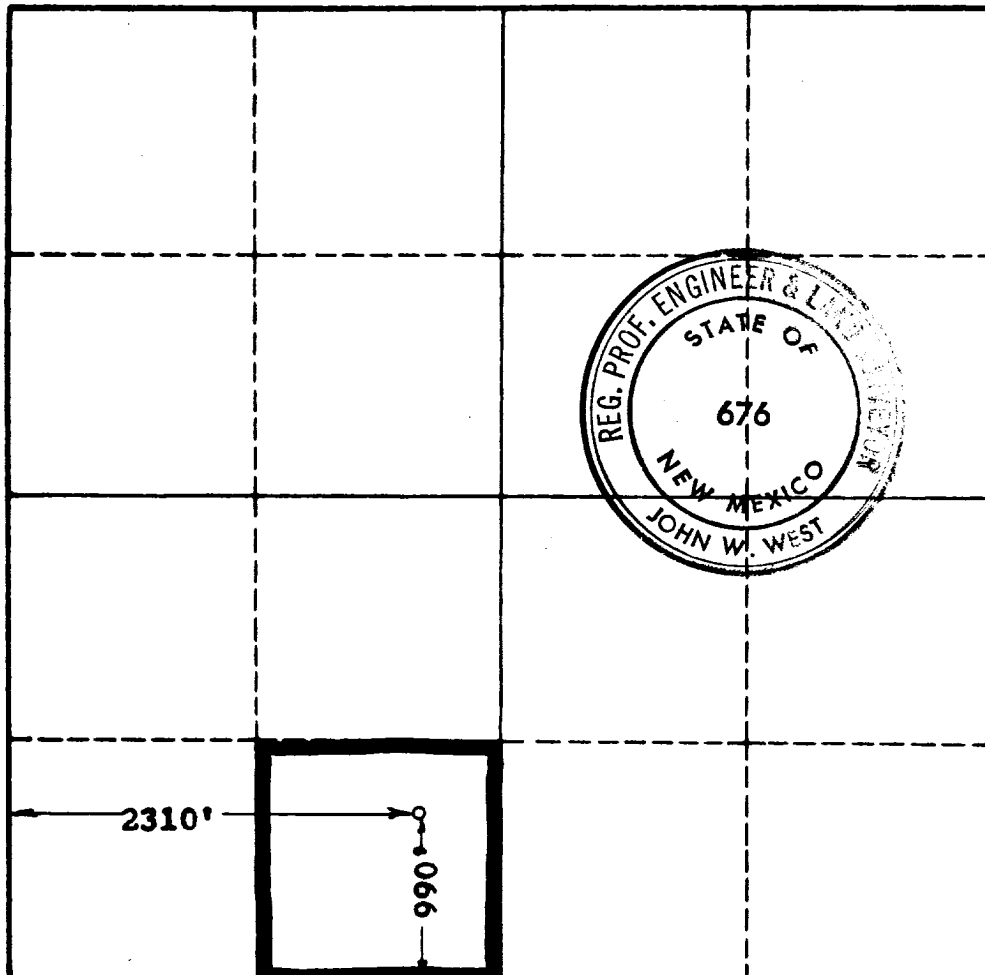

CERTIFICATION

I hereby certify that the information in SECTION A above is true and complete to the best of my knowledge and belief.

Name <i>J. Cecil Rhodes</i>
Position <b>Owner</b>
Company <b>J. Cecil Rhodes</b>
Date <b>3-4-65</b>

I hereby certify that the well location shown on the plat in SECTION B was plotted from field notes of actual surveys made by me or under my supervision, and that the same is true and correct to the best of my knowledge and belief.

Date Surveyed <b>3-1-65</b>
Registered Professional Engineer and/or Land Surveyor, <b>JOHN W. WEST</b>
Certificate No. <i>John W. West</i>
N. M. - P. E. & L. S. NO. 676