

UNITED STATES  
DEPARTMENT OF THE INTERIOR  
GEOLOGICAL SURVEY

## APPLICATION FOR PERMIT TO DRILL, DEEPEN, OR PLUG BACK

## 1a. TYPE OF WORK

DRILL ☒DEEPEN ☐PLUG BACK ☐

## b. TYPE OF WELL

OIL  
WELL ☒GAS  
WELL ☐OTHER ☐SINGLE  
ZONE ☒MULTIPLE  
ZONE ☐

## 2. NAME OF OPERATOR

Continental Oil Company

## 3. ADDRESS OF OPERATOR

P. O. Box 460, Hobbs, New Mexico 88240

## 4. LOCATION OF WELL (Report location clearly and in accordance with any State requirements.)\*

At surface 660' FNL & 660' FWL, Section 26, T-24S, R-37E,  
Lea County, New Mexico

At proposed prod. zone

Same

## 14. DISTANCE IN MILES AND DIRECTION FROM NEAREST TOWN OR POST OFFICE\*

## 15. DISTANCE FROM PROPOSED\*

LOCATION TO NEAREST  
PROPERTY OR LEASE LINE, FT.  
(Also to nearest drlg. unit line, if any)

660'

## 16. NO. OF ACRES IN LEASE

160

## 17. NO. OF ACRES ASSIGNED

TO THIS WELL

40

## 18. DISTANCE FROM PROPOSED LOCATION\*

TO NEAREST WELL, DRILLING, COMPLETED,  
OR APPLIED FOR, ON THIS LEASE, FT.

1320'

## 19. PROPOSED DEPTH

5800'

## 20. ROTARY OR CABLE TOOLS

Rotary

## 21. ELEVATIONS (Show whether DF, RT, GR, etc.)

## 22. APPROX. DATE WORK WILL START\*

1-10-68

23.

## PROPOSED CASING AND CEMENTING PROGRAM

SIZE OF HOLE	SIZE OF CASING	WEIGHT PER FOOT	SETTING DEPTH	QUANTITY OF CEMENT
12 1/4"	8 5/8"	28#	1000'	400 sacks
7 7/8"	5 1/2"	17#	5800'	550 sacks

It is proposed to drill a straight hole at the above location with rotary tools to a depth of 5800'.

1. Drill to 1000' - set surface casing.
2. Drill to TD - run open hole logs - set production casing - bump plug down w/treated brine water.
3. Perforate selected intervals - run 2 3/8" OD tubing w/packer - treat w/2500 gals. 15% LSTNE acid using ball sealers.
4. Pull tubing and packer. Frac down casing w/42000 gals. brine water, 840# Guar, 1050# ADOMITE AQUA fluid loss additive, 42 gals. ADOMALL chemical additive and 42000# sand. (Desired rate 40-45 BPN - ISIP-1700 psi - calc. 3000 HHP)  
Shut-in overnight
5. Swab back to clean up well. Place on production.

Your permission is requested for the above work.

IN ABOVE SPACE DESCRIBE PROPOSED PROGRAM: If proposal is to deepen or plug back, give data on present productive zone and proposed new productive zone. If proposal is to drill or deepen directionally, give pertinent data on subsurface locations and measured and true vertical depths. Give blowout preventer program, if any.

24.

SIGNED

*Jesse R. Stark*

TITLE

Sup. Prod. Engineer

DATE

12-18-67

(This space for Federal or State office use)

PERMIT NO.

APPROVAL DATE

DEC 26 1967

APPROVED BY

TITLE

A. R. McGOWN  
DISTRICT ENGINEER

DATE

CONDITIONS OF APPROVAL, IF ANY:

USGS-5 ATL-Ros-2 CHEV-Mid-2 PAN AM-Hobbs-2 FILE

NEW MEXICO OIL CONSERVATION COMMISSION  
WELL LOCATION AND ACREAGE DEDICATION PLAT

Form C-122  
Supersedes C-128  
Effective 1-1-65

All distances must be from the outer boundaries of the Section.

Operator <b>CONTINENTAL OIL COMPANY</b>			Lease <b>JACK B 26</b>		Well No. <b>3</b>
Tract Letter <b>D</b>	Section <b>26</b>	Township <b>24 SOUTH</b>	Range <b>37 EAST</b>	County <b>LEA</b>	
Actual Footage Location of Well:					
<b>660</b> feet from the <b>NORTH</b> line and		<b>660</b> feet from the <b>WEST</b> line			
Ground Level elev.	Producing Formation <b>Elinebry</b>		Depth <b>Justis Elinebry</b>	Dedicated Acreage <b>40</b>	

1. Outline the acreage dedicated to the subject well by colored pencil or hatchure marks on the plat below.
2. If more than one lease is dedicated to the well, outline each and identify the ownership thereof (both as to working interest and royalty).
3. If more than one lease of different ownership is dedicated to the well, have the interests of all owners been consolidated by communitization, unitization, force-pooling, etc?

☐ Yes ☐ No If answer is "yes," type of consolidation \_\_\_\_\_

If answer is "no," list the owners and tract descriptions which have actually been consolidated. (Use reverse side of this form if necessary.) \_\_\_\_\_

No allowable will be assigned to the well until all interests have been consolidated (by communitization, unitization, forced-pooling, or otherwise) or until a non-standard unit, eliminating such interests, has been approved by the Commission.

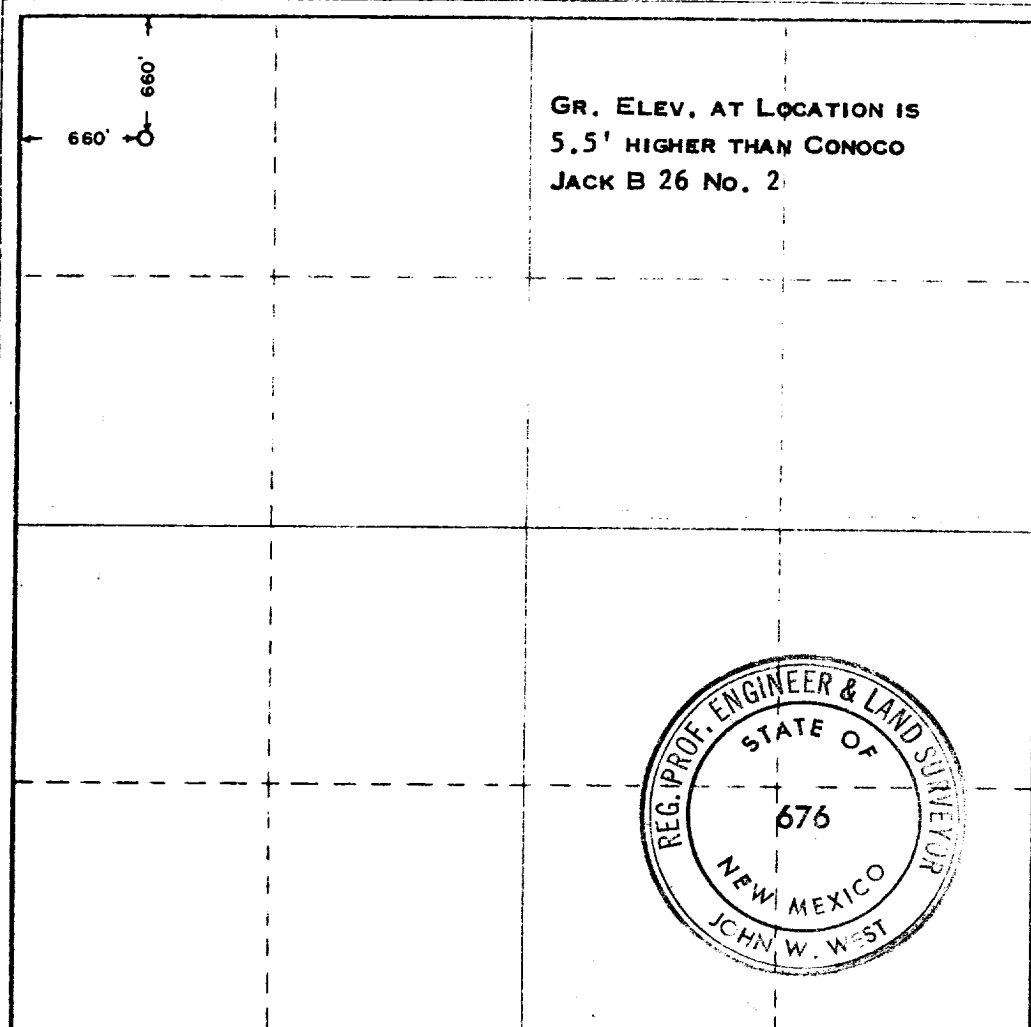

CERTIFICATION

I hereby certify that the information contained herein is true and complete to the best of my knowledge and belief.

Signature  
**Supr. Prod. Engineer**

Company  
**Continental Oil Company**

Date  
**December 11, 1967**

I hereby certify that the well location shown on this plat was plotted from field notes of actual surveys made by me or under my supervision, and that the same is true and correct to the best of my knowledge and belief.

**DEC. 13, 1967**

Date Surveyed

Registered Professional Engineer and/or Land Surveyor

*John W. West*  
Certificate No. **676**

