

NEW MEXICO OIL CONSERVATION COMMISSION
WELL LOCATION AND ACREAGE DEDICATION FORM

Form C-102
Supersedes C-128
Effective 1-1-65

All distances must be from the outer boundaries of the Section.

Operator Mobil Oil Corporation			Lease AUG 11 Humphrey "A"		Well No. 10
Unit Letter F	Section 3	Township 25-S	Range 37-E	County Lea	
Actual Footage Location of Well: 2420 feet from the north line and 2200 feet from the west line					
Ground Level Elev. 3146	Producing Formation Grayburg-San Andres		Pool Langlie Mattix		Dedicated Acreage: -- Acres

1. Outline the acreage dedicated to the subject well by colored pencil or hachure marks on the plat below.
2. If more than one lease is dedicated to the well, outline each and identify the ownership thereof (both as to working interest and royalty).
3. If more than one lease of different ownership is dedicated to the well, have the interests of all owners been consolidated by communitization, unitization, force-pooling, etc?

☐ Yes ☐ No If answer is "yes," type of consolidation _____

If answer is "no," list the owners and tract descriptions which have actually been consolidated. (Use reverse side of this form if necessary.) _____

No allowable will be assigned to the well until all interests have been consolidated (by communitization, unitization, forced-pooling, or otherwise) or until a non-standard unit, eliminating such interests, has been approved by the Commission.

S 89° 58' W

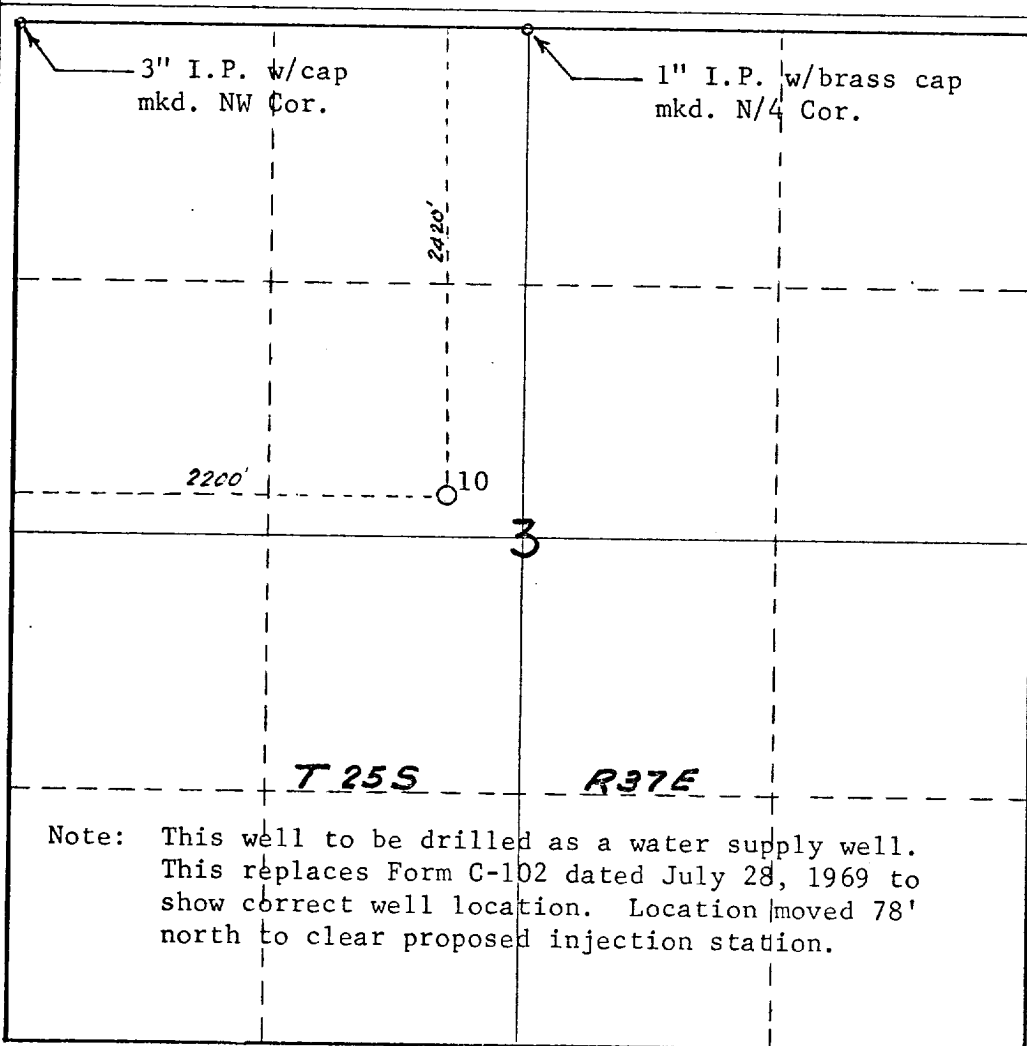

Note: This well to be drilled as a water supply well. This replaces Form C-102 dated July 28, 1969 to show correct well location. Location moved 78' north to clear proposed injection station.

CERTIFICATION

I hereby certify that the information contained herein is true and complete to the best of my knowledge and belief.

Name

A. D. Bond

Position

Proration Staff Assistant

Company

Mobil Oil Corporation

Date

August 1, 1969

I hereby certify that the well location shown on this plat was plotted from field notes of actual surveys made by me or under my supervision, and that the same is true and correct to the best of my knowledge and belief.

Date Surveyed

August 1, 1969

Registered Professional Engineer and/or Land Surveyor

John H. Seerey

Certificate No.

3572

S 0° 06' W

0 330 660 990 1320 1650 1980 2310 2640 2000 1500 1000 500 0