

UNITED STATES  
DEPARTMENT OF THE INTERIOR  
GEOLOGICAL SURVEY

APPLICATION FOR PERMIT TO DRILL, DEEPEN, OR PLUG BACK

1a. TYPE OF WORK  
DRILL ☒ DEEPEN ☐ PLUG BACK ☐

b. TYPE OF WELL  
OIL WELL ☒ GAS WELL ☐ OTHER ☐ SINGLE ZONE ☐ MULTIPLE ZONE ☐

2. NAME OF OPERATOR  
*Continental Oil Company*

3. ADDRESS OF OPERATOR  
*Box 460, Hobbs, N. Mex.*

4. LOCATION OF WELL (Report location clearly and in accordance with any State requirements.)  
At surface *1980' FSL + 330' FEL of Sec. 27, T-24S, R-37E, in Lea County, N. Mex.*  
At proposed prod. zone *Same*

14. DISTANCE IN MILES AND DIRECTION FROM NEAREST TOWN OR POST OFFICE\*  
*6 miles northeast of Hobbs, N. Mex.*

10. DISTANCE FROM PROPOSED LOCATION TO NEAREST PROPERTY OR LEASE LINE, FT. (Also to nearest drilg. unit line, if any)  
*3225' DF (est.)*

18. DISTANCE FROM PROPOSED LOCATION TO NEAREST WELL, DRILLING, COMPLETED, OR APPLIED FOR, ON THIS LEASE, FT.

16. NO. OF ACRES IN LEASE  
*330*

17. NO. OF ACRES ASSIGNED TO THIS WELL  
*40*

19. PROPOSED DEPTH  
*5,700*

20. ROTARY OR CABLE TOOLS  
*Rotary*

22. APPROX. DATE WORK WILL START\*  
*10-13-69*

5. LEASE DESIGNATION AND SERIAL NO.  
*LC-032326 B*

6. IF INDIAN, ALLOTTEE OR TRIBE NAME

7. UNIT AGREEMENT NAME  
*NMEU*

8. FARM OR LEASE NAME  
*JACK B-27*

9. WELL NO.  
*3*

10. FIELD AND POOL, OR WILDCAT  
*JUSTIS Blinbery*

11. SEC., T., R., M., OR BLM. AND SURVEY OR AREA  
*Sec. 27, T-24S, R-37E*

12. COUNTY OR PARISH  
*Lea*

13. STATE  
*N. Mex.*

PROPOSED CASING AND CEMENTING PROGRAM

SIZE OF HOLE	SIZE OF CASING	WEIGHT PER FOOT	SETTING DEPTH	QUANTITY OF CEMENT
<i>12 1/4</i>	<i>8 7/8</i>	<i>24 #</i>	<i>1050</i>	<i>440 CIRCULATE</i>
<i>7 7/8</i>	<i>5 1/2</i>	<i>14 #</i>	<i>5700</i>	<i>510</i>

*It is proposed to drill a straight hole to 5,700' and complete the well in the Blinbery zone.*

IN ABOVE SPACE DESCRIBE PROPOSED PROGRAM: If proposal is to deepen or plug back, give data on present productive zone and proposed new productive zone. If proposal is to drill or deepen directionally, give pertinent data on subsurface locations and measured and true vertical depths. Give blowout preventer program, if any.

24. SIGNED *Robert Gault III* TITLE *Adm. Section Chief* DATE *10-2-69*

(This space for Federal or State office use)

PERMIT NO. \_\_\_\_\_ APPROVED BY \_\_\_\_\_ TITLE \_\_\_\_\_ DATE \_\_\_\_\_

CONDITIONS OF APPROVAL, IF ANY:

**APPROVED**  
OCT 3 1969  
ANTHONY R. BROWN  
DISTRICT ENGINEER

\*See Instructions On Reverse Side

*22 1/2 - 5' Feb*  
*San Am Hobbs 2*

*Plan mid 2 1968 Rich Res 2*

NEW MEXICO OIL CONSERVATION COMMISSION  
WELL LOCATION AND ACREAGE DEDICATION PLAT

Form C-102  
Supersedes C-128  
Effective 1-1-65

All distances must be from the outer boundaries of the Section.

Operator <b>CONTINENTAL OIL CO.</b>			Lease <b>JACK B-27</b>		Well No. <b>3</b>
Unit Letter <b>I</b>	Section <b>27</b>	Township <b>24 SOUTH</b>	Range <b>37 EAST</b>	County <b>LEA</b>	
Actual Footage Location of Well: <b>1980</b> feet from the <b>SOUTH</b> line and <b>330</b> feet from the <b>EAST</b> line					
Ground Level Elev.	Producing Formation <i>Justin Blinchy</i>		Pool <i>Blinchy</i>	Dedicated Acreage: <b>40</b> Acres	

1. Outline the acreage dedicated to the subject well by colored pencil or hatchure marks on the plat below.
2. If more than one lease is dedicated to the well, outline each and identify the ownership thereof (both as to working interest and royalty).
3. If more than one lease of different ownership is dedicated to the well, have the interests of all owners been consolidated by communitization, unitization, force-pooling, etc?

☐ Yes ☐ No If answer is "yes," type of consolidation \_\_\_\_\_

If answer is "no," list the owners and tract descriptions which have actually been consolidated. (Use reverse side of this form if necessary.) \_\_\_\_\_

No allowable will be assigned to the well until all interests have been consolidated (by communitization, unitization, forced-pooling, or otherwise) or until a non-standard unit, eliminating such interests, has been approved by the Commission.

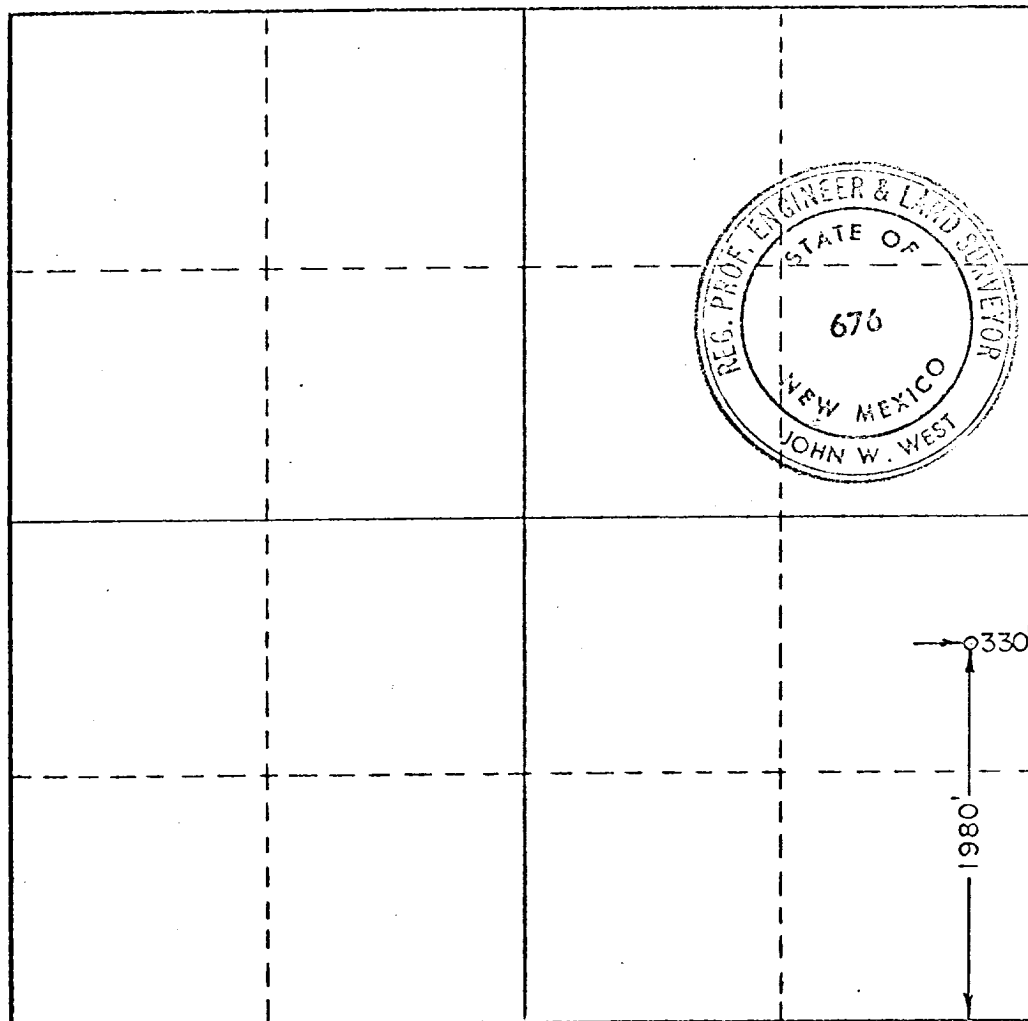

CERTIFICATION

I hereby certify that the information contained herein is true and complete to the best of my knowledge and belief.

Name *Robert Goulson*  
Position *Adm. Section Chief*  
Company *Continental Oil Co.*  
Date *10-2-69*

I hereby certify that the well location shown on this plat was plotted from field notes of actual surveys made by me or under my supervision, and that the same is true and correct to the best of my knowledge and belief.

Date Surveyed  
**SEPTEMBER 27, 1969**

Registered Professional Engineer and/or Land Surveyor

*John W. West*

Certificate No. **676**

