

(May 1963)

**UNITED STATES
DEPARTMENT OF THE INTERIOR
GEOLOGICAL SURVEY**

(Other instructions on reverse side)

Form approved.
Budget Bureau No. 42-R1425.

APPLICATION FOR PERMIT TO DRILL, DEEPEN, OR PLUG BACK

1a. TYPE OF WORK

DRILL ☒DEEPEN ☐PLUG BACK ☐

b. TYPE OF WELL

OIL WELL ☒GAS WELL ☐OTHER ☐SINGLE ZONE ☒MULTIPLE ZONE ☐

2. NAME OF OPERATOR

Atlantic Richfield Company

3. ADDRESS OF OPERATOR

P. O. Box 1978, Roswell, New Mexico 88201

4. LOCATION OF WELL (Report location clearly and in accordance with any State requirements.)*

At surface

At proposed prod. zone 2310' FNL & 1830' FEL (Unit letter G)

14. DISTANCE IN MILES AND DIRECTION FROM NEAREST TOWN OR POST OFFICE*

8 miles NE of Jal, N.M.

15. DISTANCE FROM PROPOSED*

LOCATION TO NEAREST
PROPERTY OR LEASE LINE, FT.
(Also to nearest drlg. unit line, if any)

330'

16. NO. OF ACRES IN LEASE

160

17. NO. OF ACRES ASSIGNED
TO THIS WELL

40

18. DISTANCE FROM PROPOSED LOCATION*
TO NEAREST WELL, DRILLING, COMPLETED,
OR APPLIED FOR, ON THIS LEASE, FT.

19. PROPOSED DEPTH

8200'

20. ROTARY OR CABLE TOOLS

Rotary

21. ELEVATIONS (Show whether DF, RT, GR, etc.)

To be reported

22. APPROX. DATE WORK WILL START*

11/20/72

23.

PROPOSED CASING AND CEMENTING PROGRAM

SIZE OF HOLE	SIZE OF CASING	WEIGHT PER FOOT	SETTING DEPTH	QUANTITY OF CEMENT
17-1/2	13-3/8	48# H-40	600	Circulate w/Class C + 4% ge
12-1/4 & 11"	8-5/8	24# J-55	3900	2000 ft of Class C + 4% ge
		32# H-40		& 2% CaCl ₂
7-7/8	5-1/2	15.5 & 17# J-55	8200	600 sx Class C neat

We propose to drill a well as outlined above to test the Devonian zone. Fresh water spud mud will be used on 17-1/2" hole. Native brine mud will be used to 3900'. Fresh water will be used to 7500' and a low solids fresh water gel mud from 7500' to T.D. 12" Series 900 preventers will be used on 13-3/8" casing and 8" Series 900 hydraulic BOP's on 8-5/8" casing.

IN ABOVE SPACE DESCRIBE PROPOSED PROGRAM: If proposal is to deepen or plug back, give data on present productive zone and proposed new productive zone. If proposal is to drill or deepen directionally, give pertinent data on subsurface locations and measured and true vertical depths. Give blowout preventer program, if any.

24.

SIGNED

A.D. Litcher

TITLE

Dist. Drlg. Supervisor

DATE

11/1/72

(This space for Federal or State office use)

PERMIT NO.

APPROVAL DATE

APPROVED BY

TITLE

CONDITIONS OF APPROVAL, IF ANY:

*See Instructions On Reverse Side

RECEIVED

JUL 7 1972

CAL CONSERVATION COMM.
HOUSTON, TX. M.

NE XICO OIL CONSERVATION COMMISSIC
WELL LOCATION AND ACREAGE DEDICATION PLAT

Form C-102
 Supersedes C-128
 Effective 1-1-65

All distances must be from the outer boundaries of the Section.

Operator Atlantic Richfield Company			Lease J. H. McClure "A"		Well No. 22
Unit Letter G	Section 30	Township 24-S	Range 38-E	County Lea	
Actual Footage Location of Well: 2310 feet from the North line and 1830 feet from the East line					
Ground Level Elev:	Producing Formation Devonian		Pool West Undesignated		Dedicated Acreage: 40 Acres

1. Outline the acreage dedicated to the subject well by colored pencil or hachure marks on the plat below.
2. If more than one lease is dedicated to the well, outline each and identify the ownership thereof (both as to working interest and royalty).
3. If more than one lease of different ownership is dedicated to the well, have the interests of all owners been consolidated by communitization, unitization, force-pooling, etc?

☐ Yes ☐ No If answer is "yes," type of consolidation _____

If answer is "no," list the owners and tract descriptions which have actually been consolidated. (Use reverse side of this form if necessary.) _____

No allowable will be assigned to the well until all interests have been consolidated (by communitization, unitization, forced-pooling, or otherwise) or until a non-standard unit, eliminating such interests, has been approved by the Commission.

R-38-E

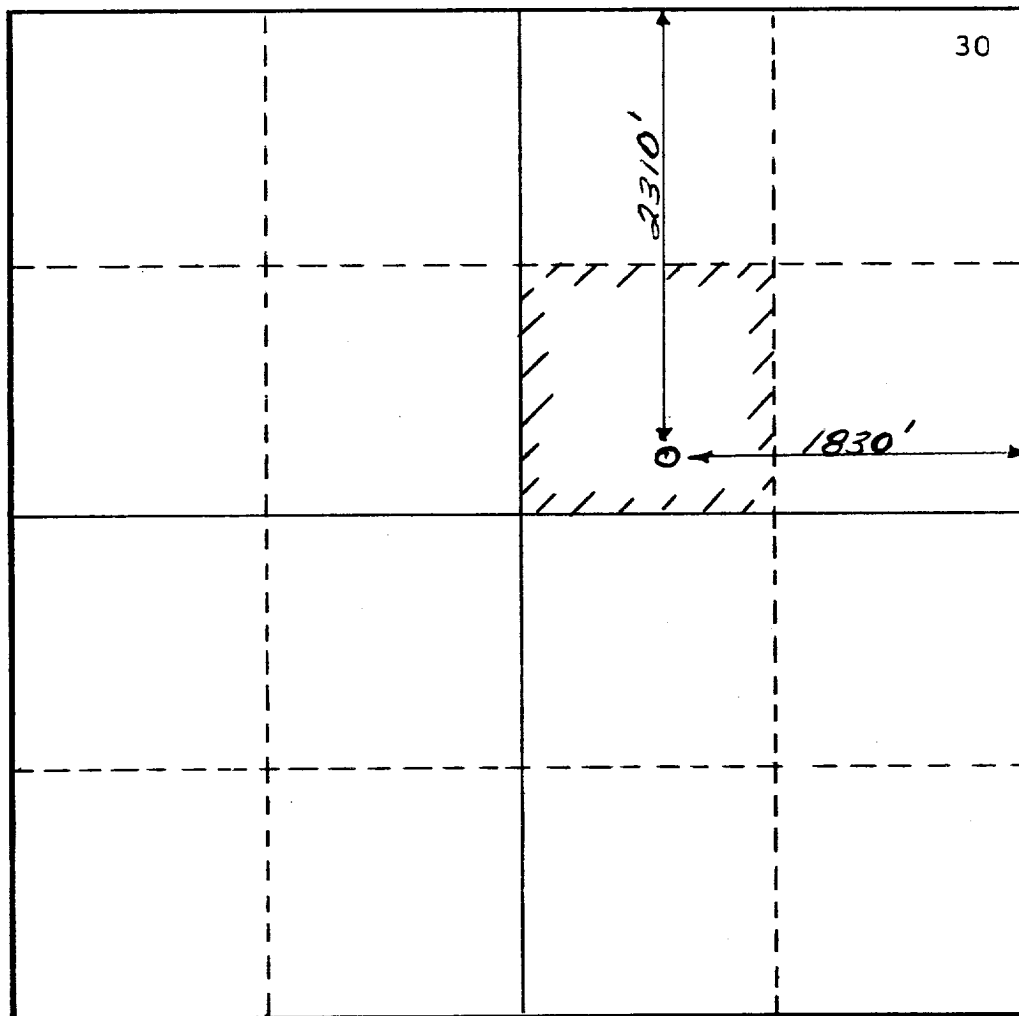

CERTIFICATION

I hereby certify that the information contained herein is true and complete to the best of my knowledge and belief.

O. D. Bretches

Name
O. D. Bretches

Position
Dist. Drlg. Supervisor

Company
Atlantic Richfield Co.

Date
October 31, 1972

I hereby certify that the well location shown on this plat was plotted from field notes of actual surveys made by me or under my supervision, and that the same is true and correct to the best of my knowledge and belief.

Date Surveyed
Oct. 26-1972

Registered Professional Engineer and/or Land Surveyor

George S. Anderson

Certificate No.

648

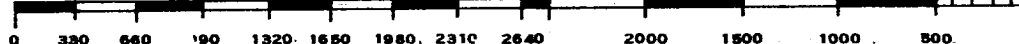

T
24
S

RECEIVED

7 1972

OIL CONSERVATION COMM.
HOBBES, W. M.