

Exxon Lse. No. _____
State Lse. No. _____
Federal Lse. No. NM 0559805

NEW MEXICO OIL CONSERVATION COMMISSION
WELL LOCATION AND ACREAGE DEDICATION PLAT

Form C-102
Supersedes C-128
Effective 1-1-65

All distances must be from the outer boundaries of the Section.

Operator Exxon Corporation			Lease FAIRVIEW MILLS - FEDERAL		Well No. 1
Unit Letter "O"	Section 14	Township T 25 S	Range R 34 E	County LEA	
Actual Footage Location of Well: 990 feet from the South line and 1980 feet from the East line					
Ground Level Elev: Later	Producing Formation Wolfcamp		Pool Fairview Mills Wolfcamp Gas		Dedicated Acreage: 640 Acres

1. Outline the acreage dedicated to the subject well by colored pencil or hachure marks on the plat below.
2. If more than one lease is dedicated to the well, outline each and identify the ownership thereof (both as to working interest and royalty).
3. If more than one lease of different ownership is dedicated to the well, have the interests of all owners been consolidated by communitization, unitization, force-pooling, etc?
☐ Yes ☐ No If answer is "yes," type of consolidation _____

If answer is "no," list the owners and tract descriptions which have actually been consolidated. (Use reverse side of this form if necessary.) _____
No allowable will be assigned to the well until all interests have been consolidated (by communitization, unitization, forced-pooling, or otherwise) or until a non-standard unit, eliminating such interests, has been approved by the Commission.

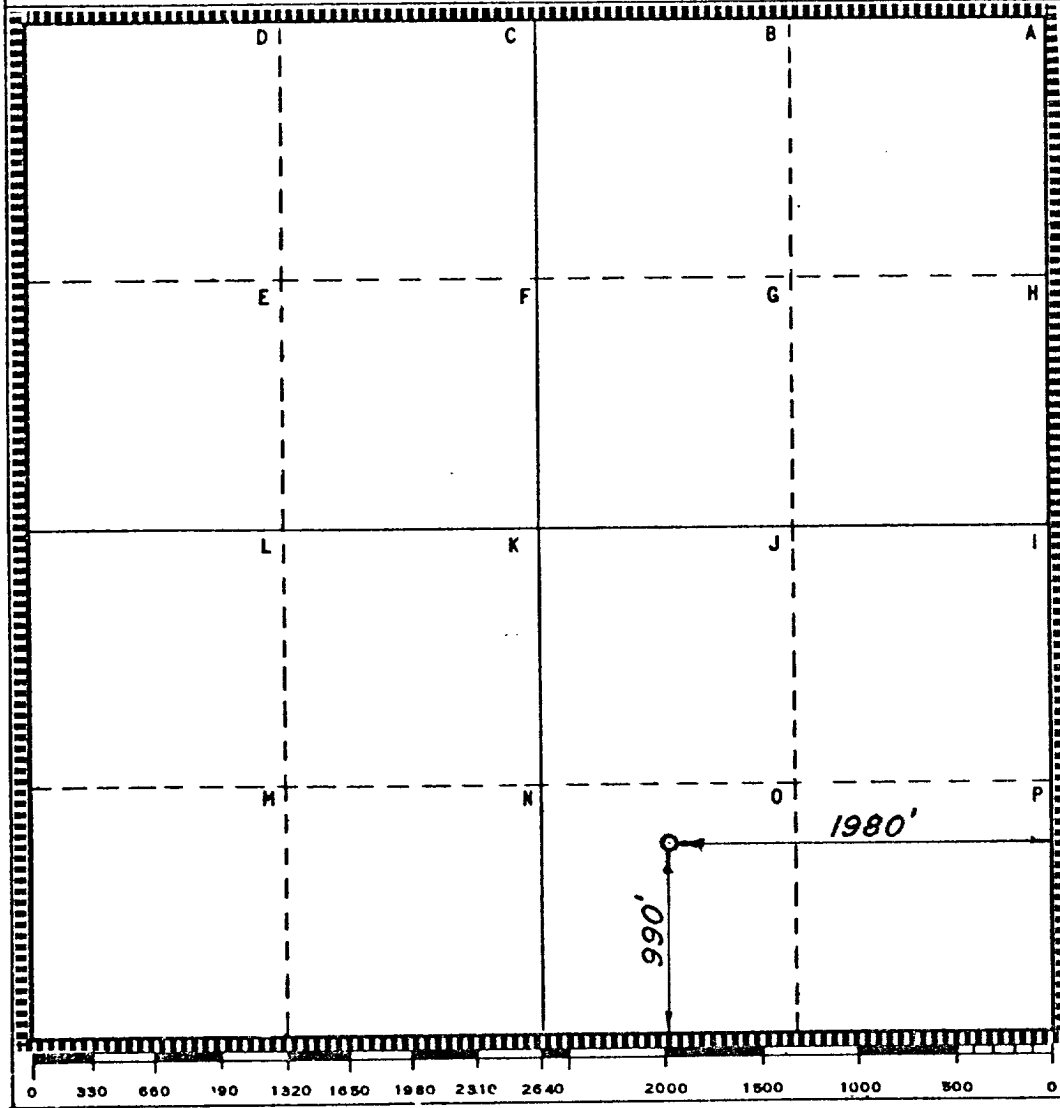

CERTIFICATION	
I hereby certify that the information contained herein is true and complete to the best of my knowledge and belief.	
Name	<i>W. S. Sipton</i>
Position	Proration Specialist
Company	Exxon Corporation
	Box 1600 Midland, Texas
Date	7-17-75
I hereby certify that the well location shown on this plat was plotted from field notes of actual surveys made by me or under my supervision, and that the same is true and correct to the best of my knowledge and belief.	
Date Surveyed	2/12/74
Registered Professional Engineer and/or Land Surveyor <i>W. S. Sipton</i>	
Certificate No.	1382