

| | |
|------------------------|--|
| NO. OF COPIES RECEIVED | |
| DISTRIBUTION | |
| SANTA FE | |
| FILE | |
| U.S.G.S. | |
| LAND OFFICE | |
| OPERATOR | |

N. MEXICO OIL CONSERVATION COMMISSION

Form C-101
Revised 1-1-65

5A. Indicate Type of Lease
STATE ☐ FEE ☒
5. State Oil & Gas Lease No.

APPLICATION FOR PERMIT TO DRILL, DEEPEN, OR PLUG BACK

| | | | |
|---|--|--|--|
| 1a. Type of Work | | 7. Unit Agreement Name | |
| b. Type of Well OIL WELL <input checked="" type="checkbox"/> GAS WELL <input type="checkbox"/> OTHER <input type="checkbox"/> DRILL <input checked="" type="checkbox"/> DEEPEN <input type="checkbox"/> PLUG BACK <input type="checkbox"/> SINGLE ZONE <input type="checkbox"/> MULTIPLE ZONE <input type="checkbox"/> | | Langlie-Jal Unit | |
| 2. Name of Operator | | 8. Farm or Lease Name | |
| Union Texas Petroleum Corporation | | | |
| 3. Address of Operator | | 9. Well No. | |
| 1300 Wilco Building, Midland, Texas 79701 | | 80 | |
| 4. Location of Well UNIT LETTER <u>E</u> LOCATED <u>1980'</u> FEET FROM THE <u>North</u> LINE AND <u>430'</u> FEET FROM THE <u>West</u> LINE OF SEC. <u>8</u> TWP. <u>25-S</u> RGE. <u>37-E</u> NMPM | | 10. Field and Pool, or Wildcat Langlie-Mattix (Queen) | |
| 21. Elevations (Show whether DF, RT, etc.) 3151.2' GL | | 12. County Lea | |
| 21A. Kind & Status Plug. Bond Blanket | | 19. Proposed Depth 3775' | |
| 21B. Drilling Contractor Cactus Drlg. Corp. | | 19A. Formation 7-Rivers Queen | |
| 22. Approx. Date Work will start 9-20-74 | | 20. Rotary or C.T. Rotary | |

PROPOSED CASING AND CEMENT PROGRAM

| SIZE OF HOLE | SIZE OF CASING | WEIGHT PER FOOT | SETTING DEPTH | SACKS OF CEMENT | EST. TOP |
|--------------|----------------|-----------------|---------------|-----------------|----------------|
| 12-1/4" | 8-5/8" | 24# | 800' | 400 sx | Circ. to surf. |
| 7-7/8" | 5-1/2" | Various | 3775' | 675 sx | Circ. to surf. |

Propose to drill and equip an oil well to depth of approximately 3775' into the unitized interval in the Langlie-Jal Unit.

Well control equipment will comply with API 3M Rds. Specifications.

APPROVAL
FOR 90 DAYS UNLESS
DRILLING COMMENCED,

EXPIRES 12-3-74

IN ABOVE SPACE DESCRIBE PROPOSED PROGRAM: IF PROPOSAL IS TO DEEPEN OR PLUG BACK, GIVE DATA ON PRESENT PRODUCTIVE ZONE AND PROPOSED NEW PRODUCTIVE ZONE. GIVE BLOWOUT PREVENTER PROGRAM, IF ANY.

I hereby certify that the information above is true and complete to the best of my knowledge and belief.

Signed Stanley H Post Title Gas Measurement Analyst Date August 28, 1974

(This space for State Use)

APPROVED BY [Signature] TITLE SUPERVISOR DATE 8-28-74

CONDITIONS OF APPROVAL, IF ANY:

NEW MEXICO OIL CONSERVATION COMMISSION
WELL LOCATION AND ACREAGE DEDICATION PLAT

Form C-102
Supersedes C-128
Effective 1-1-65

All distances must be from the outer boundaries of the Section.

| | | | | | |
|---|--|-----------------------------|----------------------------------|----------------------|---|
| Operator UNION TEXAS PETROLEUM CORP. | | | Lease LANGLIE-JAL UNIT | | Well No. 80 |
| Unit Letter E | Section 8 | Township 25 SOUTH | Range 37 EAST | County LEA | |
| Actual Footage Location of Well: 1980 feet from the NORTH line and 430 feet from the WEST line | | | | | |
| Ground Level Elev. 3151.2 | Producing Formation Seven Rivers-Queen | | Pool Langlie-Mattix | | Dedicated Acreage: 3748.06 (Unit) Acres |

1. Outline the acreage dedicated to the subject well by colored pencil or hachure marks on the plat below.
2. If more than one lease is dedicated to the well, outline each and identify the ownership thereof (both as to working interest and royalty).
3. If more than one lease of different ownership is dedicated to the well, have the interests of all owners been consolidated by communitization, unitization, force-pooling, etc?

☐ Yes ☐ No If answer is "yes," type of consolidation _____

If answer is "no," list the owners and tract descriptions which have actually been consolidated. (Use reverse side of this form if necessary.) _____

No allowable will be assigned to the well until all interests have been consolidated (by communitization, unitization, forced-pooling, or otherwise) or until a non-standard unit, eliminating such interests, has been approved by the Commission.

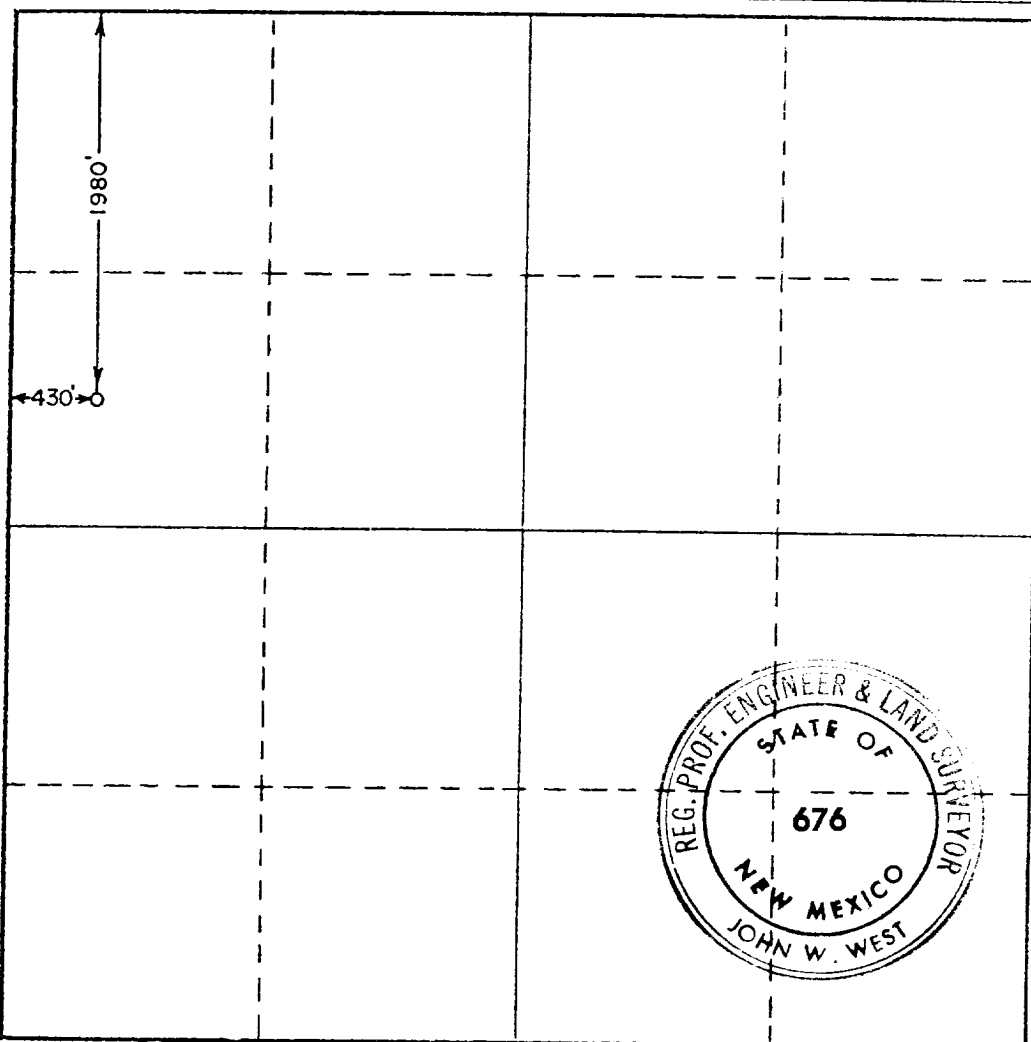

CERTIFICATION

I hereby certify that the information contained herein is true and complete to the best of my knowledge and belief.

Stanley A. Post
Name

Stanley A. Post
Position

Gas Measurement Analyst
Company

Union Texas Petroleum Corp.
Date

August 28, 1974

I hereby certify that the well location shown on this plat was plotted from field notes of actual surveys made by me or under my supervision, and that the same is true and correct to the best of my knowledge and belief.

Date Surveyed
OCTOBER 8, 1973

Registered Professional Engineer and/or Land Surveyor

John W. West
Certificate No.

676

0 330 660 990 1320 1650 1980 2310 2640 2970 3300 3630 3960 4290 4620 4950 5280 5610 5940 6270 6600